

Movable Range Coop 20' x 36' FC3000

Assembly Instructions



P.O. Box 458 - 27725 Danville Avenue - Castle Rock, MN 55010 - www.poly-tex.com
U.S. & Canada Toll Free - 800-852-3443 - (651) 463-7009 - fax (651) 463-2479

REV: AM-230711

PLEASE READ THE INSTALLATION INSTRUCTIONS CAREFULLY BEFORE BEGINNING TO ASSEMBLE THE STRUCTURE. SAVE THESE INSTRUCTIONS FOR FUTURE REFERENCE.

There is no guarantee of the load capacity of the structure or foundation for snow, wind, seismic, or other loads unless buyer has received certified engineering drawings with the structure, and Poly-Tex does not warrant that the frame or foundation will comply with local or state building codes in buyer's location.



This structure is intended to be self-supporting, provided it is constructed with all frames, hardware, sheathing, sheeting, bracing, cables, and membrane in place, and secured to the foundation as shown in the manual. Stability during construction, from winds and loads imposed during erection, is the sole responsibility of the installer. Observe safety codes required by the local jurisdiction, and relevant safety practices for working at heights. Avoid the risk of electrical shock from overhead lines or electrical storms. Poly-Tex recommends contracting a licensed electrician to perform electrical work. Eye protection is recommended under all circumstances and hearing protection is recommended when cutting components with power tools.



No part of this structure is engineered to function as an anchorage point for a fall arrest system. Use a safety net or work from a safe work platform (i.e. scaffolding). Select a calm day for work. Wind can be sufficient enough to knock materials or workers off a work platform or ladder, resulting in a potentially deadly fall.

Overview of assembly procedure

While each structure and site is unique, and may require special considerations, these instructions are for a tilt-up method (where frames are assembled on the ground and tilted onto ground stakes or anchor rods using ropes or lifts). If installer is not confident to erect the structure, Poly-Tex suggests hiring a general contractor, carpenter, or similar licensed business familiar with construction, to assemble and erect the structure.



Do not overload structure. Consult with a Poly-Tex representative prior to adding any amount of weight over the specified capacity of this structure. Basket purlins, shelving or any objects of significant weight shall not be hung, attached, or secured to roof or truss members in a manner that will overload the structure.



Do not walk on polycarbonate sheets. If structure is to be covered with polycarbonate sheets, always use scaffolding for the erection process to avoid damage to sheeting and to ensure safety. Polycarbonate sheeting has UV coating protected with vinyl film on the exterior surface. Install sheets with the film intact and toward the exterior. Remove film once the sheet has been fastened

Poly-TEX, Inc. Limited Warranty

Poly-TEX, Inc. warrants its products to be free from defects in material and workmanship for a period of (1) year from date of invoice. This warranty is provided to the original purchaser of the product and is not transferable. Poly-TEX does not warrant parts not manufactured by Poly-TEX, but does assign any transferable manufacturer or supplier warranties. Should any defect be found, full repair or replacement will be rendered to the customer at no cost following inspection by a Poly-TEX representative and the return of the defective product to our Castle Rock, MN factory. Expenses for removal or reinstallation of defective products will not be covered by the warranty. The sale of custom projects are final and are not eligible for refund.

POLY-TEX SHALL NOT BE HELD RESPONSIBLE FOR ANY SPECIAL OR CONSEQUENTIAL DAMAGES, OR FOR ANY DELAY IN PERFORMANCE OF THIS WARRANTY BEYOND OUR CONTROL. THIS WARRANTY IS EXCLUSIVE AND IN LIEU OF ALL OTHER WARRANTIES WHETHER IMPLIED, WRITTEN, OR ORAL INCLUDING THE WARRANTIES OF MERCHANTABILITY AND FITNESS FOR A PARTICULAR PURPOSE.

ADDITIONALLY, THERE IS NO GUARANTEE OF THE LOAD CAPACITY OF THE STRUCTURE FOR SNOW, WIND, SEISMIC, OR OTHER LOADS UNLESS BUYER HAS RECEIVED CERTIFIED ENGINEERING DRAWINGS WITH THE STRUCTURE. POLY-TEX, INC DOES NOT WARRANT THAT FRAME WILL COMPLY WITH LOCAL OR STATE BUILDING CODES IN BUYERS LOCATION.

This warranty does not cover damage from customer abuse, misuse, improper installation, customer modifications, customer negligence in performing normal maintenance, or damage resulting from acts of nature.

REV - 11/20

SHEET INDEX

2	Safety Guidelines
3	Warranty and Index
4	Parts - Structure
5	Parts - Structure
6	Parts - Fittings
7	Parts - Miscellaneous
8	Parts - Hardware
9	Structure Overview
10	Skid Assembly
11	Cross Brace Assembly
12	Basic Frame Assembly
13	Intermediate Frame Assembly
14	Frame and Windbrace Installation
15	Ridge & Eave Purlin Installation - Part 1
16	Ridge & Eave Purlin Installation - Part 2
17	Intermediate Purlin Installation - Part 1
18	Intermediate Purlin Installation - Part 2
19	End Frame Installation
20	Equipment Rail Installation
21	Wood Skirt Installation
22	Netting and Wiggle Wire Base
23	Wiggle Wire Installation
24	End Frame Poly
25	Gable Vent Installation - Part 1
26	Gable Vent Installation - Part 2
27	Roof Poly Installation - Part 1
28	Roof Poly Installation - Part 2
29	Side Vent Installation - Part 1
30	Side Vent Installation - Part 2
31	Shade Fabric Installation
32	Door Installation
33	Eye Hook Installation
34	Anchoring

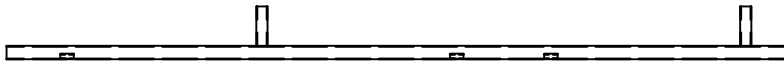

HT2170
Skid Rail 9'-4" x 6' (1.66)

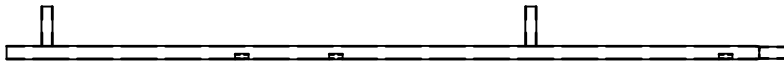

HT2171
Skid Rail Swaged 9'-4" x 6' (1.66)



HT2172
Skid Rail Swaged 8'-8" x 6' (1.66)



HP3340
9'-8" Truss Purlin w/Swage-Red

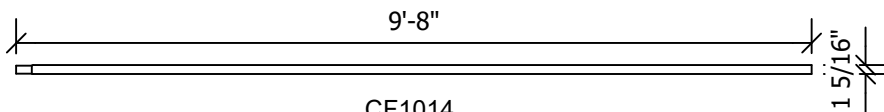

CF1014
1.315" Tube w/Swage (116")

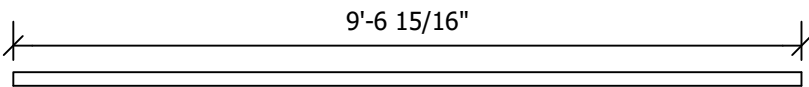

HP3557
9'-7" 2.0" x 14 ga.



RR2109
9'-8" R.F. U Channel w/Swage

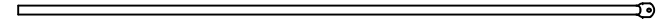

HT1015
92 3/4" Chord

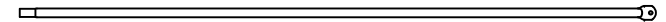

HT1016
92 3/4" Chord SWD

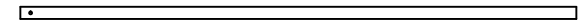

HT2143
1.75" Sq x 81 1/8" w/Hole

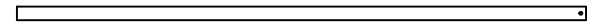

HP3420
EXT 2.0" Sq 6'-11"

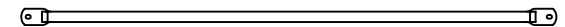

HP3506
HT Diagonal Brace 78"



RC1319
Roll-Up Crank (84")

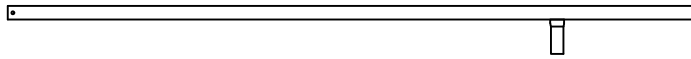

DR5082
Door Vertical (100")

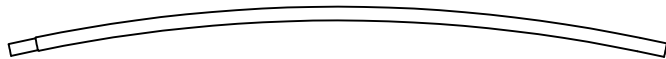

FC1002
Poultry Rafter 20' (2.0)

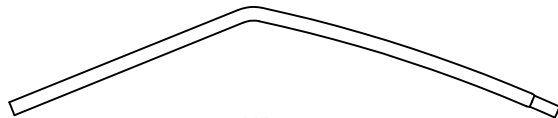

HP3556
FC Straight Side (Gothic 20')

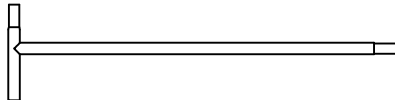

FC1001
2" Tie Post 1' x 5'

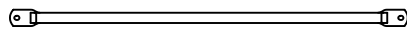

HP3503
HT Peak Brace (111")

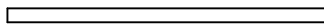

DR5073
Door Frame Header (46 1/2")



FC1003
Poultry Peak 20' (2.0)

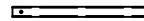

HT1076
Door Jamb Extension (24")



FT4040
2" x 1.375" Cross (Set) w/Bolts



FT4041
1.375" Brace Band

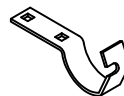

FT2079
Long Speed Hook (2")

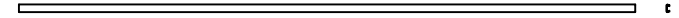

WWBASE9
8'11" Wiggle Base

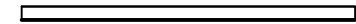

DR5085
Gable Peak Header



HT1023
34 1/2" STRUT

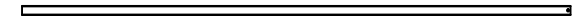

HT1085
Roll-Up DR/Vent Tube (80")

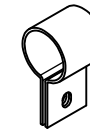

HY2027
C-Bracket (SF-23)



FT2071
Door "J" Hook



FT2108
1 1/2" UNI Pipe Clamp

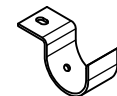

FT2106
R.F. End Strap

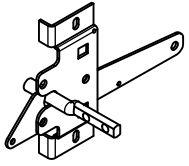

DR6041
Latch, Swinging Door

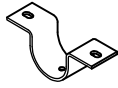

FT2057
2" U-Clamp



FT2119
Purlin Fastener 1.315



KH1000
Purlin Fastener



FT2117
R.F. End Strap (1.66")

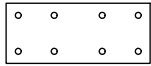

DR7033
Steel Flat Bracket

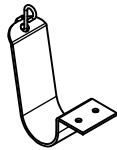

RC1330
Cradle Assy (Short) w/Hook



RC1311
Bracket Assy With S Hook



FT3504
"L" Bracket

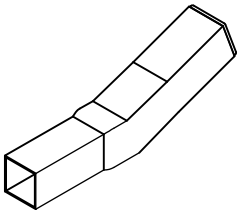

HTA1034
Skid Insert



HTA1064
Anchor Rod Shackle (5")

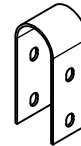

HY2026
U-Bracket (SF-23)

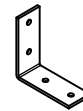

FT1990
R.F. "L" Bracket

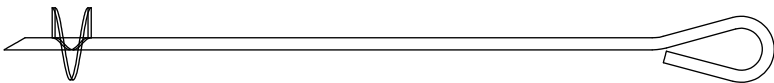

PT2200
Earth Anchor 30"



HTA1058
Anchor Rod

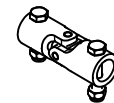

RC1303
U-Joint w/Bolts

AM-230711



RC1010
Roll-Up Tube Clip 1.315"



RS5000
1 1/4" Rnd Blk Plug



FB2527
1" x 1 1/2" Rect Blk Plug 16 ga.

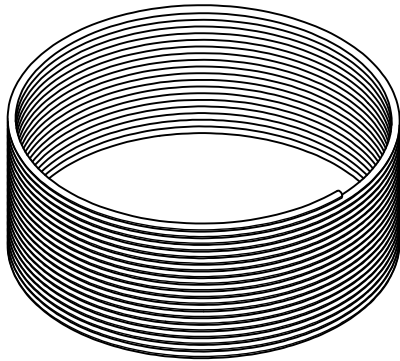

RC1406
Nylon Rope 1/4"Ø x 66'

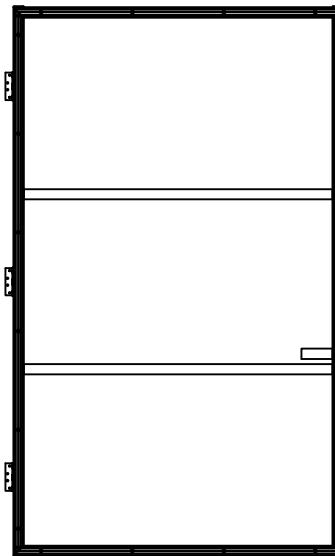

DR6038
Door, Swinging, Assembly, 4' x 6'-8"

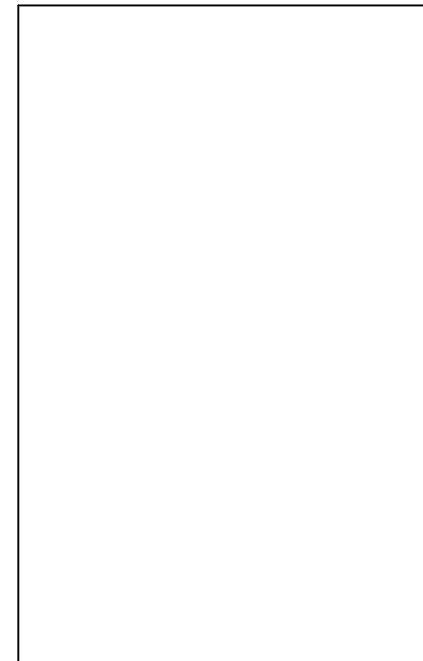

DR2410
Door Poly, Reinforced, 60" x 96"

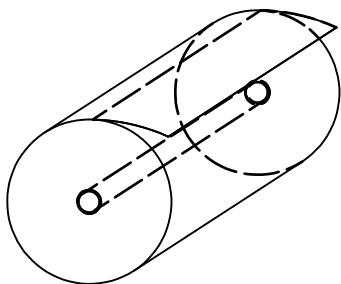

SC303890K-HGLS
Shade 30' x 38' 90% Blk. HGLS

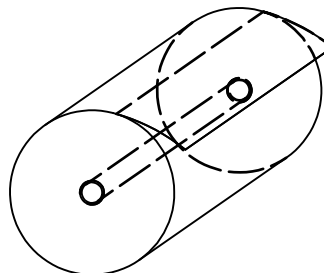

KHR36-20TW
36' x 38' White Top

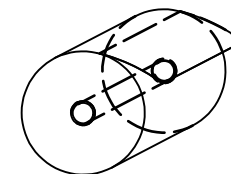

GMENDW
14' x 23' White End Frame Poly

AM-230711

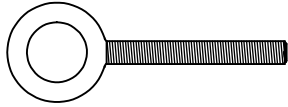

NB1622
Eye Bolt, 3/8"-16 unc x 3"



NB1958
Hairpin 1-5/8" x .093 zp.



NB1603
Screw, #10-16 x 1" SD Pan Head



NB1809
Self-Drill Screw
1/4-14 x 1"

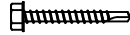

NB1805
Self-Drill Screw
#12-14 x 1-1/2"



NB1807
1 1/2" x #9 Woodtight

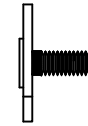

FT2570
Stop Tab

3/8" Hardware



NB1841
Carriage Bolt 3/8" x 3" G5



NB1874
Hex Nut 3/8" zp.



NB1810
Lag Screw, 1/4" x 1-1/2"

5/16" Hardware



NB1816
Carriage Bolt, 5/16" x 2-1/2"



NB1942
Hex Bolt 3/8" x 2" zp. G5



NB1863
Flat Washer 3/8" zp.



NB1749
Lock Nut 3/8" zp. Nylon Insert

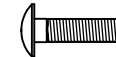

NB1832
Carriage Bolt 5/16" x 1-1/4" G5



NB1872
Hex Nut 5/16" zp.

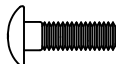

NB1837
Carriage Bolt 3/8" x 1-1/4" G5



NB1864
Lock Washer 3/8" zp.



NB1886
Flat Washer 5/16" zp.



NB1862
Lock Washer 5/16" zp.

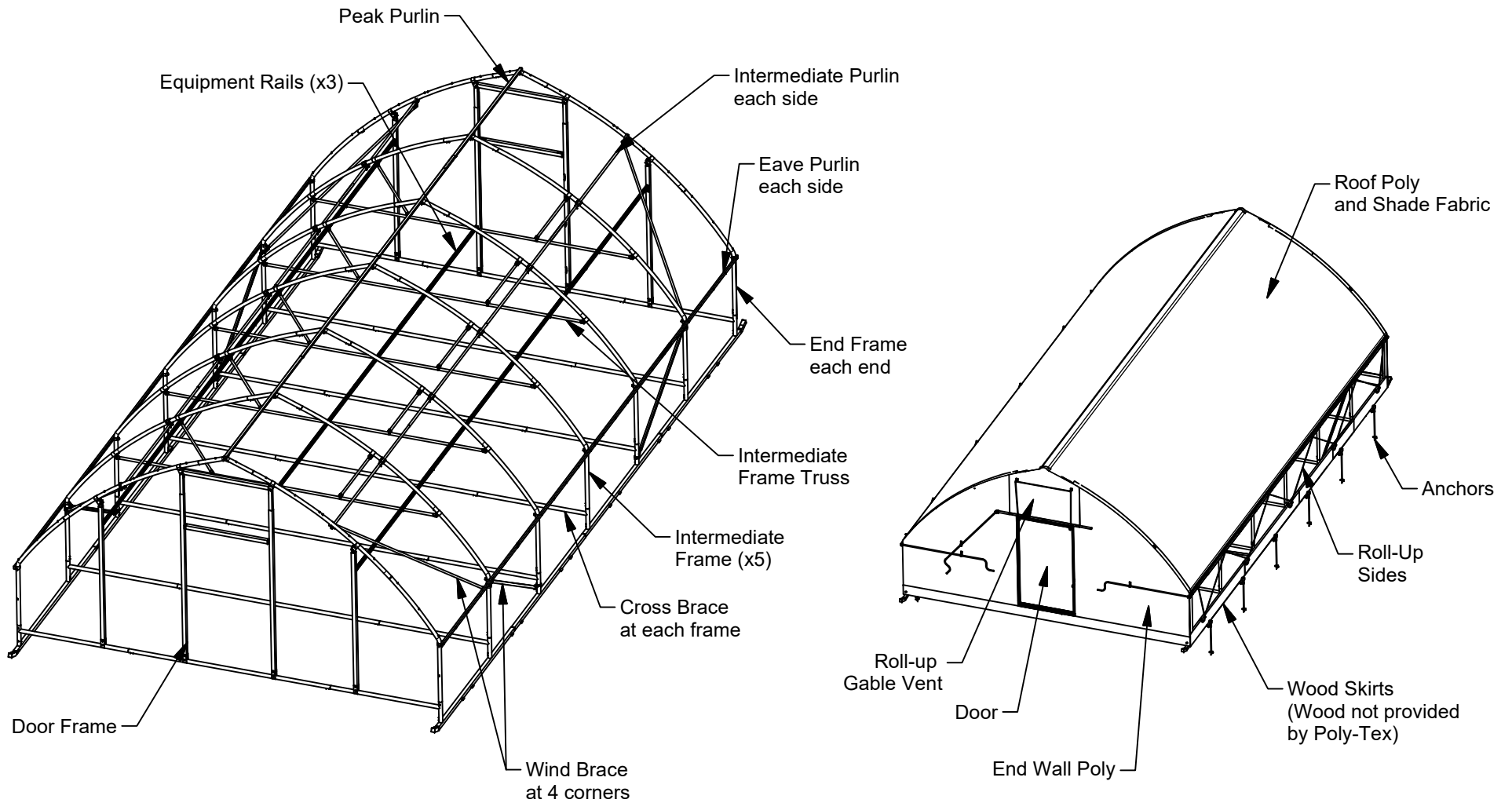

Skid Assembly

1. Assemble Skid Rails using 1x HT2104 and 2x HT2105 for each side. Ensure that the hold down tubes face the outside of the structure. (see Detail A)
2. Install 1x HTA1034 at each end of rail. secure connections using 2x NB1809 screws. Drive screws from the inside of the structure towards the outside. (see Detail B)

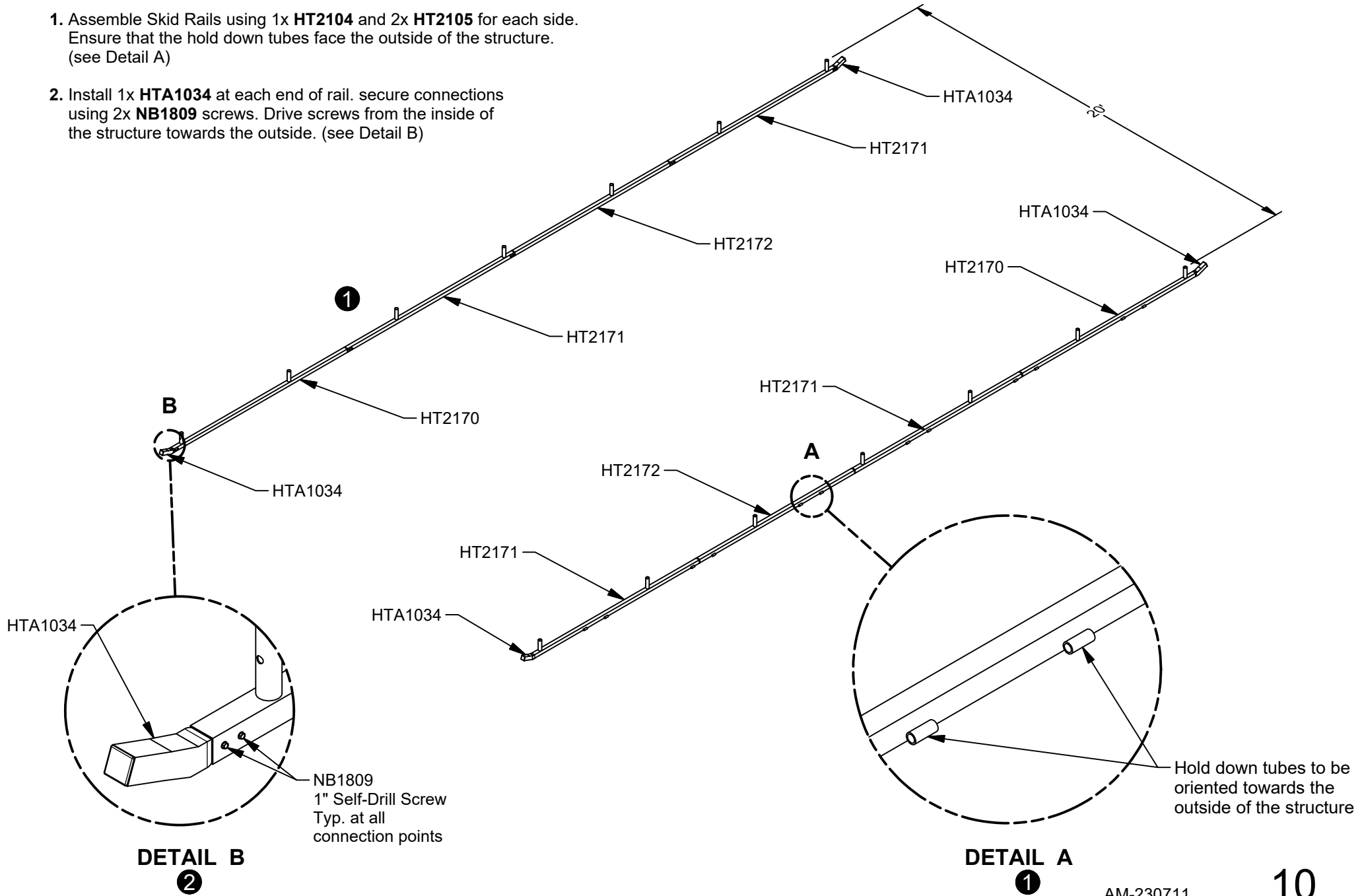

Cross Brace Assembly

Note: if construction space is limited, consider assembling the frames as shown on the next two pages before assembling the cross braces.

1. Place cross braces between Skid Rails. Do not secure connections to Skid yet.
2. Ensure Skid Rails are square by measuring diagonally across the structure from corner to corner. When the two measurements are equal the structure is square.
3. Assemble cross braces using 2X **FC1001** and 1X **HP3557**. secure each connection with 2X **NB1809** screws. Screws should be driven so they will be on the bottom of the assembly when it is placed over the Skids. (see Detail A)
4. Secure each connection with 2X **NB1809** screws. Screws should be driven from the inside of the structure. (see Detail B).

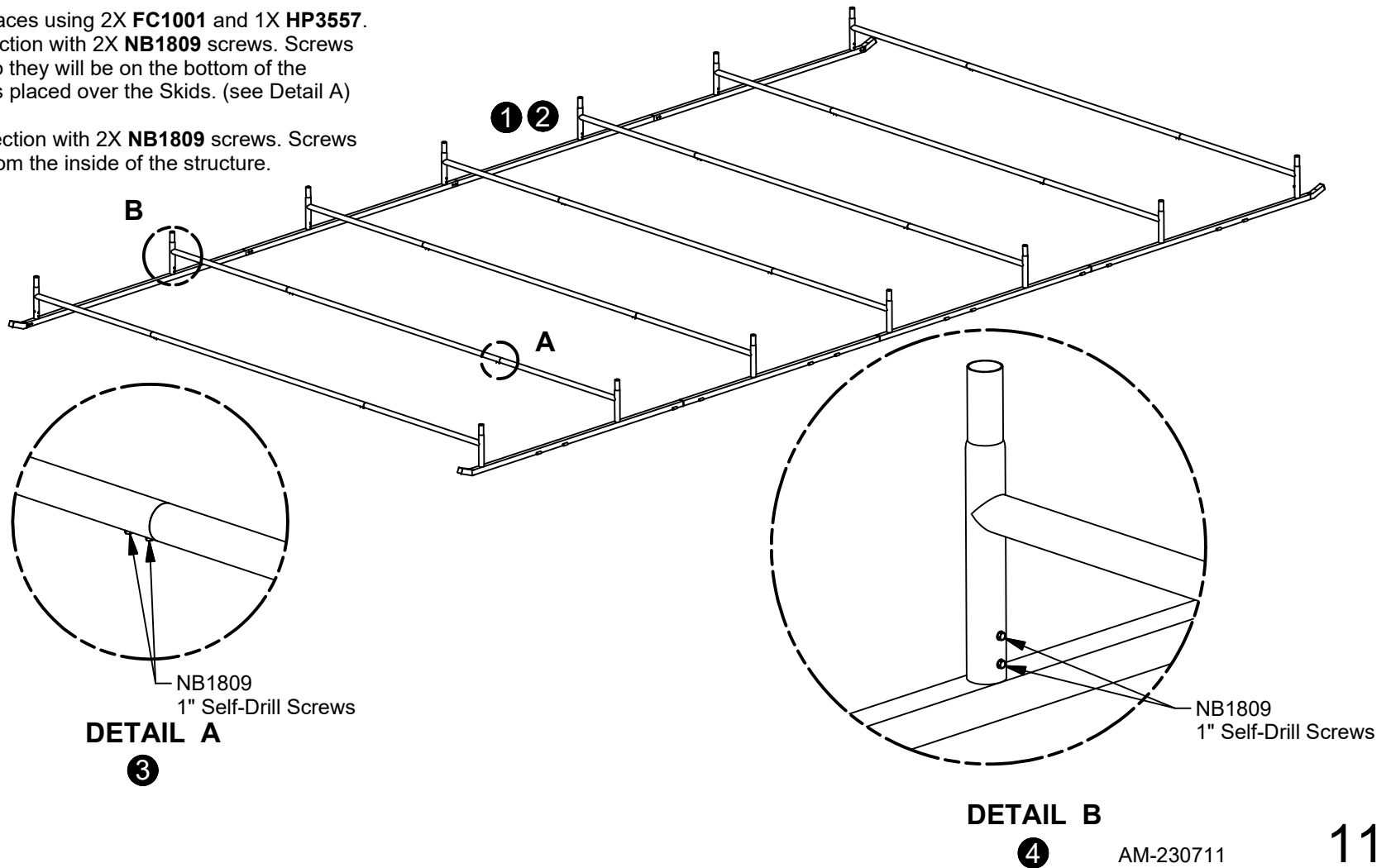

Basic Frame Assembly

1. On a level surface assemble 7 Basic Frames using 2X HP3556, 2X FC1002, 1X FC1003.
2. Center to center dimension of base should be 20'-0". Brace base to hold 20'-0" dimension while completing next step. If this dimensions isn't maintained, attachment of the frames will be difficult.
3. For 2 End Frames: Install 2X NB1809 self drilling screws at each joint. The screws should be driven from the inside of the structure towards the outside (see Detail A). For the other 5 frames, do not install the NB1809 self-drilling screws until the intermediate assembly shown on the next page is in place.

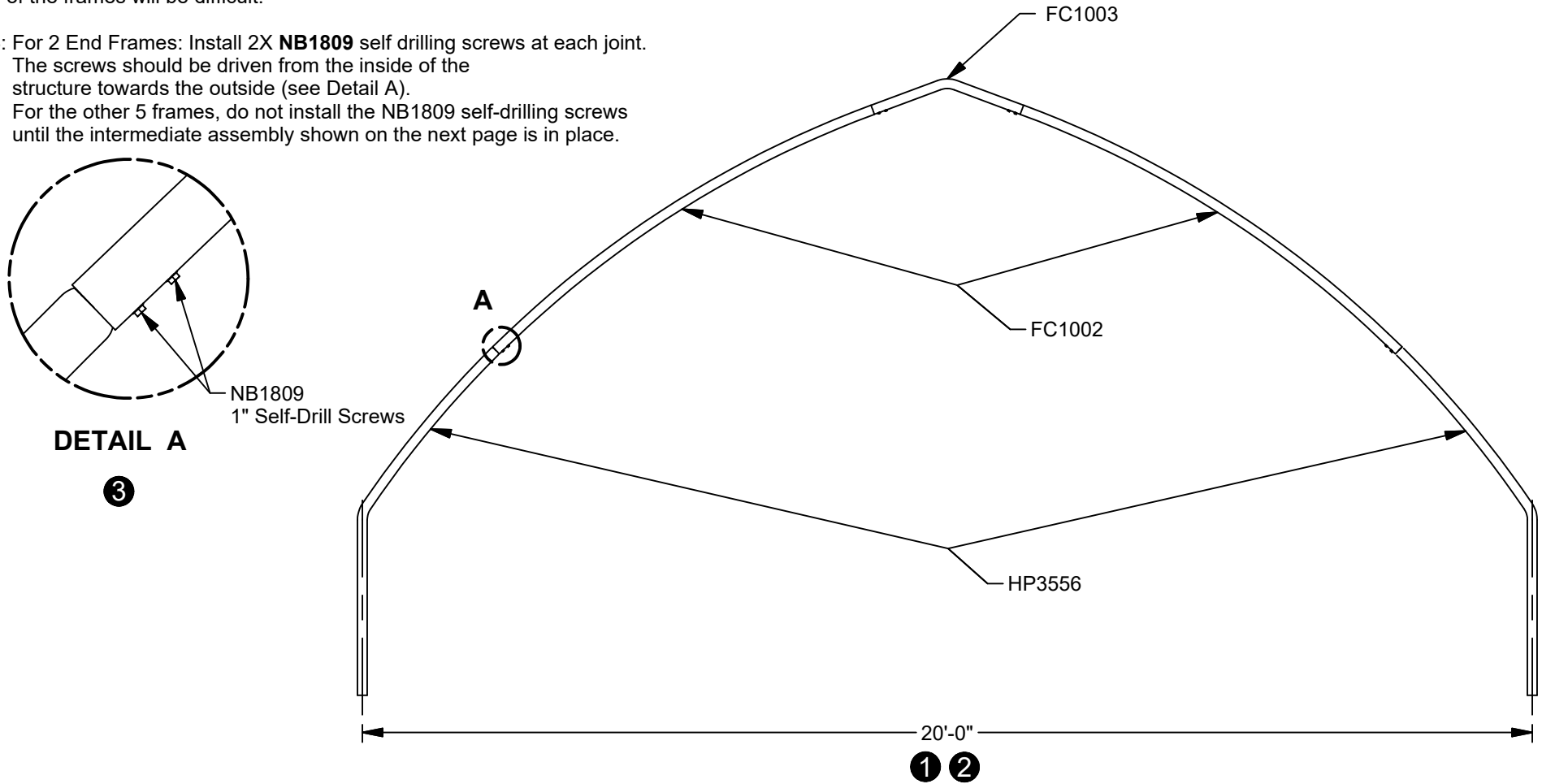

Intermediate Frame Assembly

5 of the Basic Frames assembled previously will be modified to Intermediate Frames. Assemble on a flat level surface. Ensure that frame measures 20' from tube center to tube center before tightening any hardware.

Important: All components attached to clamp fittings must be mounted on the outside of the tabs. NEVER install components between the tabs.

- Slide one **FT4041** onto each **HT1015** and **HT1016** for use in a step 7.
- Join **HT1015** and **HT1016** using 2X **NB1809** (see Detail A).
- Slide 4X **HY2027** onto the Basic Frame, two per side for use in steps 6 and 7.
- Install **HT1015/HT1016** assembly in Basic Frame (from prior step) using 2X **HY2027** and hardware (see Detail B).
- Ensure **HT1015/HT1016** assembly is level in frame by measuring from top of **HY2027** fitting to the break in the Basic Frame centered underneath **HY2027**. This measurement should be the same on both sides of the frame (see Detail C).
- Install 2X **HT1023** using previously placed **FT4041** and **HY2027** (see Detail D). To ensure parts are placed symmetrically ensure **FT4041** is the same distance from the end of the **HT1015/HT1016** assembly on both sides.
- Install 2X **NB1809** self drilling screws at each joint in the basic frame. The screws should be driven from the inside of the structure towards the outside.

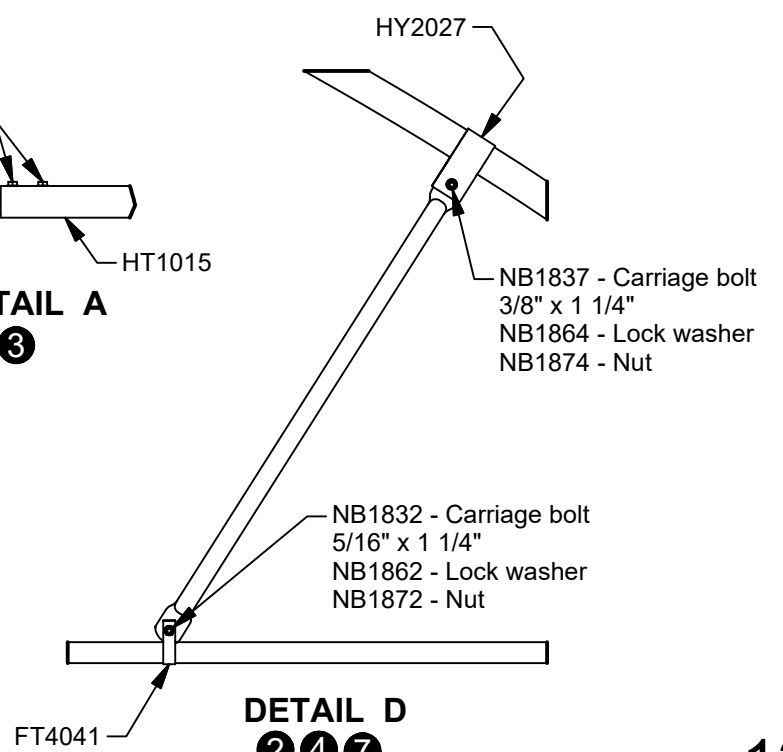
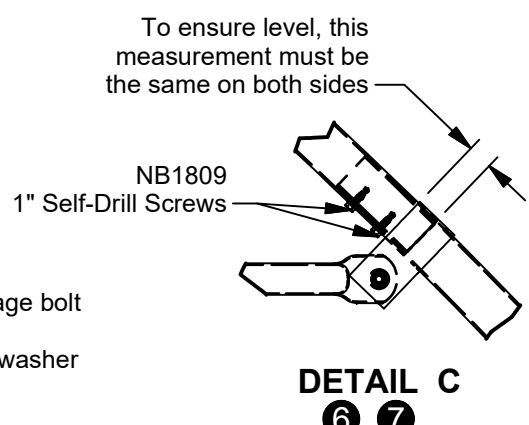
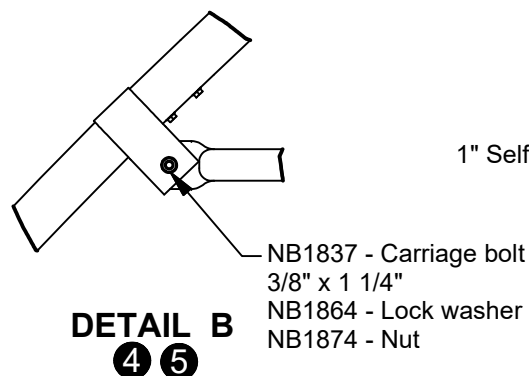
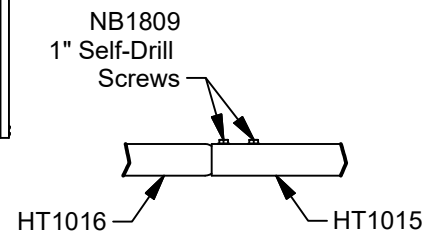
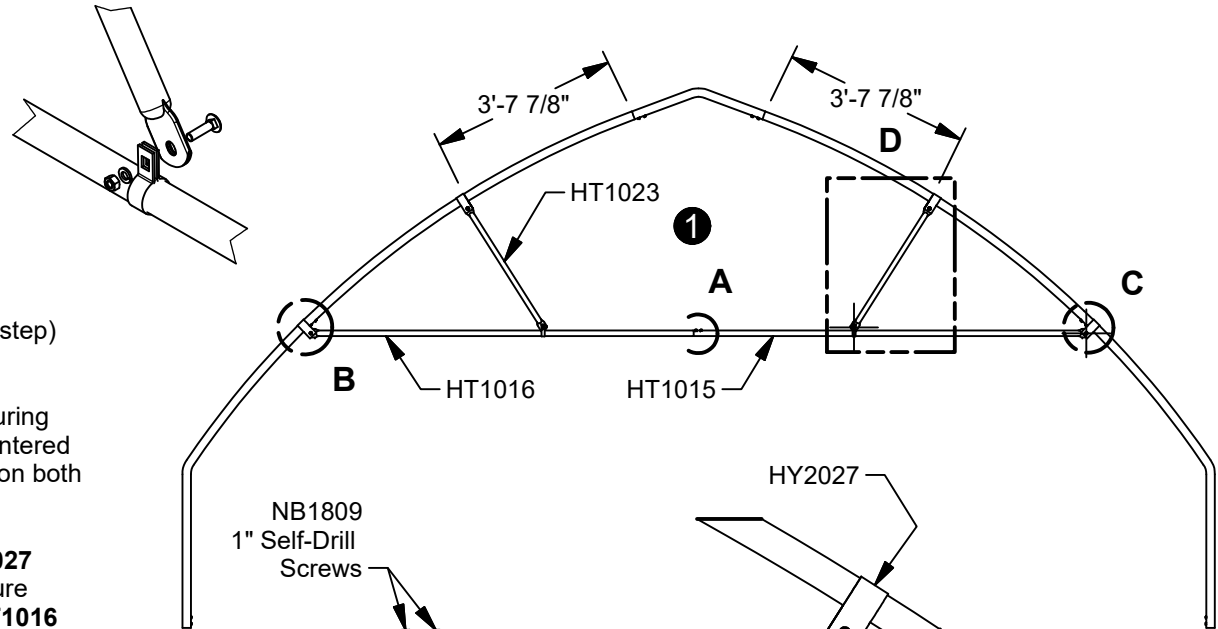

Frame and Windbrace Installation

Note: Do not tighten bolts until all parts are placed, plumbed and leveled.

1. Place 1X Basic Frame on first stubs of the Skid Rails.
2. Place an Intermediate Frame on the second set of stubs.
3. Install **HP3506** between the intermediate frame and the next stub using 2X **FT2079** at each end. The lower **FT2079** pair should be 3 7/8" above the Skid (see Detail A and B).
4. Install **HP3503** between the intermediate frame and the end frame by placing 2X **FT2079** on top of the 2X **FT2079** installed at the top of **HP3506** in the previous step. Install 2X **FT2079** at the top end of **HP3503** (see Detail B and C).

Important: Make sure screws and ends of carriage bolts do not face outwards to avoid damage to the poly covering. All components attached to Speed Hooks must be mounted on the outside of the tabs. NEVER install any components between the tabs.

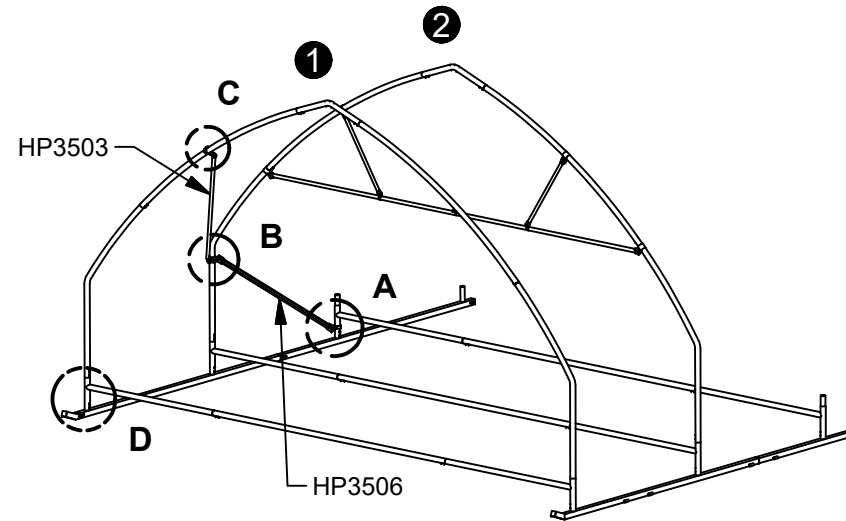

Note: It may be necessary to slightly bend the tip of **HP3503** for the best possible connection.

5. Plumb and level frames. Tighten bolts. Install 2X **NB1809** at the frame connections (see Detail D).
6. Install remaining Intermediate Frames and Basic Frame.
7. Repeat Wind Brace install on remaining corners.

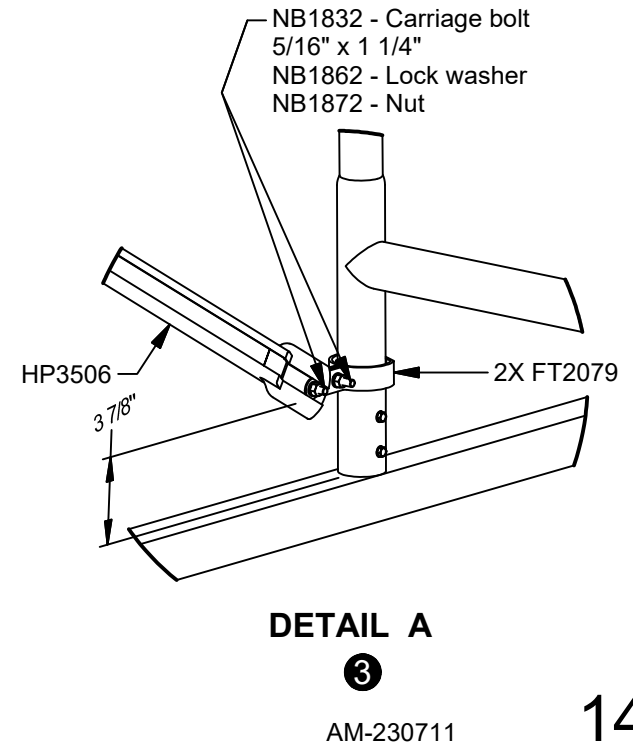
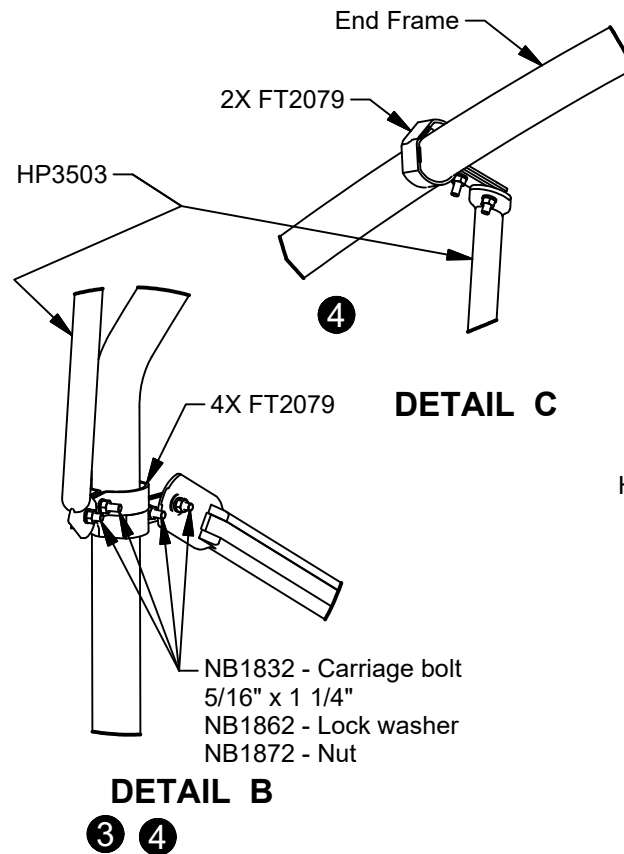
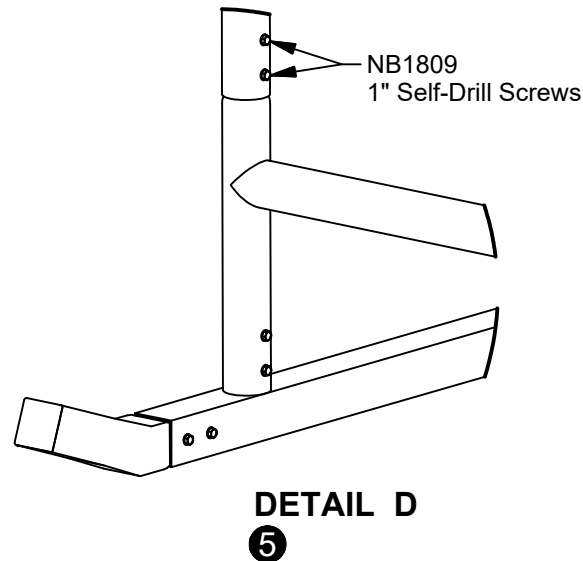

Ridge & Eave Purlin Installation - Part 1

1. Install first Eave Purlins **RR2109**, flush with end frame, 4' 1 1/4" from lower face of Skid Rail. Reference Detail A for connection to end frame, and Detail B for connections to intermediate frames.
2. Install first Peak Purlin **RR2109** at peak. Reference Detail A for connection to end frame, and Detail B for connections to intermediate frames.
3. Plug open ends of **RR2109** with **FB2527** plugs (see Detail A).

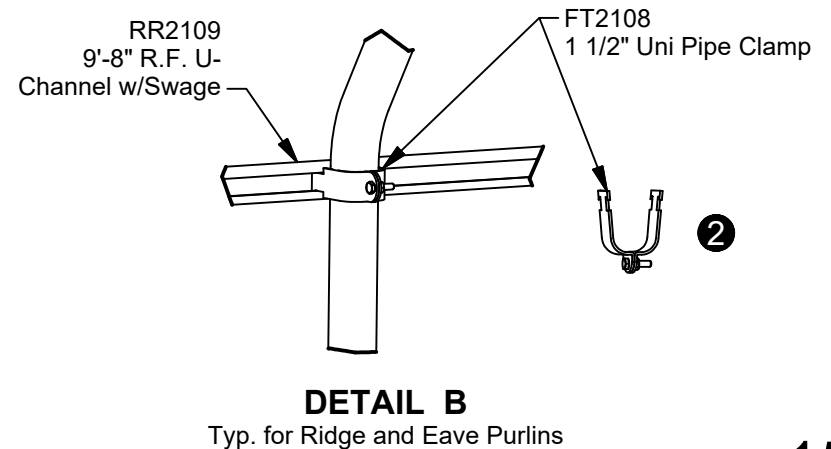
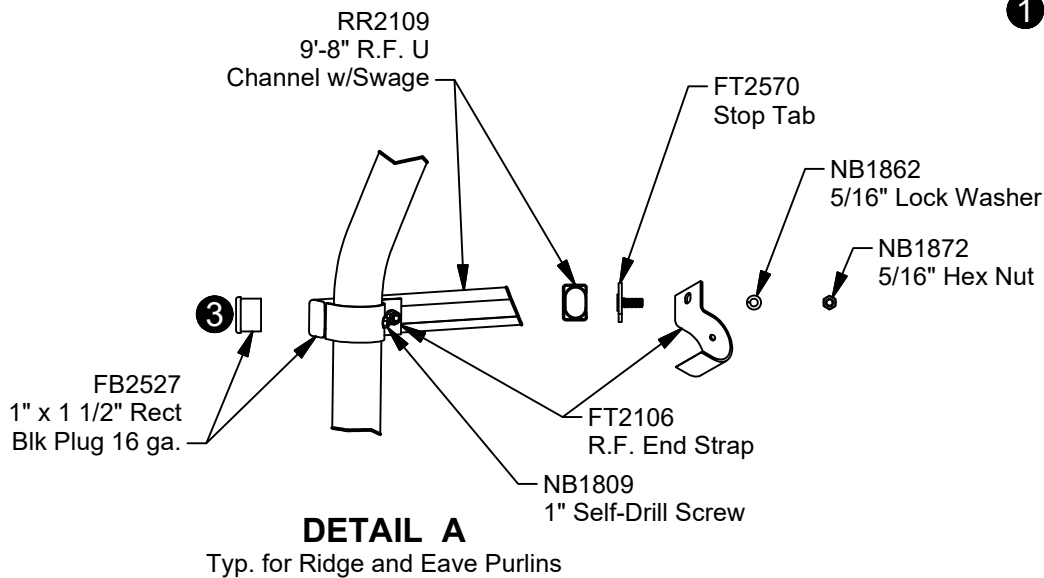
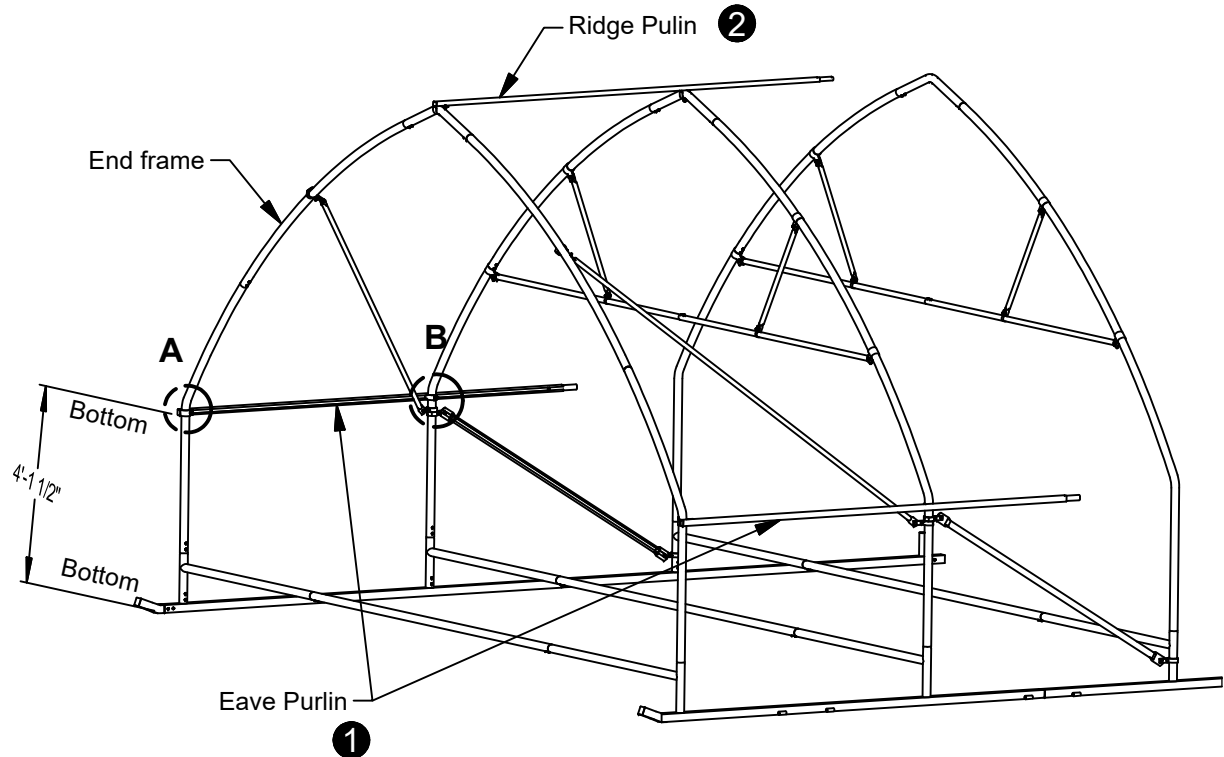

Ridge & Eave Purlin Installation - Part 2

1. Continuing from Ridge & Eave Purlin Assembly - Part 1. Add additional purlins **RR2109** to extend past end frame. Join Sections of **RR2109** using 1X **NB1809** (see Splice Connection Detail).
2. Use **FT2108** for purlin connections to intermediate frames (Detail C)
- 3 Cut Purlins flush with End Frame. (see Detail D). Connect Purlin to End Frame with **FT2106** and plug ends of **RR2109** with **FB2527**.

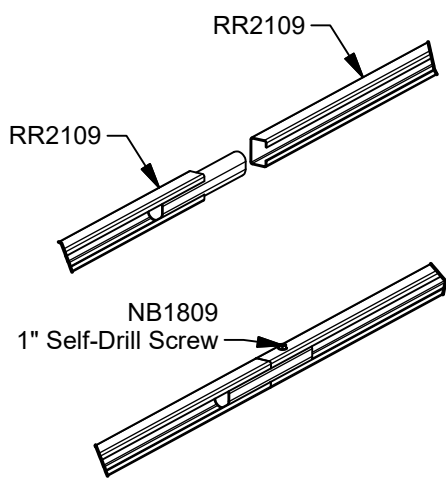
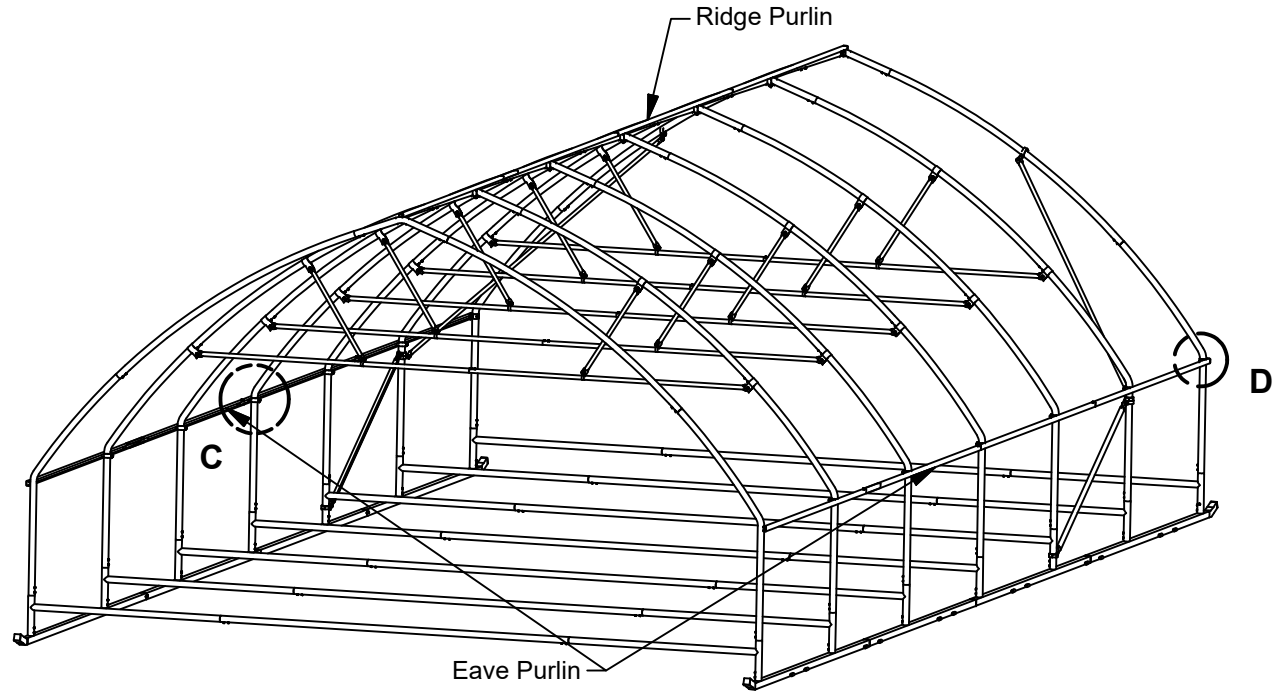

**SPLICE CONNECTION
DETAIL**

1

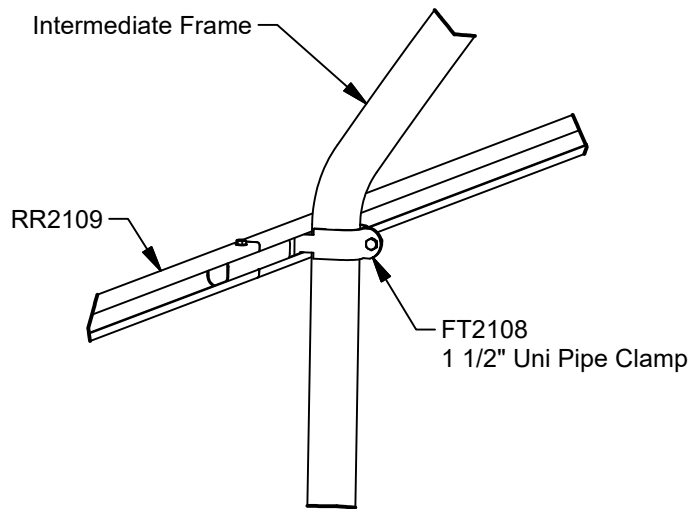

DETAIL C

Typ. for Ridge and Eave Purlins

2

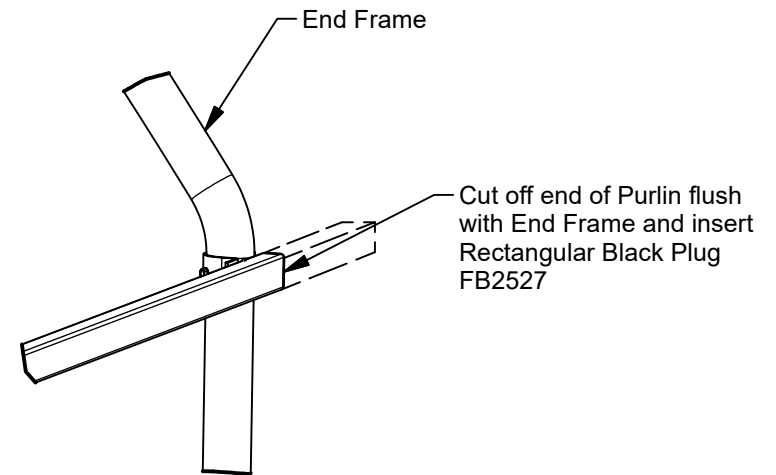

DETAIL D

3

Intermediate Purlin Installation - Part 1

1. Install first piece of **HP3340** flush to outside of End Frame approx. 4' 2 7/8" from break at the top of **FC1002**. Connect **HP3340** to End Frame using **KH1000**. Install **RS5000** Plug into **HP3340** (see Detail A).
2. At intermediate frames, use **FT4040** to attach the **HP3340**. Maintain a consistent distance between the **HP3340** and the ridge to ensure the purlins run parallel.
3. Repeat process for opposite side Intermediate Purlin.

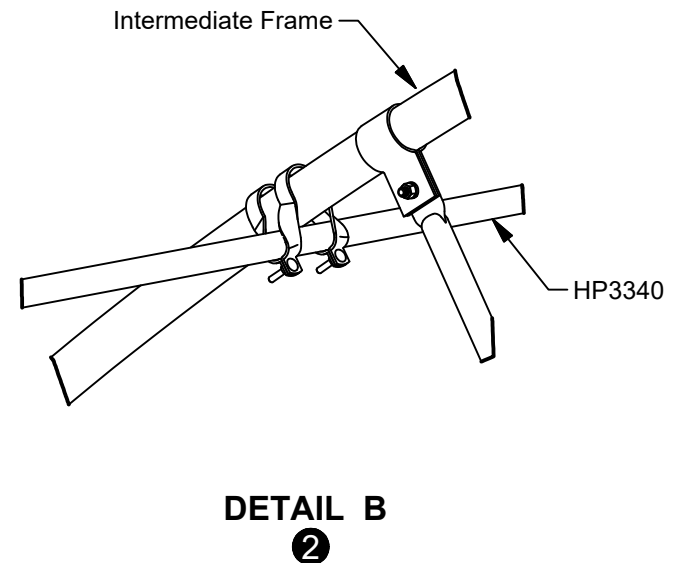
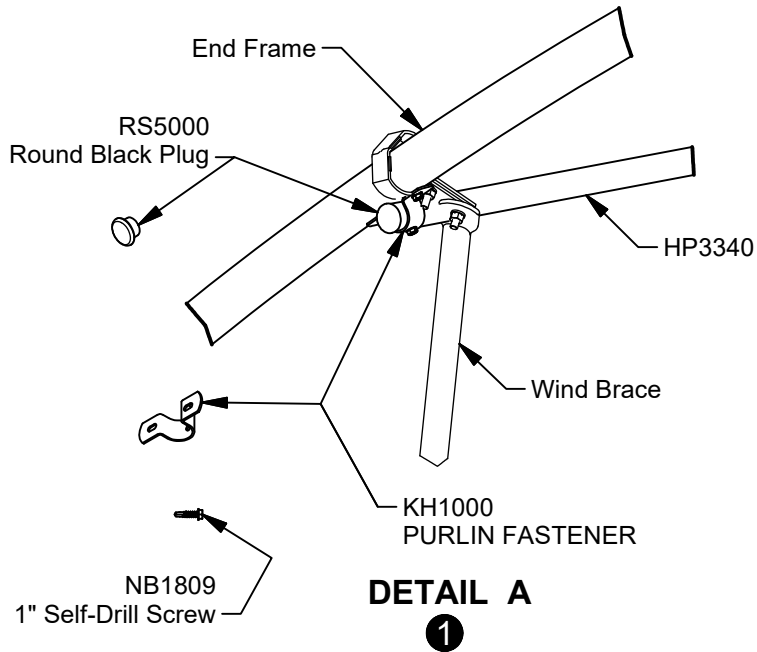
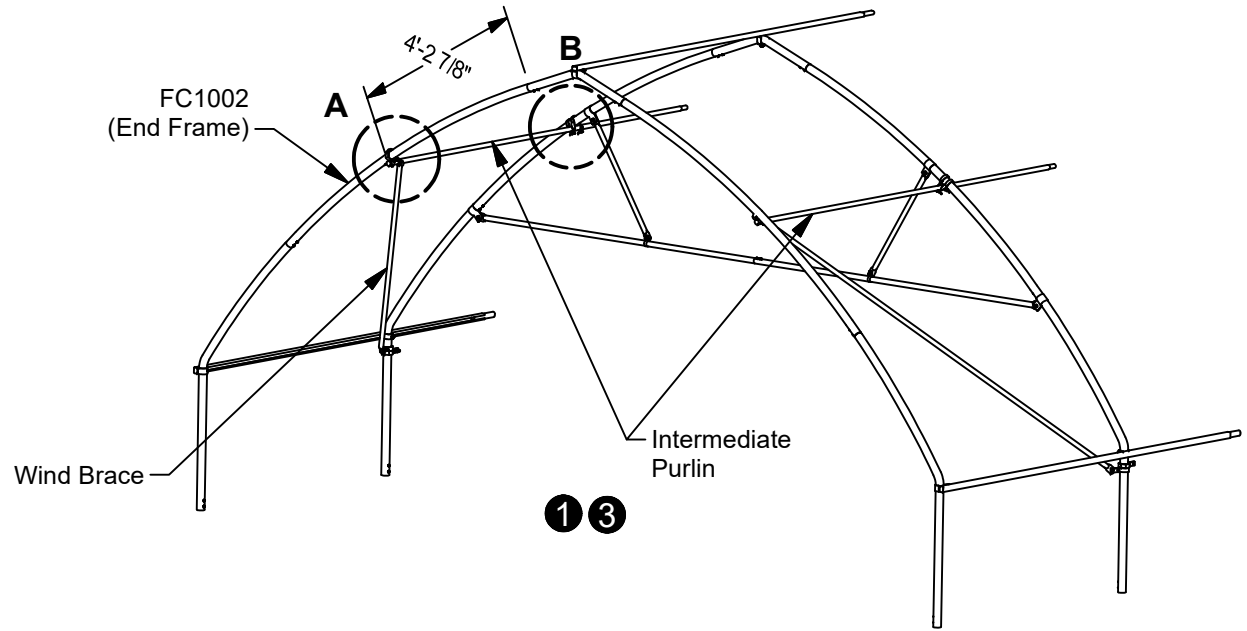

1. Continuing from Intermediate Purlin Assembly Part 1 - Join sections of **HP3340** using 1X **NB1809** (see Detail C).
2. Attach Intermediate Purlins to Intermediate Frames using **FT4040** (see Detail B).
3. Cut Purlin flush with End Frame. (see Detail D). Connect Purlin to End Frame with **KH1000** and plug ends of **HB3340** with **RS5000**.

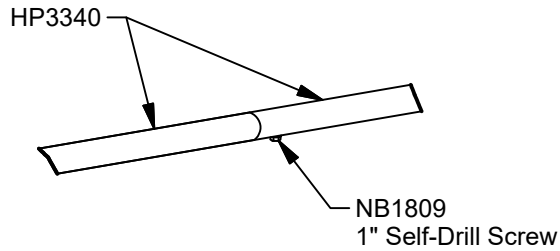
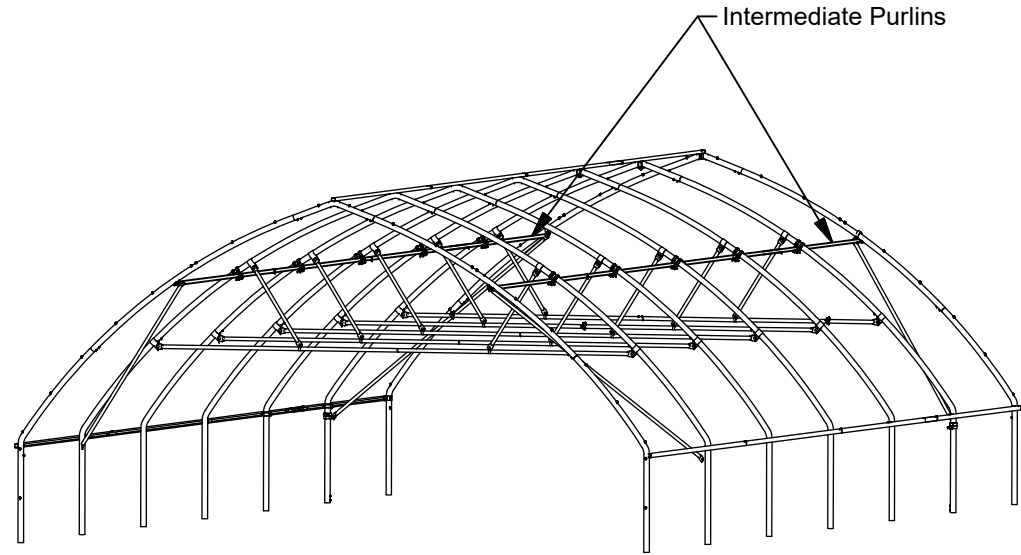

DETAIL A

1

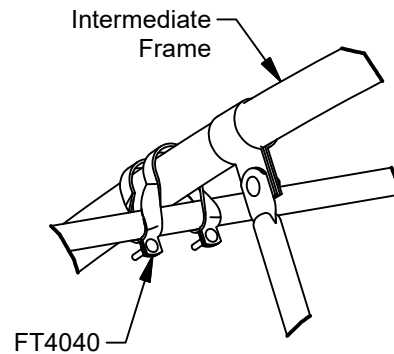

DETAIL B

2

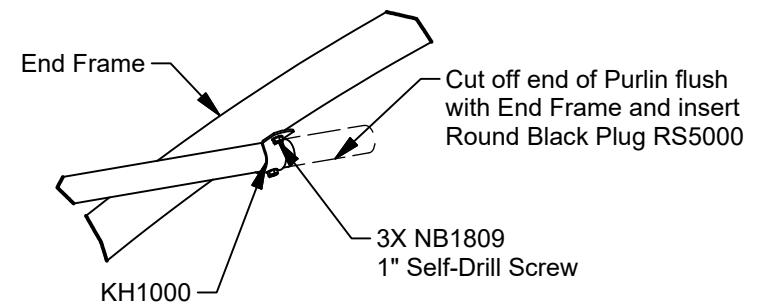

DETAIL C

Wind Brace Removed For Clarity

3

End Frame Installation

To form the adjustable end frame components, slide **HT2143** into **DR5082**, and slide **HT1076** into **HP3420**.

1. Install **HP3420** and **HT1076**, 4'-0" on center from outside wall of structure, using **HY2026** at top and bottom (see Detail A).
2. Secure **HP3420** to **HT1076** with 2X **NB1809** (see Detail A).
3. Build door frame with 2X **DR5082** and 1X **DR5073**. Secure connection with 2X **NB1809** at each connection. Drive **NB1809** from top of Header downward (See Detail D).
4. Install door frame using 4X **HY2026**. Ensure door is centered in End Frame before tightening down (see Detail B & C)

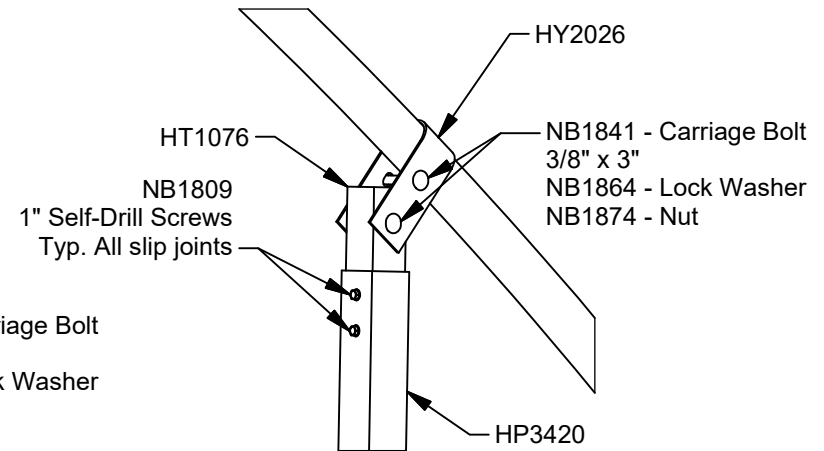
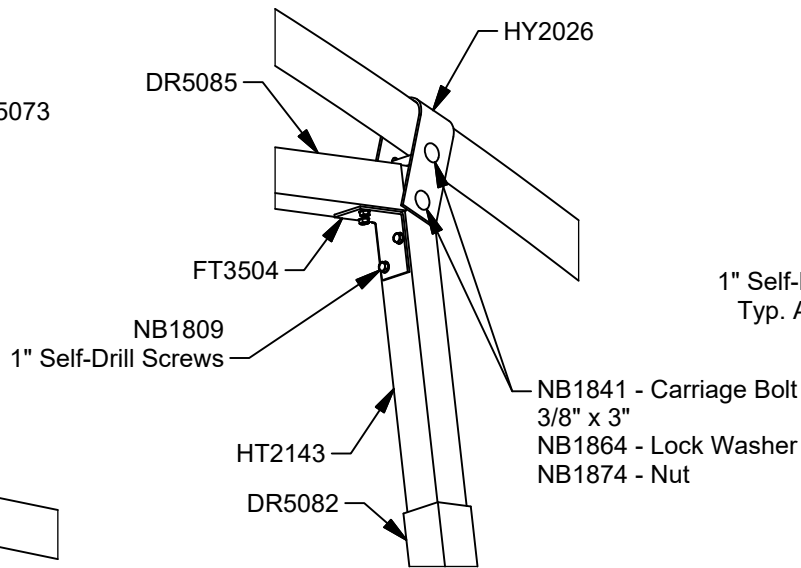
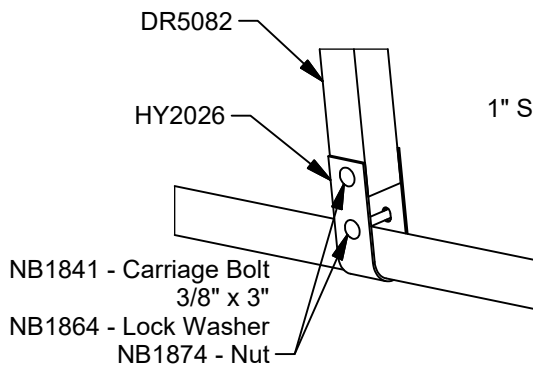
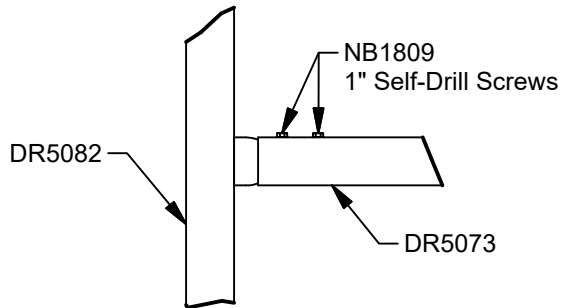
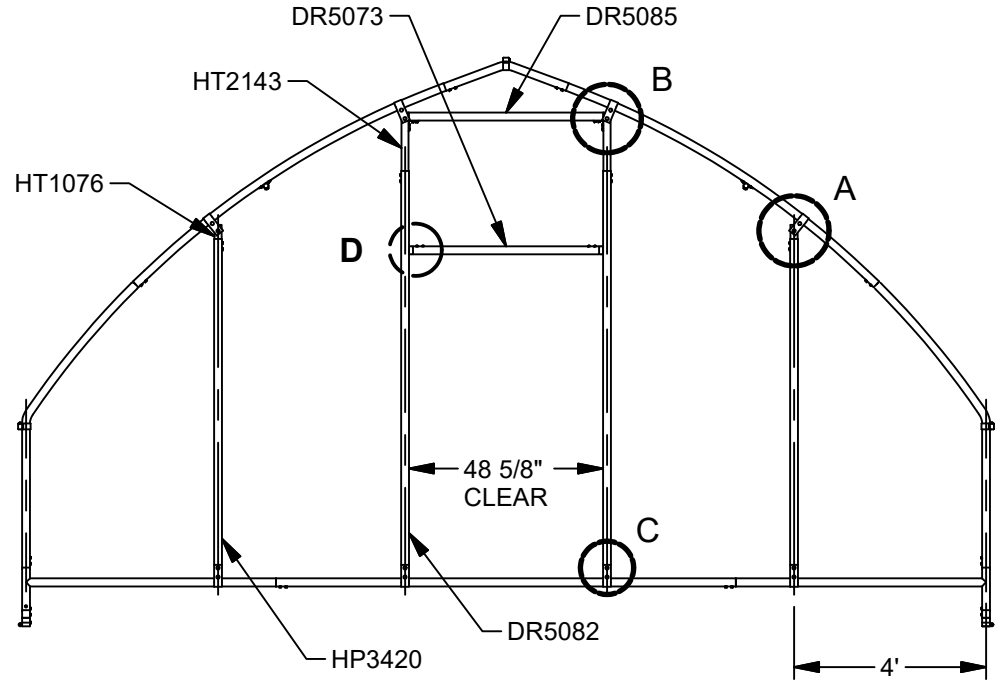

Equipment Rail Installation

Equipment Rails are installed on top of the frame trusses with the open side of the roll-formed channel up.

1. Install 2X Outer Equipment Rails using **RR2109** on top of Intermediate Frame Trusses. Ends will connect to End Frame verticals with **FT1990** (see Detail A). Trim Equipment Rail **RR2109** as required. Connect **RR2109** Pieces as shown in Detail B.
2. Install 1x Center Equipment Rail using **RR2109** on top of Intermediate Frame Trusses. Ends will connect to the Intermediate Frame Truss using **FT2117** (See Detail C). Trim Equipment Rail **RR2109** as required. Connect **RR2109** Pieces as shown in Detail B.
3. Attach equipment rails to Intermediate Frame Trusses using **FT2119** (See Detail B).

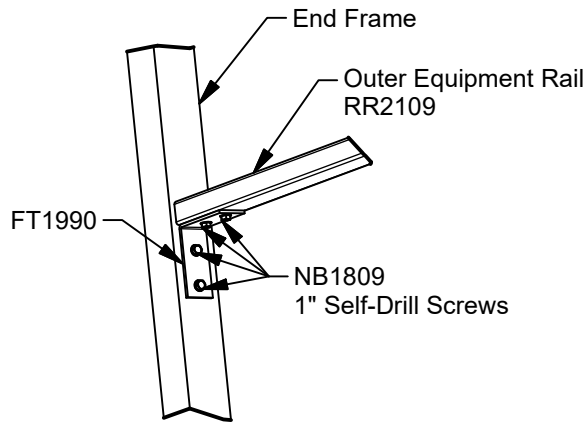
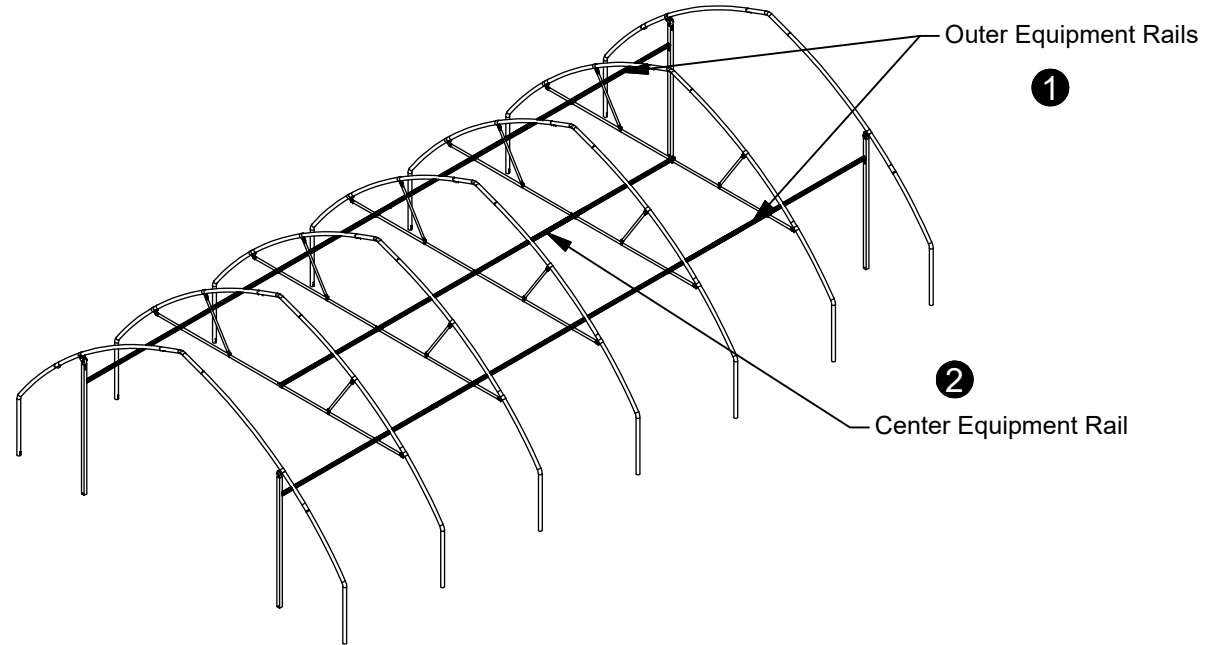

DETAIL A
①

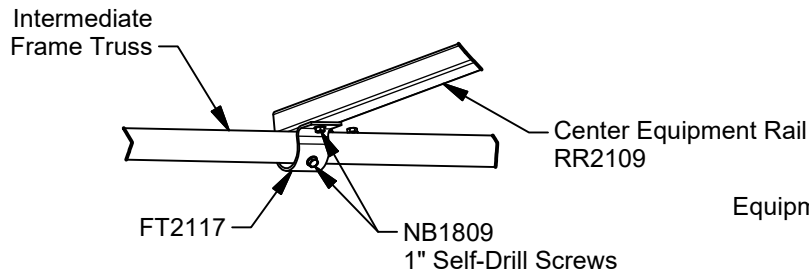

DETAIL C
②

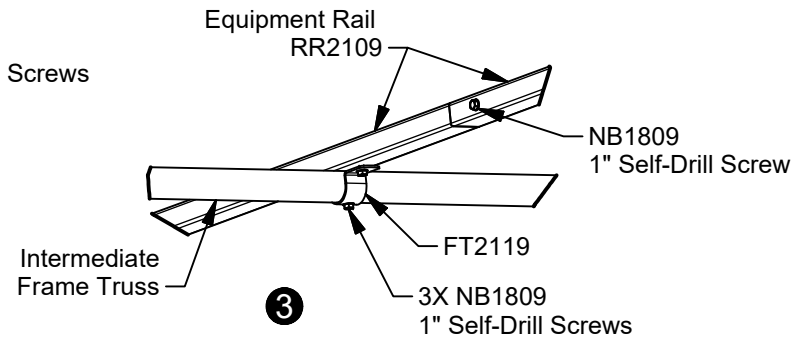

DETAIL B
③

Wood Skirt Installation

1. Install 2 x12 Skirt along rails on each side of structure. Skirt will sit on top of the holddown tubes during install.
2. Attach Skirt 2 x12 at End Frames using **FT2106** (see Detail A)
3. Attach Skirt 2 x 12 at Intermediate Frames using **FT2057** (See Detail B)
4. At each corner, cut 2 x 6 filler board to fit between 2 X12 Skirt and Eave Purlin (see Details A and C).
5. Attach the filler board top using **FT2106** (see Detail C)
6. Attach the filler board bottom using **DR7033** (See Detail A)

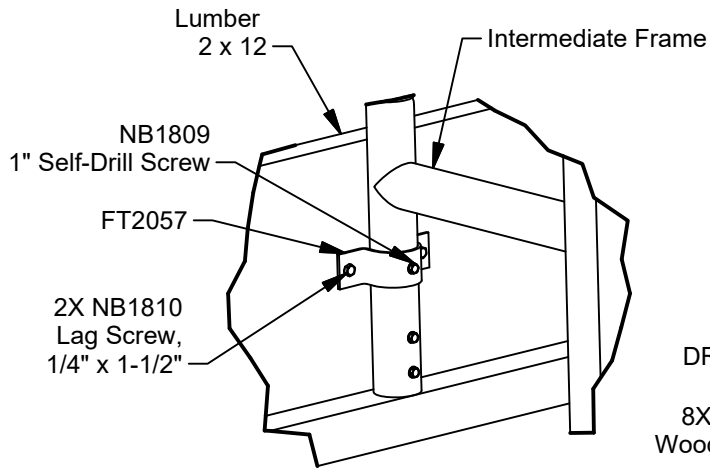
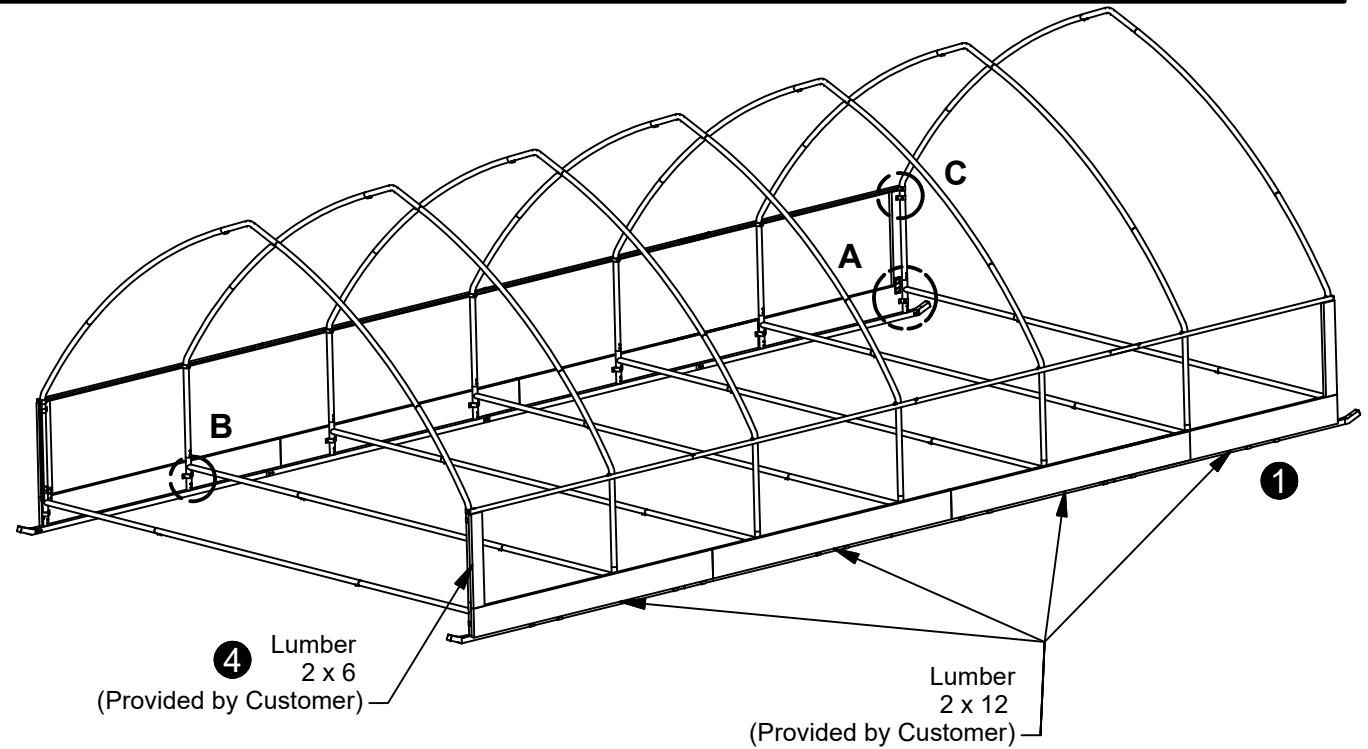

DETAIL B

3

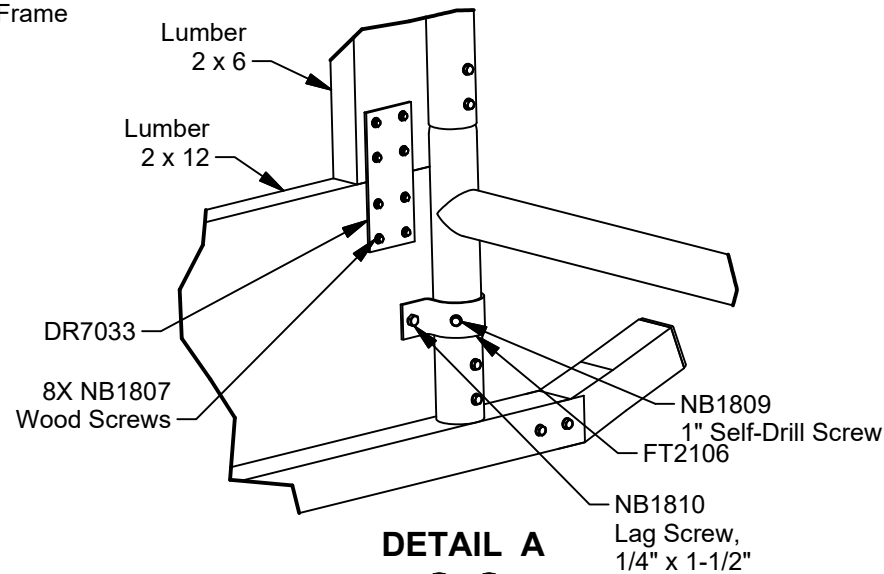

DETAIL A

2 6

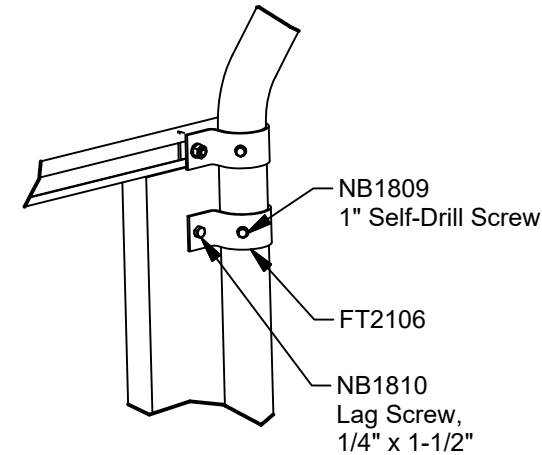

DETAIL C

5

AM-230711

Netting and Wiggle Wire Base

Install **WWBASE9** along indicated sections. Poultry Netting and Ground Skirt are held in place with **WWBASE9** where possible. All **WWBASE9** will be secured using **NB1809** at 18" spacing.

1. Install **WWBASE9** along Eave Purlin. Netting can be secured along inside of Wood Skirt and filler using staples.
2. Install **WWBASE9** over the End Frames. Start at Eave Purlin and bend to match profile. Longer, gentle bends are preferable to sharp bends (see Detail A).
3. Install Ground Skirt and **WWBASE9** across bottom face of the End Frames.
4. Install **WWBASE9** on face of End Frame vertices. To avoid puncturing Poly at the gable, stop **WWBASE9** several inches below the roof line (see Detail B).
5. Install **WWBASE9** on door header (see Detail B).

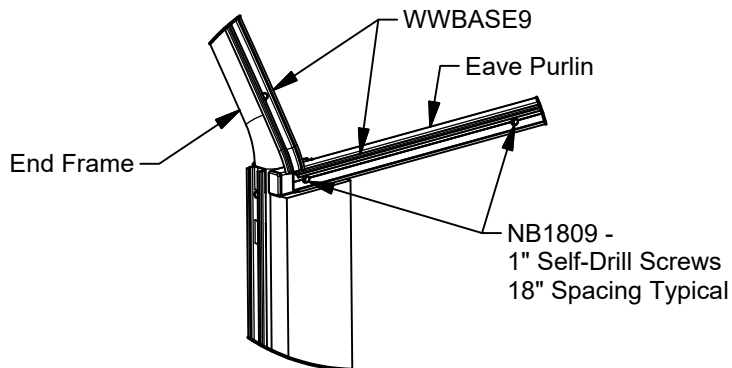
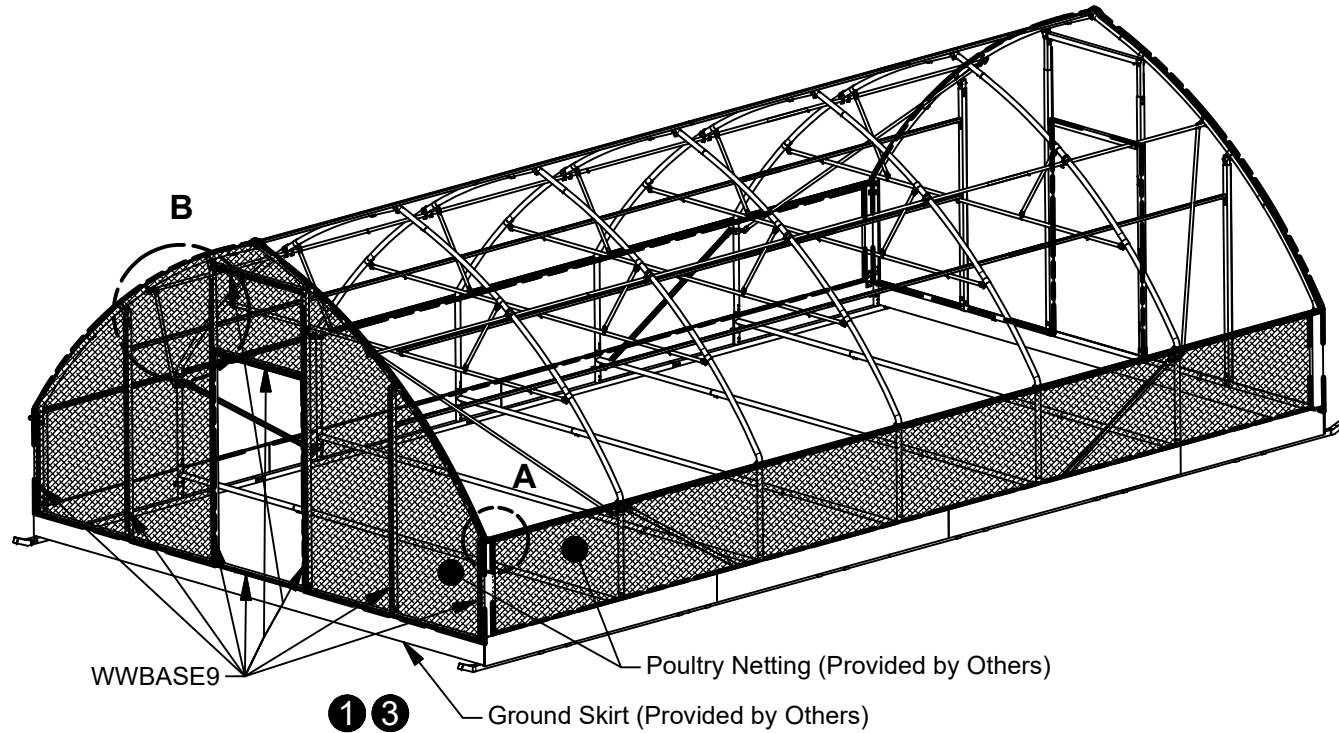

DETAIL A

2

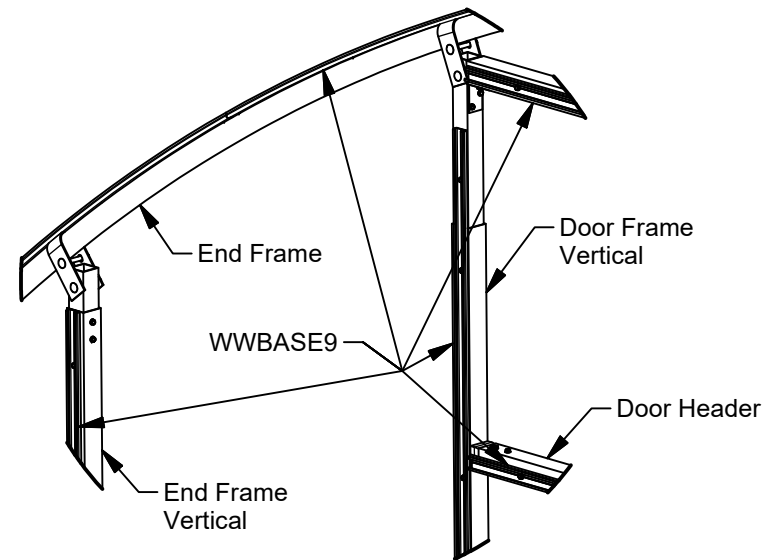

DETAIL B

4 5

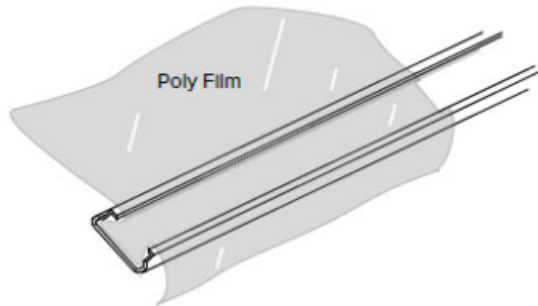

1 Carefully begin to fold the Poly Film into the Wiggle Wire Base while keeping a constant tension on the Poly Film to avoid wrinkles.

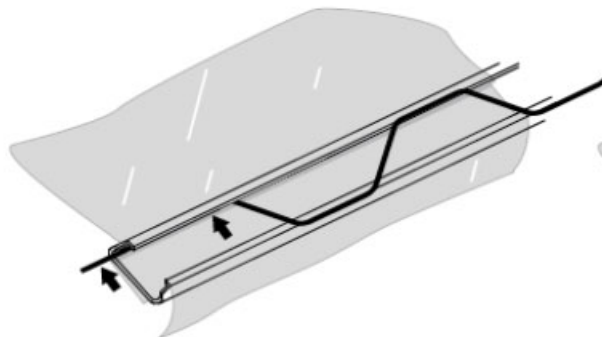

2 Insert one end of the Wiggle Wire as shown while maintaining tension on the Poly Film.

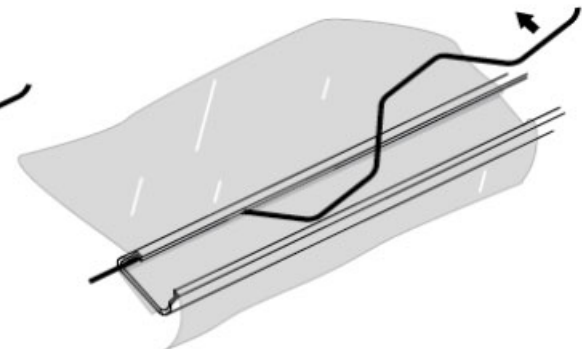

3 Bend the Wiggle Wire up just enough to clear the edge of the Wiggle Wire Base.

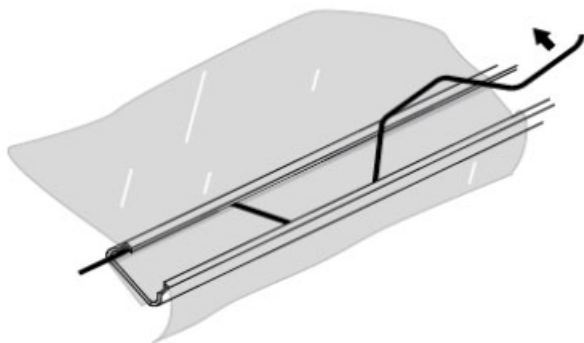

4 Continue feeding the Wiggle Wire into the Base, keeping the Poly Film under constant tension to avoid wrinkles.

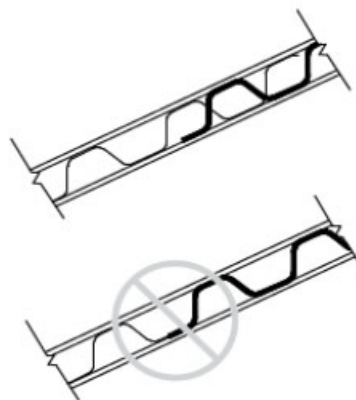

Overlap previous Wiggle Wire when adding a new Wiggle Wire piece.

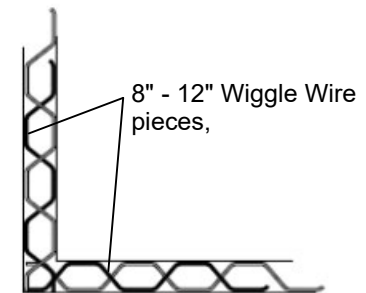

5 Reinforce all corners with additional 8\" -12\" sections of Wiggle Wire.

1. Unroll End Poly (**GMENDW**) along end of structure.
2. Locate center of longer edge and align with peak of structure.
3. Begin installing Poly by starting at the peak and working down hill keeping the Poly tight along **WWBASE9** as **WIGLWIRE** is installed.
4. Install **WIGLWIRE** on End Frame verticals.
5. Install **WIGLWIRE** at base of End Frame.
6. Using a short piece of **WIGLWIRE** reinforce all corners.
7. Using a blunt object check that all **WIGLWIRE** is securely in the **WWBASE9**.
8. Trim Poly around perimeter, door and vent.

Note: As an alternative method of installation, the end wall poly can be cut and installed as two separate, smaller pieces, one on each side of the door.

Note: Leaving extra Poly may make reinstallation easier if Poly needs to be removed.

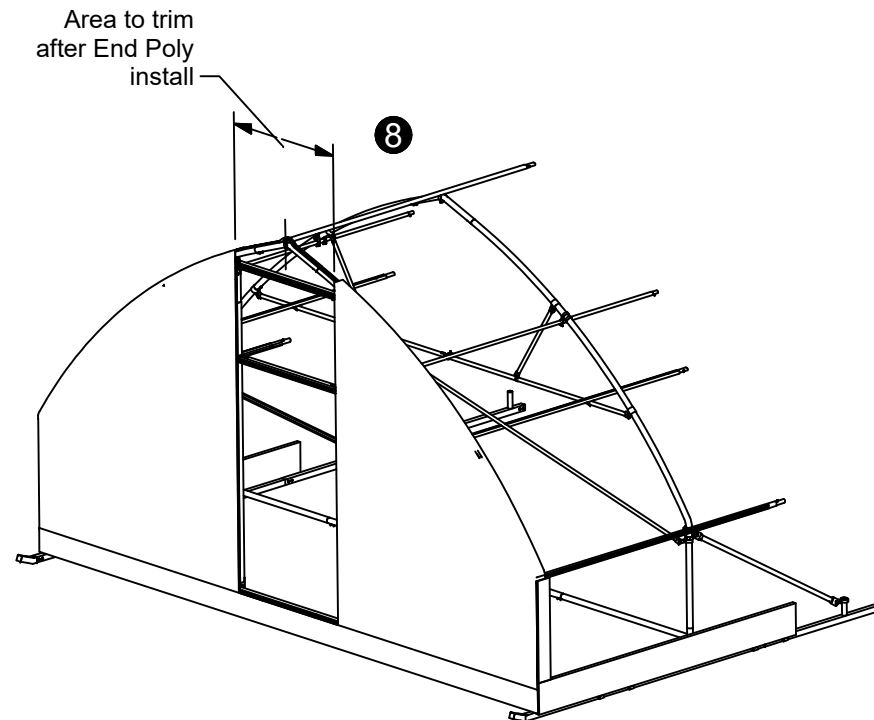
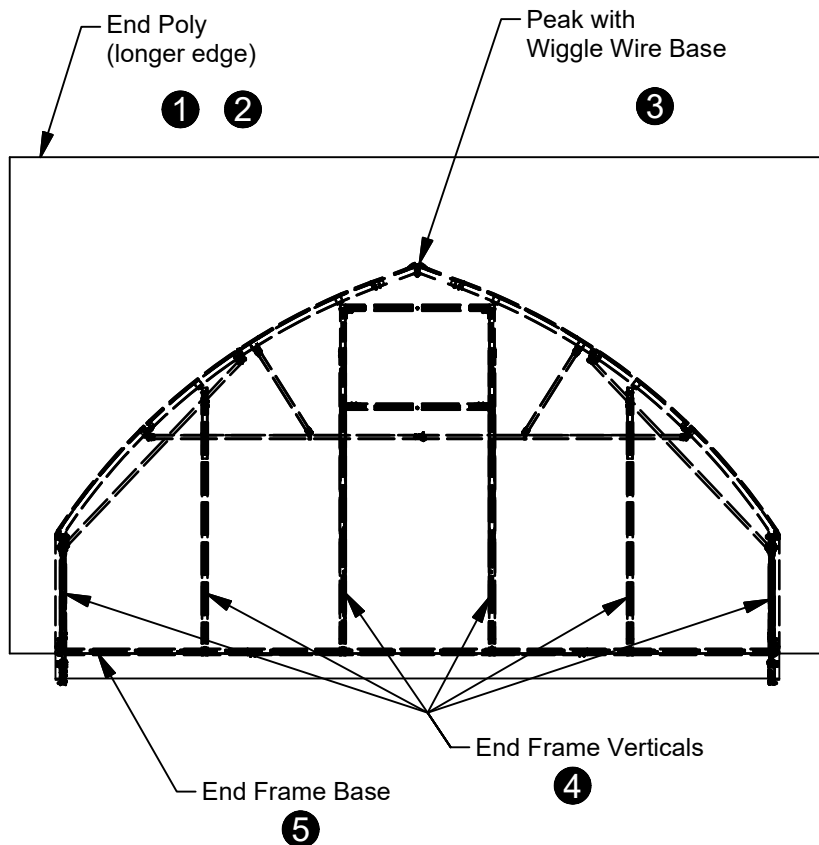

Gable Vent Installation - Part 1

1. Install **DR2410** on face of End Frame by installing **WIGLWIRE** along the Peak Header and also on the End Frame Gable Top.
2. Attach 2x **RC1311** to Peak Header, outside of Wiggle Wire Base. **NB1805** will screw through the Poly, and the Wiggle Wire Base. (see Detail A).

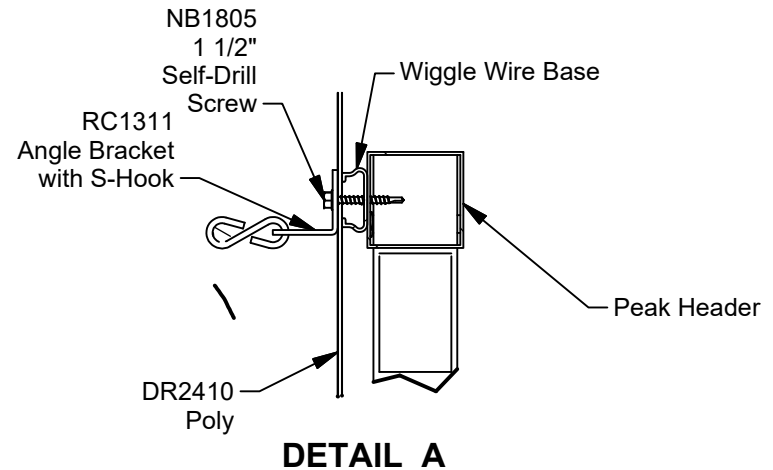
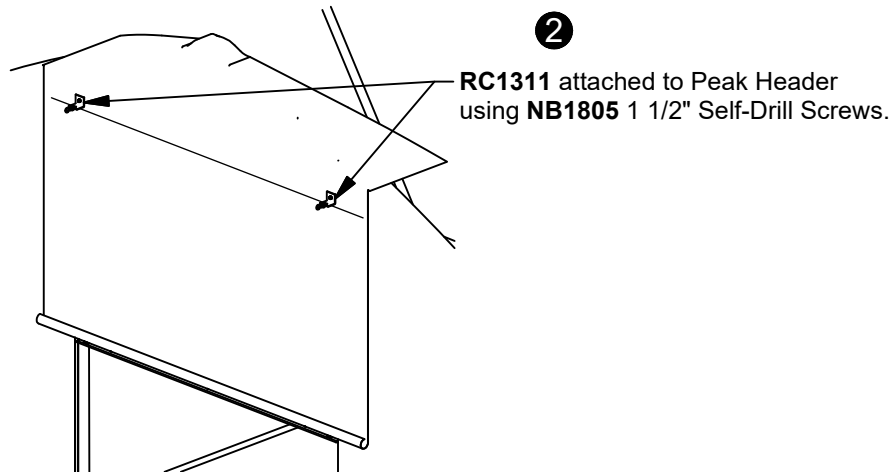
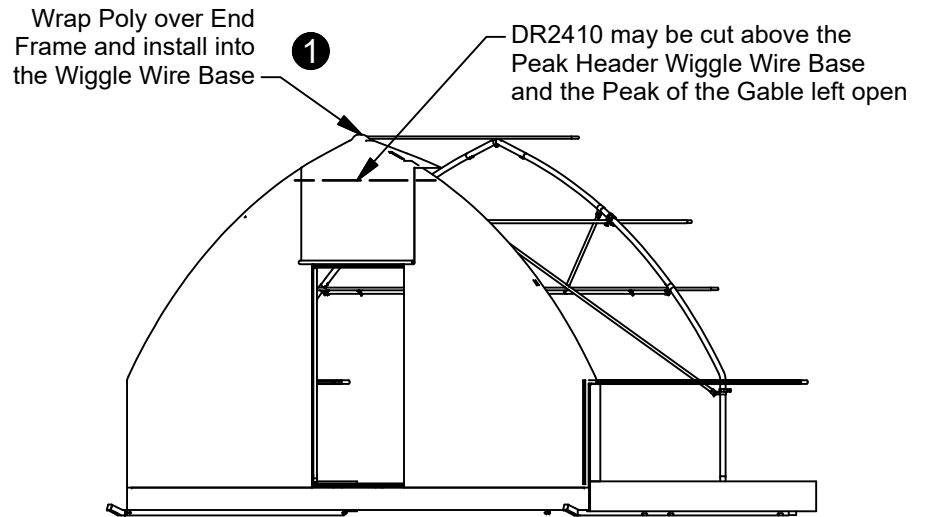
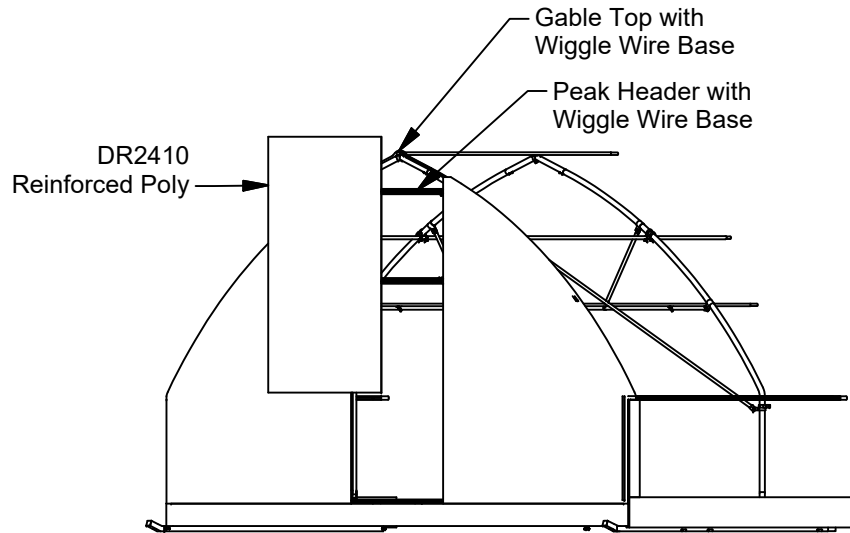

Continuing on from Gable Vent Assembly Part 1

- 1 Join **HT1085** with **RC1319** using **RC1303** and included hardware.
- 2 Wrap **DR2410** around **HT1085** and use 3x **RC1010** Clips to hold **DR2410** in place (see Detail C).
- 3 Mount **FT2071** Hook where desired for Roll-Up Crank (**RC1319**) storage placement.
- 4 Near the ends of the door header, centered vertically, drill 2 x 7/16" \varnothing holes horizontally through the door header.
- 5 Insert Eye Bolts **NB1622** through the drilled holes, attaching with the hardware shown. (See Detail A).
- 6 Create the Vent Guide by tying rope at the Eye Bolts **NB1622** with the rope running through the S-Hooks (**RC1311**) (see Detail C).

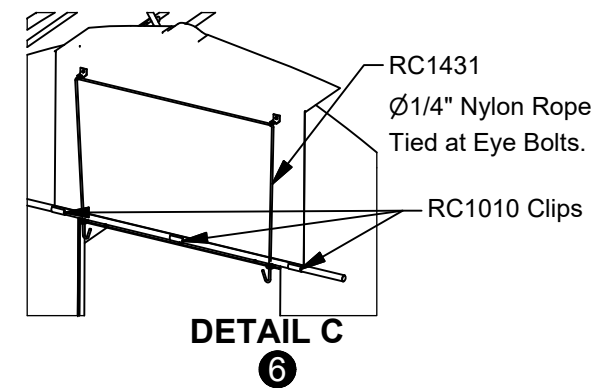
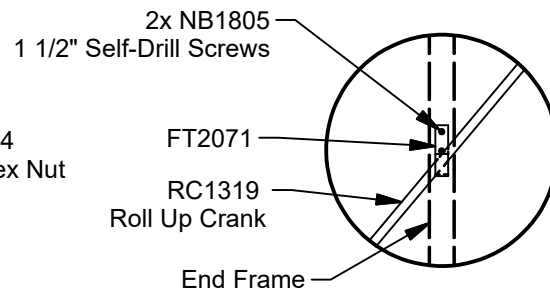
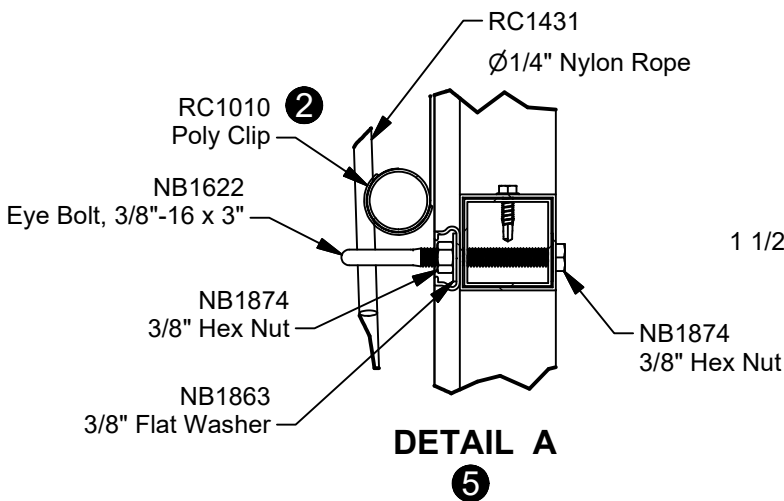
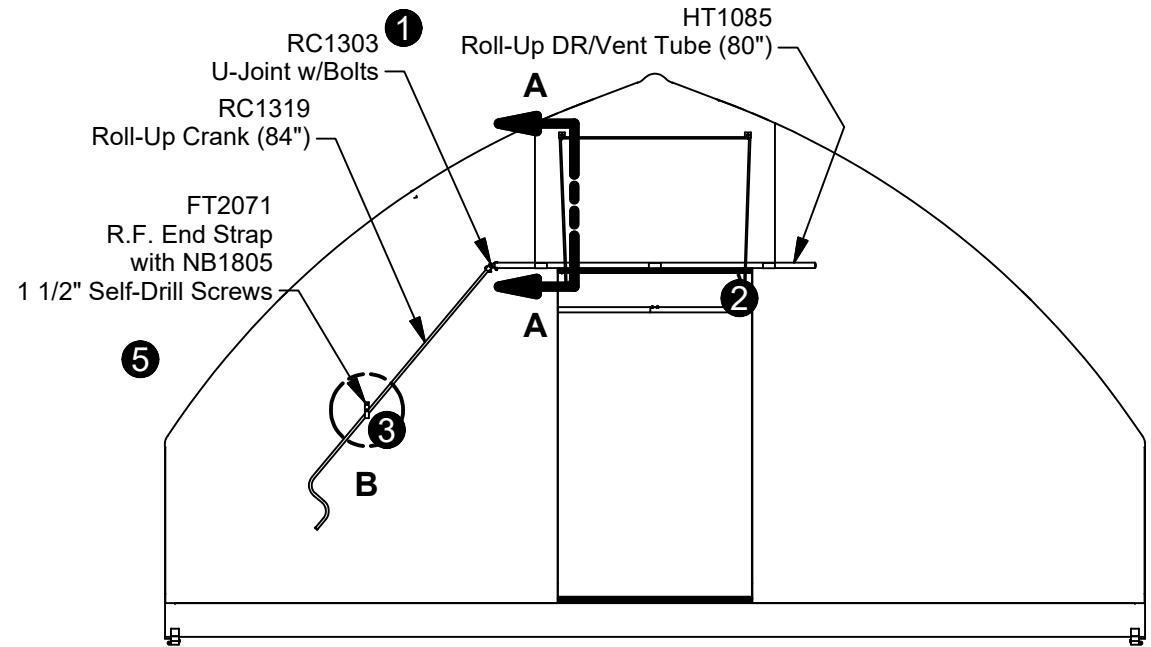

1. Lay out sections of Wiggle Wire around the perimeter of the structure so they are handy.
2. Unroll the Poly on the ground along the length of the structure, being sure to leave equal overhang on both ends.
3. Place one worker at point **A**, and one worker at **B**. It helps to have another worker inside the structure near **C** to help move the Poly up and over the frame sections.

Notes:

- Pick a calm day when attempting to install the Roof Poly. On a windy day, it's almost impossible to handle the Poly.
- If the Poly is installed on a cool day, the material may expand as the temperature warms causing the Poly to droop. If this happens, it may be necessary to re-tension the Poly and adjust the Wiggle Wire as needed at a later date.

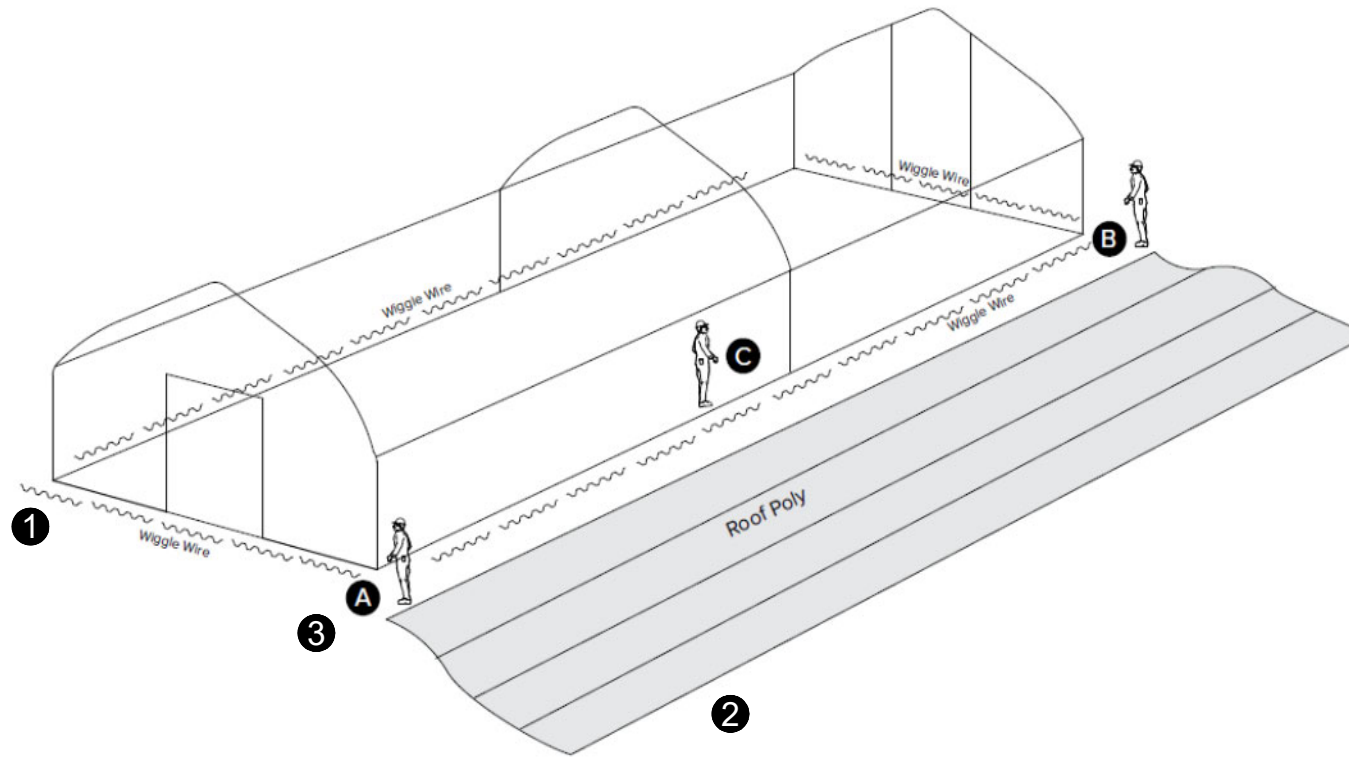

1. Gently pull the poly into place on the roof making sure poly is centered on structure as shown, use temporary sections of Wiggle Wire between points **D** and **F** to help prevent the Poly from shifting while the Wiggle Wire is installed on the first side.
2. Begin installing Wiggle Wire at point **B** (Center of the structure) and work down to point **A**
3. Moving to the other side of the structure, begin installing Wiggle Wire at point **E**, working one side at a time. Use a helper again to tension the Poly as the Wiggle Wire is inserted.
4. Starting at the top of the end frame at point **G**, begin installing Wiggle Wire down to point **D**. Next do the same on the other end frame.
5. After all the Wiggle Wire has been installed on both sides and both end frames, verify poly hanging below side WWBase is equal from side to side of structure for accuracy of side vent roll up tube installation and adjust if necessary then reinforce the corners with additional 12" pieces of Wiggle Wire. Refer to Wiggle Wire Installation sheet for proper way to install the reinforcing Wiggle Wire at the corners.

Notes:

- It helps to have two workers install the Wiggle Wire to prevent drooping and maintain proper tension along the length of the structure. One worker can tension the Poly while the second worker installs the wiggle wire. This will help reduce wrinkling of the Poly.
- Make sure the Wiggle Wire is seated properly into the Wiggle Wire Base. Adjust the Poly and Wiggle Wire as required.

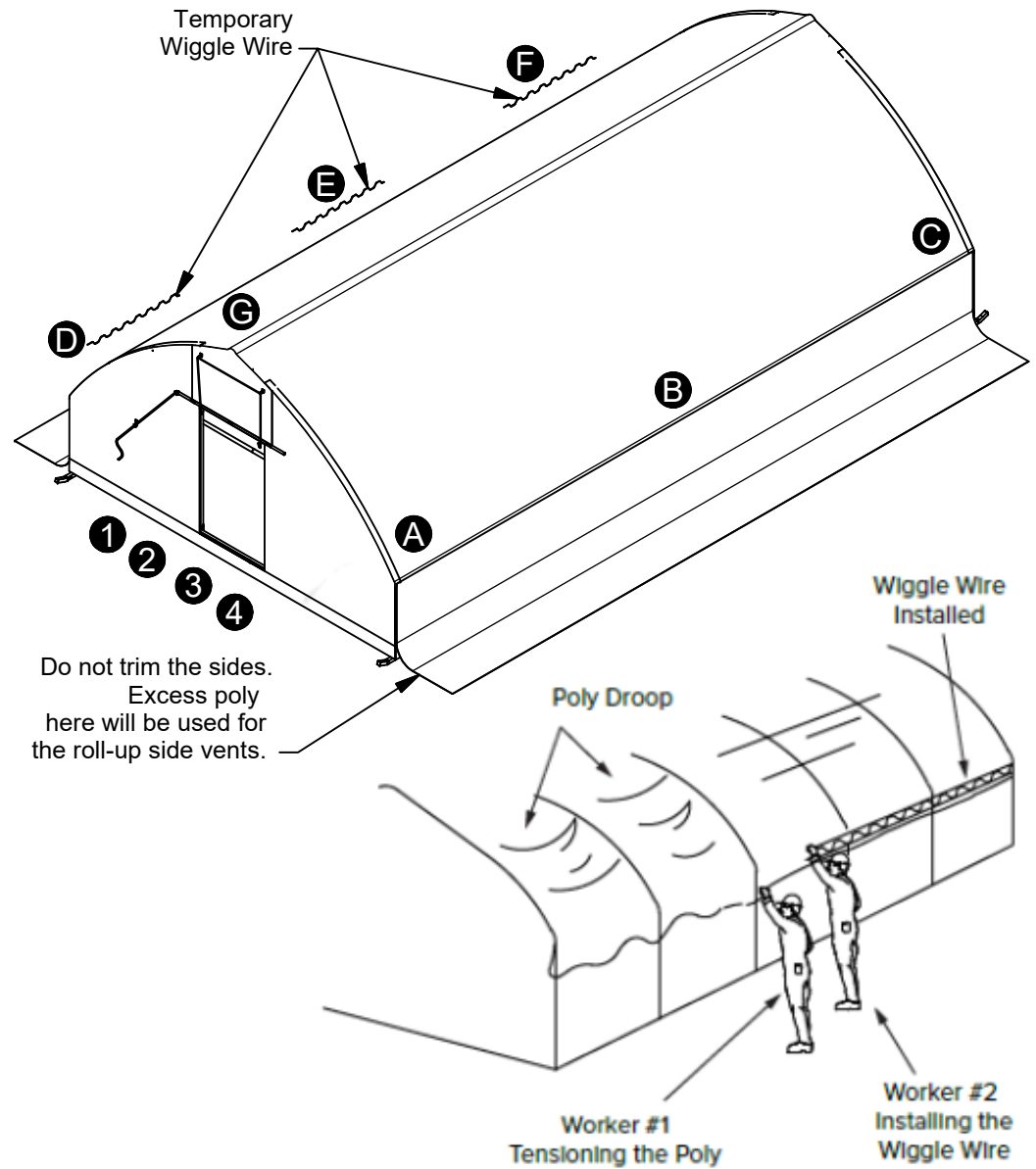

Detail 1

Side Vent Installation - Part 1

1. Install 6X **RC1311** on top of (Side) WWBASE (over Poly) using 1X **NB1805** each.
2. Install 5X **RC1330** along Wood Skirt using 2X **NB1807**.

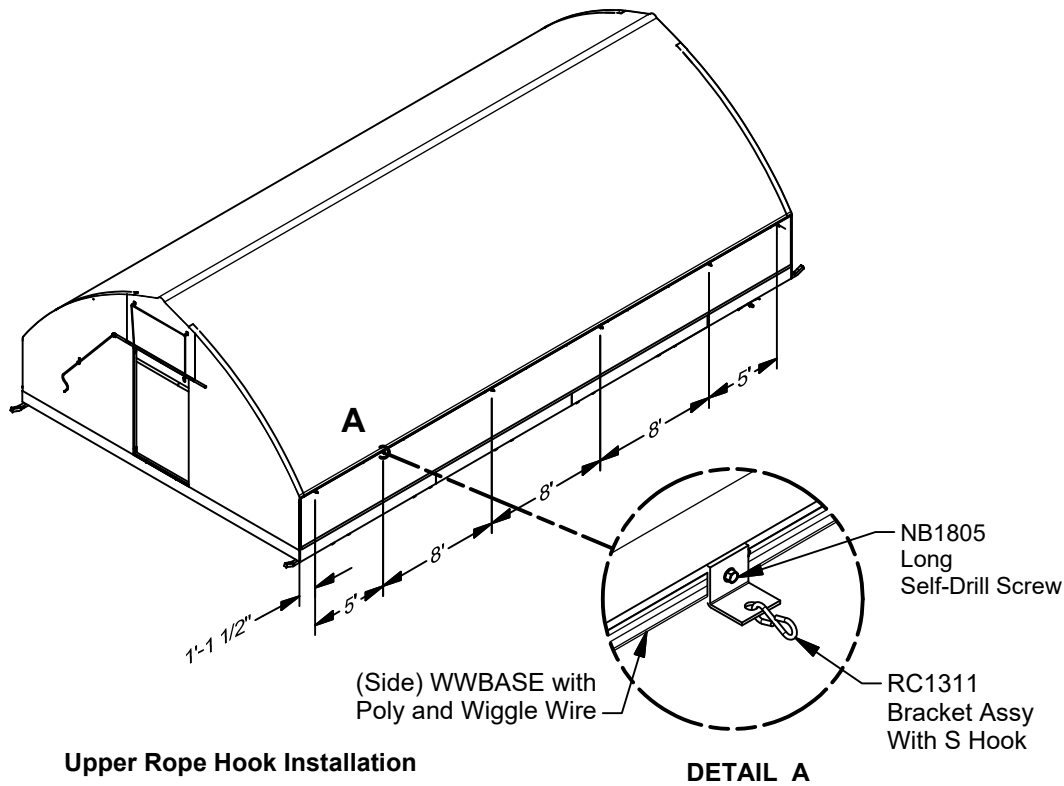

Note:
1. Dimension is to and from center of bracket.

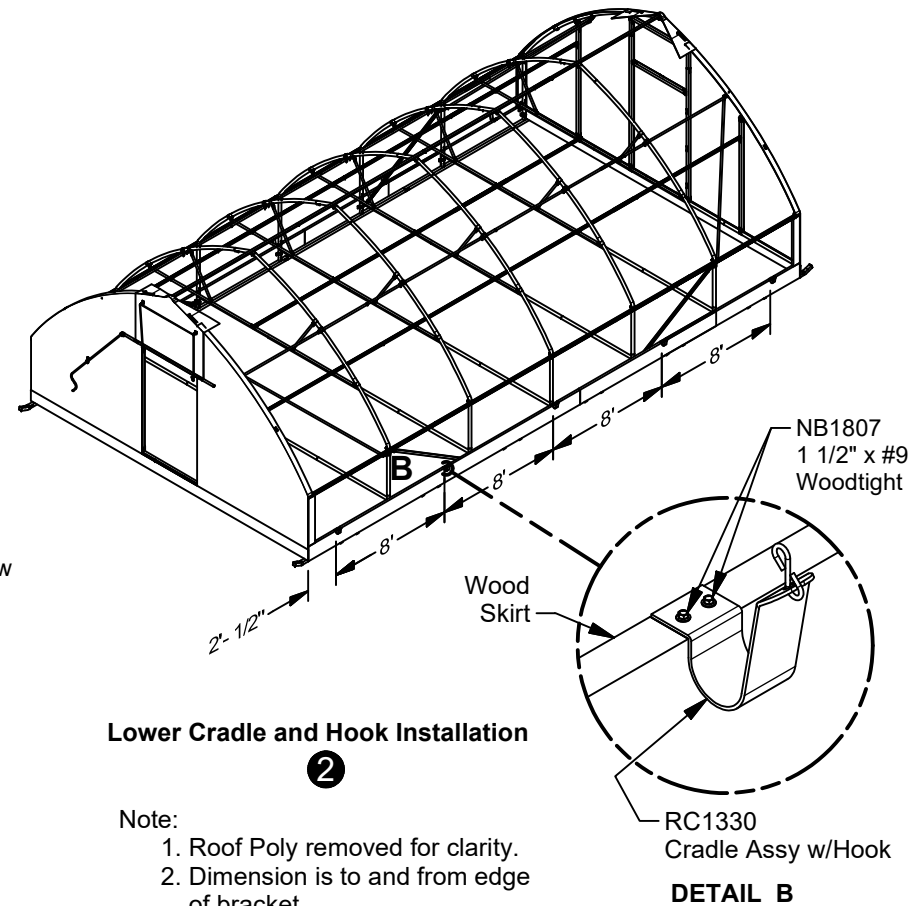

Note:
1. Roof Poly removed for clarity.
2. Dimension is to and from edge of bracket.

1. Join 4X **CF1014** using 1X **NB1809** at each joint.
2. Mark the hanging poly 54" below the Wiggle Wire Base. Also trim each end of hanging Poly for the Roll Up Vents 1" to the inside of the vertical wood making sure the wood is still covered when closed.
3. Wrap the hanging poly around the roll up tubes **CF1014** and use **RC1010** Clips spaced 36" apart to hold poly in place, use the marks made to ensure the tube and clips are parallel with the Wiggle Wire Base
4. Join **HT1085** with **RC1319** using **RC1303** and included hardware.
5. Trim run of **CF1014** to length of structure.
6. Install **FT2071** at desired height using 2X **NB1809**.
7. Thread **RC1406** (Rope) through the first **RC1311** and into the first **RC1330**. Alternate up and down for the length of the structure and tie off.

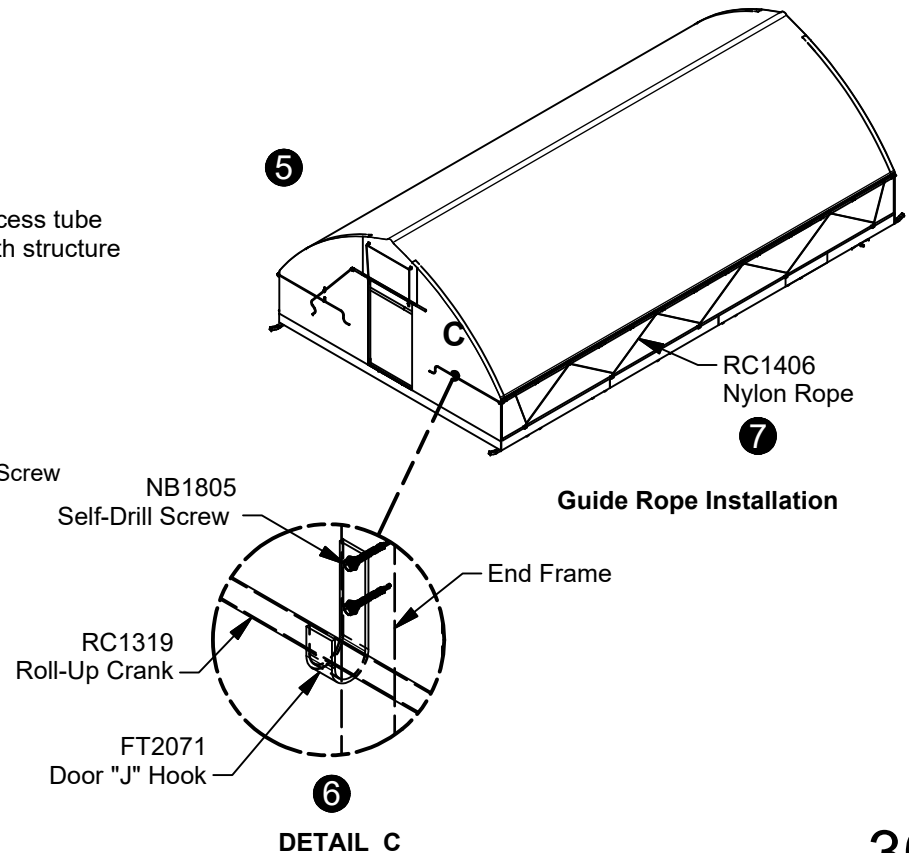
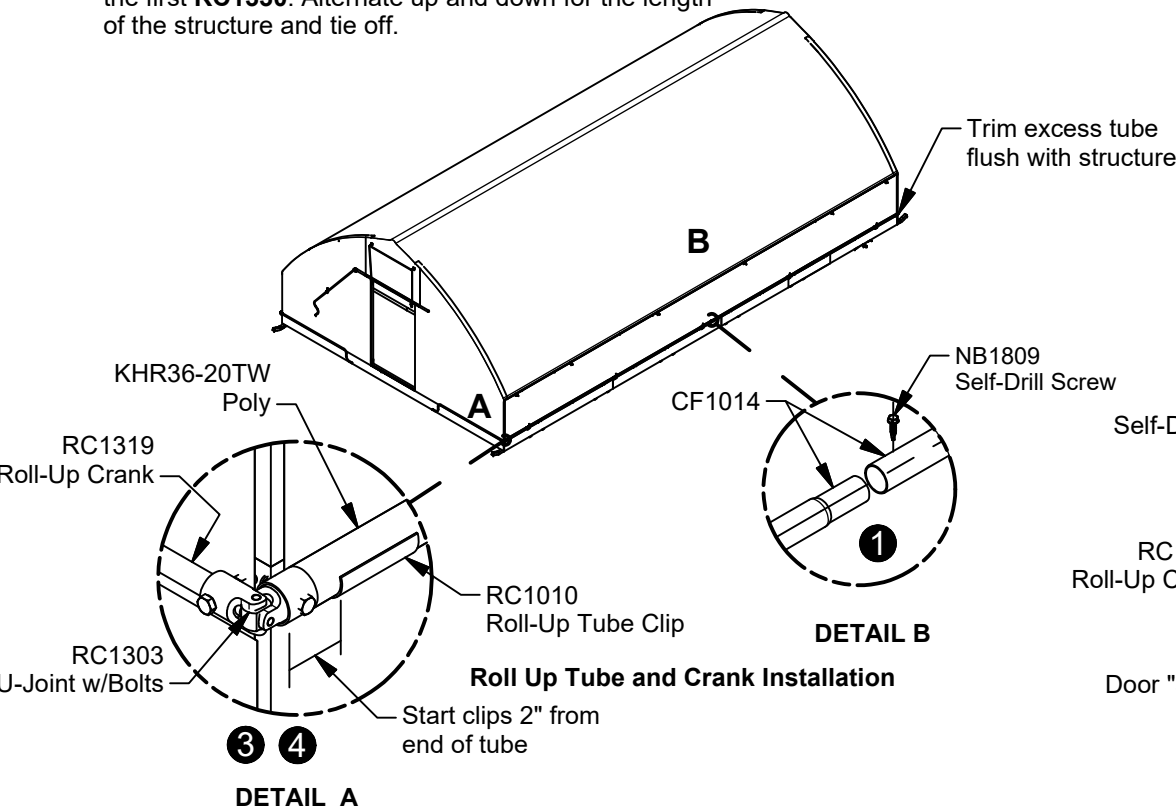
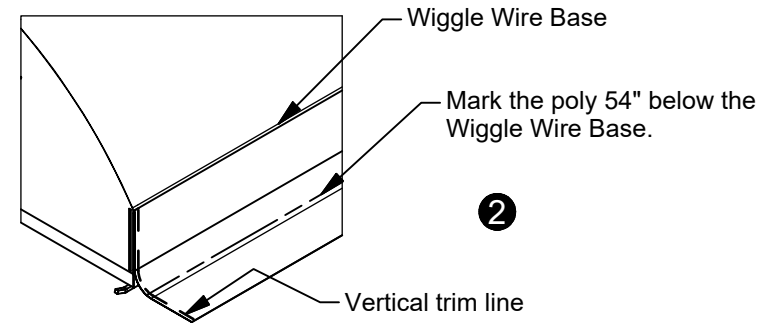

Shade Fabric Installation

- 1. Install Shade Fabric using same process used for Roof Poly Installation. Shade fabric can be attached to Wiggle Wire Base the same way Poly is installed with additional Wiggle Wire.

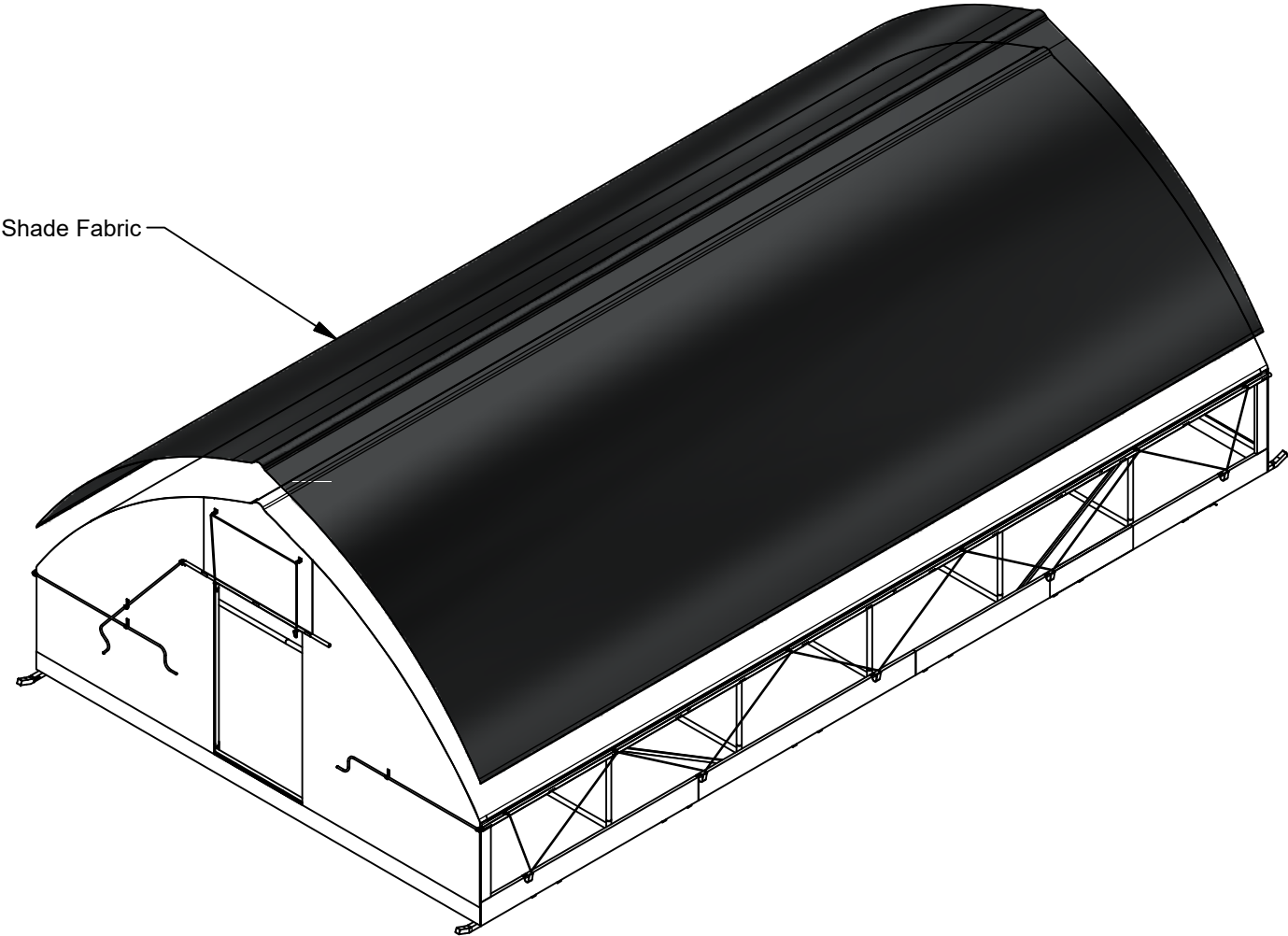

1. At each door, attach the Reinforced Poly to the door using Wiggle Wire.
2. Install the door latch (**DR6041**) using the instructions included with the latch. To attach the door latch kit, drill $3/8"$ \varnothing thru bolts at attachment locations and use $5/16"$ x $2\ 1/2"$ Carriage Bolts **NB1816** with $5/16"$ Hex Nuts and Washers **NB1862** and **NB1872**.
3. At each end of the structure, place the door assembly into the opening (make sure the hinges face the inside of the structure) and shim into place, leaving an even gap around all sides.
4. Attach the hinges to the frame using 4X **NB1603** at each hinge.

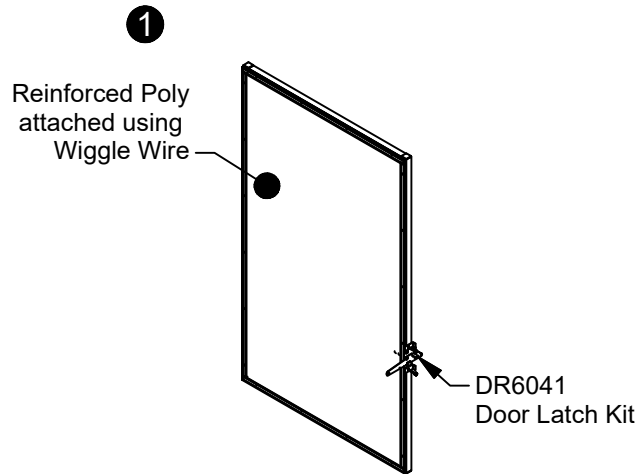

NB1816 Carriage Bolt
 $5/16"$ x $2\ 1/2"$
 NB1862
 NB1872

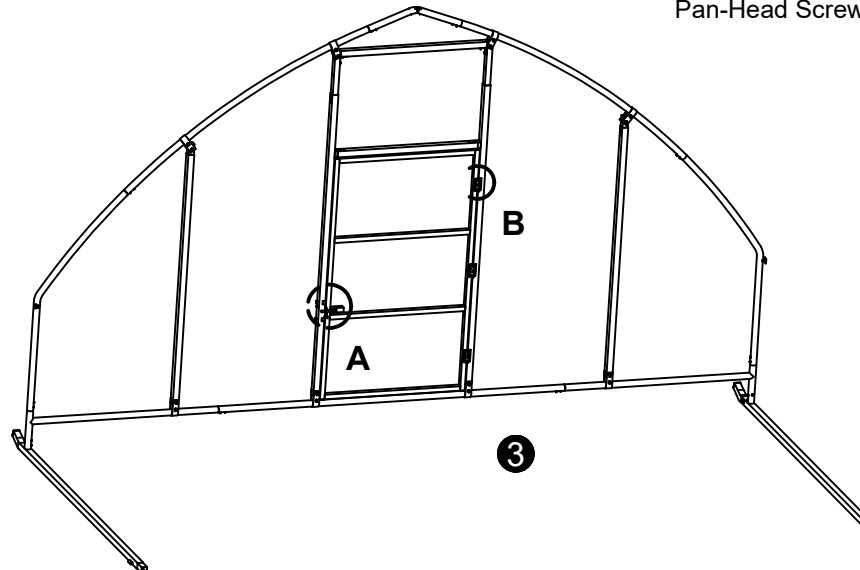
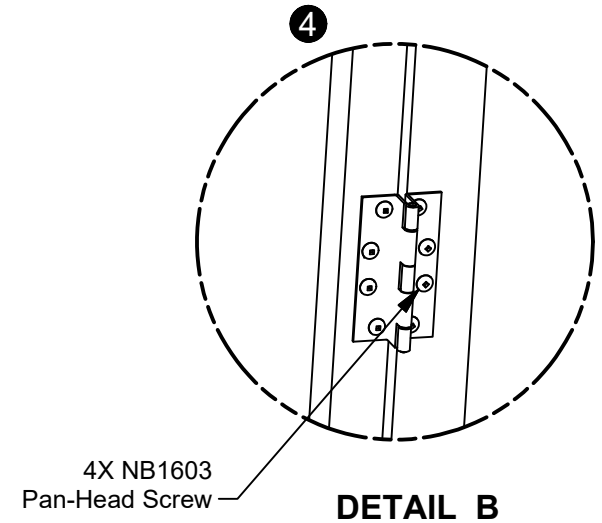
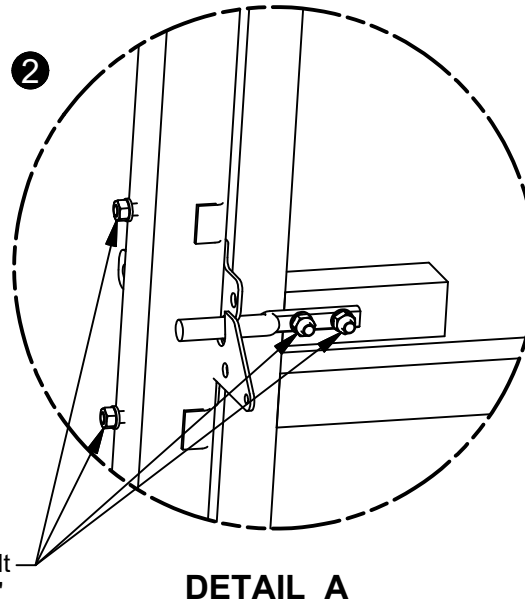

Eye Hook Installation

1. At each corner of the structure, locate and drill a 7/16" \varnothing thru hole in the corner frame centered 3" above the lower skid.
2. Install the Eye Hook (NB1622) using washers (NB1863) and nuts (NB1874) on both sides of the tube.

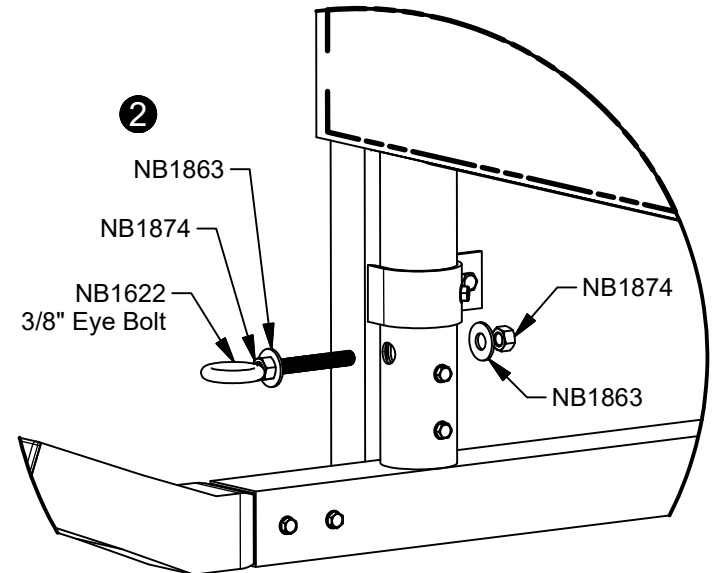
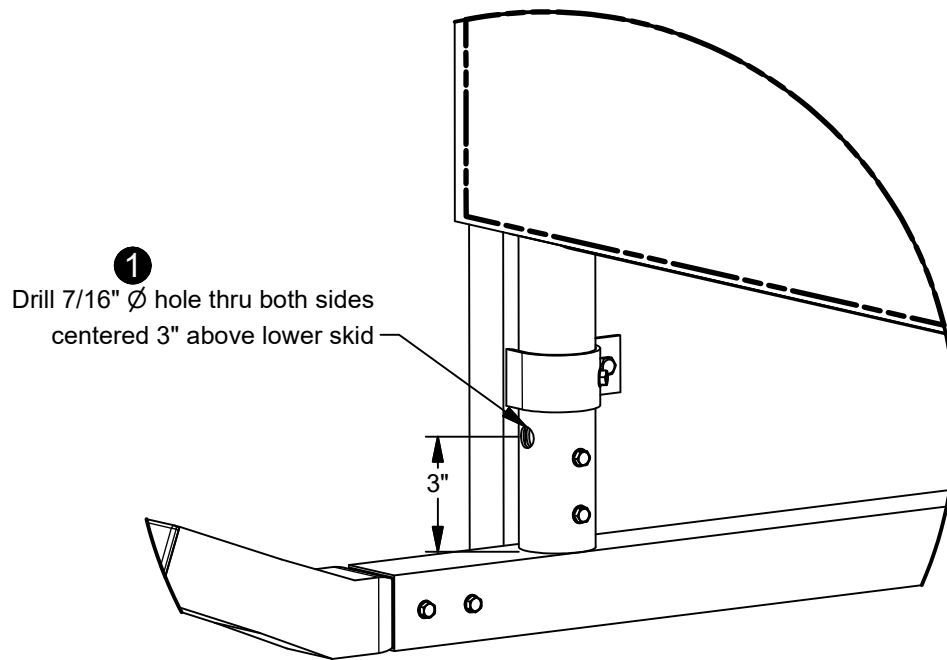

1. Between each set of hold down tubes on the outside of the Skid Rails, locate an Earth Anchor (**PT2200**) about 3" from the skid. With downward pressure screw the anchor into the soil until the eye is about 1" from the soil.
2. Secure each anchor to a skid with Shackle (**HTA1064**), Anchor Rod (**HTA1058**), and Hairpin (**NB1958**).
3. Install bolt (**NB1942**) and nut (**NB1749**) to secure each anchor to shackle.

