

FieldPro® Gothic high tunnel 30'

Installation Instructions



PO Box 458 • 27725 Danville Ave. • Castle Rock, MN 55010 • poly-tex.com
U.S. & Canada Toll Free 800-852-3443 • (651) 463-7009 • fax (651) 463-2479

Rev AJ – 210121

Thank you for purchasing the FieldPro Gothic High Tunnel 30' Greenhouse. The FieldPro 30' has been carefully engineered to provide years of faithful service.



Where this icon appears you will be alerted to a useful installation tip or an optional way of performing an installation operation.



Where this icon appears you will be alerted to a Time-Saving tip that will help speed up the FieldPro installation.

Index

Safety Guidelines	3	Truss Frame Assembly	22–23
Limited Warranty	4	Installing Wood Side Rails	24–25
Overview of FieldPro	5	Plain End Wall Wiggle Wire Base Material Installation	26
Main Components Identification	6	Plain End Wall Poly Installation	27
Standard Hardware	7	Open Doorway – Part 1 and Part 2	28–29
Roll-up Door and Roll-Up Curtain Components and Hardware	8	Wiggle Wire Installation	30
Building Site Layout	9	Installation of Roof Poly – General Instructions	31
Layout of Ground Support Locations	10	Installing Roof Poly on FieldPro with Roll-Up Side Curtain	32
Ground Stake installation Options	11	Installing Ground-to-Ground Roof Poly	33
Ground Stake and Ground Stand Installation	12	Optional Door Kit HT3004 w/ Metal Frame Installation	34–36
Ground Stake Installation in Concrete Pier	13	Roll-Up Curtain Installation	37–39
Building Side Sub-Assembly	14		
Building Main Frame Sections	15		
Erecting Initial Frame Sections	16		
Adding Diagonal Braces	17		
Side Purlin Installation	18		
Adding Main Frames and Side Purlins	19		
Peak Purlin Installation	20–21		

PLEASE READ THE INSTALLATION INSTRUCTIONS CAREFULLY BEFORE BEGINNING TO ASSEMBLE THE STRUCTURE. SAVE THESE INSTRUCTIONS FOR FUTURE REFERENCE.

Poly-Tex does not warrant that this structure or foundation will comply with local or state building codes. There is no guarantee of the load capacity of the structure for snow, wind, seismic, or other loads unless buyer has received certified engineering drawings with the structure, and Poly-Tex does not warrant that the frame or foundation will comply with local or state building codes in buyer's location.

 **WARNING**

This structure is intended to be self-supporting, provided it is constructed with all frames, hardware, sheathing, sheeting, bracing, cables, and membrane in place, and secured to the foundation as shown in the manual. Stability during construction, from winds and loads imposed during erection, is the sole responsibility of the installer. Observe safety codes required by the local jurisdiction, and relevant safety practices for working at heights. Avoid the risk of electrical shock from overhead lines or electrical storms. Poly-Tex recommends contracting a licensed electrician to perform electrical work. Eye protection is recommended under all circumstances and hearing protection is recommended when cutting components with power tools.

 **DANGER**

No part of this structure is engineered to function as an anchorage point for a fall arrest system. Use a safety net or work from a safe work platform (i.e. scaffolding). Select a calm day for work. Wind can be sufficient enough to knock materials or workers off a work platform or ladder, resulting in a potentially deadly fall.

Overview of assembly procedure

While each structure and site is unique, and may require special considerations, these instructions are for a tilt-up method (where frames are assembled on the ground and tilted onto ground stakes or anchor rods using ropes or lifts). If installer is not confident to erect the structure, Poly-Tex suggests hiring a general contractor, carpenter, or similar licensed business familiar with construction, to assemble and erect the structure.

 **DANGER**

Do not overload structure.

Consult with a Poly-Tex representative prior to adding any amount of weight over the specified capacity of this structure. Basket purlins, shelving or any objects of significant weight shall not be hung, attached, or secured to roof or truss members in a manner that will overload the structure.

 **WARNING**

Do not walk on polycarbonate sheets.

If structure is to be covered with polycarbonate sheets, always use scaffolding for the erection process to avoid damage to sheeting and to ensure safety. Polycarbonate sheeting has UV coating protected with vinyl film on the exterior surface. Install sheets with the film intact and toward the exterior. Remove film once the sheet has been fastened in place.

Poly-Tex, Inc. warrants its products to be free from defects in material and workmanship for a period of (1) year from date of invoice. This warranty is provided to the original purchaser of the product and is not transferable. Poly-Tex does not warrant parts not manufactured by Poly-Tex, but does assign any transferable manufacturer or supplier warranties. Should any defect be found, full repair or replacement will be rendered to the customer at no cost following inspection by a Poly-Tex representative and the return of the defective product to our Castle Rock, MN facility. Expenses for removal or reinstallation of defective products will not be covered by the warranty.

Non-code compliance or non-engineered structures purchased by our customers are done so at the customer's own risk. Customers shall indemnify Poly-Tex from any liabilities or cost for structural failure or any legal action taken by governing agencies against purchases of non-code compliance structures. Failure to comply with proper installation or any modifications to the product will void warranty.

Purchaser will indemnify and hold Poly-Tex and its officers and agents harmless (to the extent provided by law) from and against all loss, liability, cost, damage or expense incident to any claim, action or proceeding against Poly-Tex arising out of the installation, maintenances, use or operation of the products by purchaser.

POLY-TEX SHALL NOT BE HELD RESPONSIBLE FOR ANY SPECIAL OR CONSEQUENTIAL DAMAGES, OR FOR ANY DELAY IN PERFORMANCE OF THIS WARRANTY BEYOND OUR CONTROL. THIS WARRANTY IS EXCLUSIVE AND IN LIEU OF ALL OTHER WARRANTIES WHETHER IMPLIED, WRITTEN OR ORAL INCLUDING THE WARRANTIES OF MERCHANTABILITY AND FITNESS FOR A PARTICULAR PURPOSE.

This warranty does not cover damage from customer abuse, misuse, improper installation, customer modifications, customer negligence in performing normal maintenance or damage resulting from acts of nature.

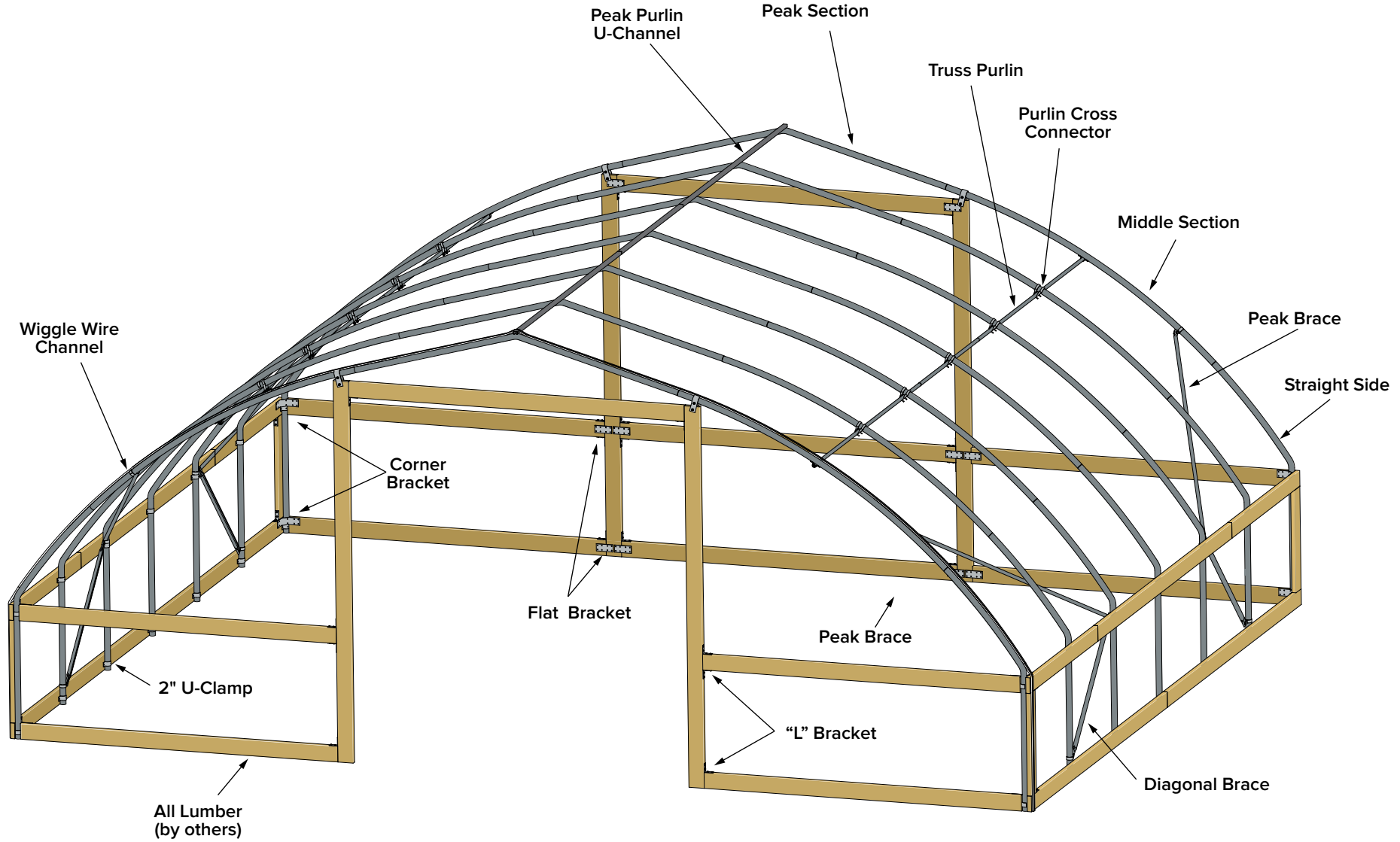

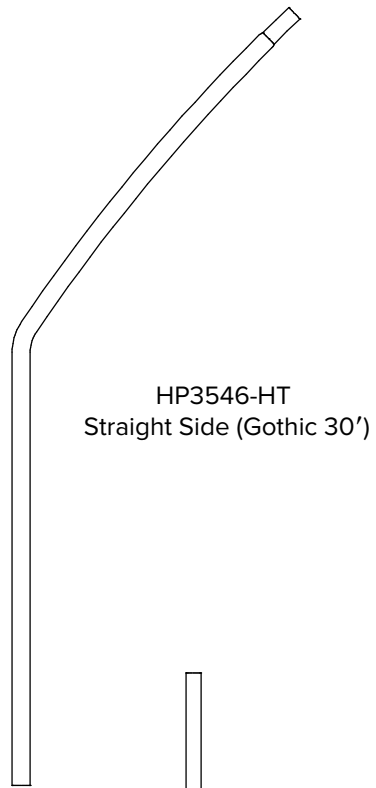

HP3546-HT
Straight Side (Gothic 30')



GS2400
Ground Stake



GS2401
Ground Stand 1.66" x 3'

Customers will receive GS2400 or GS2401 depending on the type of installation.
See page 6 for installation options.

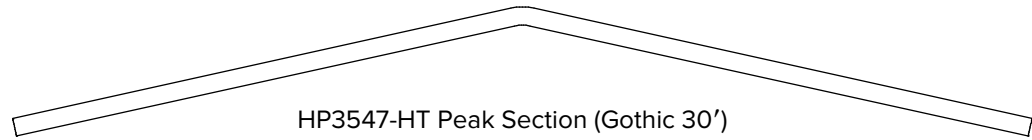

HP3547-HT Peak Section (Gothic 30')

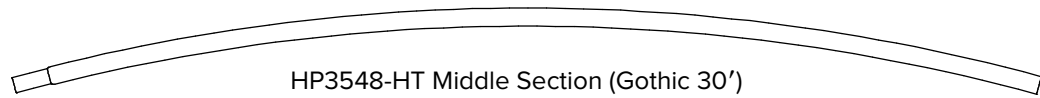

HP3548-HT Middle Section (Gothic 30')

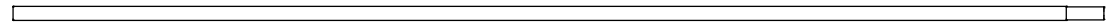

RR2109
9'-8" R.F. U-Channel w/Swage

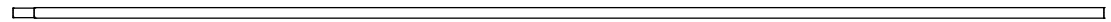

HP3340
9'-8" Truss Purlin w/Swage-Red

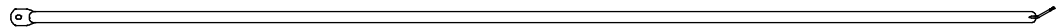

HP3503
HT Peak Brace 111"

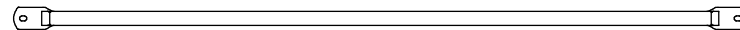

HP3506 Diagonal Brace 78"
(6 ft. spacing)

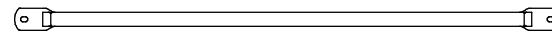

HP3505 Diagonal Brace 58"
(4 ft. spacing)

Standard Fittings and Hardware

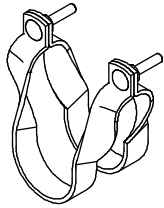

FT4040
Cross Connector

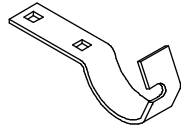

FT2079
Long Speed
Hook (2'')

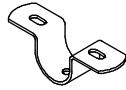

KH1000
Purlin
Fastener

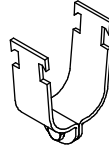

FT2108
1 1/2" UNI Pipe clamp

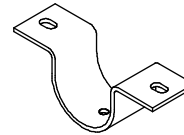

FT2057
2" U-Clamp

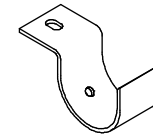

FT2106
R.F. End Strap

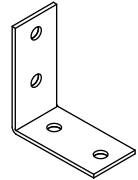

FT1990
R.F. "L" Bracket



BMS1130
18" Spike

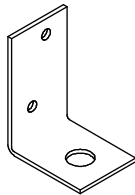

FT2118
Spike Anchor
Bracket

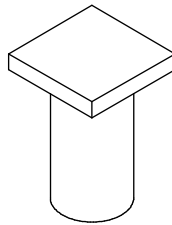

HT1001
1.66" Driving Tool

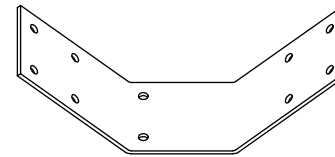

DR7032
Steel Corner Bracket

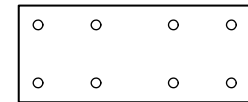

DR7033
Steel Flat Bracket

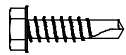

NB1809
1/4" -14 x 1"
Self-Drilling Screw

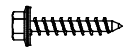

NB1807
1 1/2" Woodtite Screw



FB2527
1' x 1 1/2" Rectangular
Black Plug

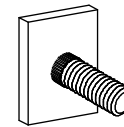

FT2570
Stop Tab

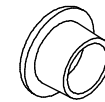

RS5000
1 1/4" Round Black Plug

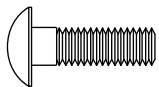

NB1837
3/8" x 1 1/4" GRD5
Carriage Bolt
(For Optional Truss Package)

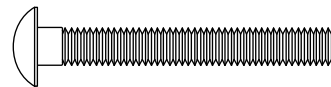

NB1841
3/8" x 3"
Carriage Bolt



NB1864
3/8"
Lock Washer



NB1874
3/8"
Hex Nut

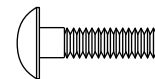

NB1832
5/16" X 1 1/4"
Carriage Bolt



NB1862
Lock Washer



NB1872
5/16" Hex Nut

Roll-Up Door and Roll-Up Curtain Components and Hardware



PT2521
10" Bungee Ball

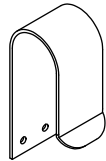

RC1316
Roll-Up Door
Cradle



FT2071
Roll-Up Door
'J' Hook

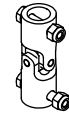

RC1303
U-Joint w/Bolts

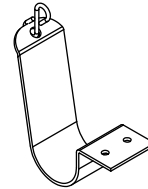

RC1330
Cradle, Short,
w/S-Hook

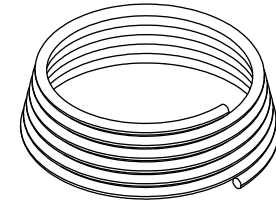

RS5049
1/4" Nylon Rope 18600

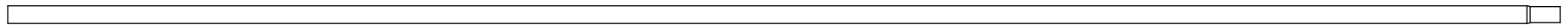

CF1014 - Tube w/Swage (116")

WIGGLWIRE - 43.000
Wiggle Wire

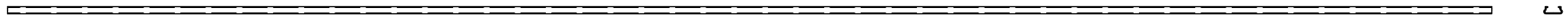

WWBASE9
8' - 11" Wiggle Wire Base

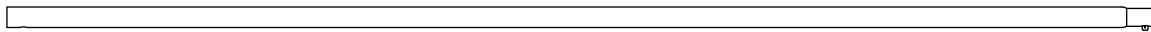

RC1007 - Roll-Up Tube Bottom 6' - 2 1/4"



RC1026 - Roll-Up Tube Bottom Extension 5'



RC1010
Roll-Up Tube Clips

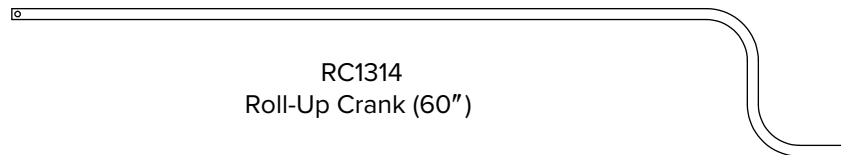

RC1314
Roll-Up Crank (60")

Building Site Layout

Note: It is very important to accurately layout the building outline. It helps to have someone assist you with laying out the building location.

1. Drive a temporary stake at point #1. Measure over 30' and drive in another stake at point #2. Attach a twisted masons line between stakes #1 and #2 approximately 12" above ground. Use a line level to level the masons line.

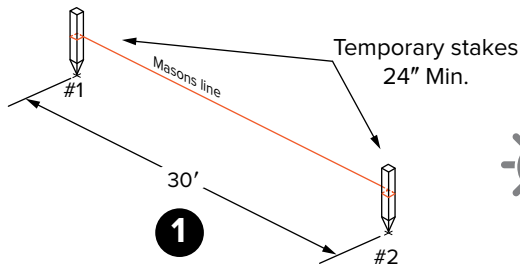

Tip:
An orange masons line is easier to see.

The "3:4:5 Triangle Method" of layout for a building produces a perfect 90° corner as shown in the diagram. It forces your foundation layout to be a perfect rectangle instead of a parallelogram. The basic approach is to roughly layout your string lines to the overall dimensions needed for whatever size building. Then square-up one corner with a tape measure using the 3:4:5 rule. Then move to any adjoining corner to the first corner, and proceed the same way.

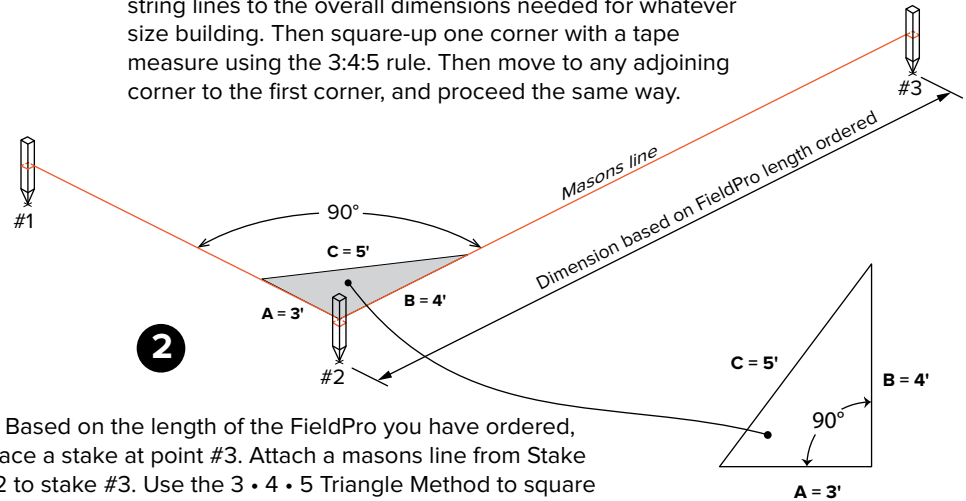

2. Based on the length of the FieldPro you have ordered, place a stake at point #3. Attach a masons line from Stake #2 to stake #3. Use the 3 • 4 • 5 Triangle Method to square up the corner at stake #2 to establish a 90° corner.

The 3:4:5 Triangle Method

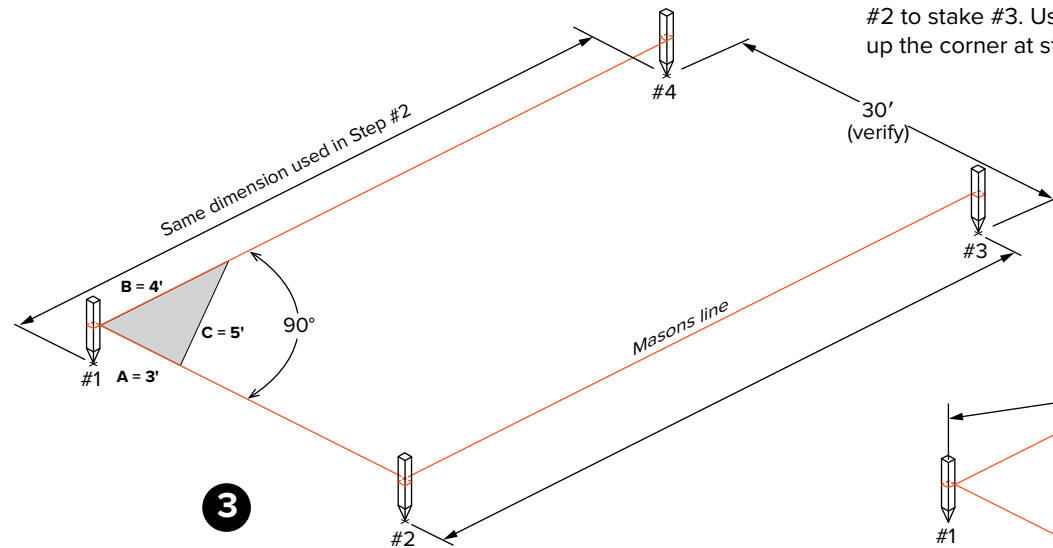

3. Place a stake at point #4. Attach a masons line from stake #1 to stake #4. Use the 3 • 4 • 5 Triangle Method to square up the corner at stake #1 to establish a 90° corner.

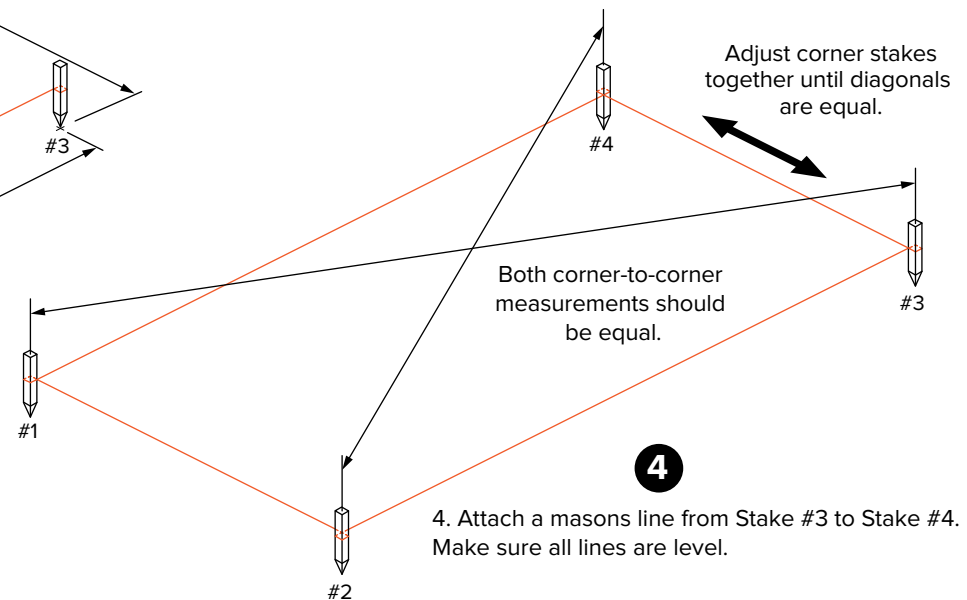

4. Attach a masons line from Stake #3 to Stake #4. Make sure all lines are level.

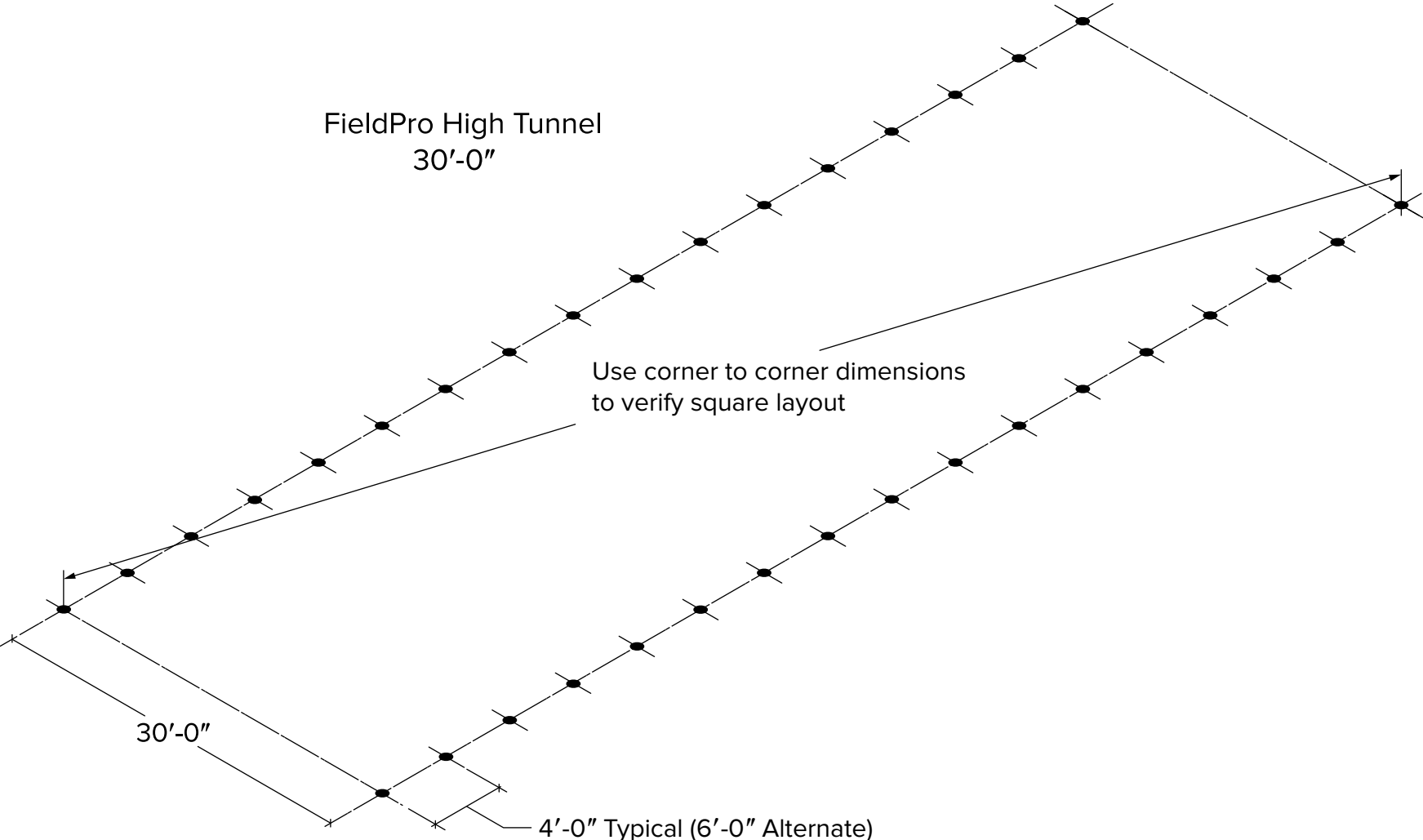

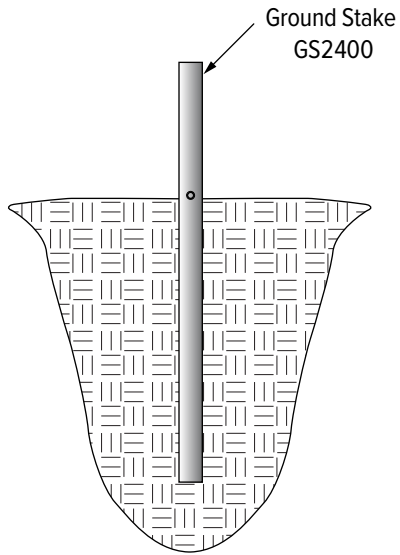

**Driven Ground Stake
Option #1**

See page 9 for the Ground Stake installation details.

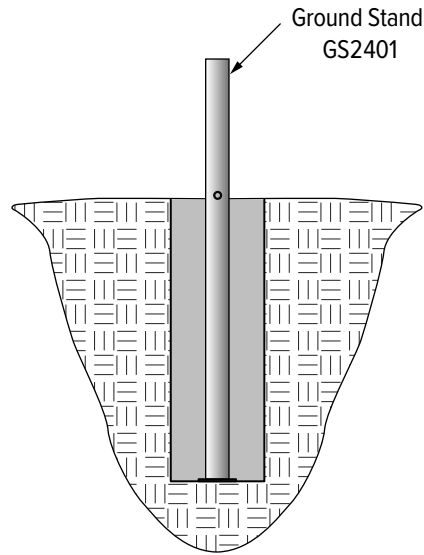

**Ground Stand in Compacted Soil
Option #2**

See page 9 for the Ground Stand installation details.

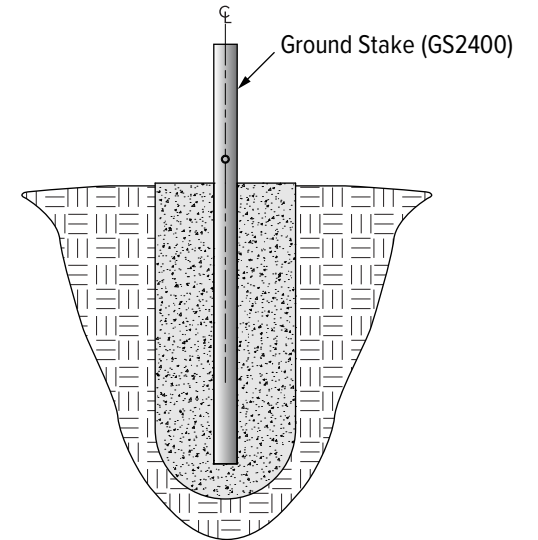

**Ground Stake in Concrete Pier
Option #3**

See page 10 for the Ground Stake in concrete pier installation details.

Ground stakes are driven into the ground using the Driving Tool (HT1001) until the top of the ground stake is 12" above the soil line.

A masons (twisted) line is attached between all four corner stakes 8" from the top of stakes. Use a line level to line up all the stakes at the 8" mark.

For longer structures, the masons line may need to be supported every 50' to prevent sagging. Sight down the line visually to check the straightness of the line.



To save time, you can prep all the stakes ahead of time.

Place a mark 8" from top of stake.

Install self-drilling screws before driving in the stake.

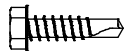

NB1809 1/4"-14x1" Self-Drilling Screw

Ground Stake GS2400 Preparation

Driven Ground Stake

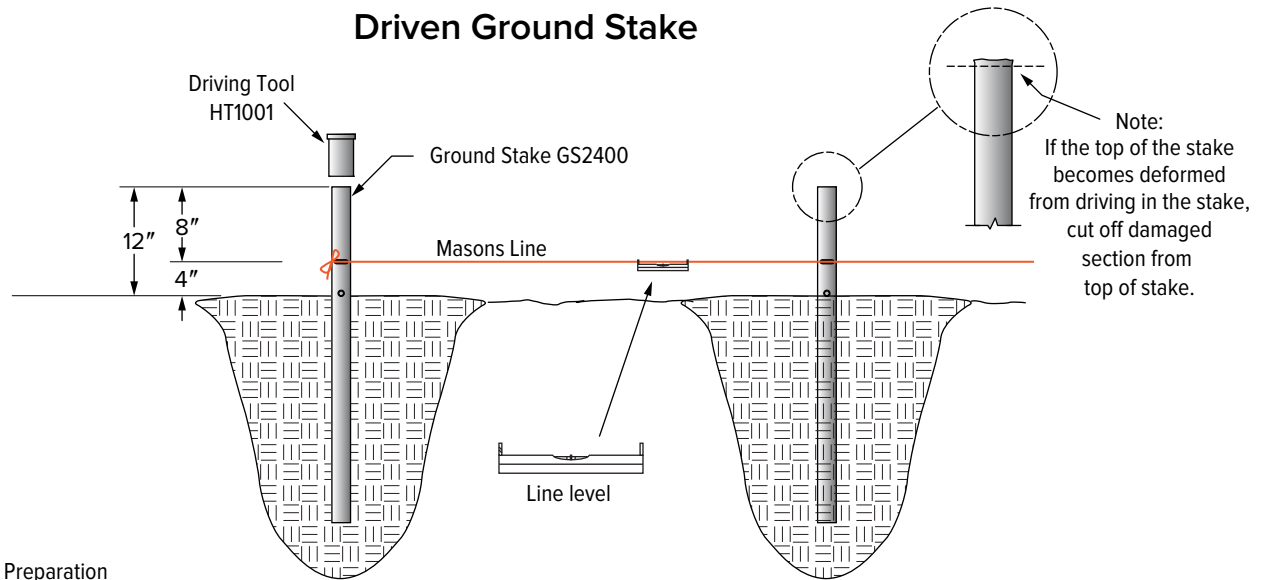

Ground stands are placed into a 6" diameter (min.) hole. The top of the ground stand will be 12" above the soil line.

Ensure that the ground stands remain plumb while compacting the soil all around.

A masons (twisted) line is attached between all four corner stakes 8" from the top of stakes. Use a line level to line up all the stakes at the 8" mark.

For longer structures, the masons line may need to be supported every 50' to prevent sagging. Sight down the line visually to check the straightness of the line.



To save time, you can prep all the stakes ahead of time.

Same details as Ground Stake above

Ground Stand GS2401 Preparation

Ground Stand in Compacted Soil

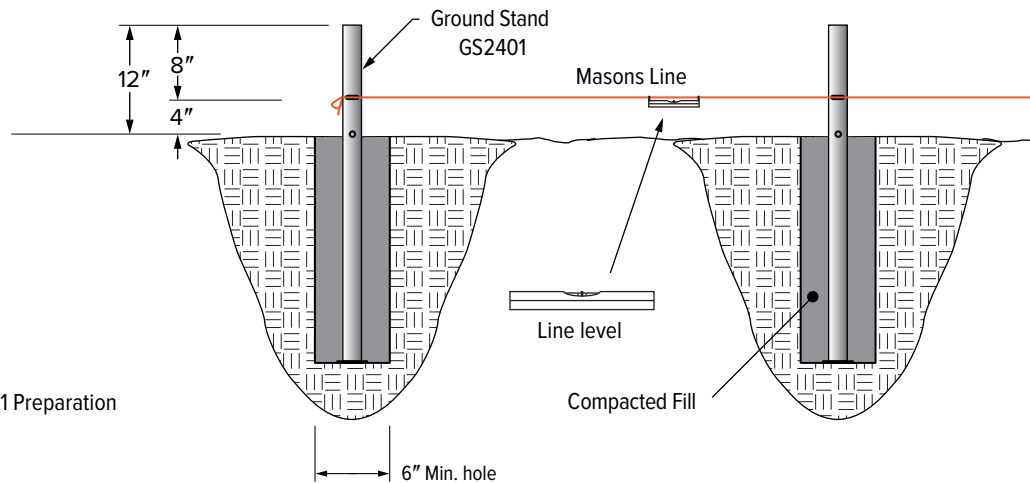



To save time, you can prep all the stakes ahead of time.

Place a mark 6" from top of stake.

Install 1 self-drilling screw in the stake.

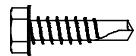

NB1809 1/4"-14x1" Self-Drilling Screw

Ground Stake GS2400 Preparation

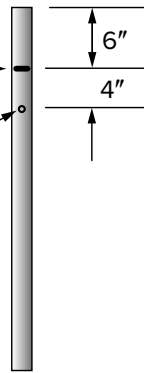

Ground Stake in Concrete Pier

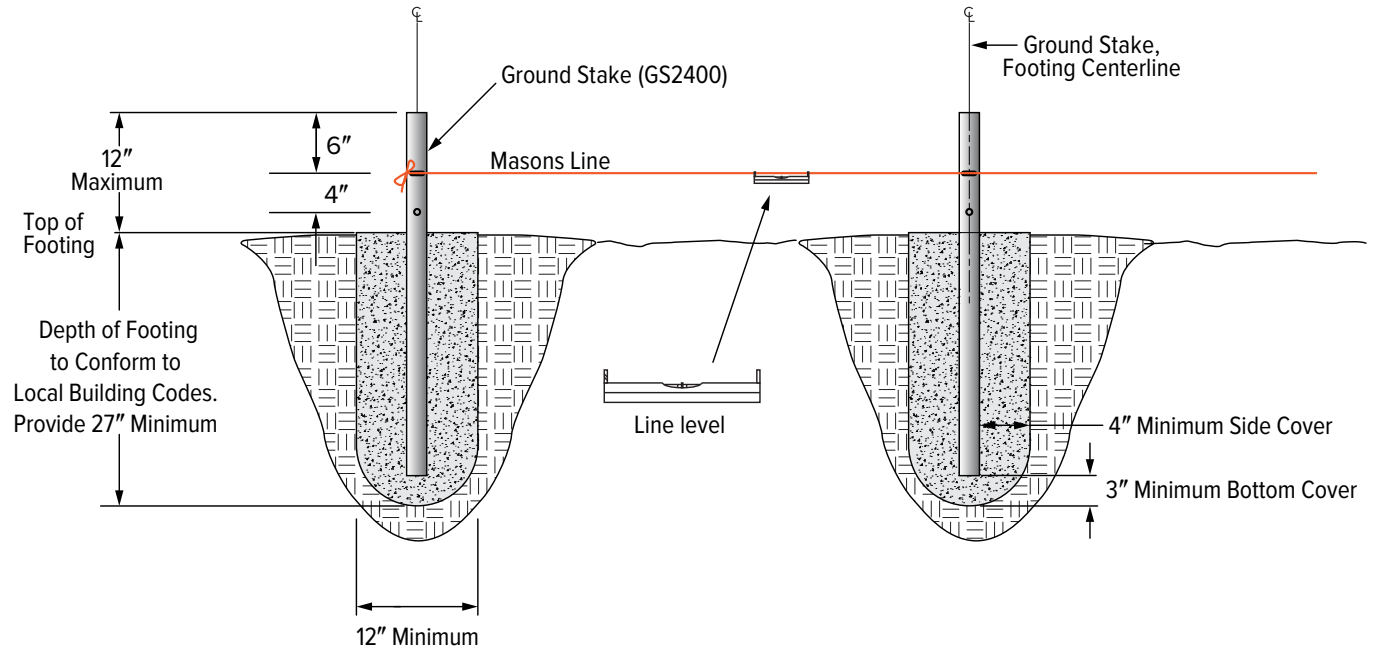

Steps

Ground stakes are set into concrete so that the top of each stake is 12" above the top of the footing. Ensure that the ground stakes remain plumb while pouring the concrete.

A masons (twisted) line is attached between all four corner stakes 6" from the top of stakes. Use a line level to line up all the stakes at the 6" mark.

For longer structures, the masons line may need to be supported every 50' to prevent sagging. Sight down the line visually to check the straightness of the line.



The **Straight Side HP3546** and **Mid-Section HP3548** can be preassembled to save time. It is recommended that the side section sub-assemblies be assembled on a flat surface so parts will be aligned properly.

- 1** Insert the **Straight Side HP3546** into the **Mid-Section HP3548**. See Detail A.
- 2** Secure frame sections together using two, (2) **1/4"-14 X 1" Self-drilling Screws (NB1809)** installed at each connection. See Detail B.
CAUTION: Do not install the self-drilling screws so that the heads of the screws face upwards. Doing so will allow the screw heads to come in contact with the Poly Sheeting Cover causing damage to the Poly Cover.
- 3** Place a mark on all Mid-Section Tubes $50 \frac{3}{16}$ " from the swaged end of the tube. This mark is for the Purlin and Purlin Fastener location. See Detail C.

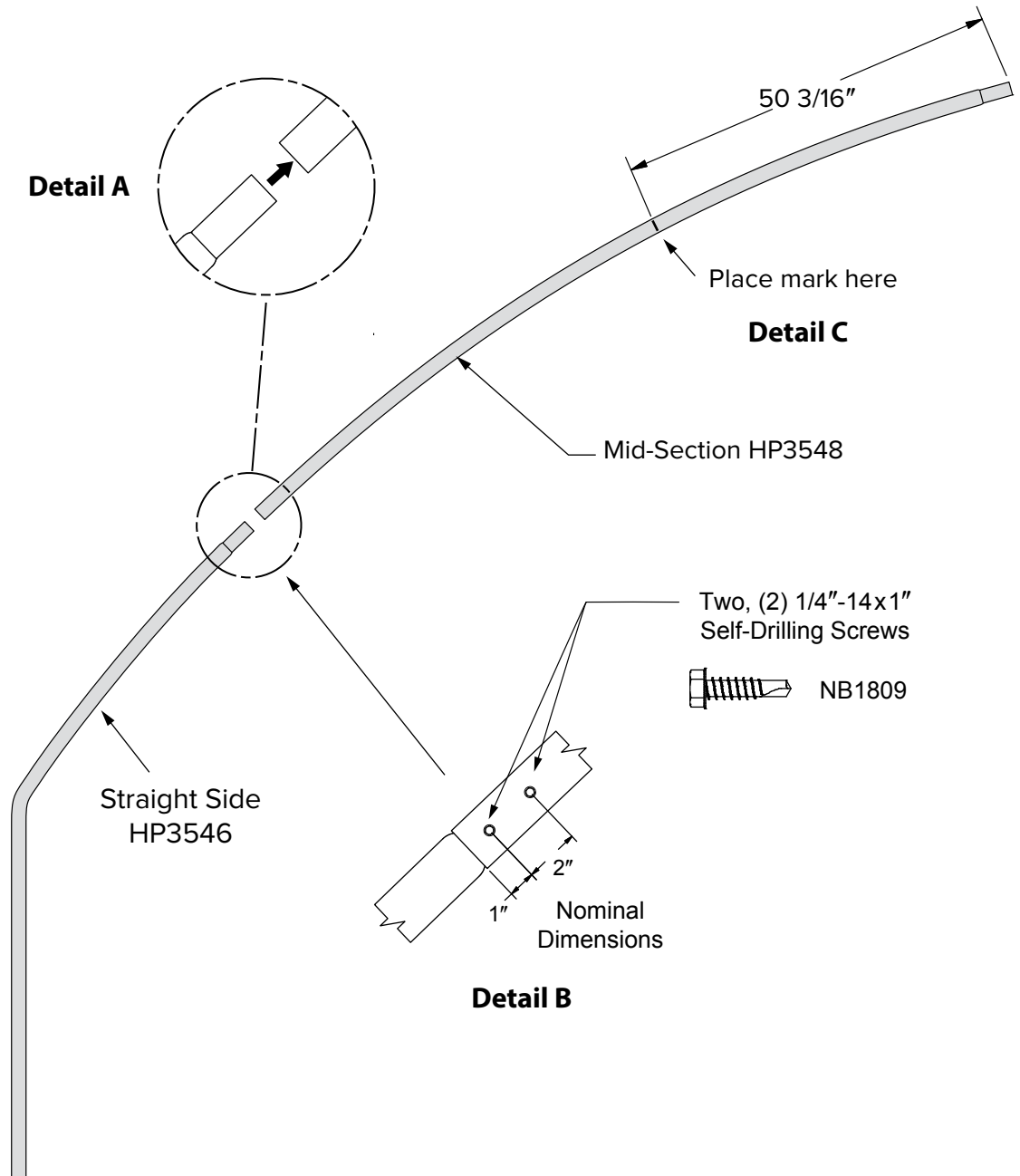

Building Main Frame Sections

Note: Choose a flat surface when assembling these components to ensure that all parts are in alignment.

- 1 Insert each Side Assembly into **Peak Section (HP3547)**.
- 2 Secure frame sections together using two, (2) **1/4"-14 X 1" Self-drilling Screws (NB1809)** installed at each connection. See Detail B.

CAUTION: Do not Install the self-drilling screws so that the heads of the screws face upwards. Doing so will allow the screw heads to come in contact with the Poly Sheeting Cover causing damage to the Poly Cover.

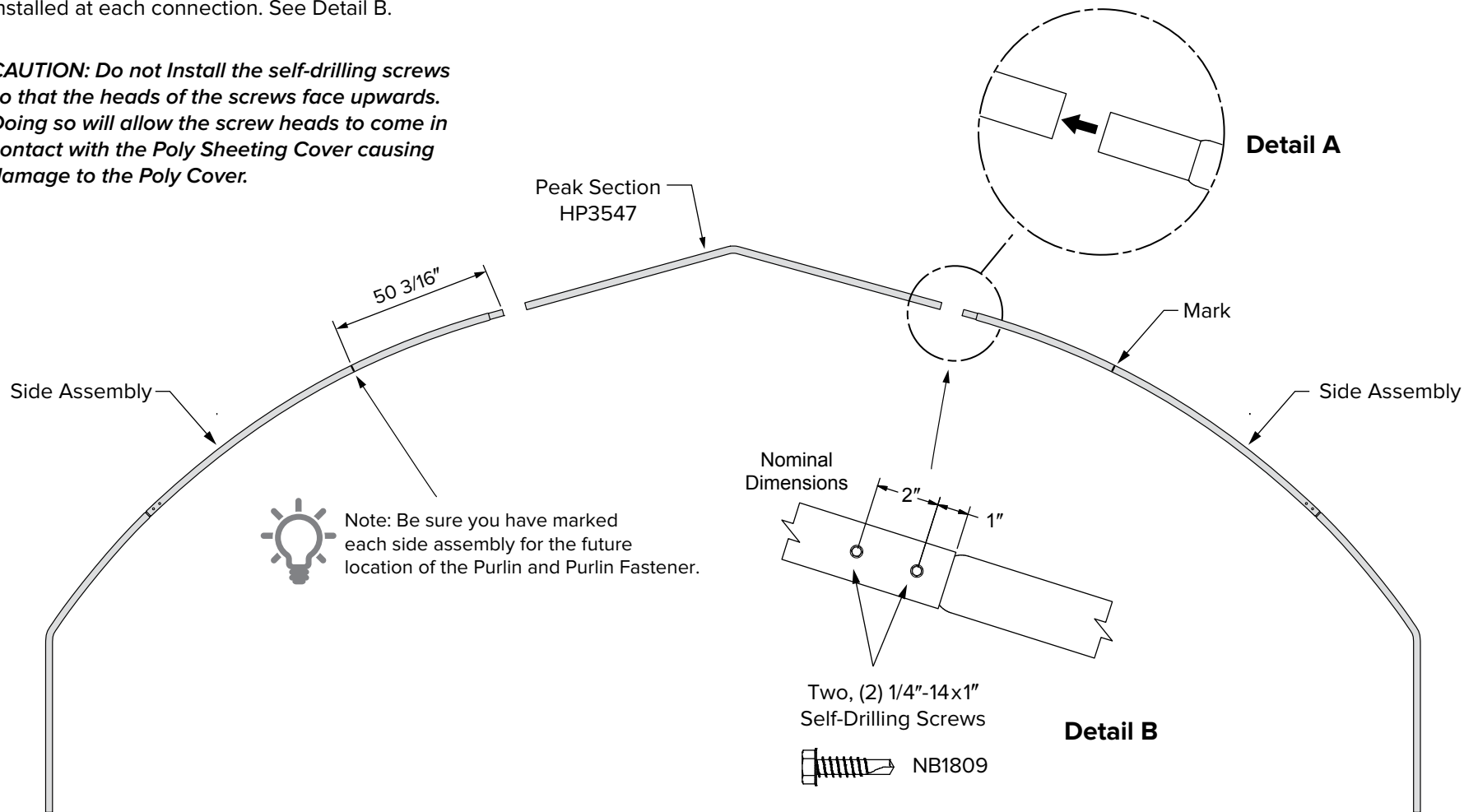

Erecting Initial Frame Sections

- 1** Slide first three frame sections over the ground stakes until they rest on the leveling screws previously installed in each ground stake. Use temporary wood bracing if necessary.
- 2** Fasten the frame sections to the ground stakes using two, (2) **1/4"-14 x 1" Self-drilling Screws**. See Detail A.

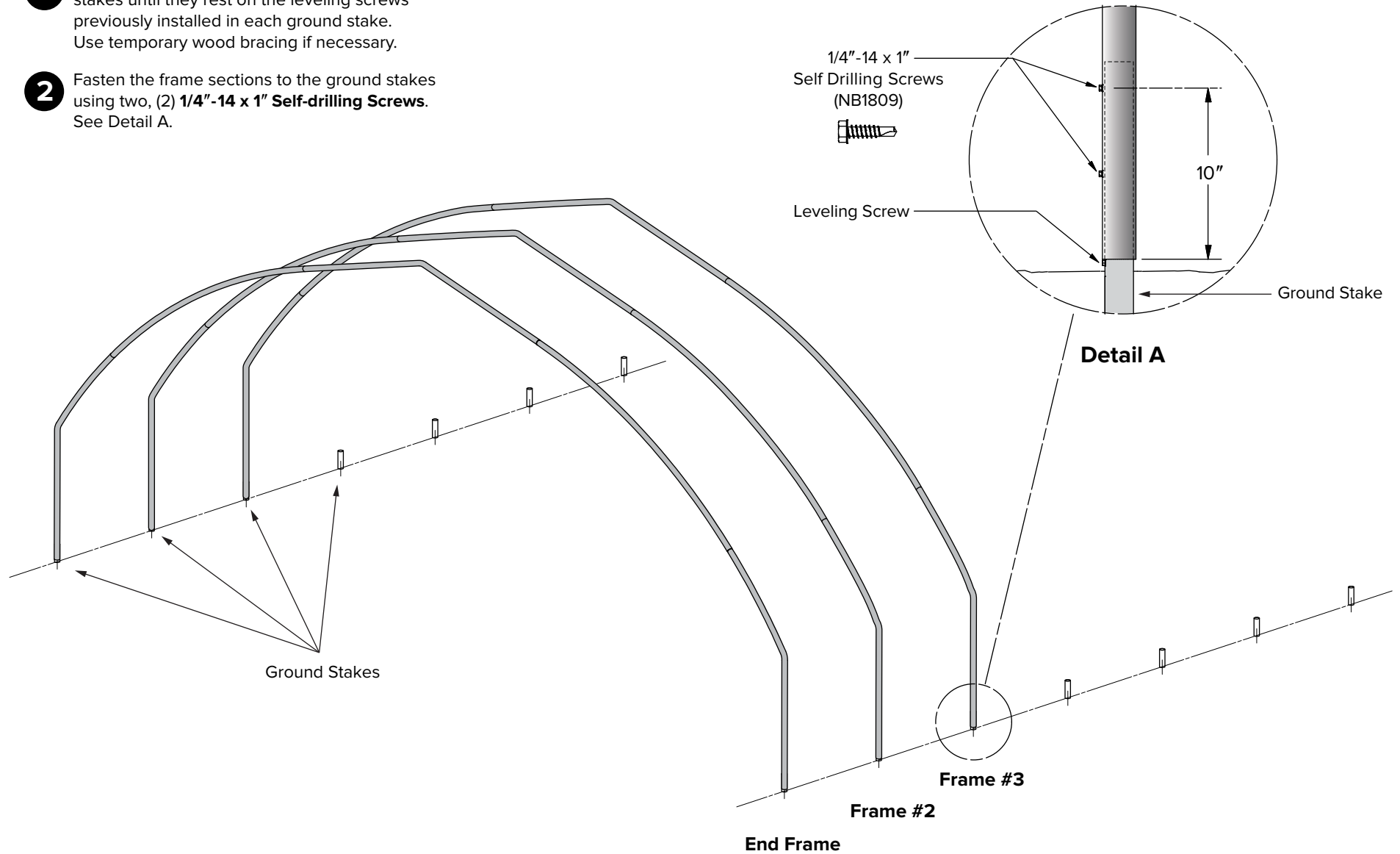

Adding Diagonal Braces

Note: The **Main Frames** can be installed on 4 foot or 6 foot centers. The drawings at the lower right show where to place the **Diagonal Braces**.

- 1** Attach a **Speed Hook (FT2079)** to Frame #3 at point 'X' at a height of 43-1/2". See drawings below.
- 2** Attach another **Speed Hook** near the bottom of **Frame #2**. Attach the (specified) **Diagonal Brace** between these two **Speed Hooks**. Use a carriage bolt, lock washer, and hex nut to attach the **Diagonal Brace**. Do not fully tighten at this time. Final adjustment may be required after the **Peak Brace** has been installed. See Details A & B.

- 3** Attach **HT Peak Brace (HP3503)** between points 'X' and 'Y'. The angled end of the **Brace** attaches at point 'X'. You will need a **Speed Hook (FT2079)** to attach the **Brace** to the End Frame using carriage bolts/washer/nut. See Detail C. Check to see that frame sections are plumb and then final tighten all hardware.

After all the Main Frames and Purlins have been erected, Steps 1–3 will be repeated to attach Diagonal and Peak Braces to the other end of the structure.



IMPORTANT: Play it safe when working at heights. Scaffolding is preferred when installing higher components. Use a helper when necessary.

Important: Make sure screws and ends of carriage bolts do not face outwards to avoid damage to poly covering. All components attached to Long Speed Hooks must be mounted on the outside of the tabs. NEVER install any components between the tabs.

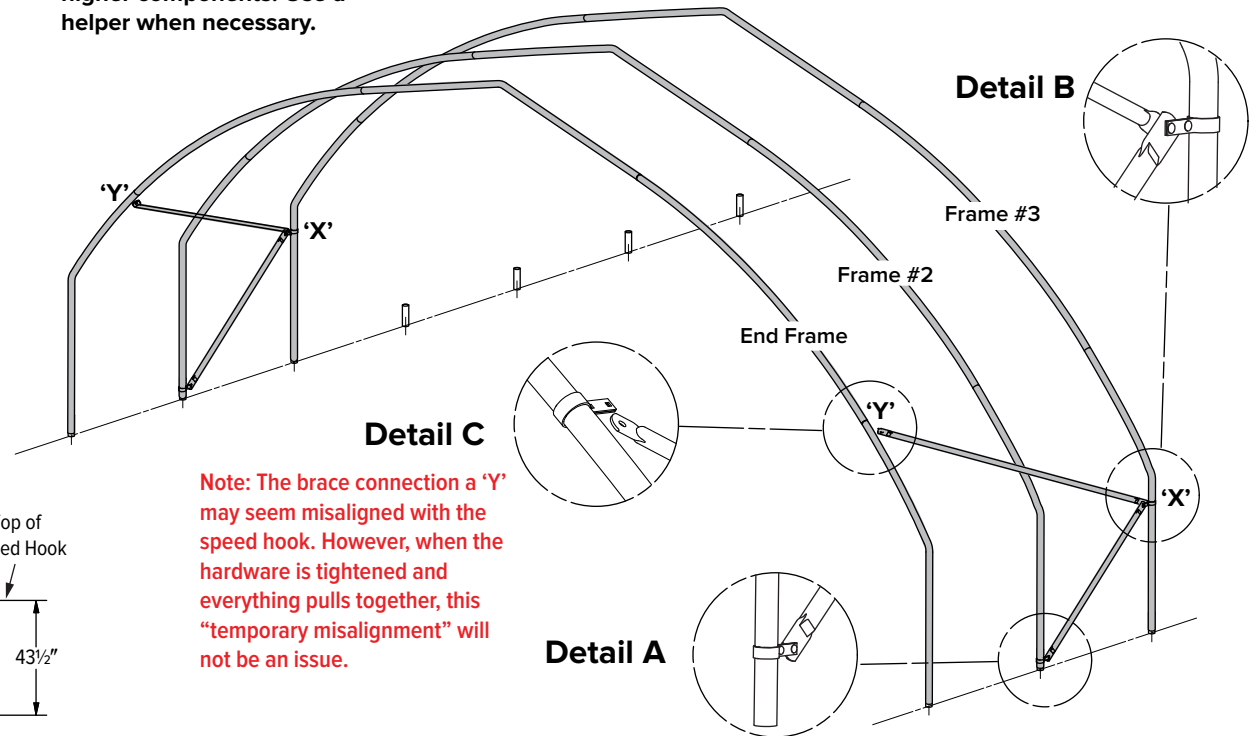
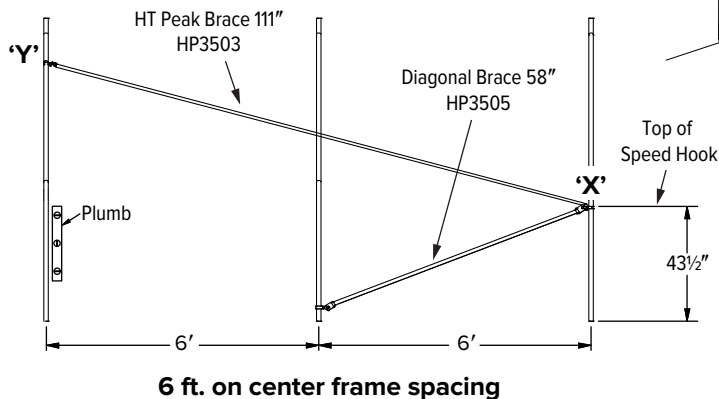
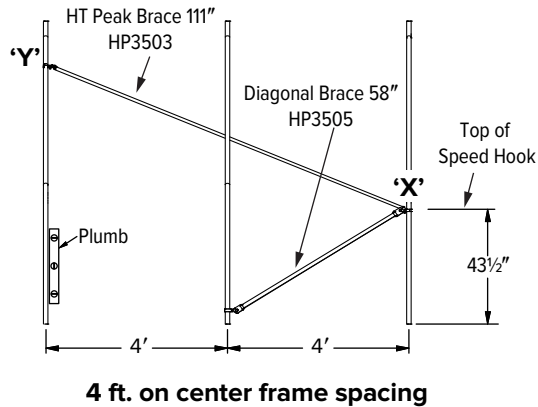
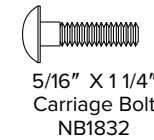
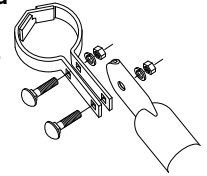

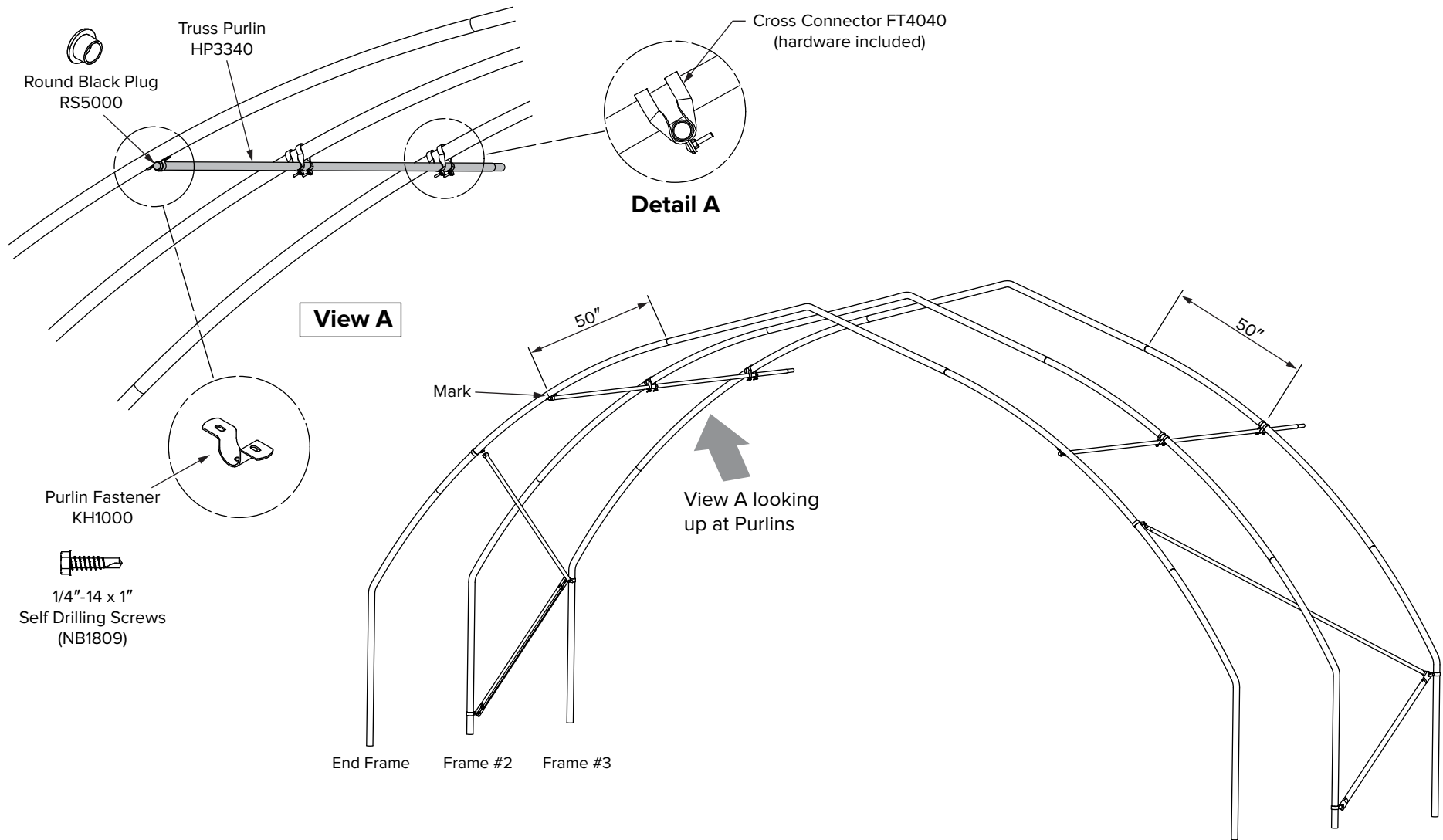

1 Attach a **Cross Connector (FT4040)** to both sides of Frames 2 & 3. Center the **Cross Connectors** over the 50\" mark previously placed on the side section(s). Secure the **Cross Connectors** using (included) carriage bolts/washers/nuts. See Detail A.

2 Slide a **Truss Purlin (HP3340)** through both **Cross Connectors** making sure the non-swaged end faces outward and is flush with the **End Frame**. Secure the **Purlin** to the **End Frame** using the **Purlin Fastener (KH1000)** and **1/4\"-14 X 1\" Self-drilling Screws (NB1809)**. See View A. Insert **Round Plastic Plug (RS5000)** into end of **Purlin**. Repeat Steps 1 & 2 for other side of structure.

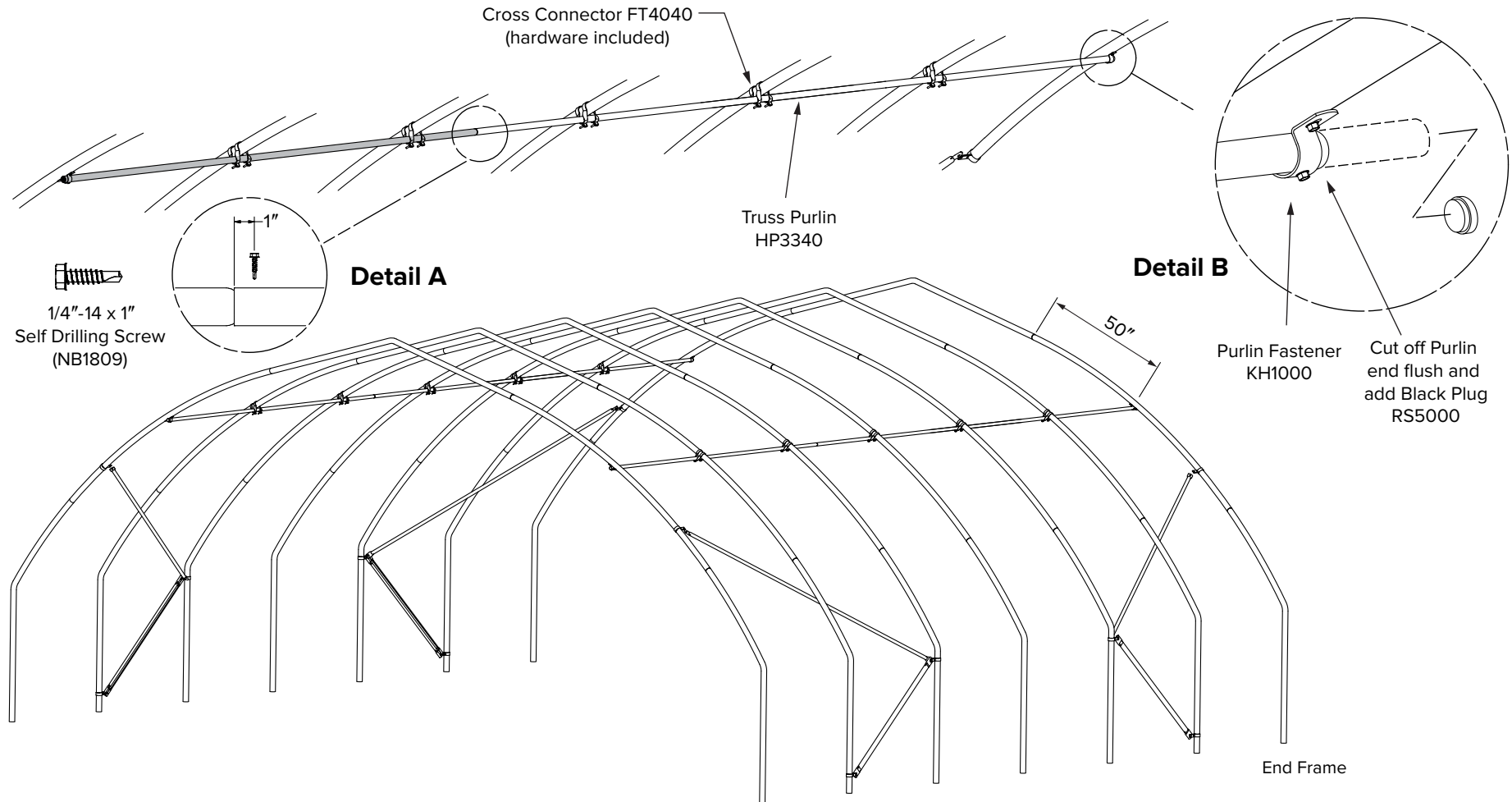

- 1** Continue to add the rest of the **Main Frames**. You may want to work in stages and install the **Truss Purlins (HP3340)** as you go along. After the **End Frame** is installed, you need to add the four **Cross Braces**. See steps 1–3 on page 17.
- 2** Insert new **Truss Purlin** sections onto the swaged end of the previous **Truss Purlin** until you reach the end. Secure the **Purlin** sections using **Cross Connectors (FT4040)** in same manner as shown in Detail A on previous page. Check that each frame is plumb before you proceed to the next frame.

- 3** Use a **1/4"-14 X 1" Self-drilling Screw (NB1809)** at each splice. See Detail A.
- 4** After you install the last **Purlin** on each side, you will need to trim the end of each **Purlin** flush with the **End Frame**. Use **1/4"-14 X 1" Self-drilling Screws (NB1809)** and **Purlin Fastener (KH1000)** to secure **Purlin** to the **End Frame**. Insert the **Round Black Plug (RS5000)** into the end of each **Purlin**. See Detail B.

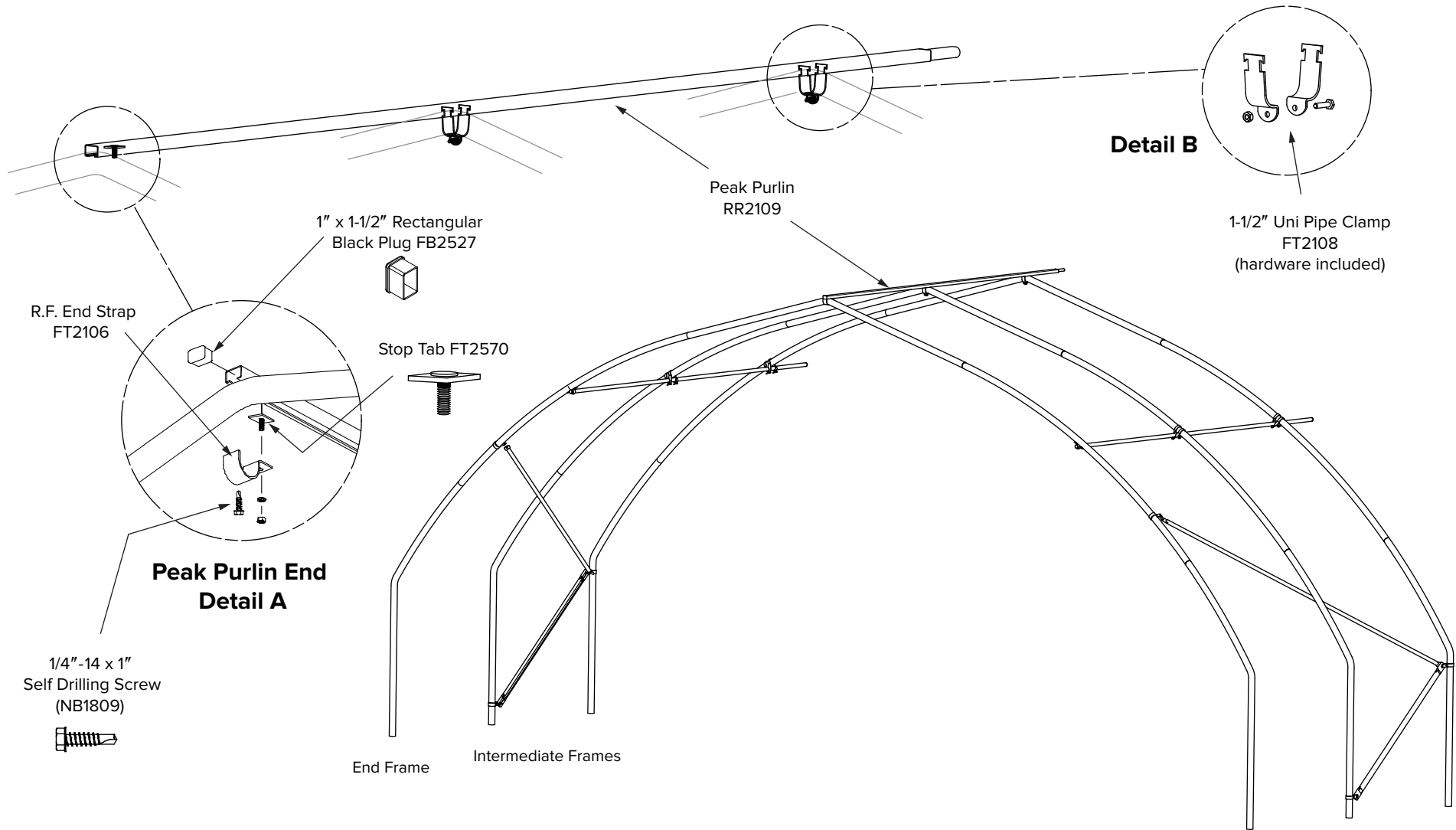

1 Insert the **Stop Tab (FT2570)** into the Purlin channel. Align the **Peak Purlin (RR2109)** flush with the End Frame. Place the **End Strap (FT2106)** onto the threaded end of the **Stop Tab** and attach with **5/16" Hex Nut (NB1872)** and **5/16" Lock Washer (NB1862)**. See Detail A.

2 Secure the **End Strap** to the underside of the End Frame with a **1/4"-14 x 1" Self Drilling Screw (NB1809)**. Insert a **Rectangular Black Plug (FB2527)** into the end of the **Peak Purlin** channel. See Detail A.

3 Use a **Uni Pipe Clamp (FT2108)** to secure the **Peak Purlin** to each intermediate **Main Frame**. Take apart the **Uni Clamp** and insert the notched ends into the **Purlin** channel. Fit the **Uni Clamp** pieces around the **Main Frame** and secure with the included hardware. See Detail B.

1 Insert additional **Peak Purlin** sections onto the swaged end of the previous **Peak Purlin** until you reach the end. Install a **1/4" - 14 x 1" Self Drilling Screw (NB1809)** at each splice as shown in Detail B below.

Secure **Purlins** at each **Main Frame** using a **Uni Pipe Clamp (FT21108)** with included hardware. See Detail A below.

2 After the last **Peak Purlin** section has been installed, trim the **Purlin** end flush with the **End Frame**. Fasten the end of the **Purlin** to the **End Frame** using same **End Strap** and hardware as used on the first **End Frame**. See Detail A at top of page 20.

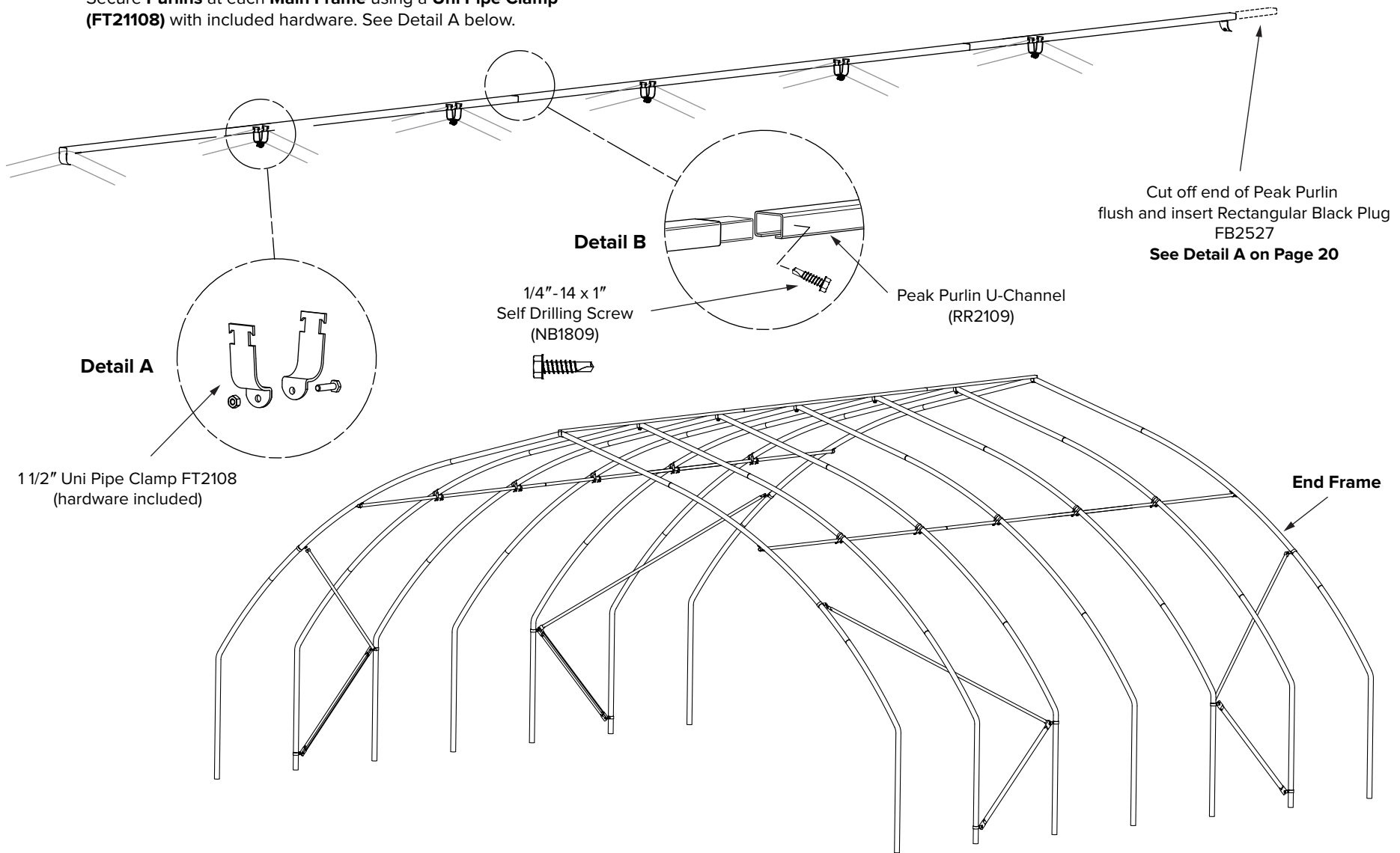

- 1 Mark the location(s) where the four **Band Brace(s) HY2027** are located on the Main Frame. The measurements shown are from the points where Main Frame components are joined together.



The lower **Band Brace(s) HY2027** can be held in place temporarily with a self-drilling screw. See Detail A.

This will keep the lower Band Braces in place until the Chord has been installed as detailed on page 23.

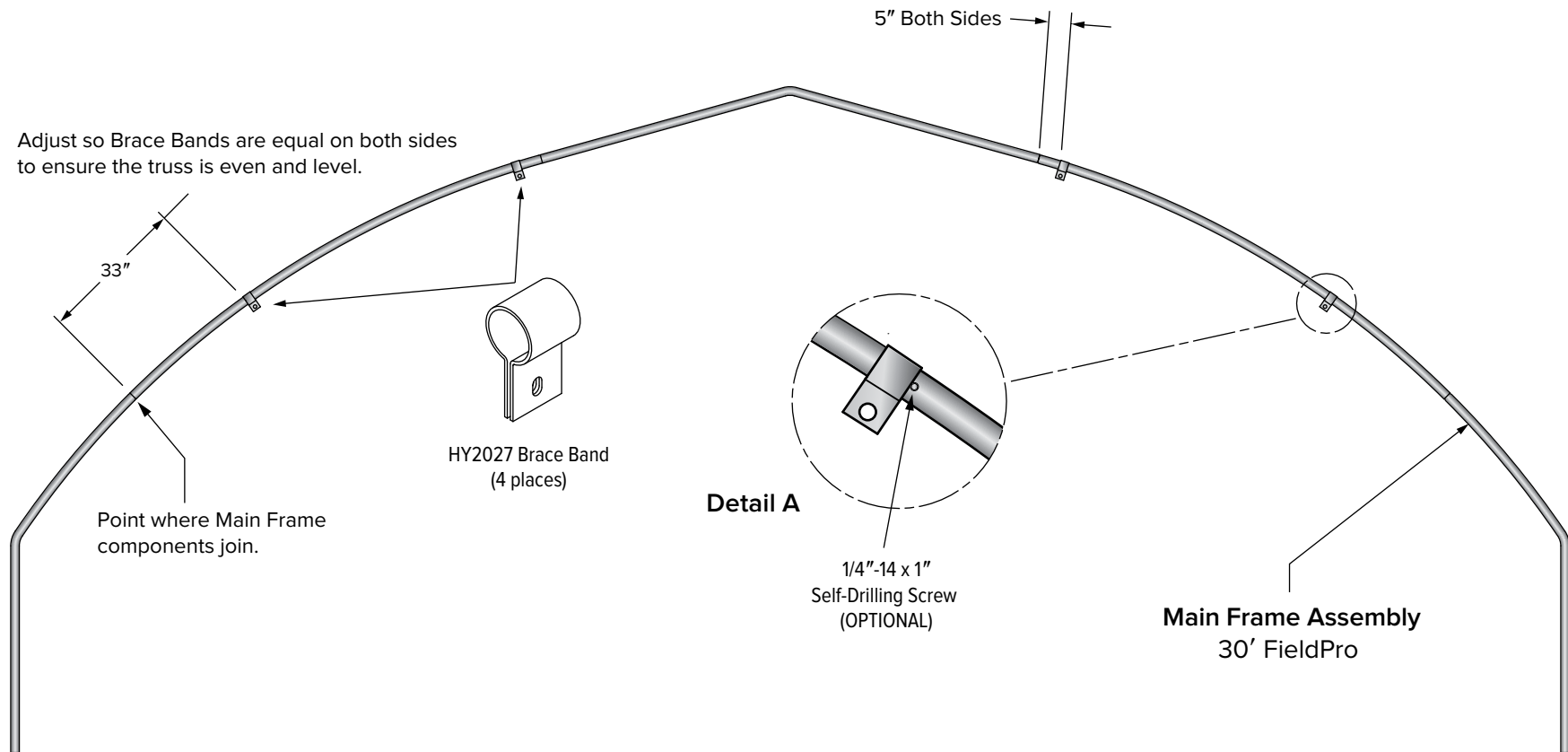

- 1** Assemble the **Chord Sections** on a flat surface. Make sure that the tabs on each end are facing the same direction. Secure the **Chord Sections** together using **1/4" - 14 X 1" Self-drilling Screws (NB1809)** as shown in Detail B.
- 2** Mount the assembled Chord section to the prepositioned **Brace Brackets (HY2027)** on the Main Frame using **3/8" x 1-1/4" Carriage bolts, 3/8" Lock Washers, and 3/8" Hex Nuts**. See Detail A.
Adjust the Brace Bands until the Chord Assembly is level.
- 3** Attach the **Strut(s) HT1023** to the **Brace Brackets** on the **Main Frame** and the assembled horizontal **Chord Section**. Each end of the **Strut** uses a different **Brace Bracket and Carriage Bolt/Washer/Hex Nut**. (See Details A and B.)

Important:
Components attached to **Brace Bands** must be mounted on the **outside of the tabs**. **NEVER** install any components **between the tabs**.

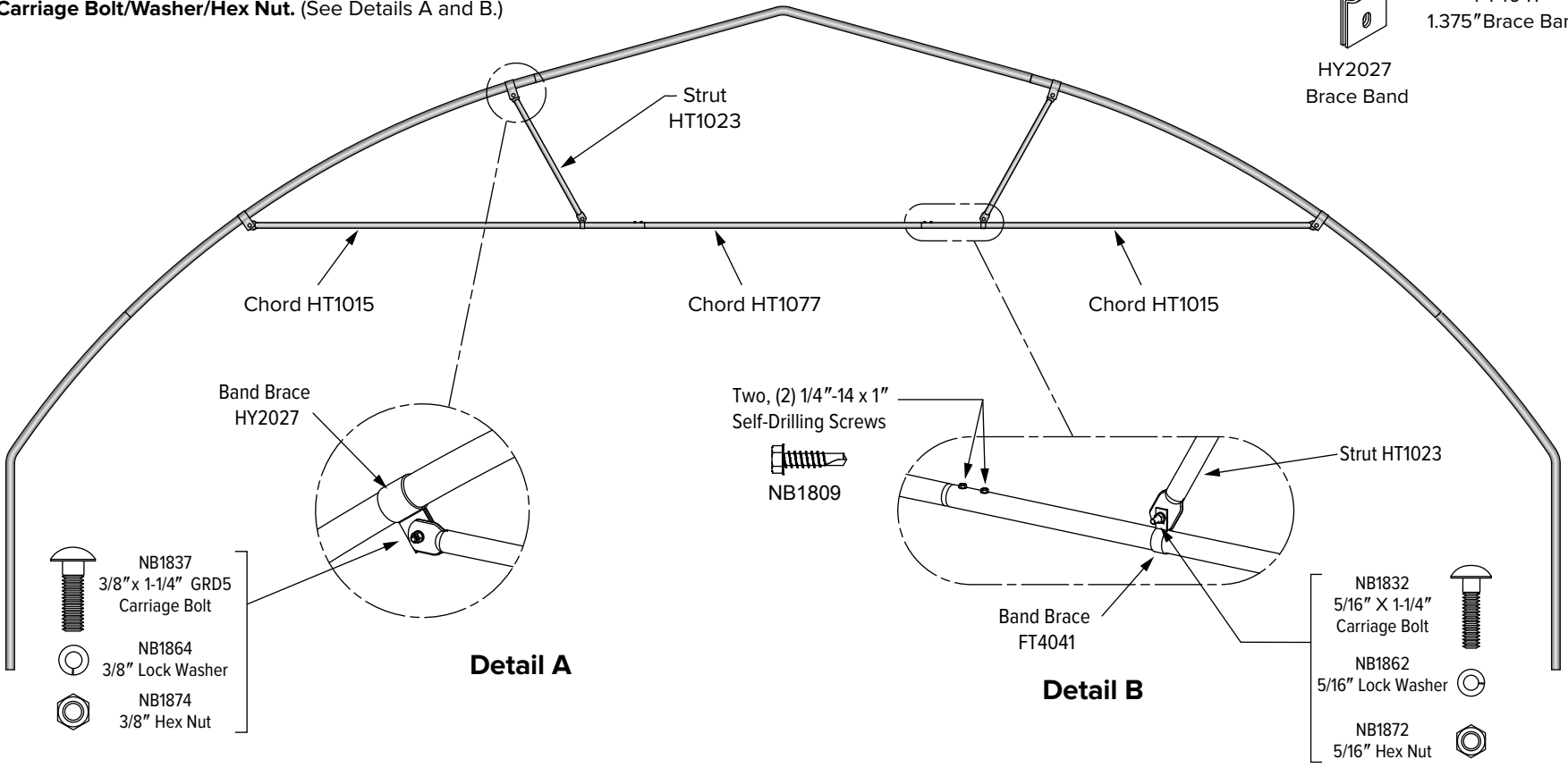
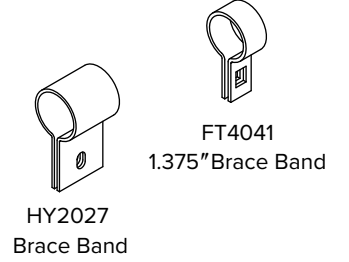
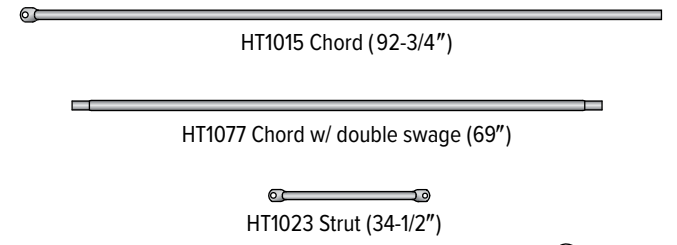
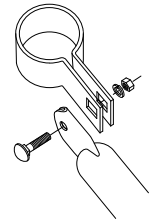

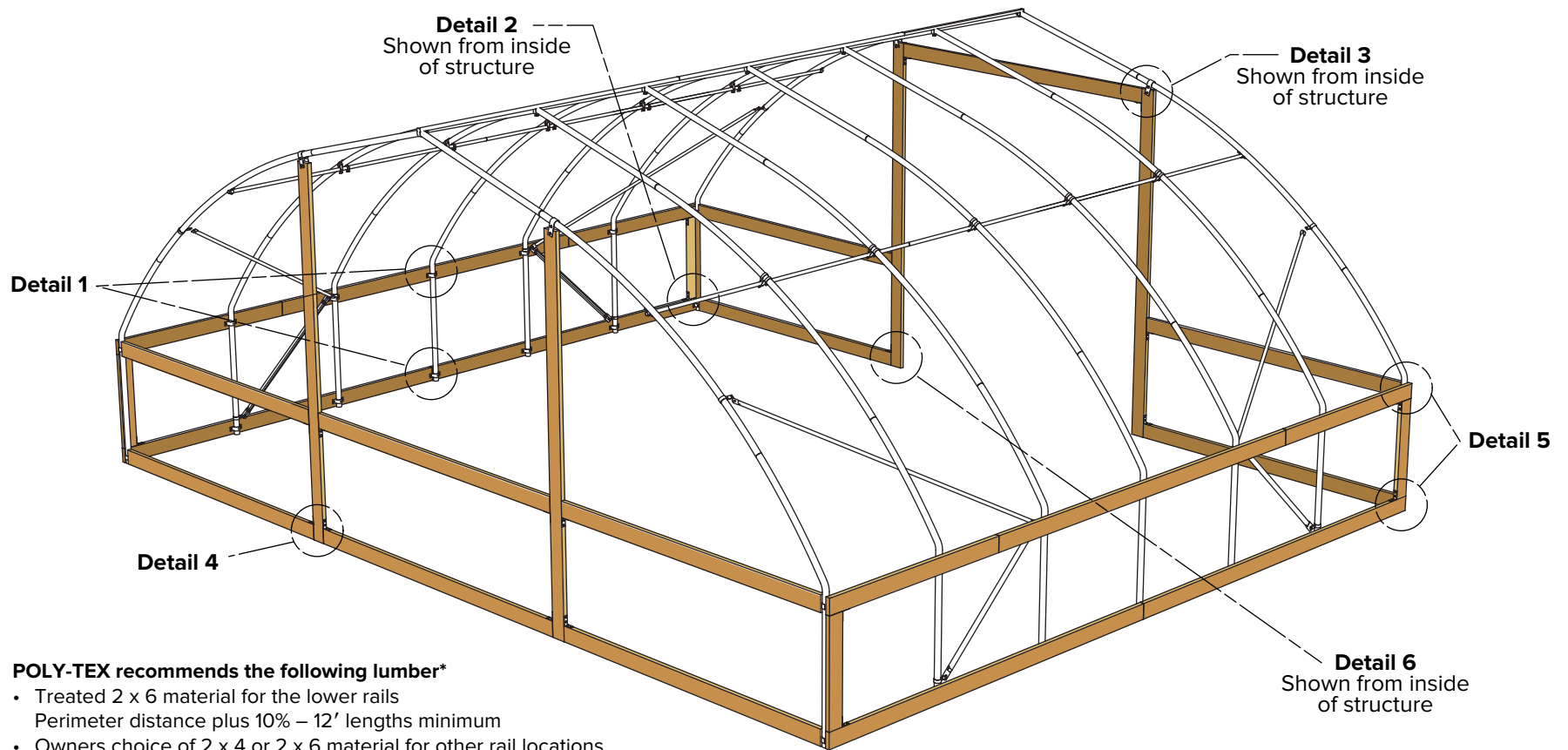

POLY-TEX recommends the following lumber*

- Treated 2 x 6 material for the lower rails
Perimeter distance plus 10% – 12' lengths minimum
- Owners choice of 2 x 4 or 2 x 6 material for other rail locations
Perimeter distance plus 10% – 12' lengths minimum
- Additional 10' lengths of treated material required.
Two pieces for the filler boards and three for each end
(Not required for optional steel door frame.)

Notes:

1. The upper side rails are not necessary for the ground-to-ground poly roof applications.
2. If structure was purchased with the optional door, see pages 34–36 for frame installation instructions.

- Lumber supplied by others

Details 1–6 are illustrated on the next page.

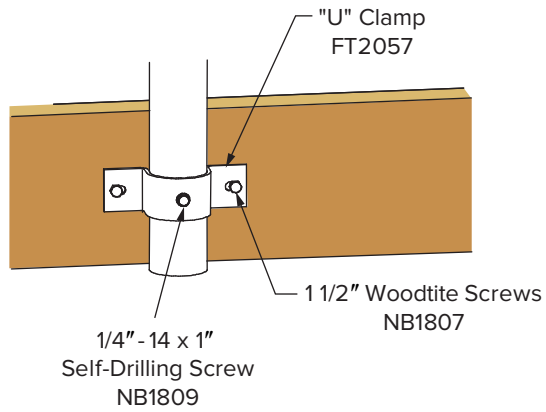

Detail 1

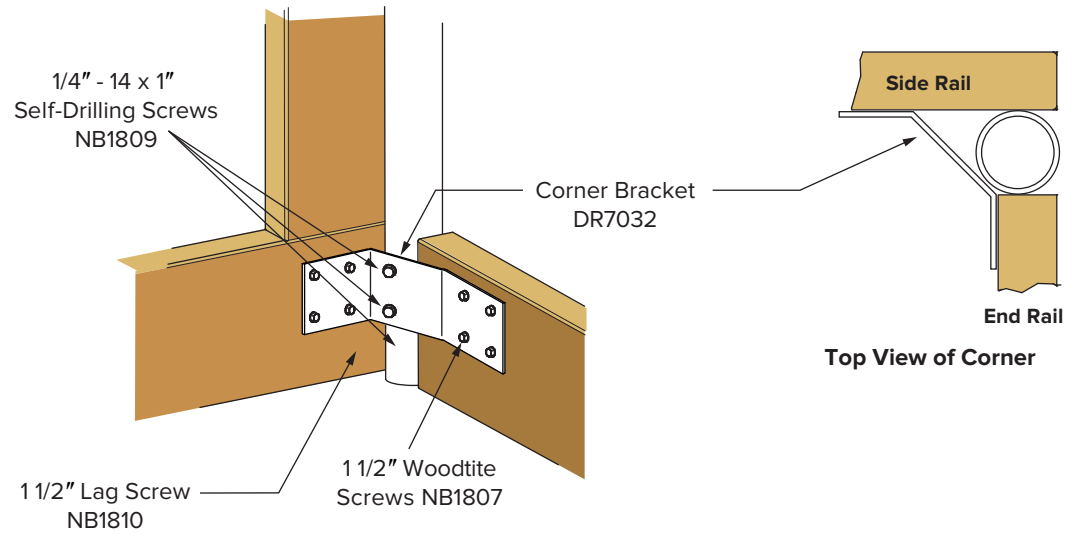

Detail 2
Shown from inside of structure

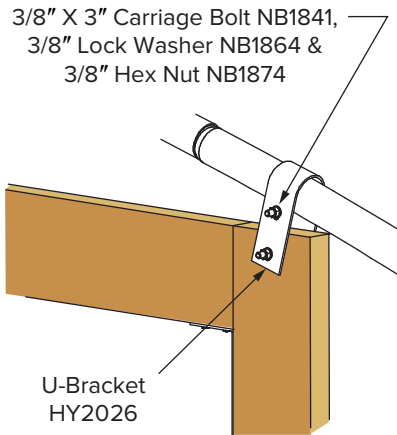
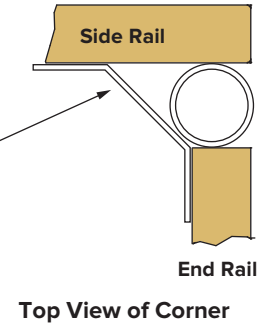

Detail 3
Shown from inside of structure

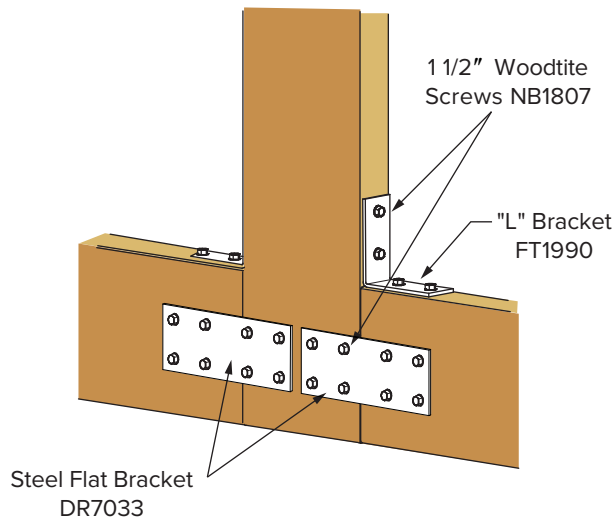

Detail 4

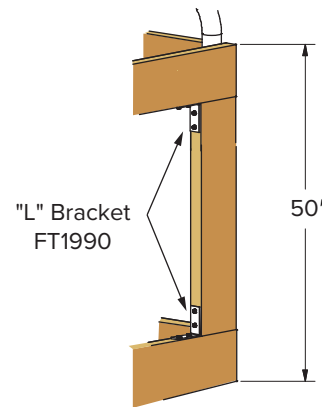

Detail 5

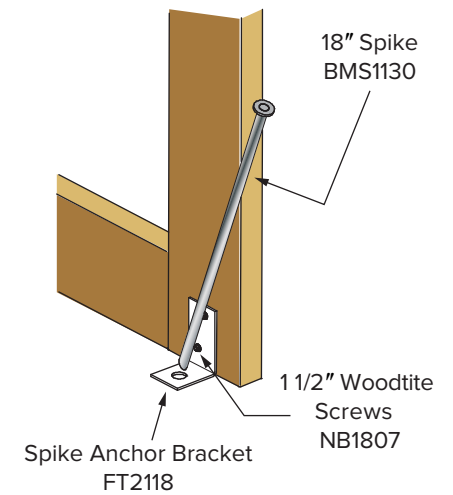

Detail 6
Shown from inside of structure

Plain End Wall Wiggle Wire Base Material Installation

Note: Refer to page 34 for optional metal jamb details.

- 1** Attach **Wiggle Wire Base** to the outside of the bottom **Wood Base Rail** flush with the top. Section B-B shows proper screw usage.
- 2** Install **Wiggle Wire Base** to **End Frame** starting at the bottom of the **Wood Rail** on each side. Install the **Wiggle Wire Base** over the top of the **Peak Purlin**. See Detail A. The **Wiggle Wire Base** is to be installed as one continuous run from one side of the **End Wall** to the bottom of the opposite side. Section A-A shows proper screw usage.

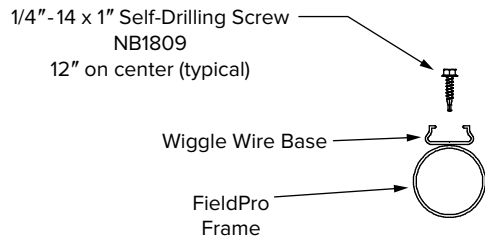
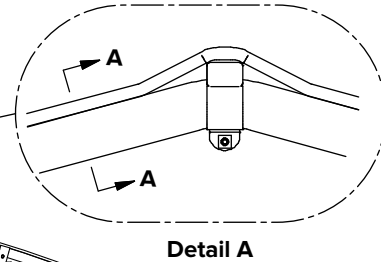
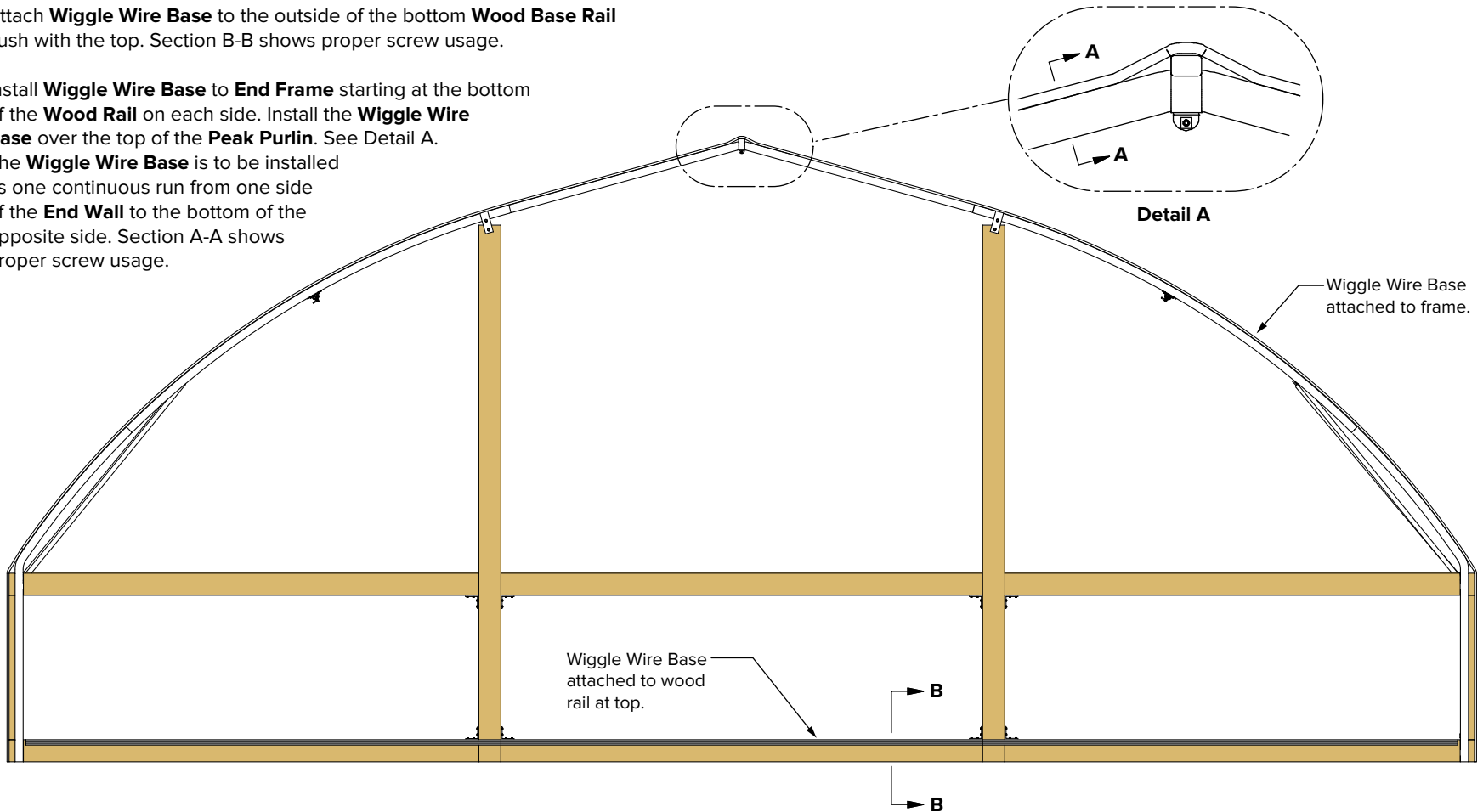

Section A-A

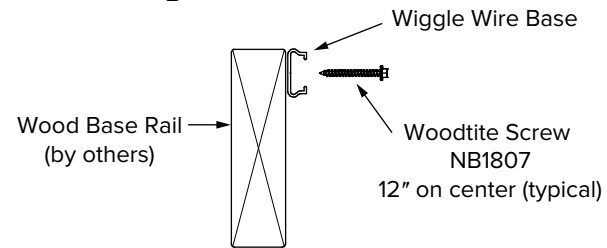

Section B-B

1 **Positioning the Poly**
You will need some help with this step. After all the **Wiggle Wire Base** has been attached, position the **Poly Film** over the **End Frame**. Be sure to have leave excess **Poly** on all sides. You can always trim the **Poly** closer after the installation is completed.

 You may want to install a few 12" pieces of the **Wiggle Wire** here and there to keep the large sheet of **Poly** temporarily in place. This will also provide an opportunity to pre-stretch the **Poly**. These 12" pieces can be reused to reinforce the corners after all the **Wiggle Wire** is installed.

2 Begin to install the **Wiggle Wire** all around the **End Frame** and across the **Lower Wood Rail**.

Note: See page 30 for instructions on how to retain the **Poly** in the **Wiggle Wire Base** using the **Wiggle Wire**.

If the **Poly** is installed on a cool day, it will expand when the outside temperature warms. It may be necessary to retension the sheet of **Poly**.

After all the **Wiggle Wire** is installed, use 12" pieces to reinforce the corners. See details on page 30.

Trim Poly leaving a minimum of 1" of material all around.

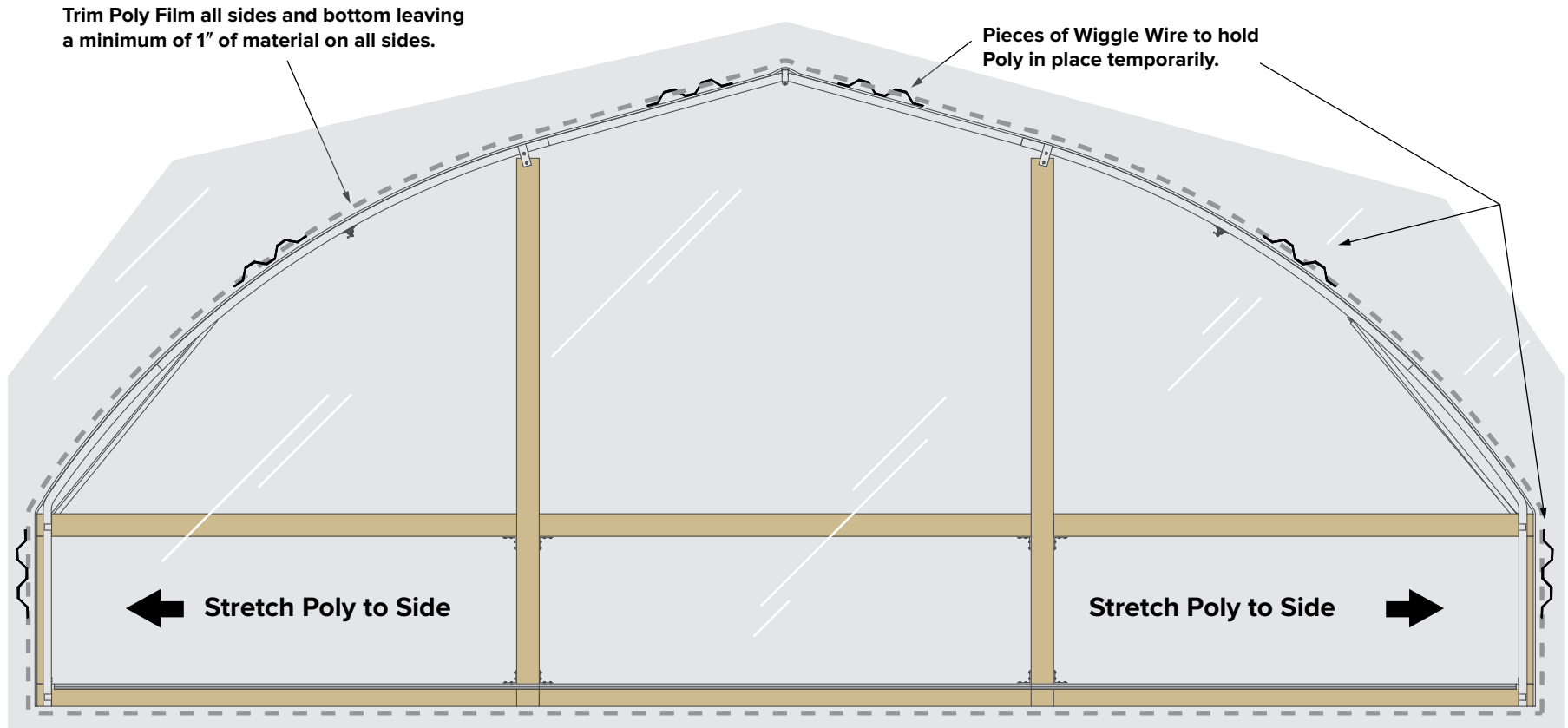

Open Doorway – Wood Frame – Part 1

Note: See pages 24 and 25 for details about adding wood components and hardware details.

- 1** Attach **Wiggle Wire Base** to the outside of the bottom **Wood Base Rail** flush with the top. Section B-B shows proper screw usage.
- 2** Attach **Wiggle Wire Base** to both side of vertical jambs and across bottom of header.
- 3** Install **Wiggle Wire Base** to **End Frame** starting at the bottom of the **Wood Rail** on each side. Install the **Wiggle Wire Base** over the top of the **Peak Purlin**. See Detail A. The **Wiggle Wire Base** is to be installed to the top of the **End Wall** as one continuous run from one side to the bottom of the opposite side. Section A-A shows the proper screw usage.

Wiggle Wire Base attached to frame.

Wiggle Wire Base attached to wood rail at top (each side).

Wiggle Wire Base around opening

Note: Refer to pages 34–36 for optional Roll-Up Door Kit HT3004 with metal jamb.

1/4"-14 x 1" Self-Drilling Screw NB1804
12" on center (typical)

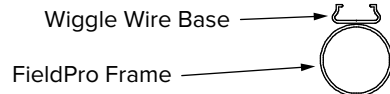

Section A-A

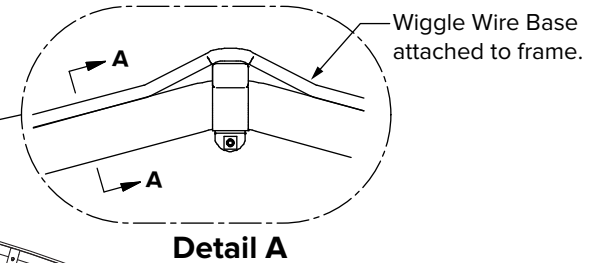

Detail A

10' x 10' Opening

Wood Base Rail (by others)

Woodtite Screw NB1807
12" on center (typical)

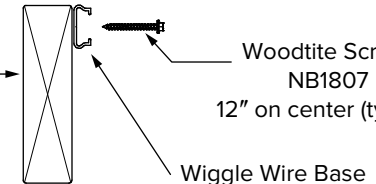

Section B-B

Positioning the Poly

You will need some help with this step. After all the **Wiggle Wire Base** has been attached, position the **Poly Film** over the **End Frame**. Be sure to have leave excess **Poly** on all sides. You can always trim the **Poly** closer after the installation is completed.

You may want to install a few 12" pieces of the **Wiggle Wire** here and there to keep the large sheet of **Poly** temporarily in place. This will also provide an opportunity to pre-stretch the **Poly**. These 12" pieces can be reused to reinforce the corners after all the **Wiggle Wire** is installed.

Install **Wiggle Wire** all around the **End Frame**, across the **Lower Wood Rail** and around door opening.

Note: See page 30 for instructions on how to retain the **Poly** in the **Wiggle Wire Base** using the **Wiggle Wire**.

If the **Poly** is installed on a cool day, it will expand when the outside temperature warms. It may be necessary to retighten the sheet of **Poly**.

After all the **Wiggle Wire** is installed, use 12" pieces to reinforce the corners. See details on page 30.

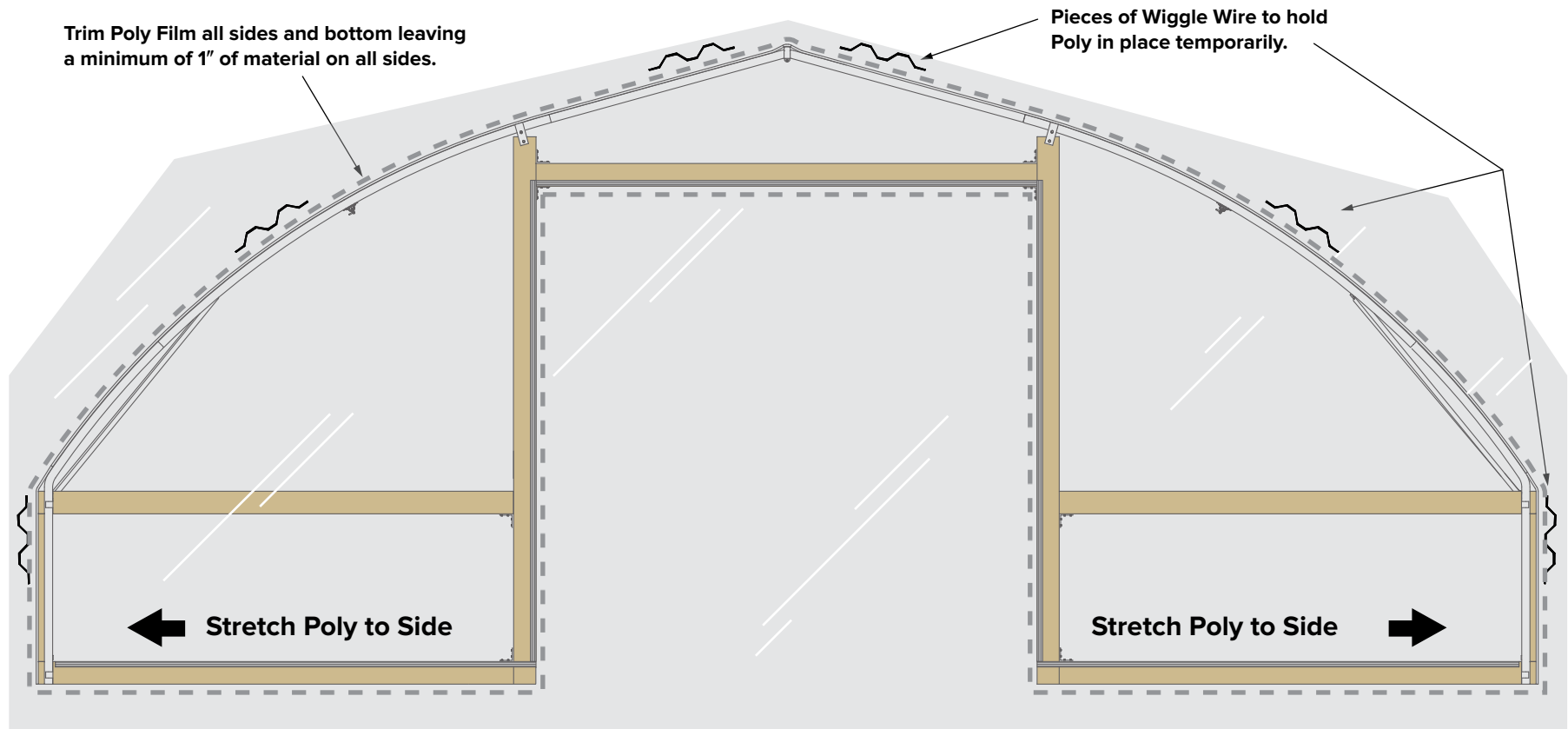

Wiggle Wire Installation



Consider having one person tension the Poly Film while a second person inserts the Wiggle Wire. See Detail 1 on pages 32 and 33.

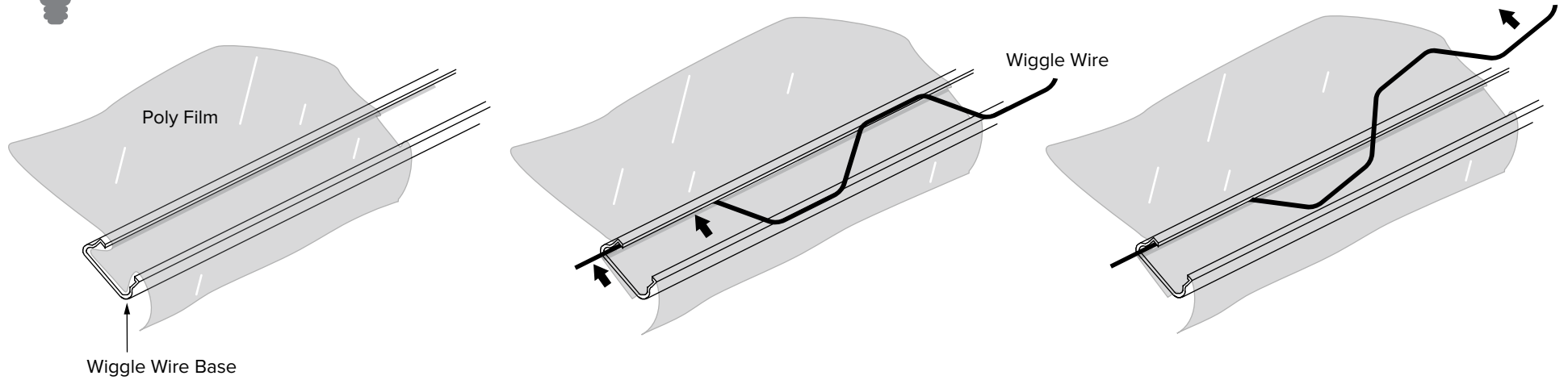

1 Carefully begin to fold the Poly Film into the Wiggle Wire base while keeping a constant tension on the Poly Film to avoid wrinkles.

2 Insert one end of the Wiggle Wire as shown above while maintaining tension on the Poly Film.

3 Bend the Wiggle Wire up just enough to clear the edge of the Wiggle Wire Base.

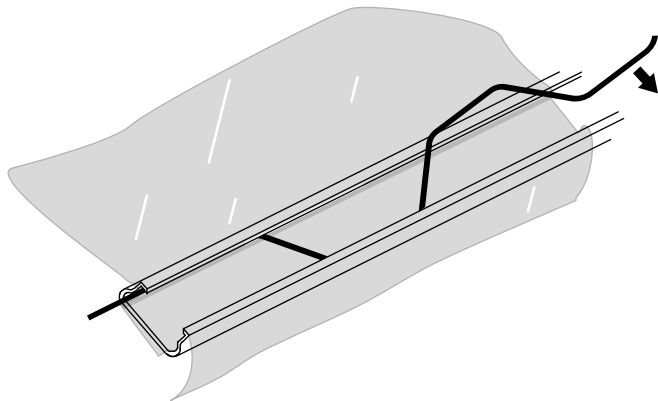

Continue feeding the Wiggle Wire into the Base always keeping the Poly Film under a constant tension to avoid wrinkles.

Overlap previous Wiggle Wire when adding a new Wiggle Wire.

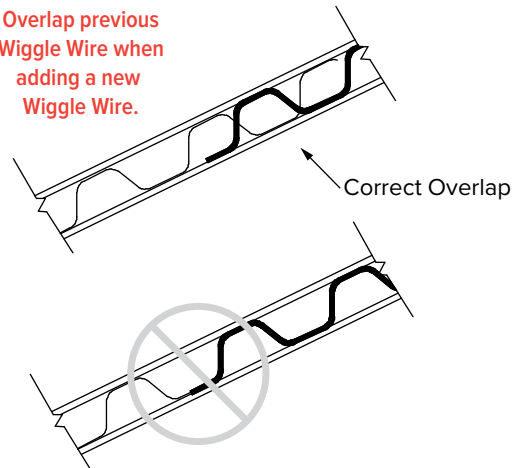

Wrong - No Overlap

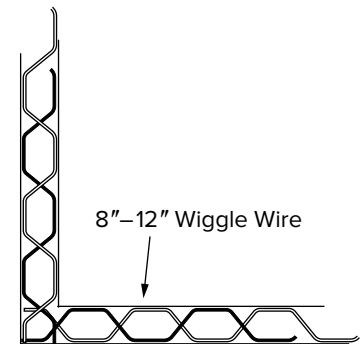

Reinforce all corners with additional 8"-12" sections of Wiggle Wire.

5

NOTE: Take care not to Rub/Pinch/Abraid the Poly with the Wiggle Wire during installation.

General Notes:

- These instructions pertain to both Roof Poly installations and explain the best method for initial placement of the Poly.
- Pick a calm day when attempting to install the Roof Poly. On a windy day, it is almost impossible to handle the Poly.
- If the Poly is installed on a cool day, the material may expand as the temperature warms causing the Poly to droop. If this happens, it may be necessary to re-tension the Poly and adjust the Wiggle Wire as needed at a later date.

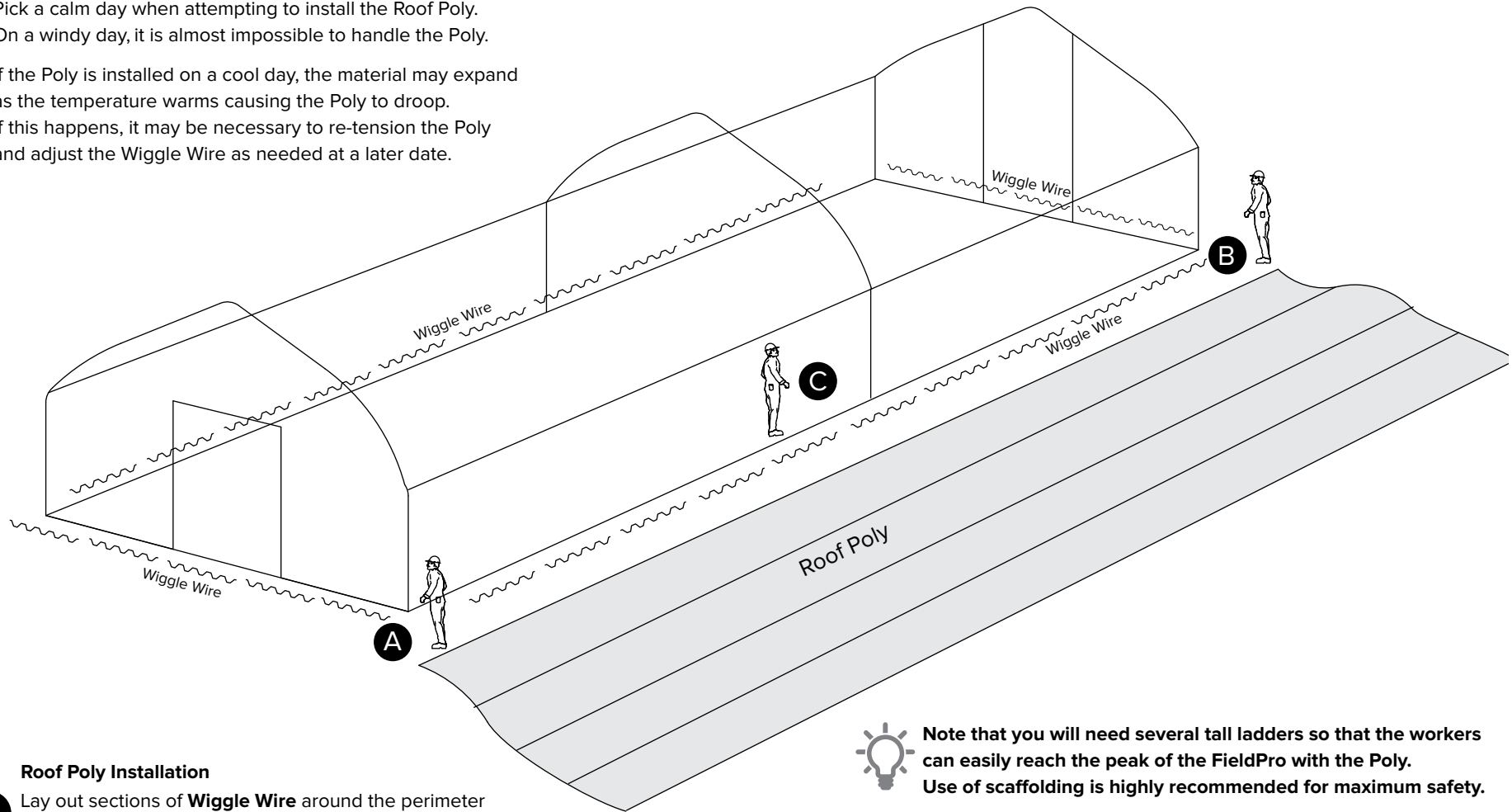

Roof Poly Installation

- 1** Lay out sections of **Wiggle Wire** around the perimeter of the FieldPro so they are handy. Unroll the **Poly** on the ground along the length of the FieldPro. Be sure to have equal overhang at both ends.
- 2** Place one worker at Point **A** and one at Point **B**. It helps to have another worker inside the FieldPro on a ladder near Point **C** to help move the **Poly** up and over the FieldPro frame sections.



Note that you will need several tall ladders so that the workers can easily reach the peak of the FieldPro with the Poly. Use of scaffolding is highly recommended for maximum safety.

Installing Roof Poly on FieldPro with Roll-Up Side Curtain

Note: These instructions are for a FieldPro that will feature the Roll-Up Poly Curtain.
See page 33 for the Ground-to-Ground Roof Poly Installation.

1 Once the Poly is in position, place a couple of temporary sections of **Wiggle Wire** between Point **4** and Point **6** to help prevent the Poly from shifting while the **Wiggle Wire** is installed on the first side.

2 Begin installing **Wiggle Wire** at Point **2** (center of the FieldPro) and work down to Point **1**. Return to Point **2** and install **Wiggle Wire** to Point **3**. Be sure to let the **Poly** edge overhang 3 to 6 inches.

It helps to have two workers install the **Wiggle Wire** to prevent drooping and main proper tension down the entire length. One worker tensions the **Poly** while the second worker follows along inserting the **Wiggle Wire**. Using a helper in this manner while installing the **Wiggle Wire** will make the wrinkles disappear. See Detail 1.

3 Now go to the other side of the FieldPro. Begin Installing **Wiggle Wire** at Point **5** working one side at a time same as the first side. Use a helper again to help tension the **Poly** as the **Wiggle Wire** is inserted.

Be sure the **Wiggle Wire** is seated properly into the **Wiggle Wire Base**. Adjust the **Poly** and **Wiggle Wire** as required.

4 Starting at the top of the **End Frame** at Point **7**, begin installing **Wiggle Wire** down to Point **4**. Go back to top and install **Wiggle Wire** down to Point **1**. Next do the same on the other **End Frame** of the FieldPro.

5 After all the **Wiggle Wire** has been installed on both sides and along the top of both **End Frames** of the FieldPro, the corners (see red dots in illustration) need to be reinforced with additional 12" pieces of **Wiggle Wire**. Also note Detail 2 showing proper way to install the **Wiggle Wire** at the corners.

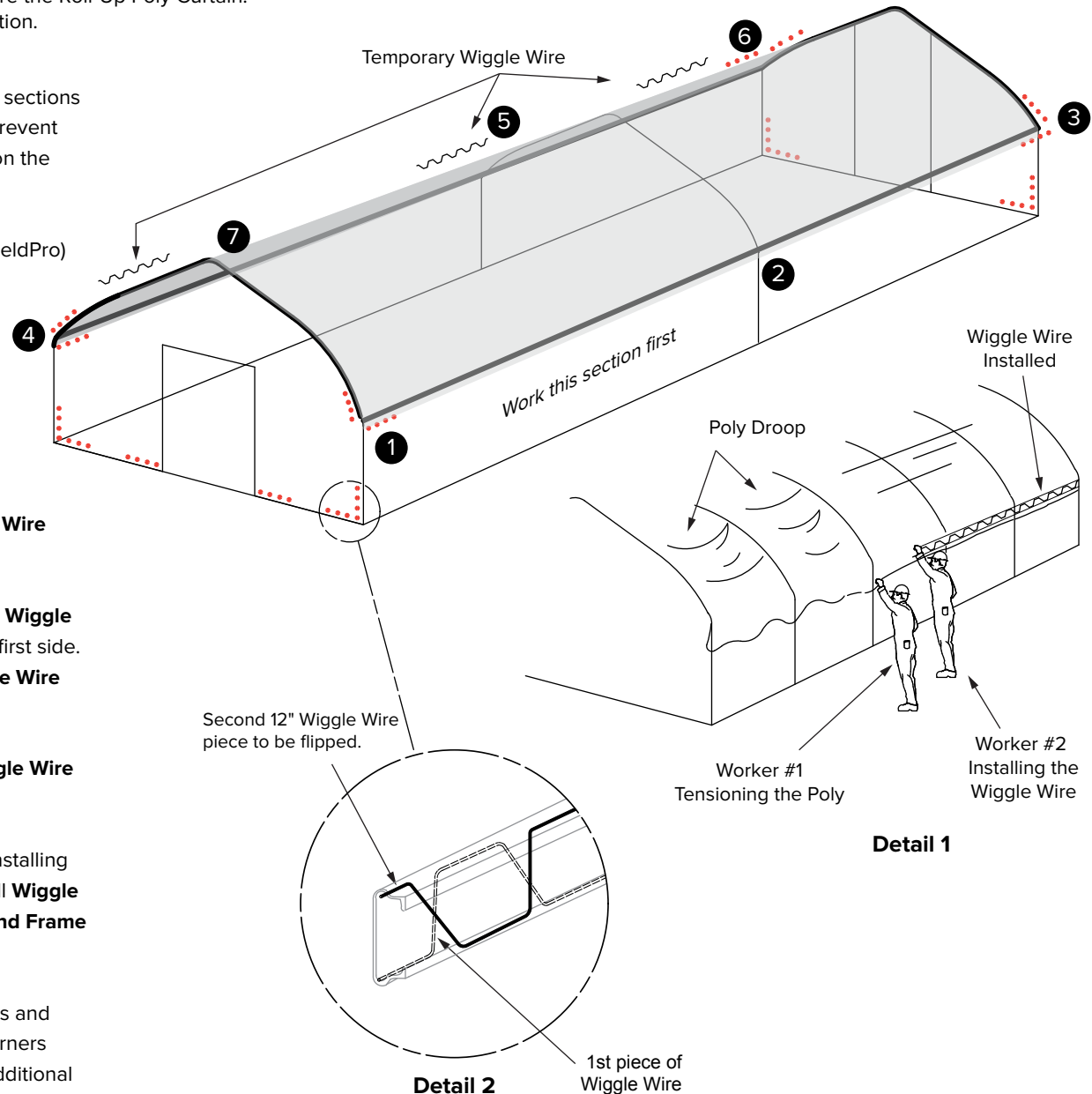

1 Once the Poly is in position, place a couple of temporary sections of **Wiggle Wire** between Point **4** and Point **6** to help prevent the Poly from shifting while the **Wiggle Wire** is installed on the first side.

2 Begin installing **Wiggle Wire** at Point **2** (center of the FieldPro) and work down to Point **1**. Return to Point **2** and install **Wiggle Wire** to Point **3**. Be sure to let the **Poly** edge overhang 3 to 6 inches.

It helps to have two workers install the **Wiggle Wire** to prevent drooping and main proper tension down the entire length. One worker tensions the **Poly** while the second worker follows along inserting the **Wiggle Wire**. Using a helper in this manner while installing the **Wiggle Wire** will make the wrinkles disappear. See Detail 1.

3 Now go to the other side of the FieldPro. Begin Installing **Wiggle Wire** at Point **5** working one side at a time same as the first side. Use a helper again to help tension the **Poly** as the **Wiggle Wire** is inserted.

Be sure the **Wiggle Wire** is seated properly into the **Wiggle Wire Base**. Adjust the **Poly** and **Wiggle Wire** as required.

4 Starting at the top of the **End Frame** at Point **7**, begin installing **Wiggle Wire** down to Point **4**. Go back to top and install **Wiggle Wire** down to Point **1**. Next do the same on the other **End Frame** of the FieldPro.

5 After all the **Wiggle Wire** has been installed on both sides and along the top of both **End Frames** of the FieldPro, the corners (see red dots in illustration) need to be reinforced with additional 12" pieces of **Wiggle Wire**. Also note Detail 2 showing proper way to install the **Wiggle Wire** at the corners.

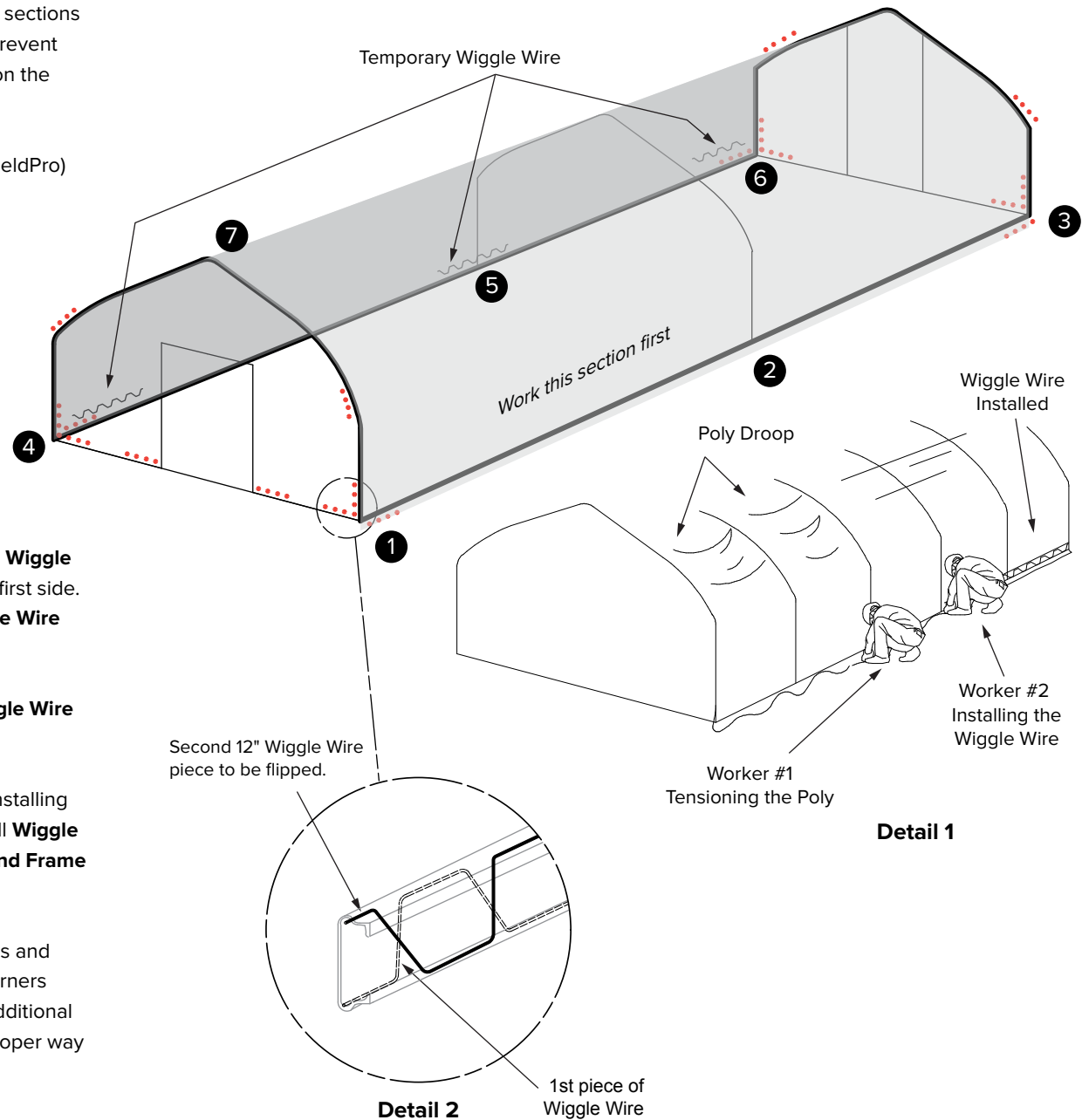

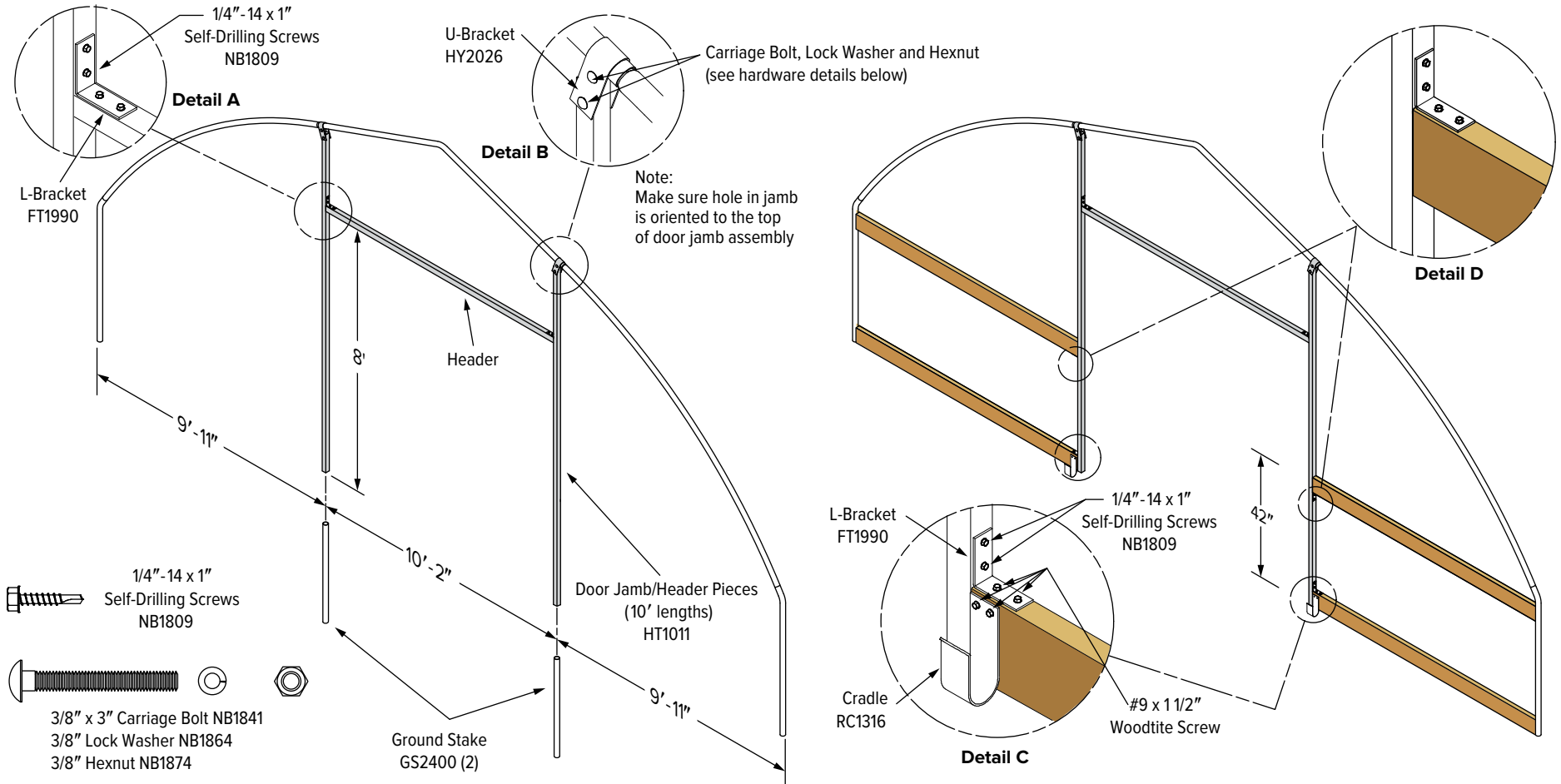

1 Drive the two **Ground Stakes (GS2400)** at the locations shown above. Slide **Door Jamb** vertical sections over the **Ground Stakes (GS2400)**.

Attach the tops of the **Door Jambs** to the **End Frame** using the **U-Brackets** and hardware as shown in Detail B. Make sure the jamb pieces are plumb.

Install the **Header** to using the **L-Brackets FT1990** and hardware as shown in Detail A.

2 Measure the distance from the **Door Jamb** to the **End Frame**. Cut the four wood* side rails and attach using the **“L” Bracket** and **Woodtite Screws**. See Detail #2 on page 25 to see how the side rails are attached at the corners.

Attach **Cradles RC1316** to the bottom rails adjacent to the metal jambs as shown in Detail C.

* wood side rail material by others

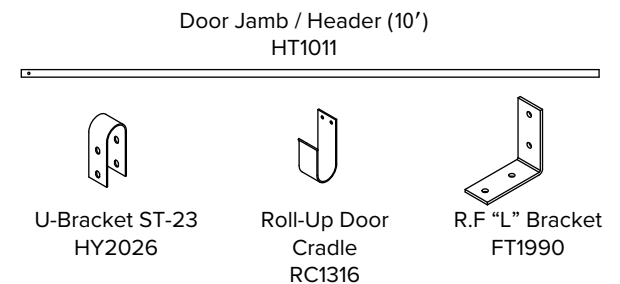

Part Identification

1 Measure the distance from the **Metal Door Jamb** to the **End Frame** for upper and lower wood* side rails. Attach the wood rails using the **“L” Bracket (FT1990)** and appropriate screws. See Details A & B. Also see Detail #2 on page 25 to see how the side rails are attached at the corners.

2 Attach **Roll-Up Door Cradles (RC1316)** at the bottom of each jamb as shown in Detail A.

3 Cut five **Wiggle Wire Base** sections to length for use on the lower wood rails and around the Door Frame.

Attach **Wiggle Wire Base** to wood rails using **Woodtite Screws (NB1807)** every 12”.

Attach **Wiggle Wire Base** to metal jamb pieces and header using **1/4”-14 X 1” Self-drilling Screws (NB1809)** every 12”.

4 Install the Poly material to the end wall before you proceed to Part 3 on the next page. Refer to details on page 29 showing how the Poly is installed in wood framed doorway end application. Also see page 30 showing Wiggle Wire Installation.

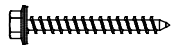
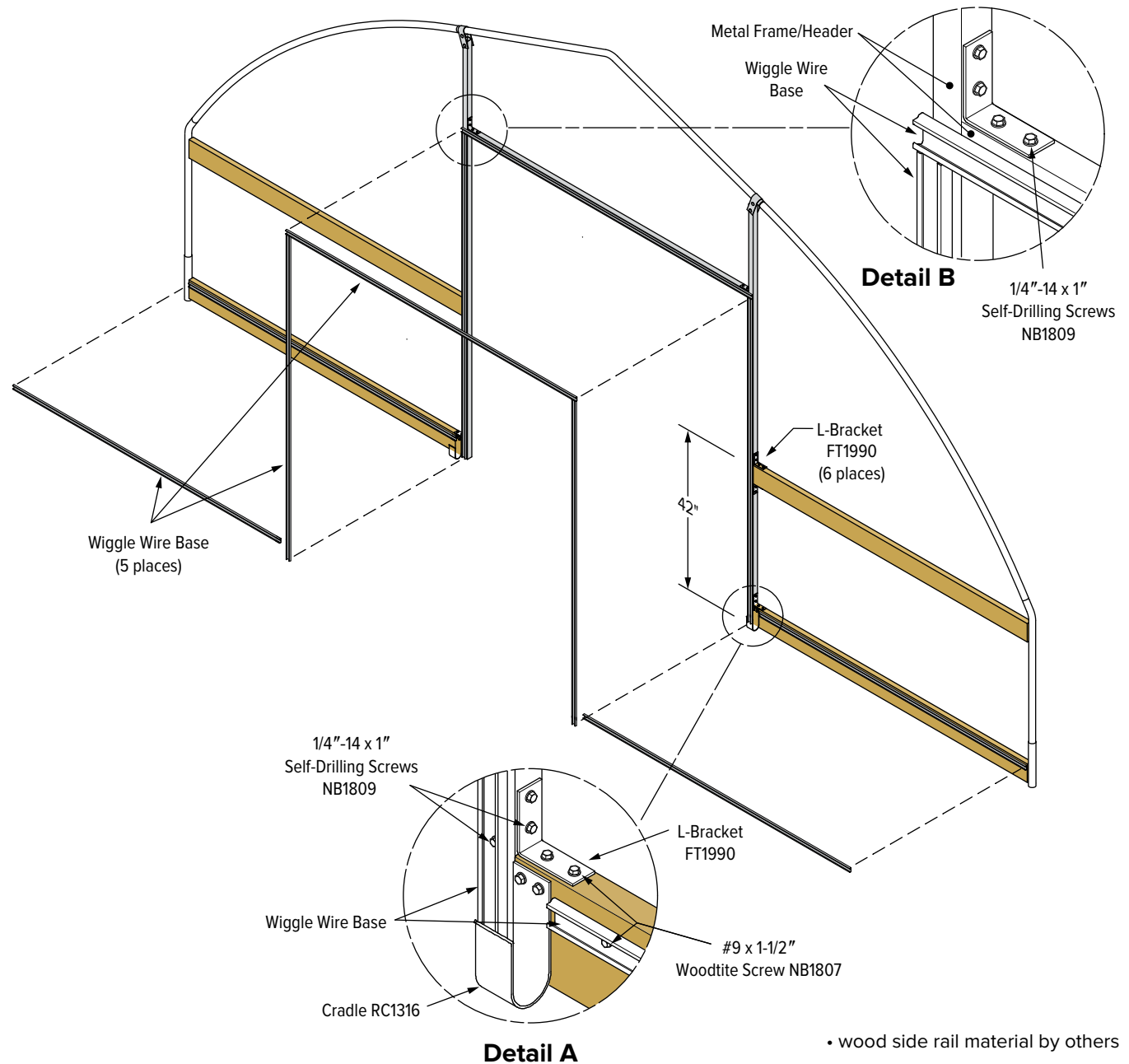

1 1/2" Woodtite Screw NB1807

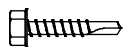

1/4" - 14x 1" Self-Drilling Screw NB1809

• wood side rail material by others

Refer to Contents of Door Kit HT3004

- 1** Lay out the **Reinforced Poly Door (HT1014)** on a flat surface.

Insert the **Roll-Up Tube w/Snap (RC1007)** into the **Tube Bottom Extension (RC1026)**. Slide the assembled tubes into the sleeve at the bottom of the **Poly Door**.

Secure the **Poly Door** to the **Door Tube** using **Roll-Up Tube Clips (RC1010)** approximately every 36". Set the **Poly Door** with **Tube** in the **Cradles**.
- 2** Lift the free end of the **Poly Door** to the top of the door frame and secure with **Wiggle Wire**. Be sure to center the door over the opening. Note: It is important that the **Roll-Up Door Tube** is still resting in the **Cradles** after the **Wiggle Wire** has been installed along the top.
- 3** Using the **Grommets** in the **Poly Door** as a guide, drill three 3/8" holes through the **Wiggle Wire Base** and **Wood Jamb** on each side of the Door. Insert a **3" Carriage Bolt (NB1841)** with the threaded end facing outside. Add **lock washer and hex nut** and tighten. Install a **Ball Knob** on threaded ends. Loop the **Bungee Cords** over the **Ball Knobs**. See Detail 2.
- 4** Install **U-Joint (RC1303)** onto the end of the **Roll-Up Tube** using a **5/16" x 1-3/4" hex bolt** and **lock nut** through the hole. Attach **Roll-Up Crank (RC1314)** to the end of the **U-Joint** using a **5/16" x 1-3/4" hex bolt** and **lock nut**. Install door "**J**" **Hook (FT2071)** to retain the **Roll-Up Crank** when door is rolled up.
- 5** Check the operation of the **Poly Door** by unhooking the **Bungee Cords** and rolling up the **Poly Door** to the top grommet elevation. Insert a loose **Bungee Cord** into the center hole of the Door. Wrap the cord around the rolled up part of the door and insert the **Ball** through the loop of the cord. Do same at left and right grommets.

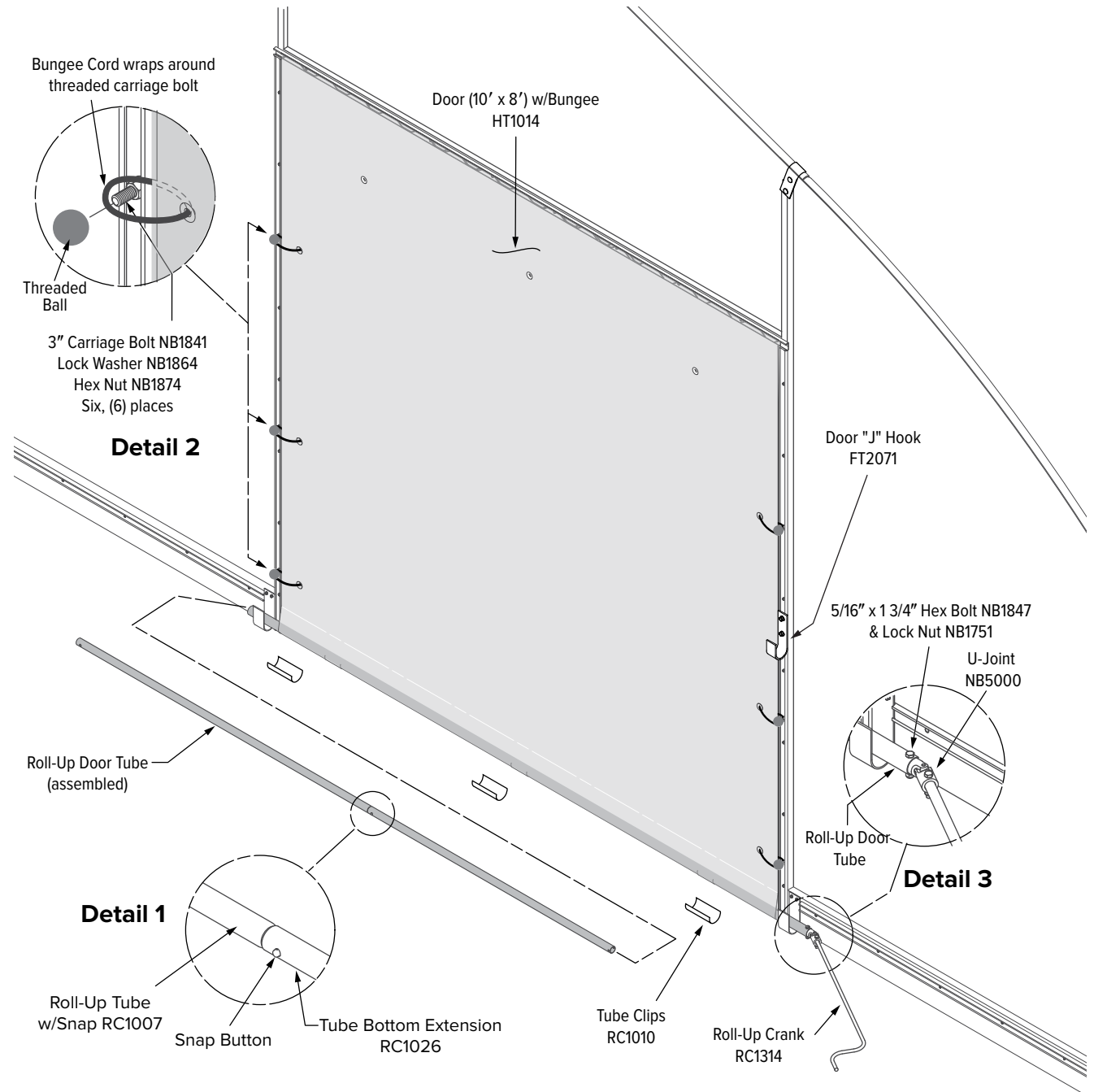

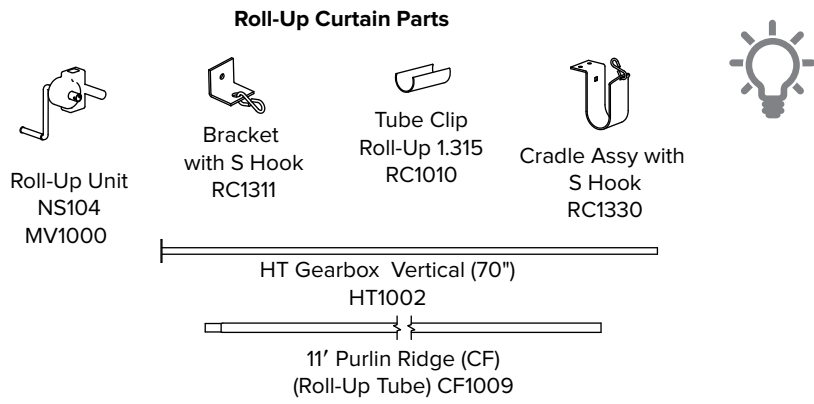

Important Note:
The **Roof Poly** and **End Frame Poly** (not shown) are installed before installing the **Roll-Up Curtain**. See page 32 for **Roof Poly** installation details.

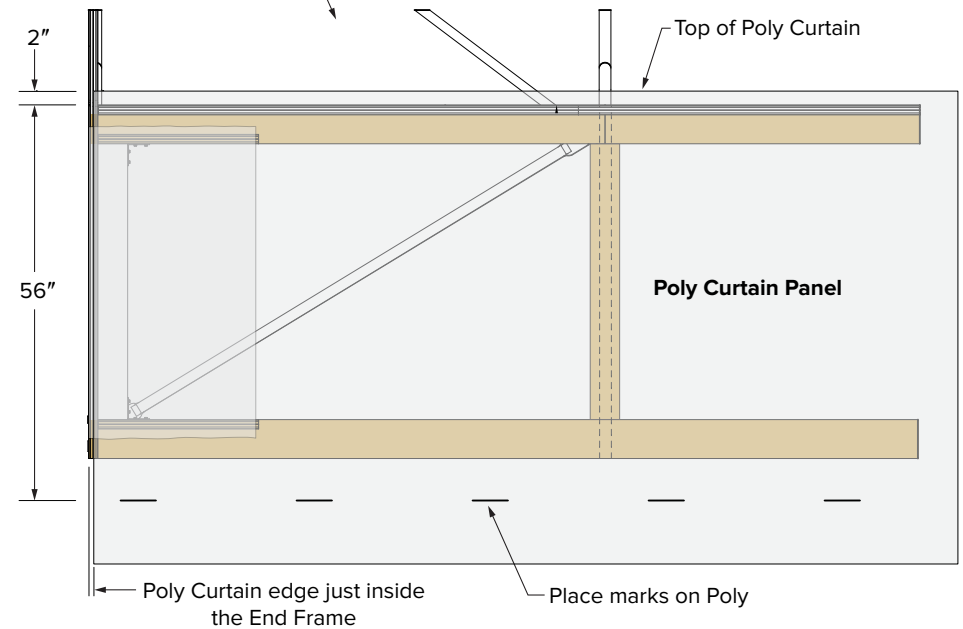
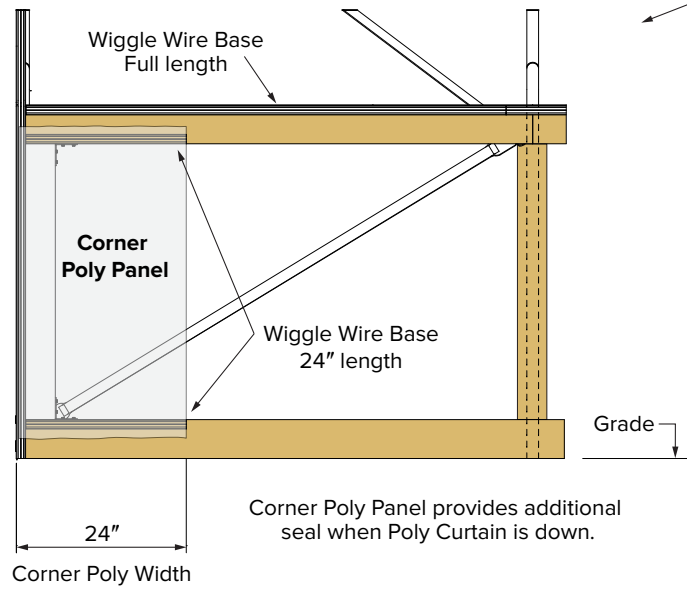
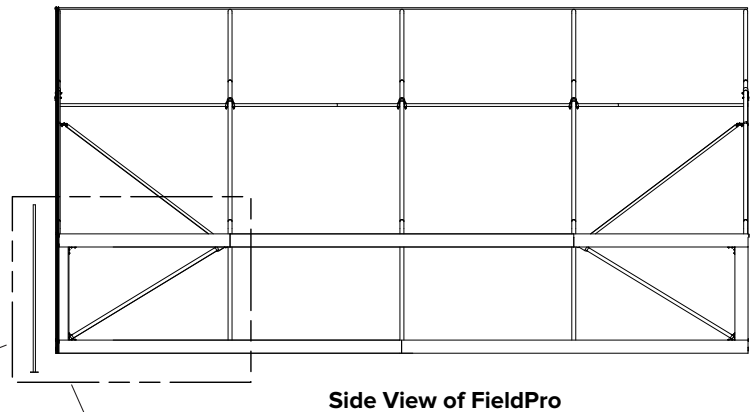

1 Install **Wiggle Wire Base** flush with top of wood rail across full length of the FieldPro. Also install two, (2) 24" lengths of the **Wiggle Wire Base** to top and bottom wood rails (each end) as shown above.

Cut a 24" x 48" piece of Poly to use for the **Corner Poly Panel**. Use **Wiggle Wire** to secure this panel in place.

2 The **Roll-Up Poly Curtain** ends should be kept just inside the **End Frames**. The top should extend 2" above the top of the upper rail. Begin folding the Poly into the **Wiggle Wire Base** and secure with the **Wiggle Wire**. Continue securing the **Poly Curtain** in place down the entire length of the FieldPro. Make sure that 2" of **Poly** always extends above the top rail—keeping the Poly as even as possible.

After the **Poly Curtain** top is secured, use a permanent marker to make placement marks down the entire length of the **Poly Curtain**. These placement marks should be drawn at a point 56" down from the top rail. These marks will help to align the **Poly Curtain** with the **Roll Up Tube**. Proceed to next page to continue the installation.

1 To install the **Vertical Tube (HT10020)** that supports the **Roll-Up Unit (MV1000)**, drill a 5" diameter hole that is 8" in depth. The end of the **Vertical Tube** that has a plate, goes into the hole. The top of the **Tube** should extend 12" above the upper wood rail. Backfill the hole and tamp around the tube to compact the soil.

Place the **Roll-Up Unit** onto the **Vertical Tube**.

2 To prepare the first **Roll-Up Tube**, drill a 3/8" hole in the non-swaged end of the section. Place this **Roll-Up Tube** over the shaft on the **Roll-Up Unit** and replace the screw and nut that will hold this section in place.

Add additional **Roll-Up Tube** sections and secure together with **1/4"-14 x 1" Self-Drilling Screws**. See Detail A.

Trim the last **Roll-Up Tube** flush with the other **End Frame**.

3 Use the marks previously placed on the **Poly Curtain** to align **Roll Up Tube(s)**. See Detail B.

Begin fastening the Poly Curtain to the **Roll-Up Tube** using a **Tube Clip** every 3'. Keep the **Roll-Up Tube** straight by continuing to line up with the placement marks as you progress down the side of the FieldPro.

Retain other components for installation after the **Roof Poly** has been installed.

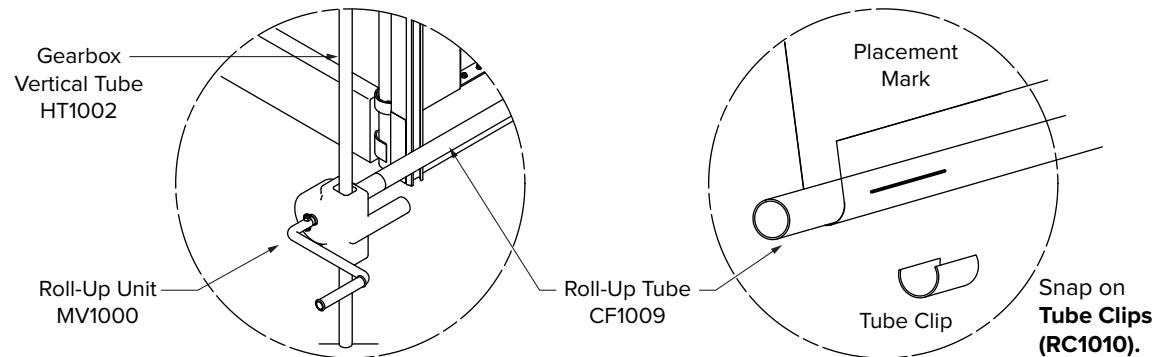
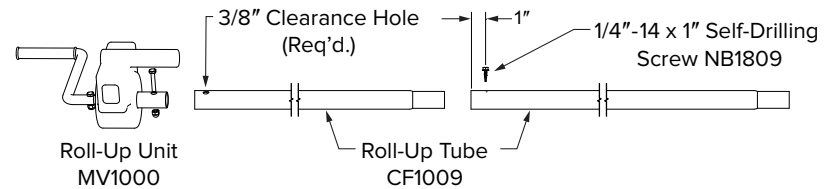
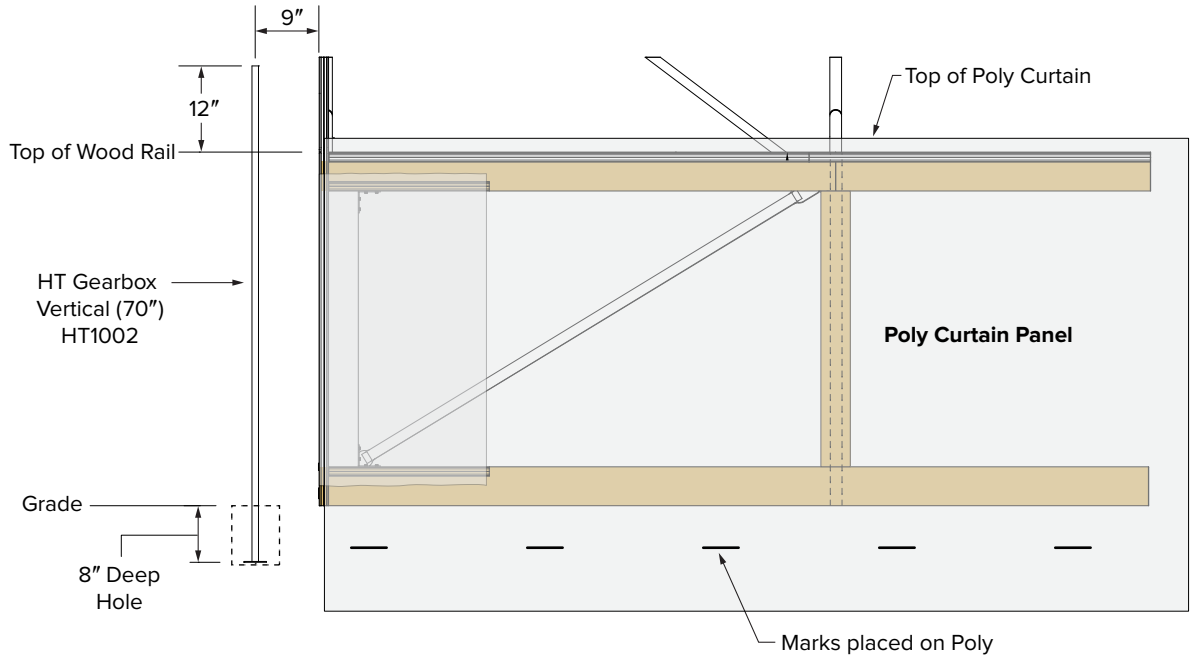

Roll-Up Curtain Retainer Installation

- 1** Raise **Poly Curtain** about halfway up by turning the crank handle on the **Roll-Up Unit** counter-clockwise. Locate **Cradles (RC1330)** 24" from the end of the lower wood side rail on both ends of the FieldPro. Locate additional **Cradles** every 12'-0" on center.
- 2** Attach the **Cradles** by driving two, (2), **Woodtite Screws** through the Cradle flange and into the top of the lower wood rail. See Detail A.
- 3** The **Rope Brackets w/ S-Hook** will be installed over the **Wiggle Wire Base** above. Center the **Brackets** and use **Woodtite Screws** to fasten the Brackets to the upper side rails. Drive the screws through the Wiggle Wire Base material. See Detail B.
- 4** Thread the **1/4" nylon rope** through the cradles and **Rope Brackets** in a zig-zag pattern down the side of the FieldPro. Tighten **Rope** and secure to the **S-Hook** on the **Rope Brackets** at each end of the FieldPro.

