

# **FieldPro**<sup>®</sup> Gothic high tunnel 20' and 24'

---

## Installation Instructions



PO Box 458 • 27725 Danville Ave. • Castle Rock, MN 55010 • poly-tex.com  
U.S. & Canada Toll Free 800-852-3443 • (651) 463-7009 • fax (651) 463-2479

Rev AK-210121

Thank you for purchasing a FieldPro Gothic High Tunnel Greenhouse. The FieldPro has been carefully engineered to provide years of faithful service.

This installation manual covers the 20' and 24' FieldPro Series. The main structural components are different for each FieldPro Series, however, both units share most smaller fittings and hardware. As such, the assembly procedure of a 20' unit is very similar to a 24' unit.

Wherever an assembly procedure or specific part is different between a 20' unit and a 24' unit — the differences are clearly explained.



Where this icon appears you will be alerted to a useful installation tip or an optional way of performing an installation operation.



Where this icon appears you will be alerted to a Time-Saving tip that will help speed up the FieldPro installation.

## Index

Safety Guidelines . . . . .	3	Side Purlin Installation . . . . .	18
Limited Warranty . . . . .	4	Adding Main Frames and Side Purlins. . . . .	19
Overview of FieldPro . . . . .	5	Peak Purlin Installation . . . . .	20–21
Gothic 20' Main Components Identification. . . . .	6	Truss Frame Assembly . . . . .	22–23
Gothic 24' Main Components Identification. . . . .	7	Installing Wood Side Rails . . . . .	24–25
Standard Fittings and Hardware. . . . .	8	Plain End Wall Wiggle Wire Base Material Installation . . . . .	26
Building Site Layout . . . . .	9	Plain End Wall Poly Installation . . . . .	27
Layout of Ground Support Locations. . . . .	10	Open Doorway – Part 1 and Part 2 . . . . .	28–29
Ground Stake installation Options . . . . .	11	Wiggle Wire Installation . . . . .	30
Ground Stake and Ground Stand Installation. . . . .	12	Installation of Roof Poly – General Instructions . . . . .	31
Ground Stake Installation in Concrete Pier. . . . .	13	Installing Roof Poly on FieldPro with Roll-Up Side Curtain. . . . .	32
Building Side Sub-Assembly . . . . .	14	Installing Ground-to-Ground Roof Poly . . . . .	33
Building Main Frame Sections. . . . .	15	Optional Door Kit w/ Metal Frame Installation . . . . .	34–37
Erecting Main Frame Sections . . . . .	16	Optional Roll-Up Curtain Installation . . . . .	38–41
Adding Diagonal Braces . . . . .	17		

PLEASE READ THE INSTALLATION INSTRUCTIONS CAREFULLY BEFORE BEGINNING TO ASSEMBLE THE STRUCTURE. SAVE THESE INSTRUCTIONS FOR FUTURE REFERENCE.

**Poly-Tex does not warrant that this structure or foundation will comply with local or state building codes. There is no guarantee of the load capacity of the structure for snow, wind, seismic, or other loads unless buyer has received certified engineering drawings with the structure, and Poly-Tex does not warrant that the frame or foundation will comply with local or state building codes in buyer's location.**

## **WARNING**

This structure is intended to be self-supporting, provided it is constructed with all frames, hardware, sheathing, sheeting, bracing, cables, and membrane in place, and secured to the foundation as shown in the manual. Stability during construction, from winds and loads imposed during erection, is the sole responsibility of the installer. Observe safety codes required by the local jurisdiction, and relevant safety practices for working at heights. Avoid the risk of electrical shock from overhead lines or electrical storms. Poly-Tex recommends contracting a licensed electrician to perform electrical work. Eye protection is recommended under all circumstances and hearing protection is recommended when cutting components with power tools.

## **DANGER**

No part of this structure is engineered to function as an anchorage point for a fall arrest system. Use a safety net or work from a safe work platform (i.e. scaffolding). Select a calm day for work. Wind can be sufficient enough to knock materials or workers off a work platform or ladder, resulting in a potentially deadly fall.

### **Overview of assembly procedure**

While each structure and site is unique, and may require special considerations, these instructions are for a tilt-up method (where frames are assembled on the ground and tilted onto ground stakes or anchor rods using ropes or lifts). If installer is not confident to erect the structure, Poly-Tex suggests hiring a general contractor, carpenter, or similar licensed business familiar with construction, to assemble and erect the structure.

## **DANGER**

### **Do not overload structure.**

Consult with a Poly-Tex representative prior to adding any amount of weight over the specified capacity of this structure. Basket purlins, shelving or any objects of significant weight shall not be hung, attached, or secured to roof or truss members in a manner that will overload the structure.

## **WARNING**

### **Do not walk on polycarbonate sheets.**

If structure is to be covered with polycarbonate sheets, always use scaffolding for the erection process to avoid damage to sheeting and to ensure safety. Polycarbonate sheeting has UV coating protected with vinyl film on the exterior surface. Install sheets with the film intact and toward the exterior. Remove film once the sheet has been fastened in place.

Poly-Tex, Inc. warrants its products to be free from defects in material and workmanship for a period of (1) year from date of invoice. This warranty is provided to the original purchaser of the product and is not transferable. Poly-Tex does not warrant parts not manufactured by Poly-Tex, but does assign any transferable manufacturer or supplier warranties. Should any defect be found, full repair or replacement will be rendered to the customer at no cost following inspection by a Poly-Tex representative and the return of the defective product to our Castle Rock, MN factory. Expenses for removal or reinstallation of defective products will not be covered by the warranty. The sale of custom projects are final and are not eligible for refund.

**POLY-TEX SHALL NOT BE HELD RESPONSIBLE FOR ANY SPECIAL OR CONSEQUENTIAL DAMAGES, OR FOR ANY DELAY IN PERFORMANCE OF THIS WARRANTY BEYOND OUR CONTROL. THIS WARRANTY IS EXCLUSIVE AND IN LIEU OF ALL OTHER WARRANTIES WHETHER IMPLIED, WRITTEN, OR ORAL INCLUDING THE WARRANTIES OF MERCHANTABILITY AND FITNESS FOR A PARTICULAR PURPOSE.**

**ADDITIONALLY, THERE IS NO GUARANTEE OF THE LOAD CAPACITY OF THE STRUCTURE FOR SNOW, WIND, SEISMIC, OR OTHER LOADS UNLESS BUYER HAS RECEIVED CERTIFIED ENGINEERING DRAWINGS WITH THE STRUCTURE AND POLY-TEX, INC DOES NOT WARRANT THAT FRAME WILL COMPLY WITH LOCAL OR STATE BUILDING CODES IN BUYERS LOCATION.**

This warranty does not cover damage from customer abuse, misuse, improper installation, customer modifications, customer negligence in performing normal maintenance, damage resulting from acts of nature.

# Overview of FieldPro 20' and 24'

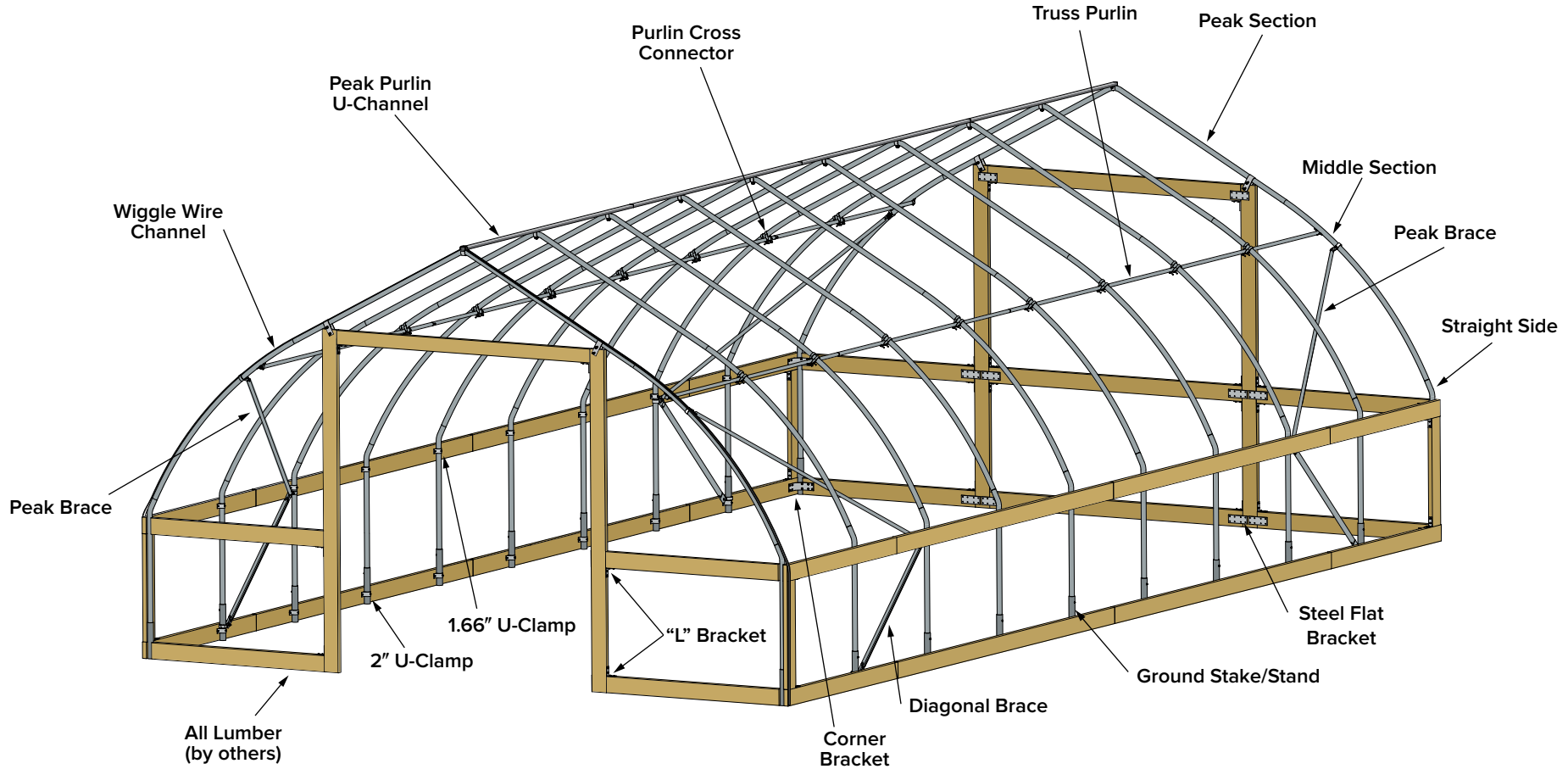

# Gothic 20' Main Components Identification

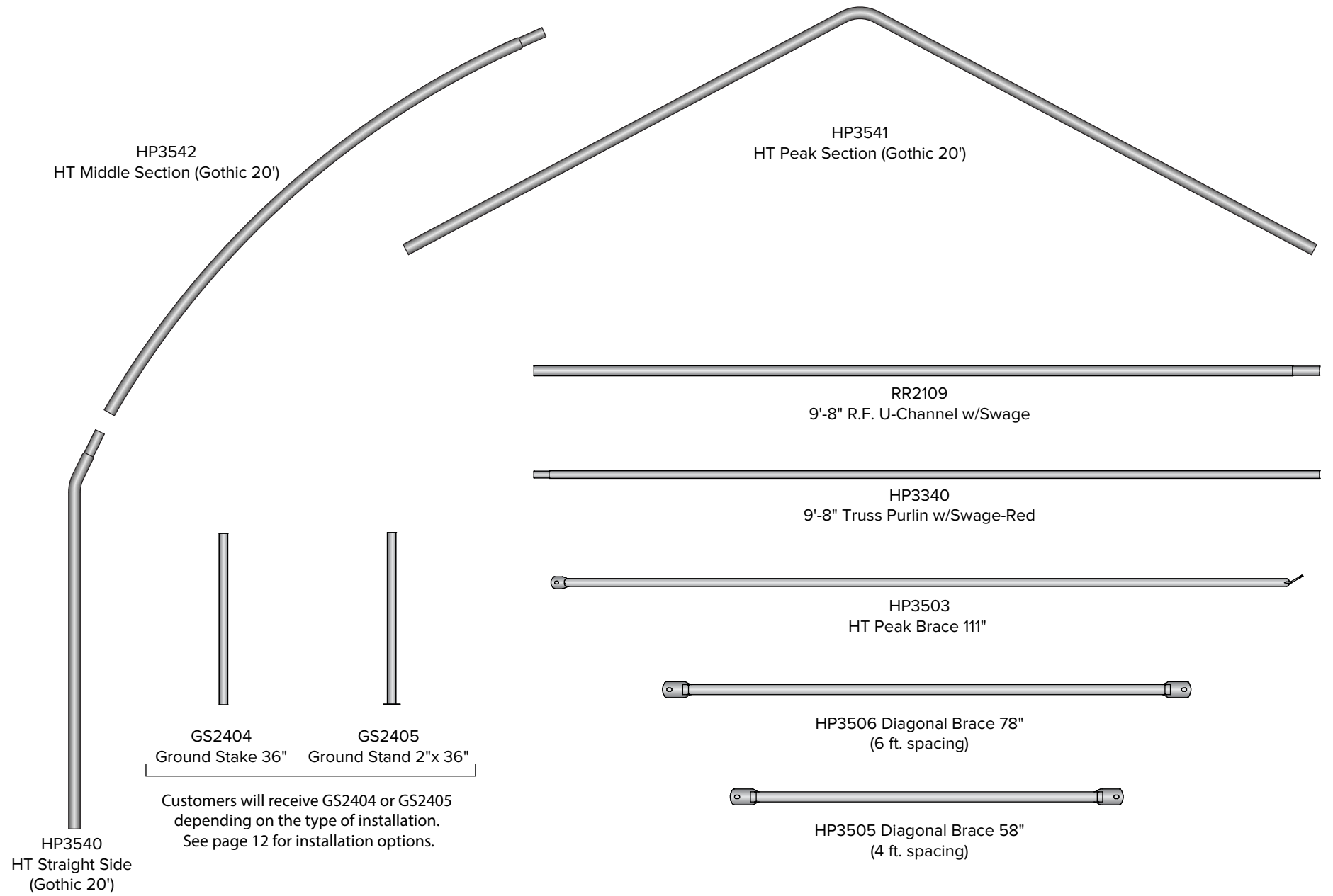

# Gothic 24' Main Components Identification

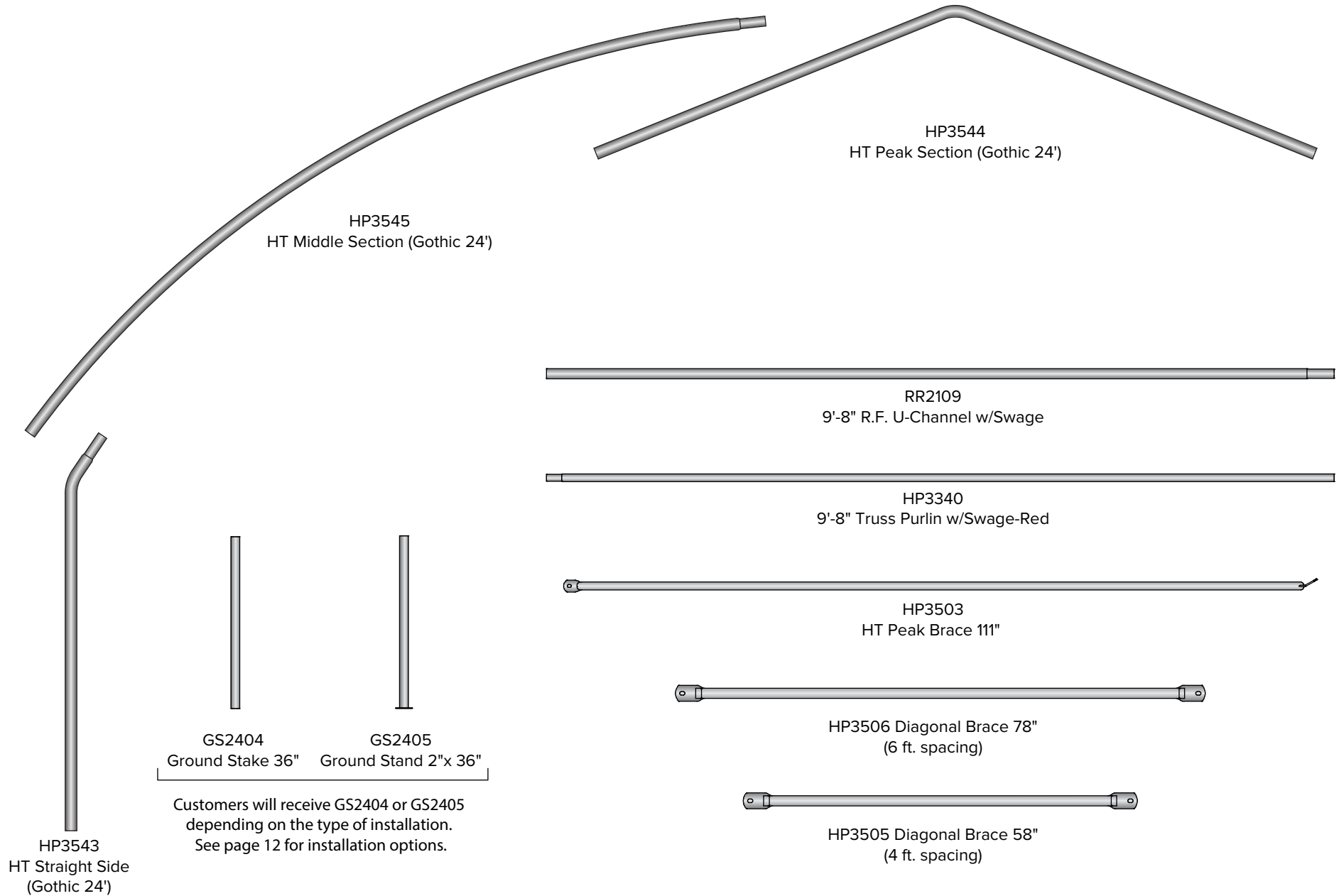

# Standard Fittings and Hardware

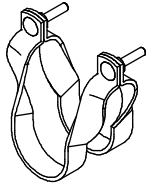

FT4042  
Cross Connector

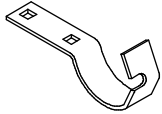

FT2079  
Long Speed  
Hook (2'')

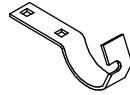

FT2080  
Long Speed  
Hook (1.66'')



KH1000  
Purlin  
Fastener

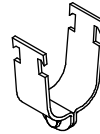

FT2113  
1-1/4" UNI-Clamp

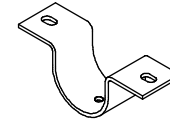

FT2057  
2" U-Clamp

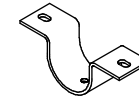

FT2104  
1.66" U-Clamp

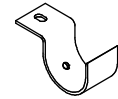

FT2117  
R.F. End Strap  
(1.66'')

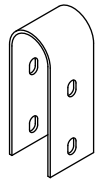

FT4053  
U-Bracket (1.66'')

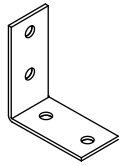

FT1990  
R.F. "L" Bracket



BMS1130  
18" Spike

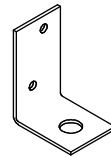

FT2118  
Spike Anchor  
Bracket

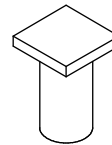

HT1000  
2" Driving Tool

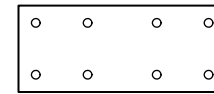

DR7033  
Steel Flat Bracket

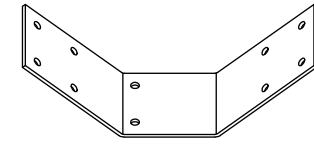

DR7032  
Steel Corner Bracket

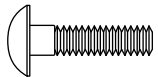

NB1832  
5/16" X 1 1/4"  
Carriage Bolt



NB1862  
5/16" Lock  
Washer



NB1872  
5/16" Hex Nut

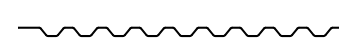

WIGGLWIRE - 43.000  
Wiggle Wire

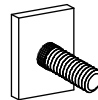

FT2570  
Stop Tab

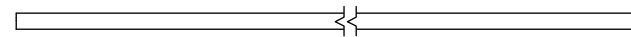

WWBASE9  
8' - 11" Wiggle Wire Base



NB1841  
3/8" x 3" Grade 5  
Carriage Bolt



NB1864  
3/8"  
Lock Washer



NB1874  
3/8"  
Hex Nut

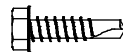

NB1809  
1/4"-14 x 1"  
Self-Drilling Screw

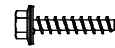

NB1807  
1 1/2" Woodtite Screw



RS5000  
1 1/4" Round  
Black Plug



FB2527  
1" x 1 1/2" Rectangular  
Black Plug



NB1826  
1/4" X 2"  
Carriage Bolt



NB1860  
1/4" Lock  
Washer



NB1870  
1/4" Hex Nut

## Using the 3:4:5 Triangle Method to “Square Up” Your Building Site

The “3:4:5 Triangle Method” of laying out a building site produces 90° corners as shown in the diagram. It forces your foundation layout to be a perfect rectangle instead of a parallelogram. To verify if a corner is 90°, place a mark on the masons line 3 feet from the corner. Place another mark on the adjacent masons line 4 feet from the corner. The distance from the 3 ft. mark to the 4 ft. mark should be exactly 5 ft.

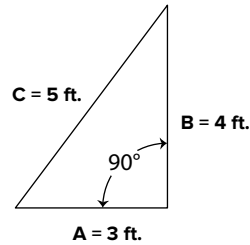

- 1 Drive in the first stake at point #1. Depending on which FieldPro model you have ordered, measure over 20' or 24' and drive in a second stake at point #2. Attach a twisted masons line between stakes #1 and #2 approximately 12" above ground. Use a line level to level the masons line.

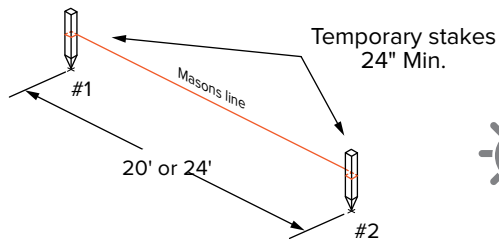

Tip:  
An orange masons line is easier to see.

- 2 Based on the length of the FieldPro you have ordered, place a stake at point #3. Attach a masons line from Stake #2 to stake #3. Use the 3 • 4 • 5 Triangle Method to square up the corner at stake #2 to establish a 90° corner.

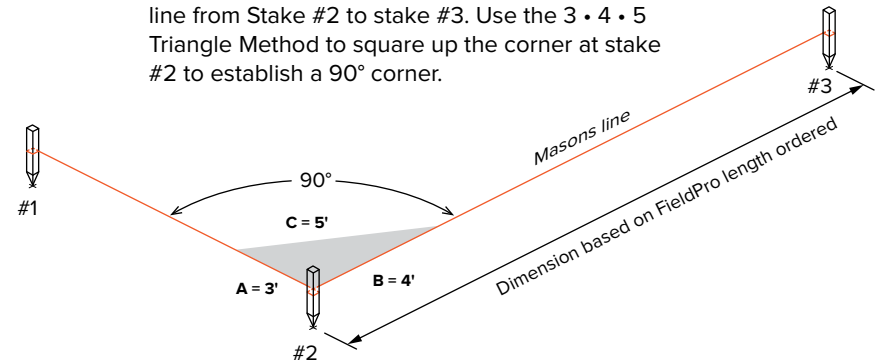

- 3 Place a stake at point #4. Attach a masons line from stake #1 to stake #4. Use the 3 • 4 • 5 Triangle Method to square up the corner at stake #1 to establish a 90° corner.

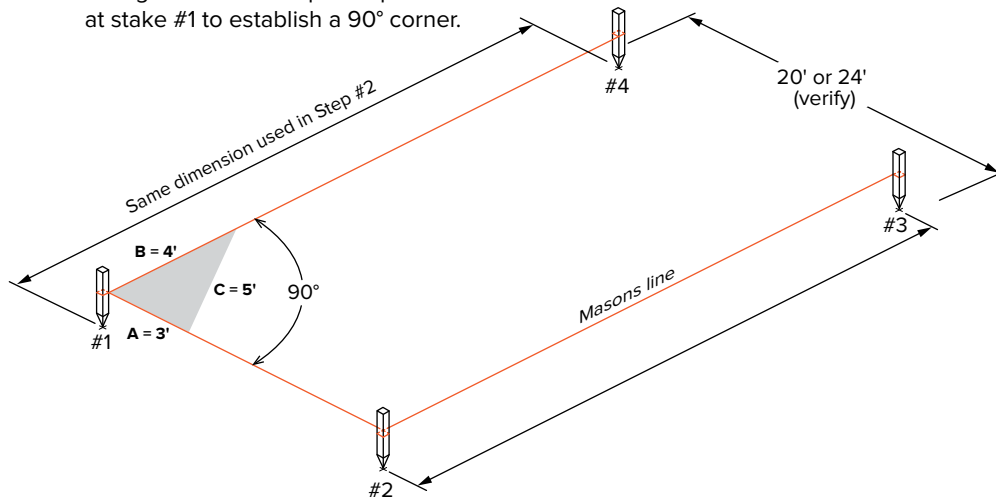

- 4 Attach a masons line from Stake #3 to Stake #4. Make sure all lines are level. Verify that both corner-to-corner measurements are the same. Adjust Stakes #3 and #4 in unison until both diagonal measurements are the same.

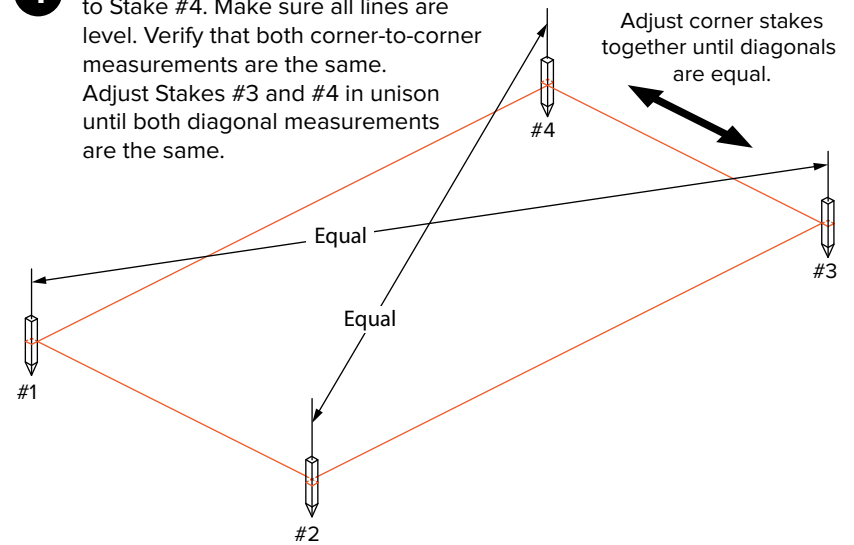

# Layout of Ground Support Locations

*Instructions on pages 10–13 apply to 20' & 24' FieldPro Models*

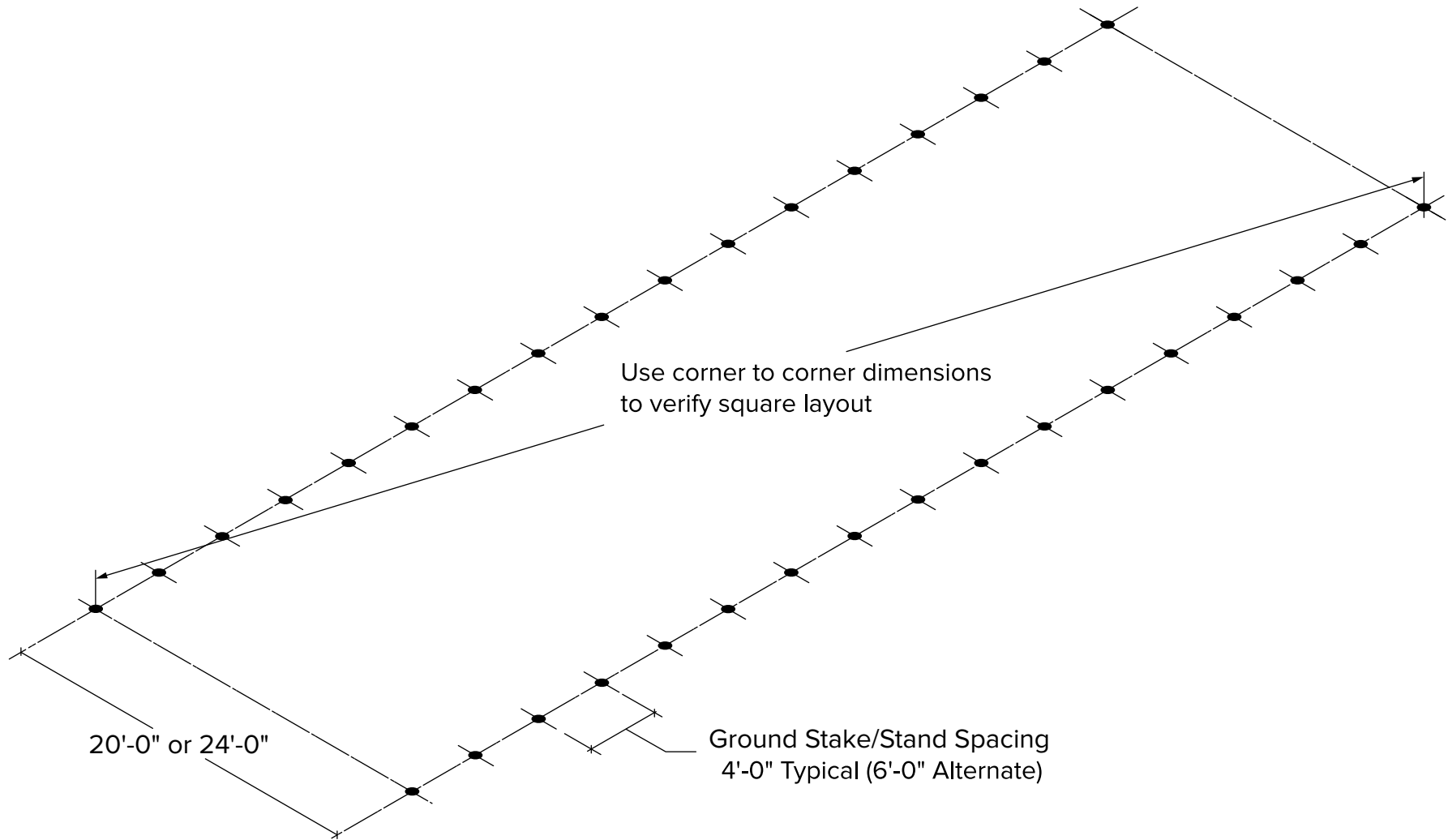

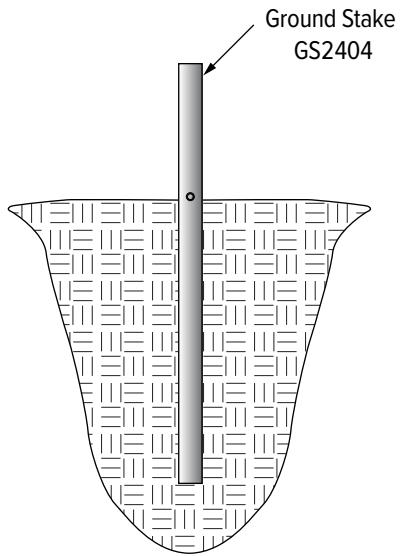

**Driven Ground Stake  
Option #1**

See page 12 for Ground Stake installation details.

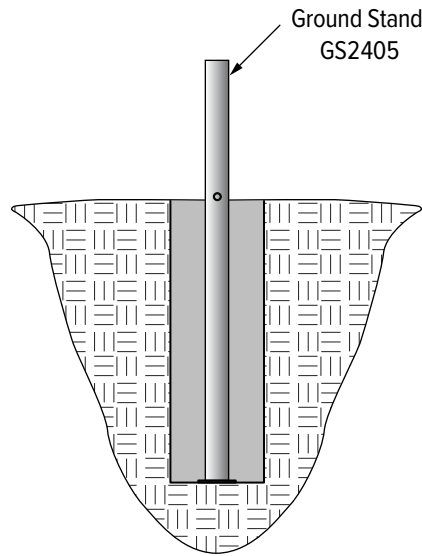

**Ground Stand in Compacted Soil  
Option #2**

See page 12 for Ground Stand installation details.

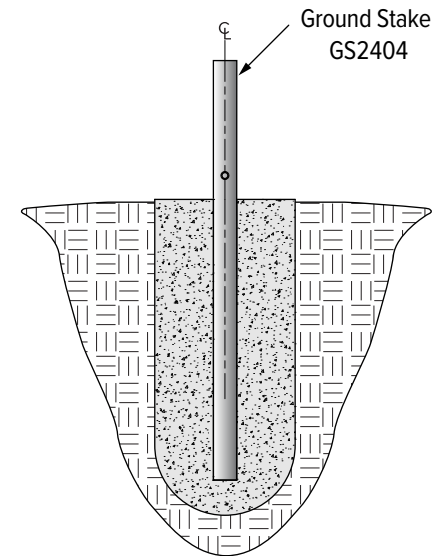

**Ground Stake in Concrete Pier  
Option #3**

See page 13 for Ground Stake in concrete pier installation details.

Ground stakes are driven into the ground using the Driving Tool (HT1000) until the top of the ground stake is 12" above the soil line.

A masons (twisted) line is attached between all four corner stakes 8" from the top of stakes. Use a line level to line up all the stakes at the 8" mark.

For longer structures, the masons line may need to be supported every 50' to prevent sagging. Sight down the line visually to check the straightness of the line.



To save time, you can prep all the stakes ahead of time.

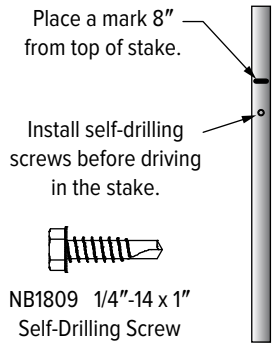

Ground Stake GS2404 Preparation

## Driven Ground Stake

Driving Tool HT1000

Ground Stake GS2404

Mark  
Masons Line

Line level

Note:  
If the top of the stake becomes deformed from driving in the stake, cut off damaged section from top of stake.

Ground stands are placed into a 6" diameter (min.) hole. The top of the ground stand will be 12" above the soil line. Ensure that the ground stands remain plumb while compacting the soil all around.

A masons (twisted) line is attached between all four corner stakes 8" from the top of stakes. Use a line level to line up all the stakes at the 8" mark.

For longer structures, the masons line may need to be supported every 50' to prevent sagging. Sight down the line visually to check the straightness of the line.



To save time, you can prep all the stakes ahead of time.

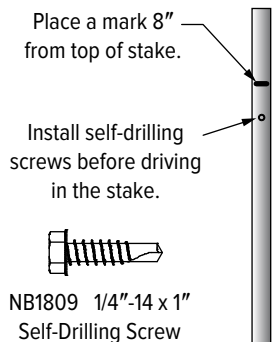

Ground Stand GS2405 Preparation

## Ground Stand in Compacted Soil

Ground Stand GS2405

Mark  
Masons Line

Line level

Compacted Fill

6" Min. hole



To save time, you can prep all the stakes ahead of time.

Place a mark 6" from top of stake.

Install 1 self-drilling screw in the stake.

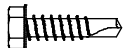

1/4"-14 x 1"  
Self-Drilling Screw  
NB1809

Ground Stake GS2404 Preparation

## Ground Stake in Concrete Pier

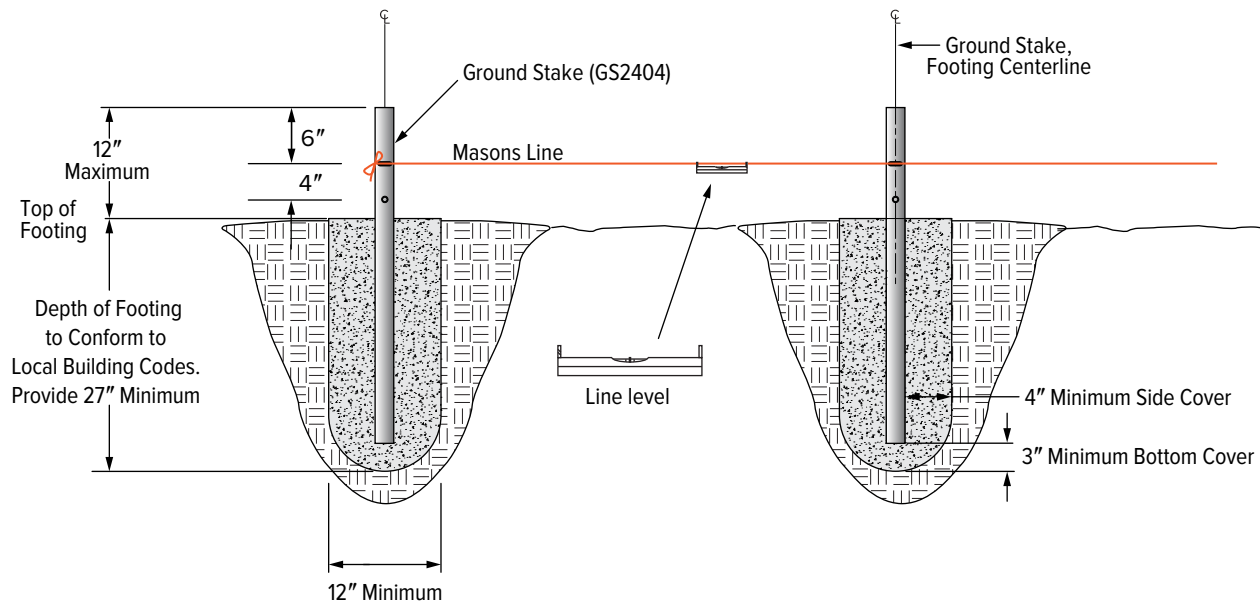

### Steps

Ground stakes are set into concrete so that the top of each stake is 12" above the top of the footing. Ensure that the ground stakes remain plumb while pouring the concrete.

A masons (twisted) line is attached between all four corner stakes 6" from the top of stakes. Use a line level to line up all the stakes at the 6" mark.

For longer structures, the masons line may need to be supported every 50' to prevent sagging. Sight down the line visually to check the straightness of the line.

*Instructions on this page apply to 20' & 24' FieldPro Models*



The **Straight Side** and **Mid-Section** can be preassembled to save time. It is recommended that the side sub-assemblies be assembled on a flat surface so parts will be aligned properly.

**1** Insert the **Straight Side** into the **Mid-Section**. See Detail A.

**2** Secure frame sections together using **1/4" -14 X 1" self-drilling screws (NB1809)** installed at each connection as shown in Detail B.

**NOTE:** Do not install the self-drilling screws so that the heads of the screws face upwards. Doing so will allow the screw heads to come in contact with the Poly Sheeting Cover causing damage to the Poly Cover when it is pulled over the frame later.

**3** Place a mark on all **Mid-Section Tubes** to indicate correct location for **Purlin Cross Connectors**. (See illustration at right. Also refer to pages 18–19 for **Side Purlin** installation details).

- For a 20' FieldPro, place a mark 15 1/2" from the swaged end.
- For a 24' FieldPro place a mark is 22" from the swaged end.

**Straight Side**  
20' FieldPro – HP3540  
24' FieldPro – HP3543

**Detail A**

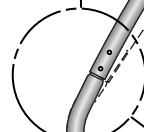
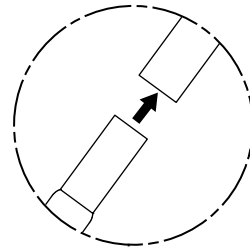

Nominal Dimensions

**Detail B**

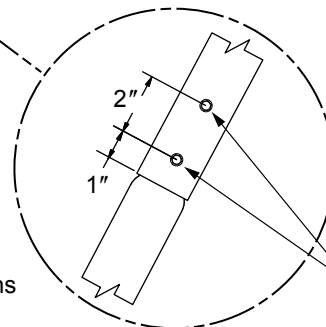

Two, (2) 1/4"-14 x 1" Self-Drilling Screws

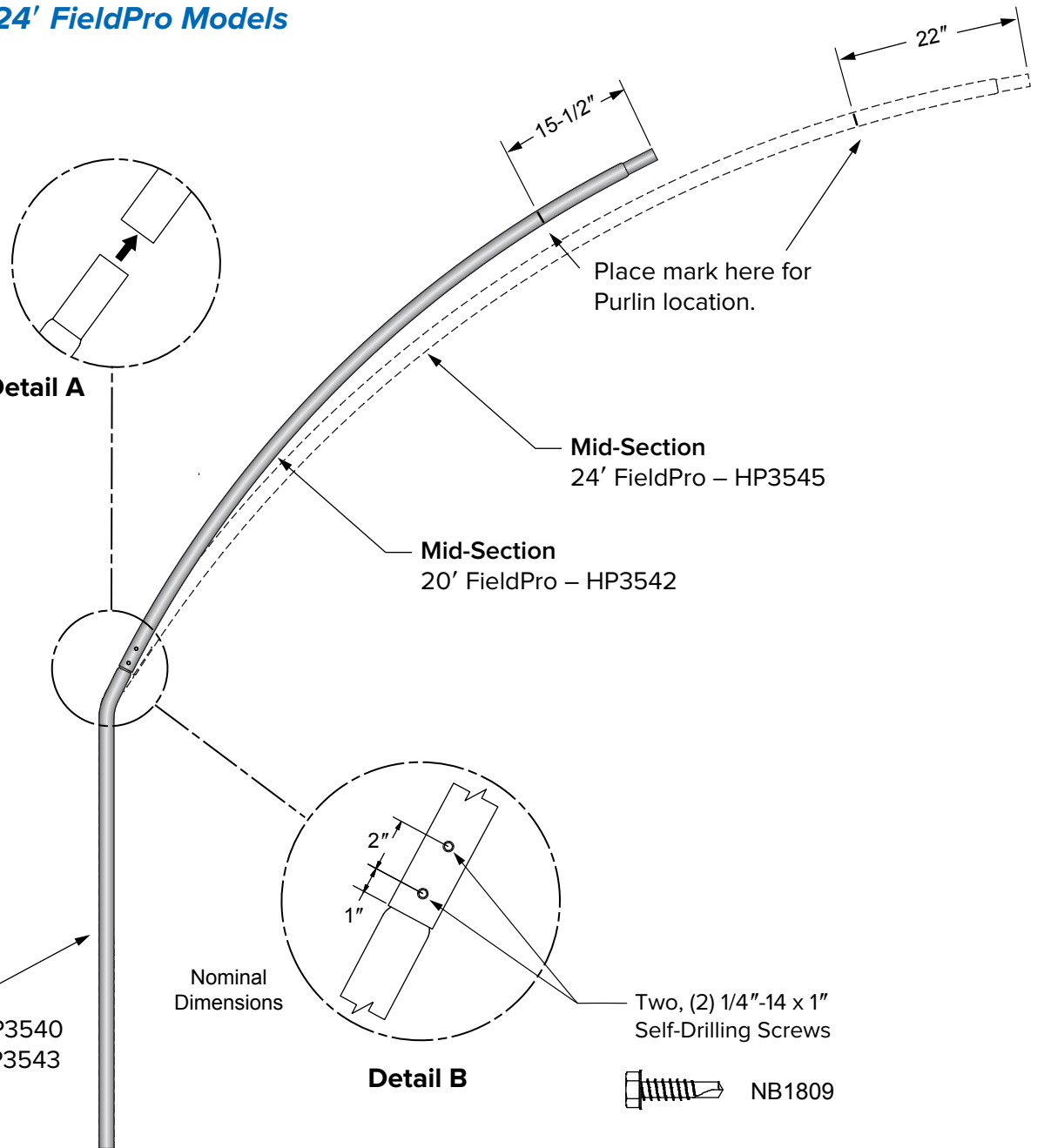
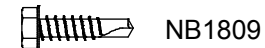

## Instructions on this page apply to 20' & 24' FieldPro Models

- 1** Insert each **Side Assembly** into **Peak Section**. Choose a flat surface when assembling these components, to ensure that all parts are properly aligned. See Detail A.
- 2** Secure frame sections together using **1/4" -14 X 1" self-drilling screws (NB1809)** installed at each connection as shown. See Detail B.

**NOTE:** Do not install the self-drilling screws so that the heads of the screws face upwards. Doing so will allow the screw heads to come in contact with the Poly Sheeting Cover causing damage to the Poly Cover when it is pulled over the frame later.

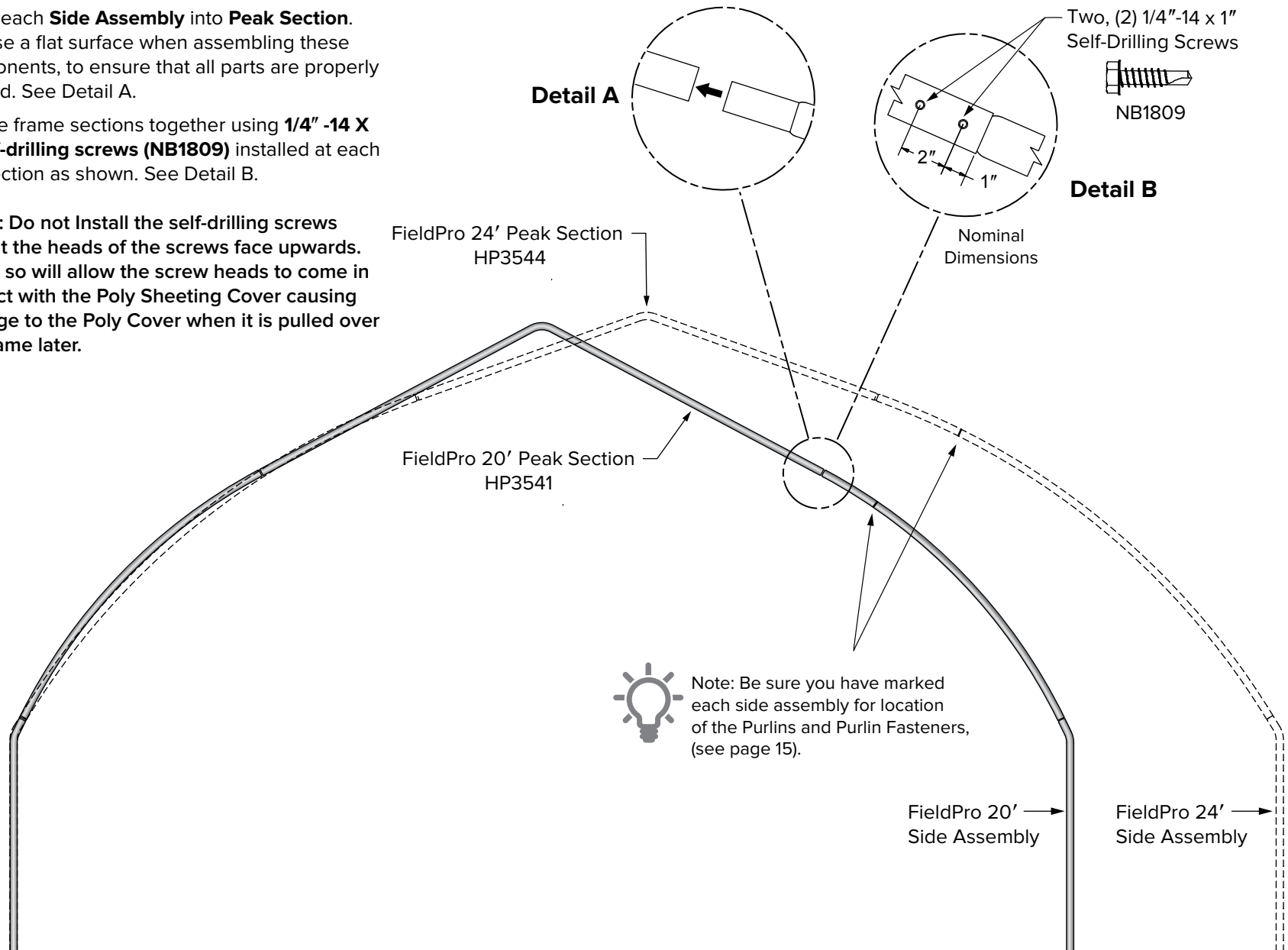

# Erecting Main Frame Sections

*Instructions on this page apply to 20' & 24' FieldPro Models*

- 1** Install the first three assembled Frame Sections by inserting the Frame Sections into the ground stake/stand until they rest on the leveling screw(s) previously installed in each ground stake/stand. Use wood bracing if necessary to temporarily support the structure.
- 2** Fasten the frame sections to the ground stakes/stands using 1/4"-14 x 1" self drilling screws. See Detail A.

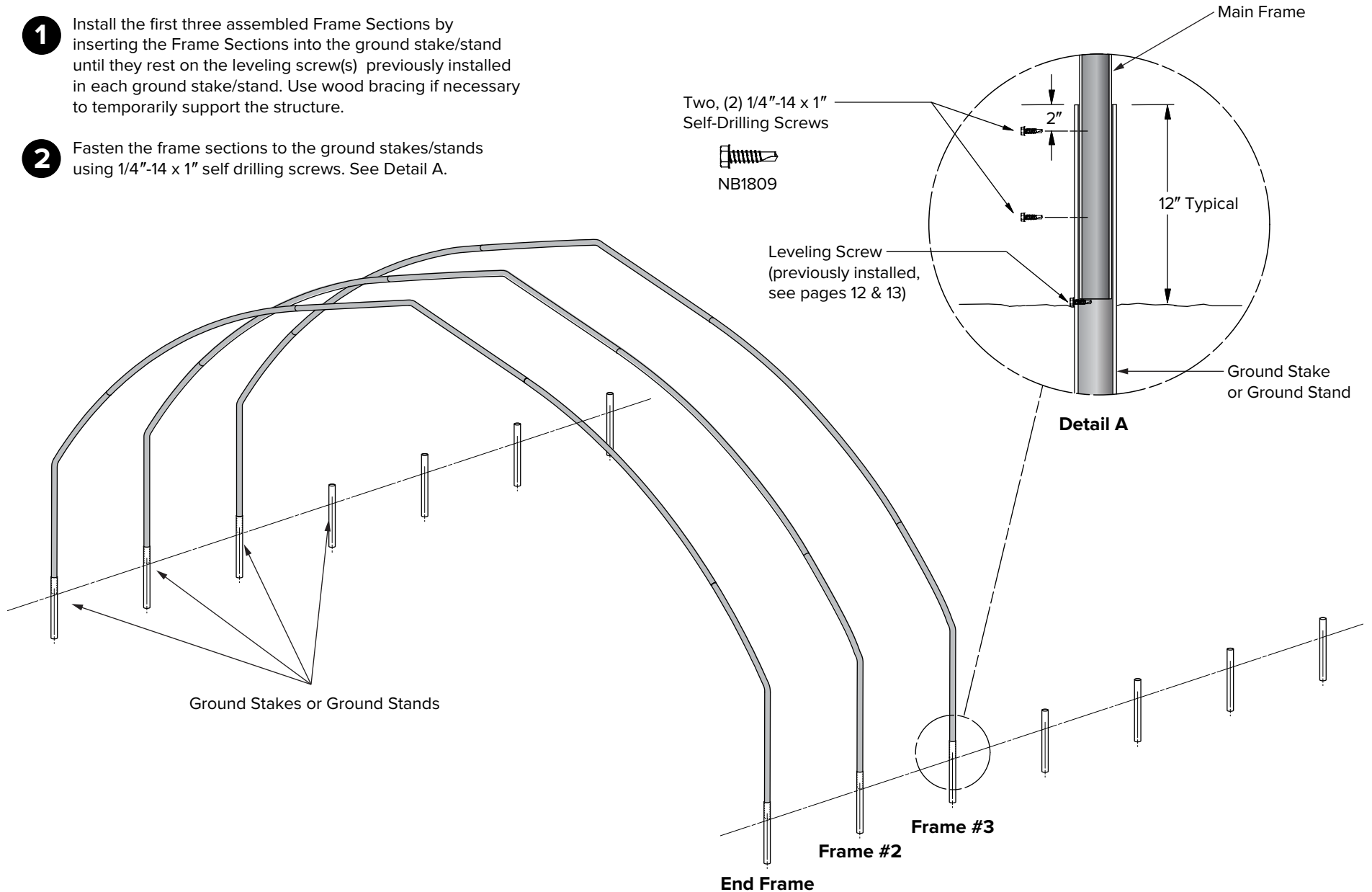

# Adding Diagonal Braces

## Instructions on this page apply to 20' & 24' FieldPro Models

Note: The **Main Frames** can be installed on 4 foot or 6 foot centers. The drawings at the lower right show where to place the **Diagonal Braces**.

- 1** Attach a **Speed Hook (FT2080)** to Frame #3 at point 'X' at a height of 43-1/2". See drawing.
- 2** Attach **Speed Hook (FT2079)** near the bottom of **Frame #2**. Attach the (specified) **Diagonal Brace** between these two **Speed Hooks**. Use a carriage bolt, lock washer, and hex nut to attach the **Diagonal Brace**. Do not fully tighten at this time. Final adjustment may be required after the **Peak Brace** has been installed. See Details A & B.

- 3** Attach **HT Peak Brace (HP3503)** between points 'X' and 'Y'. The angled end of the **Brace** attaches at point 'X'. You will need a **Speed Hook (FT2080)** to attach the **Brace** to the End Frame using carriage bolts/washer/nut. See Detail C. Check to see that frame sections are plumb and then final tighten all hardware.
- 4** Repeat Steps 1–3 to attach **Diagonal and Peak Braces** to the other side of the structure.



**IMPORTANT: Play it safe when working at heights. Scaffolding is preferred when installing higher components. Use a helper when necessary.**

**Important: Make sure screws and ends of carriage bolts do not face outwards to avoid damage to poly covering. All components attached to Long Speed Hooks must be mounted on the outside of the tabs. NEVER install any components between the tabs.**

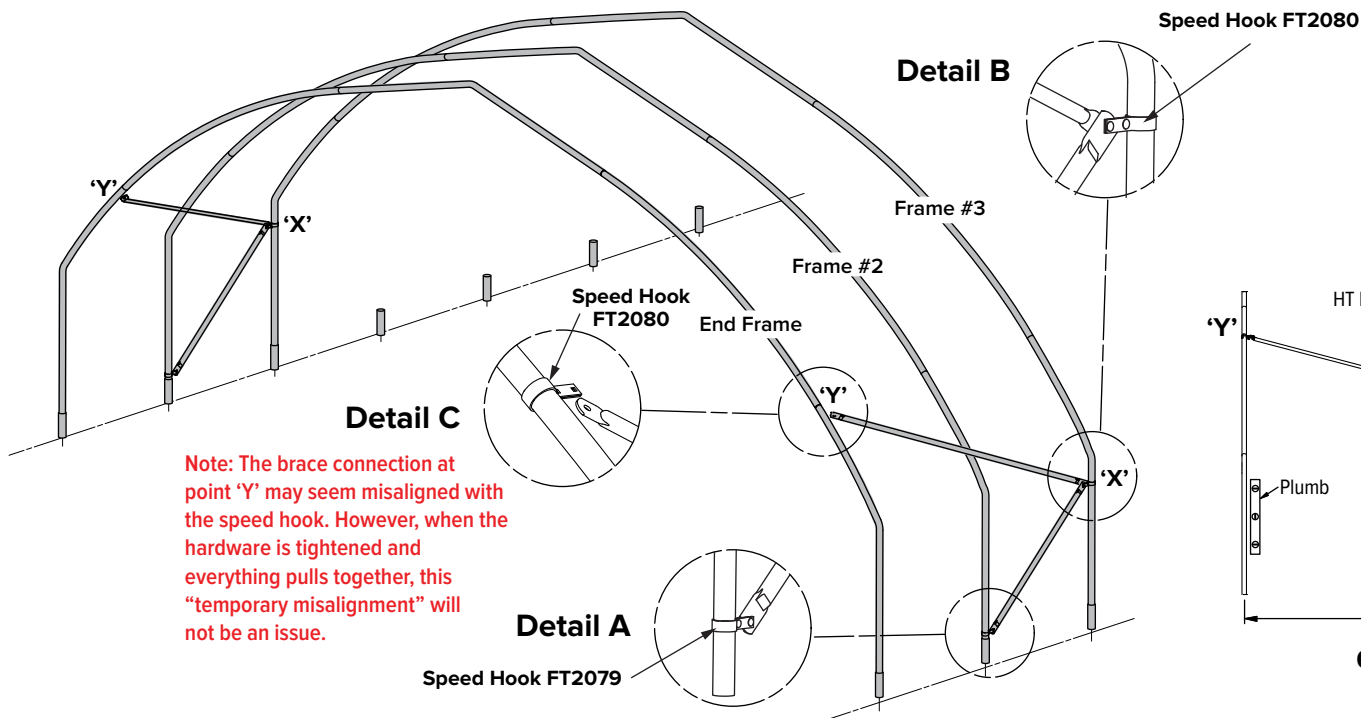
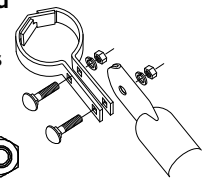

Note: The brace connection at point 'Y' may seem misaligned with the speed hook. However, when the hardware is tightened and everything pulls together, this "temporary misalignment" will not be an issue.

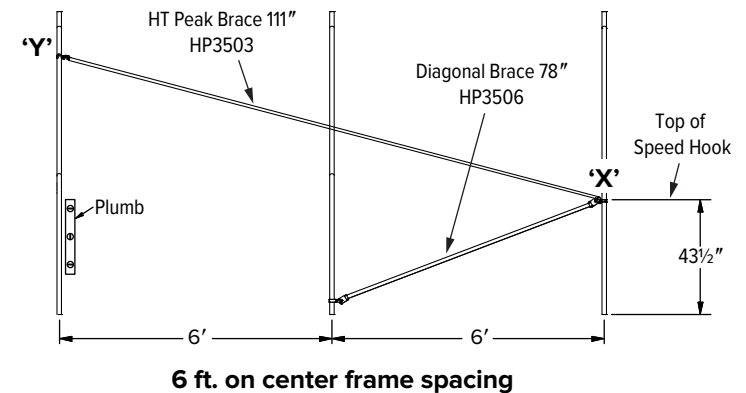
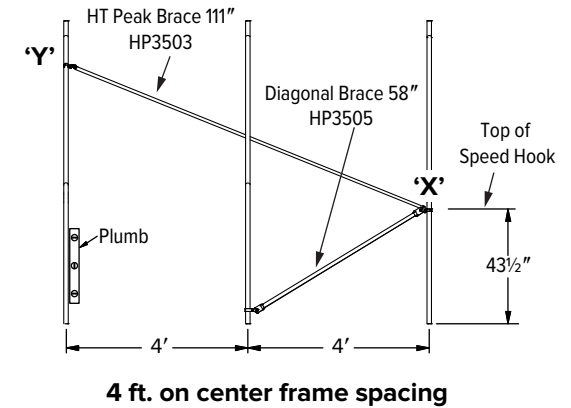

Instructions on this page apply to 20' & 24' FieldPro Models

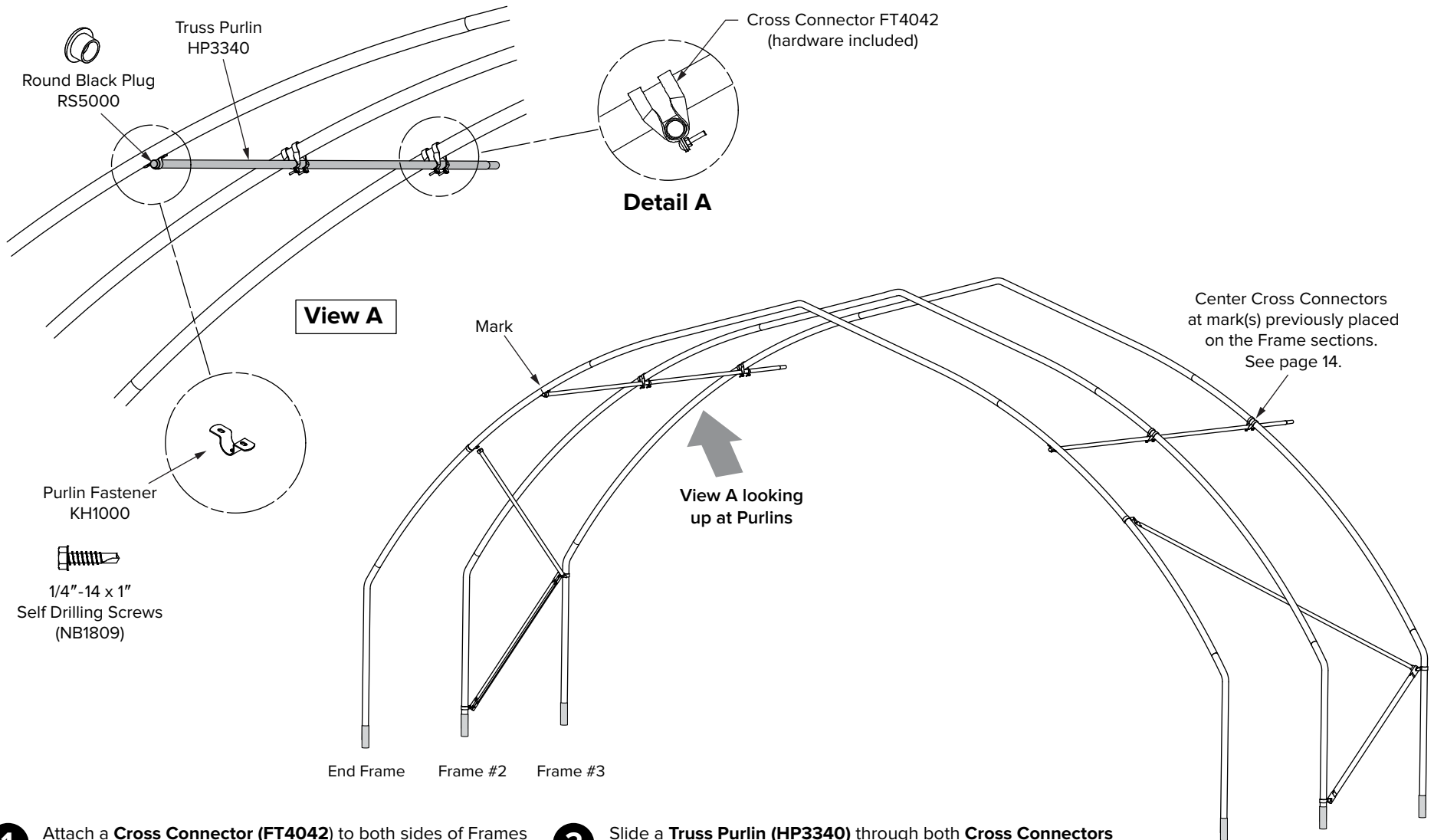

**1** Attach a **Cross Connector (FT4042)** to both sides of Frames 2 & 3. Center the **Cross Connectors** over the marks previously placed on the side sections.  
Secure **Cross Connectors** using (included) carriage bolts/ washers/nuts. See Detail A above.

**2** Slide a **Truss Purlin (HP3340)** through both **Cross Connectors** making sure the non-swaged end faces outward and is flush with the **End Frame**. Secure the **Purlin** to the **End Frame** using the **Purlin Fastener (KH1000)** and **1/4" - 14 x 1" Self Drilling Screws (NB1809)**. See View A. Insert **Round Plastic Plug (RS5000)** into end of **Purlin**. Repeat Steps 1 & 2 for other side of structure.

*Instructions on this page apply to 20' & 24' FieldPro Models*

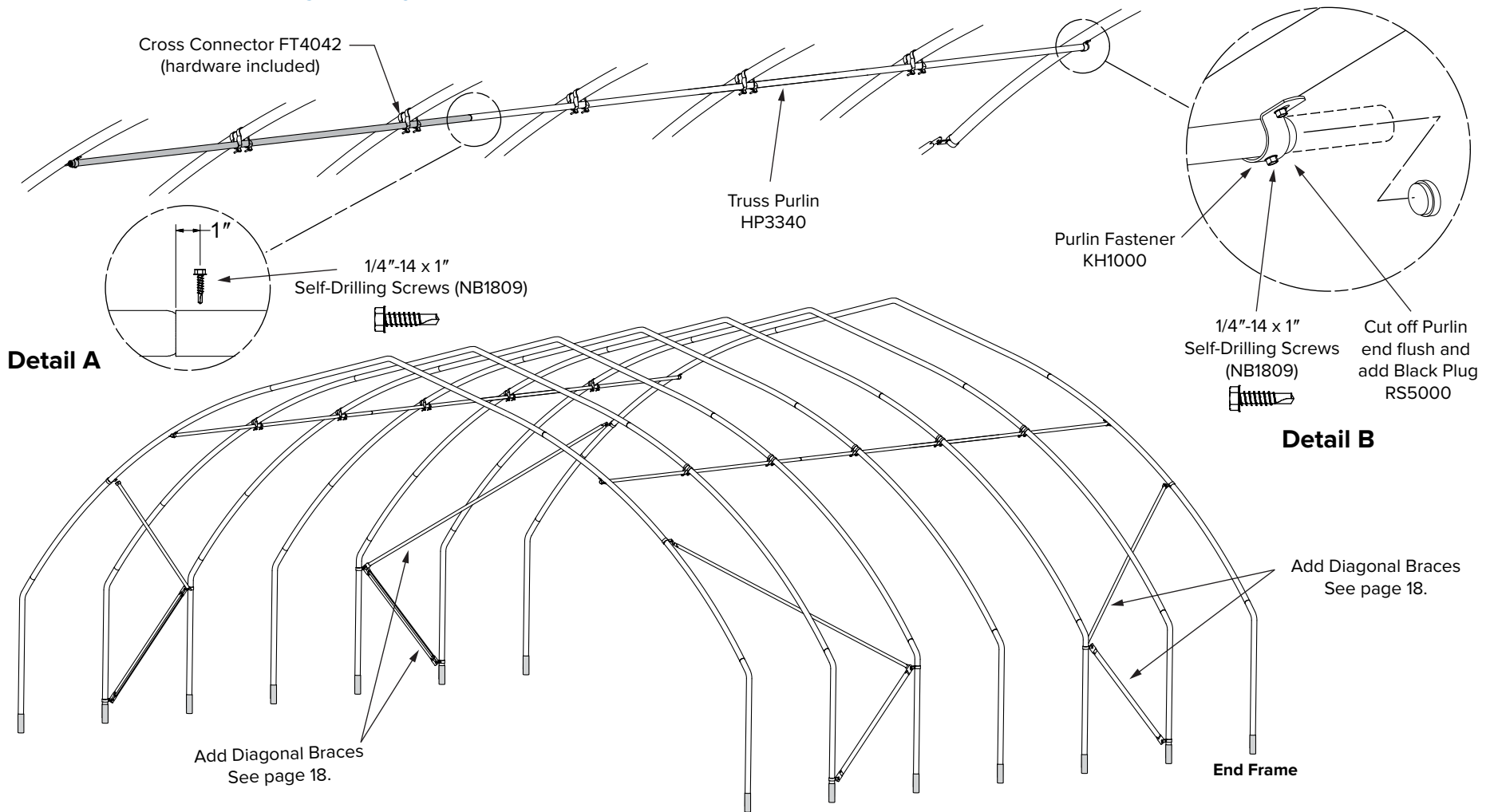

**1** Continue to add the rest of the **Main Frames**. You may want to work in stages and install the **Truss Purlins (HP3340)** as you go along. After the **End Frame** is installed, you need to add the four **Cross Braces**. See steps 1–4 on page 17.

**2** Insert new **Truss Purlin** sections onto the swaged end of the previous **Truss Purlin** until you reach the end. Install the **Cross Connectors** (see page 18). Check that each frame is plumb before you proceed to the next frame.

**3** Use a **1/4"-14 x 1" Self-drilling Screw** screw at each splice. See Detail A.

**4** After you install the last **Purlin** on each side, you will need to trim the end of each **Purlin** flush with the **End Frame**. Use a **Purlin Fastener KH1000** and three **1/4"-14 x 1" Self-drilling Screws** to attach to End Frame. Insert the **Round Black Plug (RS5000)** into the end of each **Purlin**. See Detail B.

# Peak Purlin Installation – Part 1

Instructions on this page apply to 20' & 24' FieldPro Models

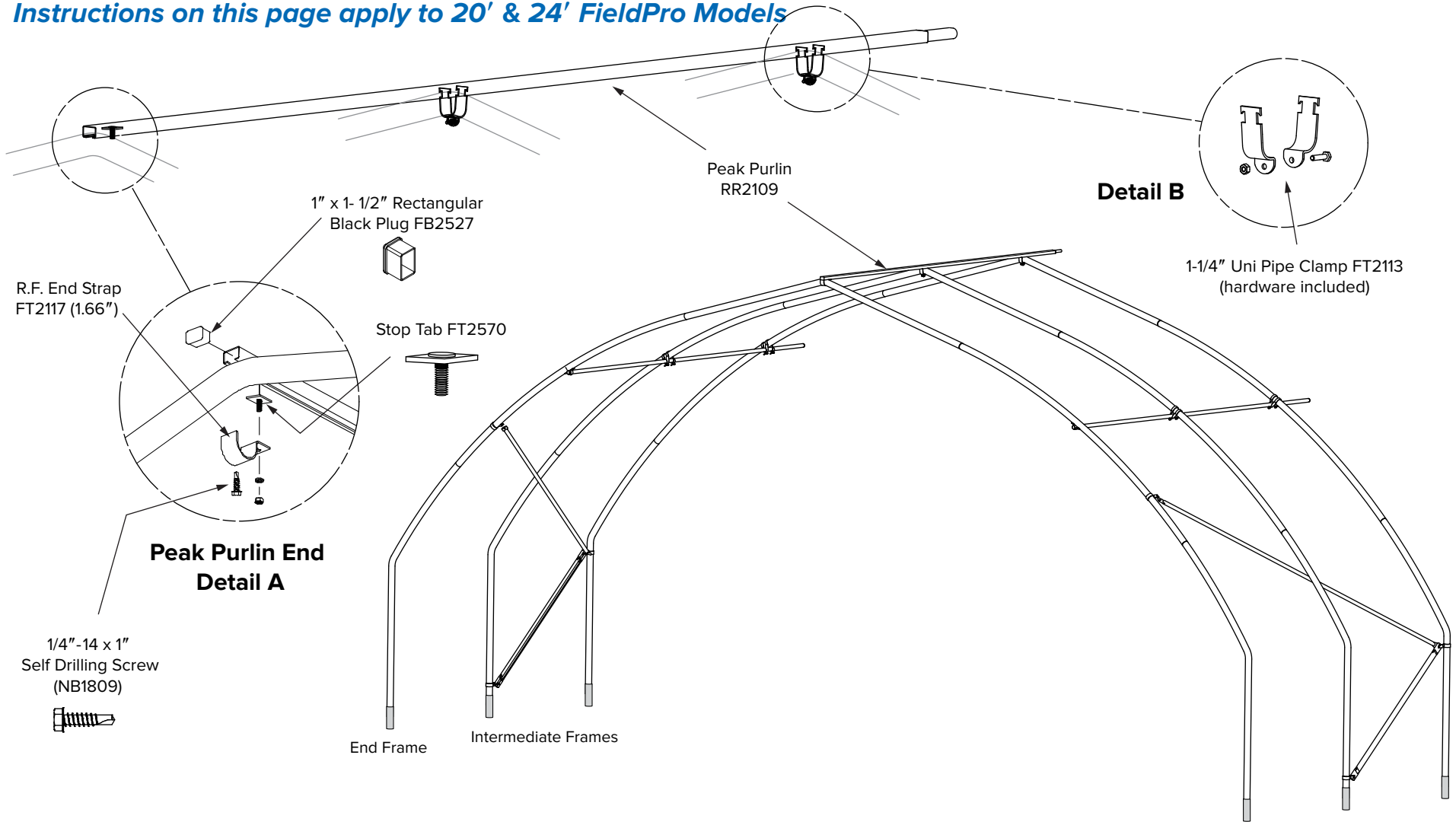

**1** Insert the **Stop Tab (FT2570)** into the Purlin channel. Align the **Peak Purlin (RR2109)** flush with the End Frame. Place the **End Strap (FT2117)** onto the threaded end of the **Stop Tab** and attach with **5/16" Hex Nut (NB1872)** and **5/16" Lock Washer (NB1862)**. See Detail A.

**2** Secure the **End Strap** to the underside of the End Frame with one **1/4"-14 x 1" Self Drilling Screw (NB1809)**. Insert a **Rectangular Black Plug (FB2527)** into the end of the **Peak Purlin** channel. See Detail A.

**3** Use a **Uni Pipe Clamp (FT2113)** to secure the **Peak Purlin** to each intermediate **Main Frame**. Take apart a **Uni Clamp (FT2113)** and insert the notched ends into the **Purlin** channel. Fit the **Uni Clamp** pieces around the **Main Frame** and secure with the Carriage Bolt Lock Washer, and Hex Nut (included). See Detail B.

## Instructions on this page apply to 20' & 24' FieldPro Models

**1** Insert additional **Peak Purlin (RR2109)** sections onto the swaged end of the previous **Peak Purlin** until you reach the end. Install one **1/4"-14 x 1" Self Drilling Screw (NB1809)** self drilling screw at splice as shown in Detail B below.

Secure **Purlins** at each **Main Frame** using a **1-1/4" Uni Pipe Clamp (FT2113)** and hardware as shown in Detail A below.

**2** After the last **Peak Purlin** section has been installed, trim the **Purlin** end flush with the **End Frame**. Fasten the end of the **Purlin** to the **End Frame** using same **End Strap (FT2117)** and hardware as used on the first **End Frame**. See Detail A at top of page 20.

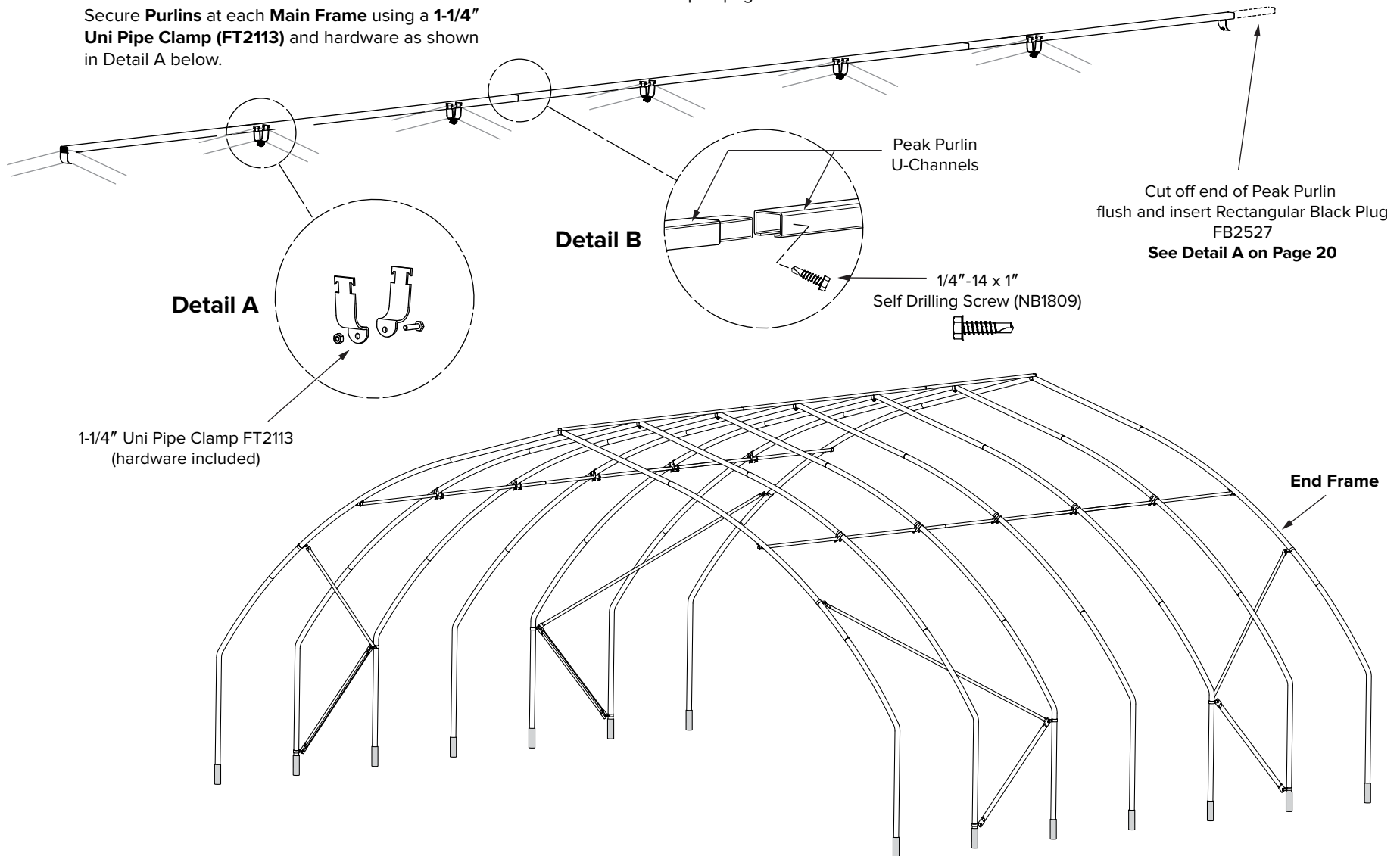

## Instructions on this page apply to 20' & 24' FieldPro Models

**Note:**

The FieldPro 20' and 24' optional Truss Frame Assemblies share several main components. All fittings and hardware are the same for both units.

- 1 Mark the locations where the **Band Braces FT4054** are located on the Main Frame. The measurements shown are from the end of the Peak section for each Main Frame Assembly.



The lower **Band Braces FT4054** can be held in place temporarily with a self-drilling screw, See Detail A.

This will keep the lower Band Braces in place until the Chord has been installed as detailed on page 23.

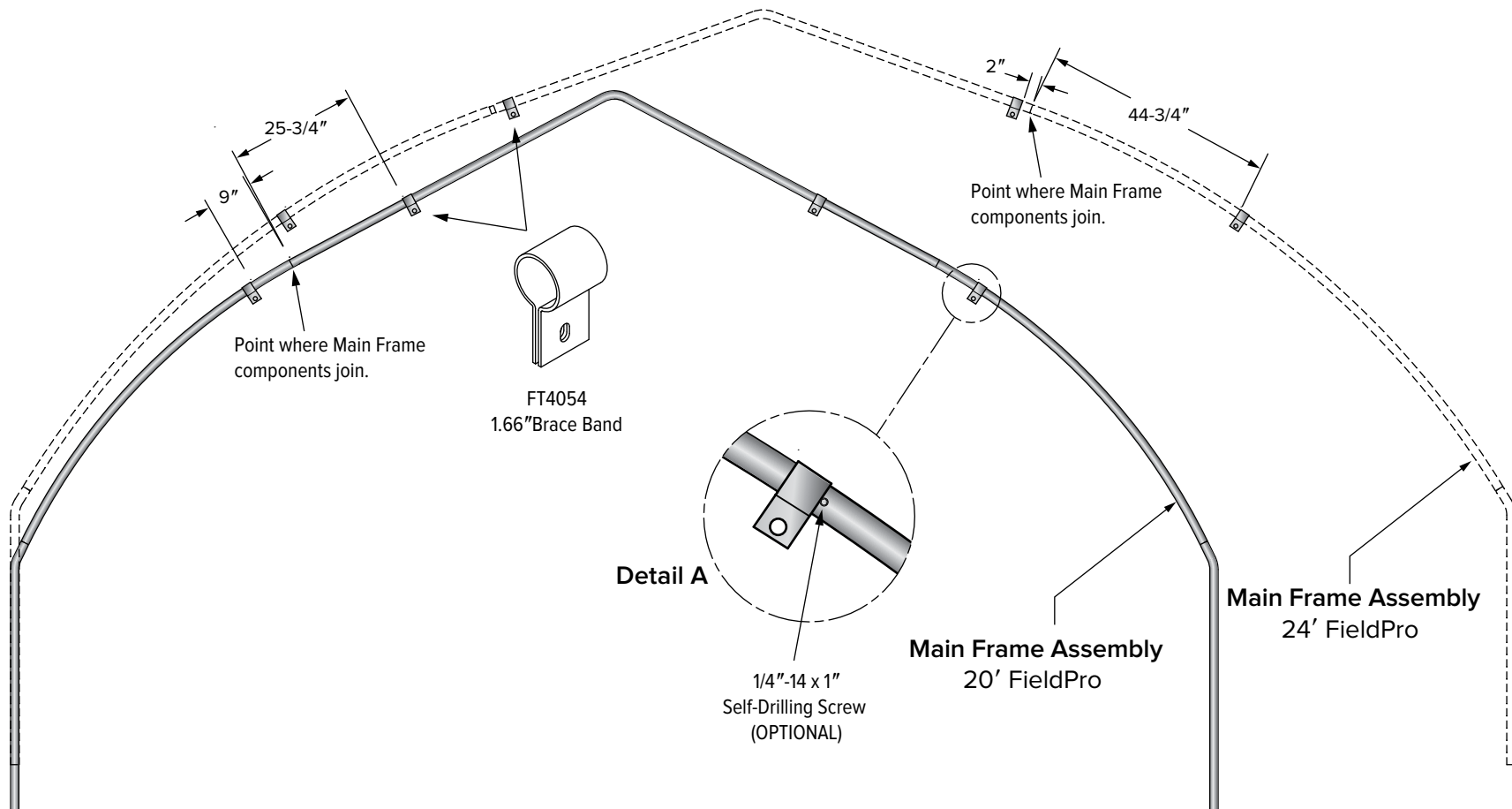

# Truss Frame Assembly – Attaching Truss Chords & Struts

*Instructions on this page apply to 20' & 24' FieldPro Models*

- 1** Assemble the **Chord Sections** on a flat surface. Make sure that the tabs on each end are facing the same direction. Secure the **Chord Sections** together using **1/4" - 14 X 1" self-drilling screws (NB1809)** as shown in Detail A.
- 2** Mount the assembled Chord assembly to the pre-positioned **Brace Brackets** on the Main Frame using the **3/8" x 1-1/4" Carriage bolts, 3/8" Lock Washers, and 3/8" Hex Nuts.**
- 3** Attach the **Struts HT1028** to the **Brace Brackets** on the **Main Frame** and the assembled horizontal **Chord Section.** Each end of the **Strut** uses a different **Brace Bracket and Carriage Bolt/Washer/Hex Nut.** See Details A and B.

**Important:**  
Components attached to **Brace Bands** must be mounted on the **outside of the tabs. NEVER install any components between the tabs.**

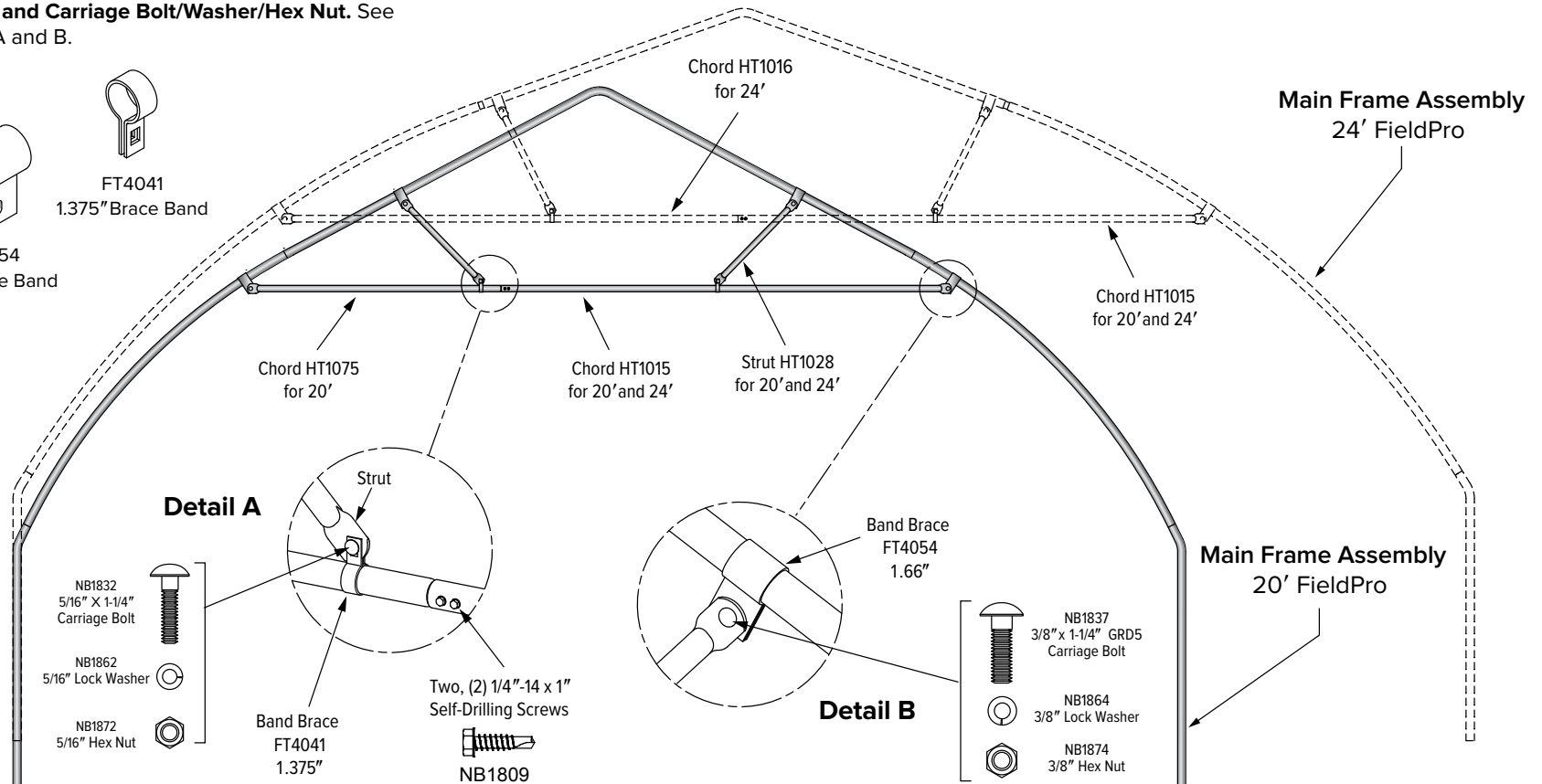
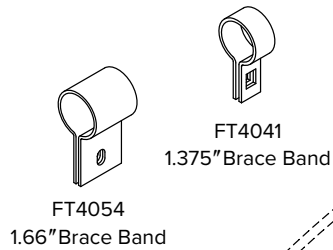
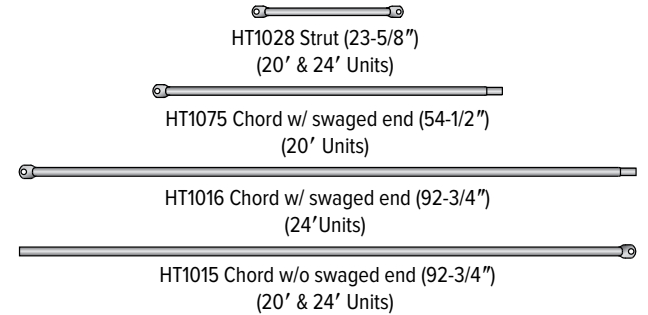
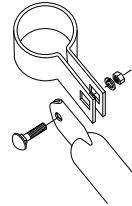

# Installing Wood Side Rails – 20' and 24'

*Instructions on this page apply to 20' & 24' FieldPro Models*

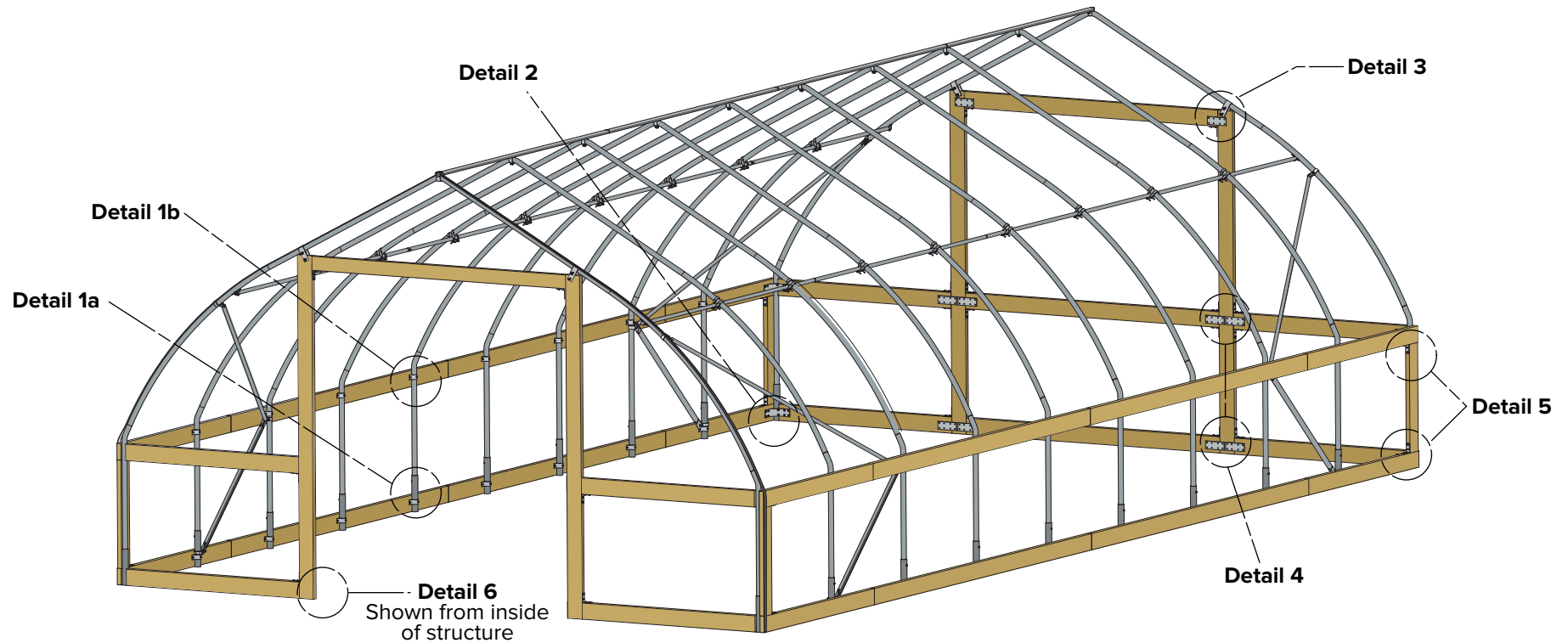

**POLY-TEX recommends the following lumber\***

- Treated 2 x 6 material for the lower rails  
Perimeter distance plus 10% – 12' lengths minimum
- Owners choice of 2 x 4 or 2 x 6 material for other rail locations  
Perimeter distance plus 10% – 12' lengths minimum
- Additional 10' lengths of treated material required.  
Two pieces for the filler boards and three for each end  
(Not required for optional Door Kits)

**Details 1a – 6 are illustrated on the next page.**

**Notes:**

1. The upper side rails are not necessary for the ground-to-ground poly roof applications.
2. If structure was purchased with an optional Door Kit, see pages 34–37 for frame installation instructions.

- All lumber supplied by others

# Wood Side Rail Fastening Details

*Instructions on this page apply to 20' & 24' FieldPro Models*

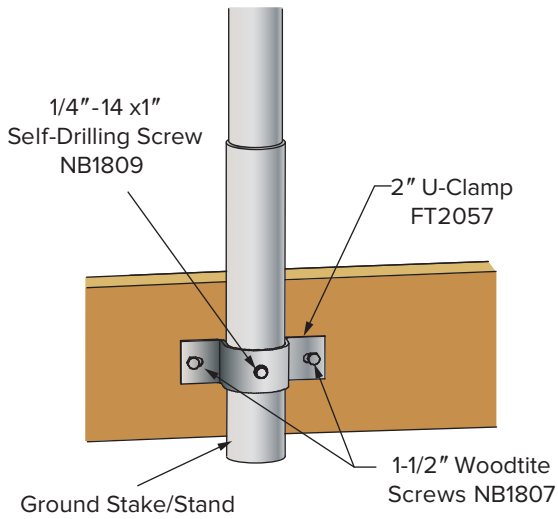

**Detail 1a**

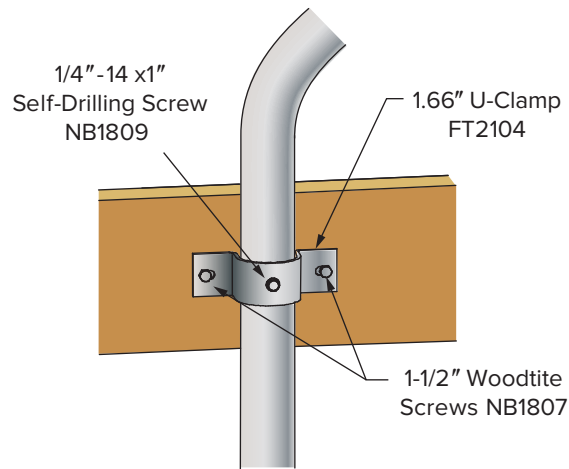

**Detail 1b**

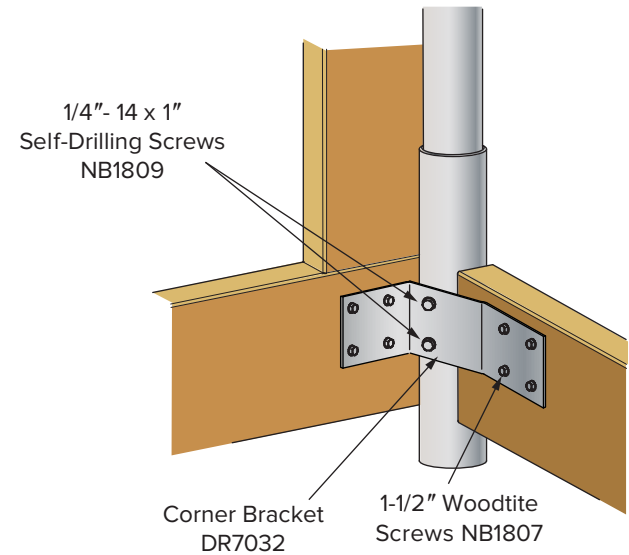

**Detail 2**

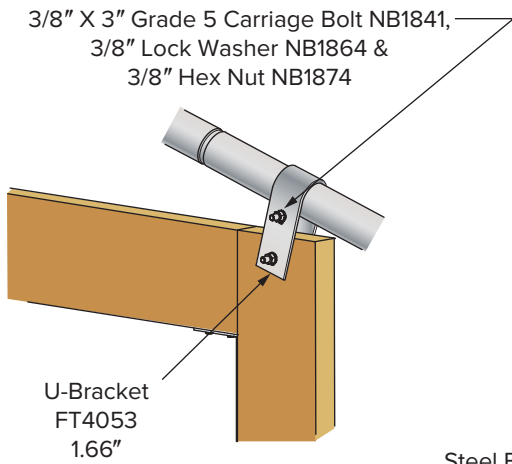

**Detail 3**

Shown from inside of structure

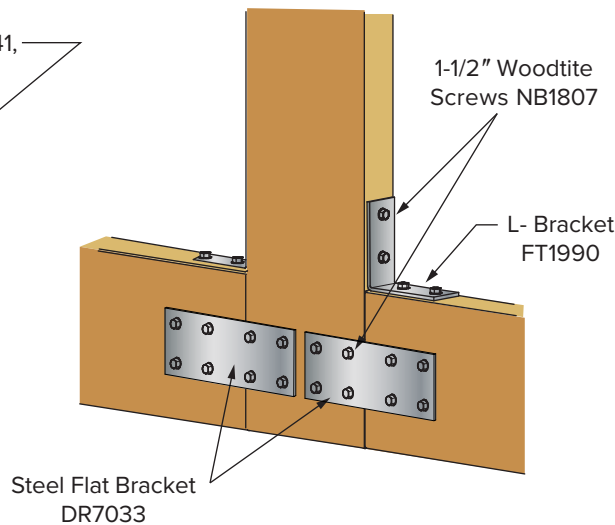

**Detail 4**

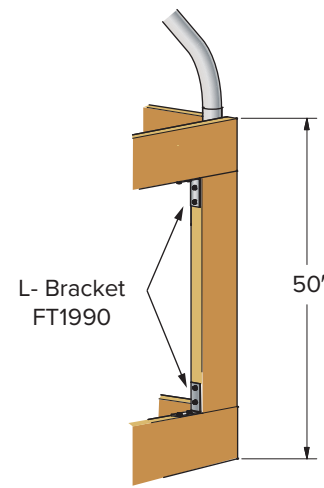

**Detail 5**

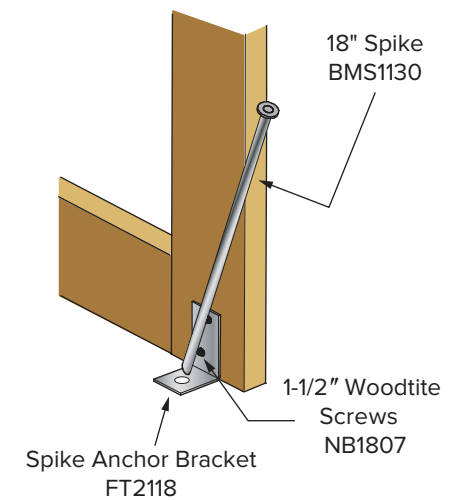

**Detail 6**

Shown from inside of structure

# Plain End Wall Wiggle Wire Base Installation

*Instructions on this page apply to 20' & 24' FieldPro Models*

**1** Attach **Wiggle Wire Base** to the outside of the bottom **Wood Base Rail** flush with the top. Section B-B shows proper screw usage.

**2** Install **Wiggle Wire Base** to **End Frame** starting at the bottom of the **Wood Rail** on each side. Install the **Wiggle Wire Base** over the top of the **Peak Purlin**. See Detail A. The **Wiggle Wire Base** is to be installed as one continuous run from one side of the **End Wall** to the bottom of the opposite side. Section A-A shows proper screw usage.

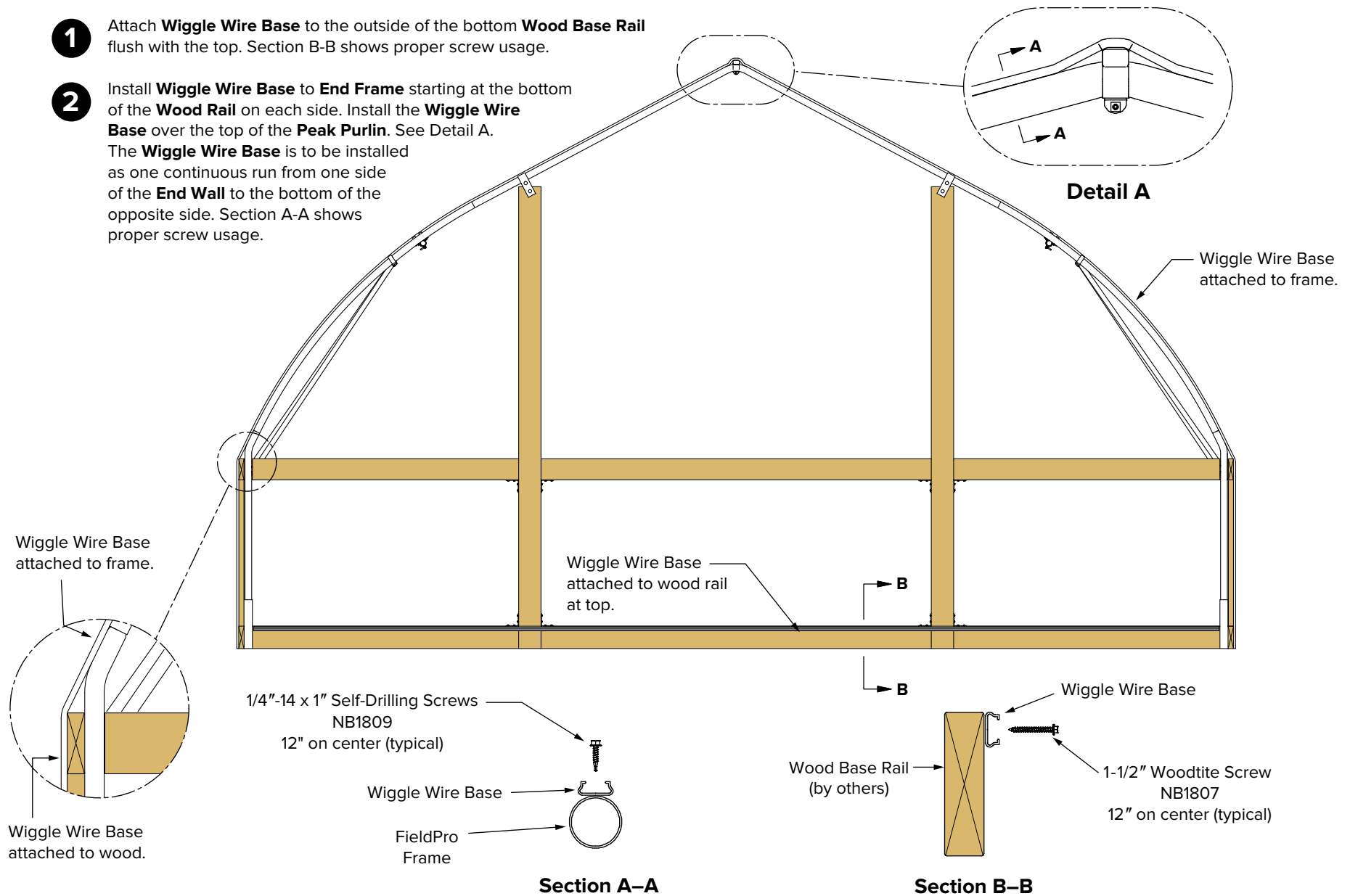

## Instructions on this page apply to 20' & 24' FieldPro Models

- 1** **Positioning the Poly**  
You will need some help with this step. After all the **Wiggle Wire Base** has been attached, position the **Poly Film** over the **End Frame**. Be sure to have leave excess **Poly** on all sides. You can always trim the **Poly** closer after the installation is completed.



You may want to install a few 12" pieces of the **Wiggle Wire** here and there to keep the large sheet of **Poly** temporarily in place. This will also provide an opportunity to pre-stretch the **Poly**. These 12" pieces can be reused to reinforce the corners after all the **Wiggle Wire** is installed.

- 2** Begin to install the **Wiggle Wire** all around the **End Frame** and across the **Lower Wood Rail**.

Note: See page 30 for instructions on how to retain the **Poly** in the **Wiggle Wire Base** using the **Wiggle Wire**.

If the **Poly** is installed on a cool day, the **Poly** will expand when the outside temperature warms. It may be necessary to retighten the sheet of **Poly**.

After all the **Wiggle Wire** is installed, use 12" pieces to reinforce the corners. See details on page 30.

After all the **Wiggle Wire** has been installed, trim the **Poly Film** on all sides and bottom, leaving a minimum of 1" of material on all sides.

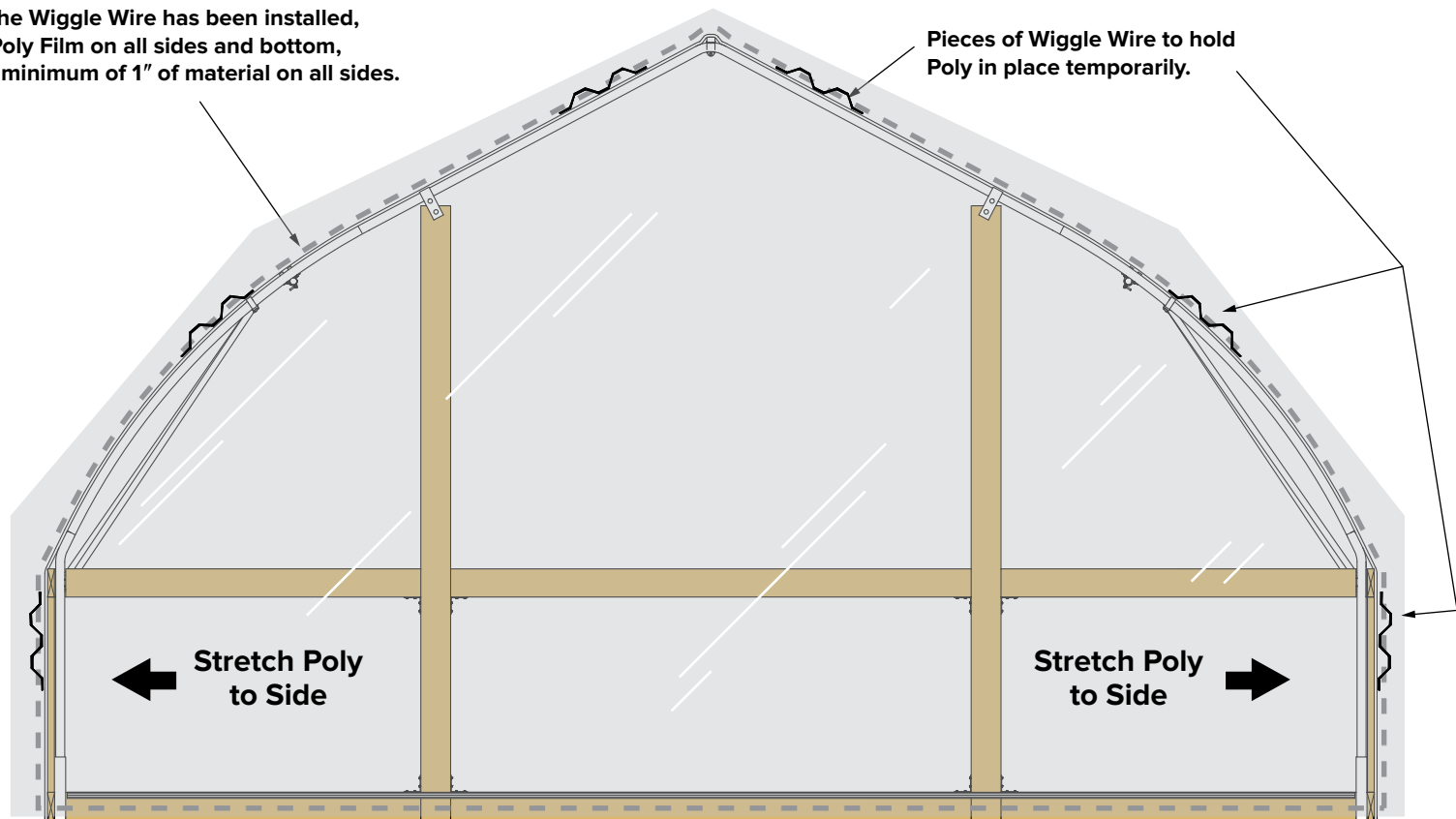

# Open Doorway – Part 1 – Adding Wood

*Instructions on this page apply to 20' & 24' FieldPro Models*

**Notes:**

See pages 24 and 25 for details about adding wood components and hardware details.

- 1** Attach **Wiggle Wire Base** to the outside of the bottom **Wood Base Rail** flush with the top. Section B-B shows proper screw usage.
- 2** Attach **Wiggle Wire Base** to both side of vertical jambs and across bottom of header.
- 3** Install **Wiggle Wire Base to End Frame** starting at the bottom of the **Wood Rail** on each side. Install the **Wiggle Wire Base** over the top of the **Peak Purlin**. See Detail A. The **Wiggle Wire Base** is to be installed to the top of the **End Wall** as one continuous run from one side to the bottom of the opposite side. Section A-A shows proper screw usage.

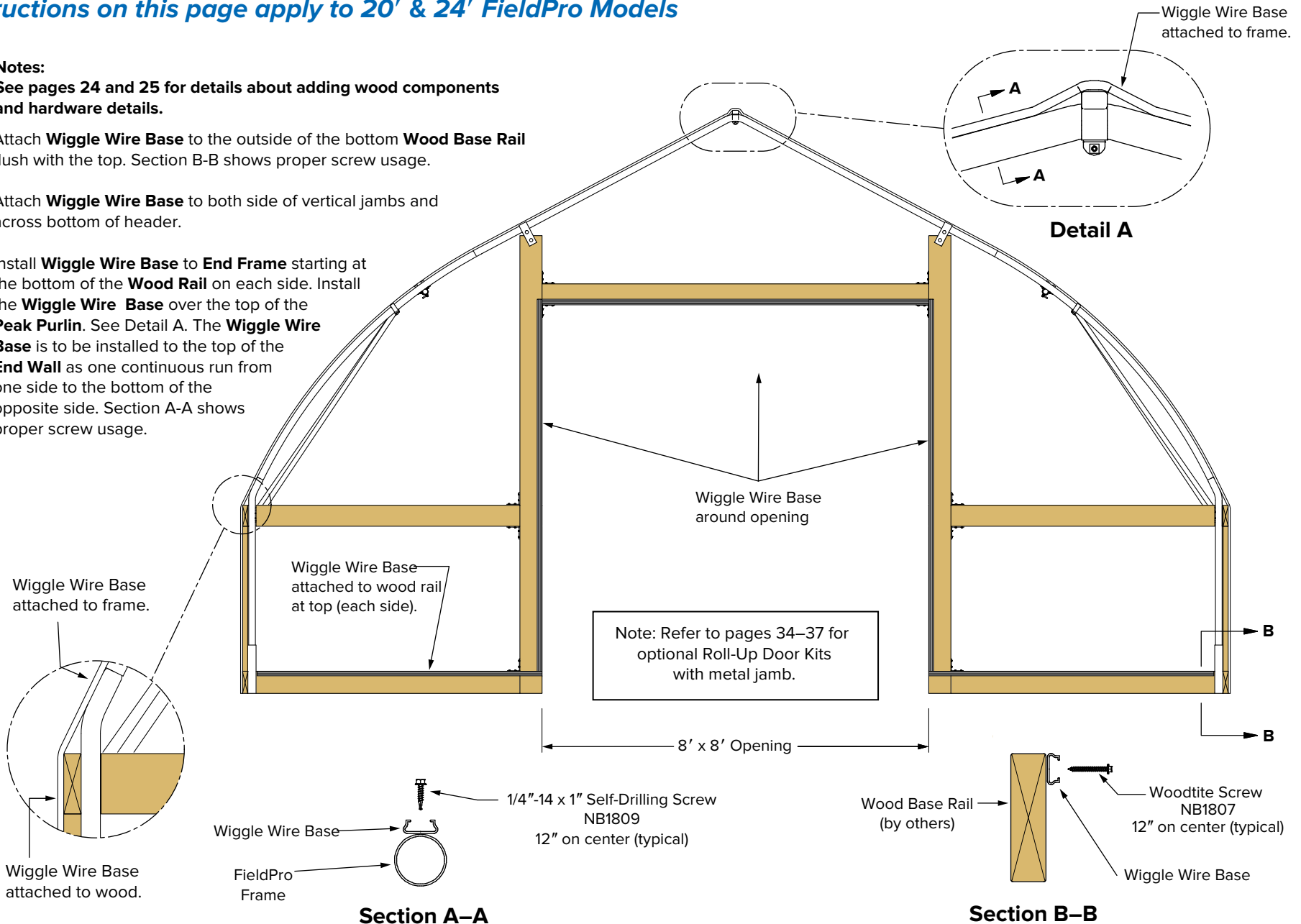

## Instructions on this page apply to 20' & 24' FieldPro Models

- 1 Positioning the Poly**  
You will need some help with this step. After all the **Wiggle Wire Base** has been attached, position the **Poly Film** over the **End Frame**. Be sure to have leave excess **Poly** on all sides. You can always trim the **Poly** closer after the installation is completed.



You may want to install a few 12" pieces of the **Wiggle Wire** here and there to keep the large sheet of **Poly** temporarily in place. This will also provide an opportunity to pre-stretch the **Poly**. These 12" pieces can be reused to reinforce the corners after all the **Wiggle Wire** is installed.

- 2** Install **Wiggle Wire** all around the **End Frame**, across the **Lower Wood Rail** and around door opening.

Note: See page 30 for instructions on how to retain the **Poly** in the **Wiggle Wire Base** using the **Wiggle Wire**.

If the **Poly** is installed on a cool day, the **Poly** will expand when the outside temperature warms. It may be necessary to re-tension the sheet of **Poly**.

After all the **Wiggle Wire** is installed, use 12" pieces to reinforce the corners. See details on page 30.

After all the **Wiggle Wire** has been installed, trim the **Poly Film** on all sides and bottom, leaving a minimum of 1" of material on all sides.

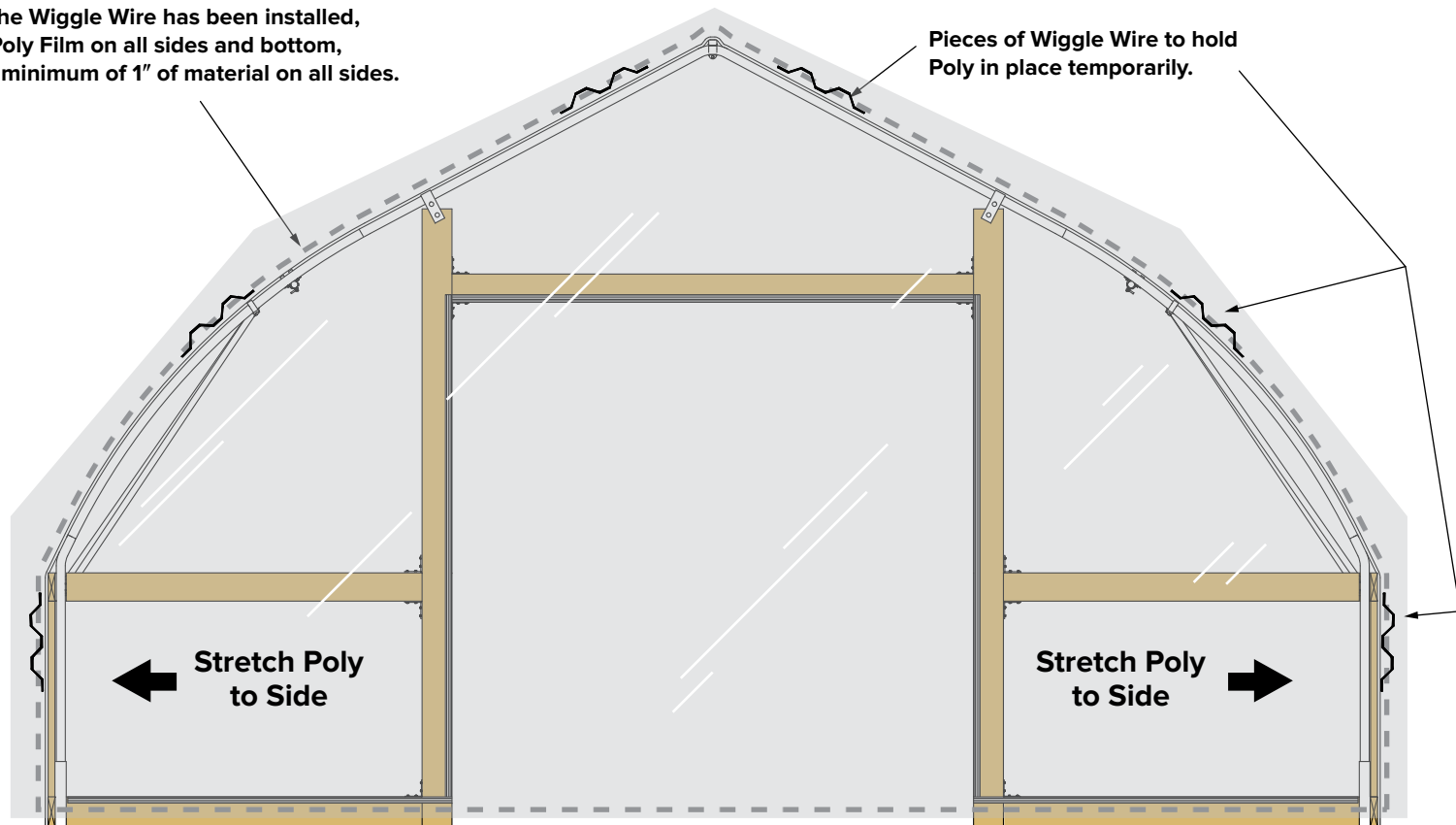

# Wiggle Wire Installation



Consider having one person tension the Poly Film while a second person inserts the Wiggle Wire. See Detail 1 on pages 32 and 33.

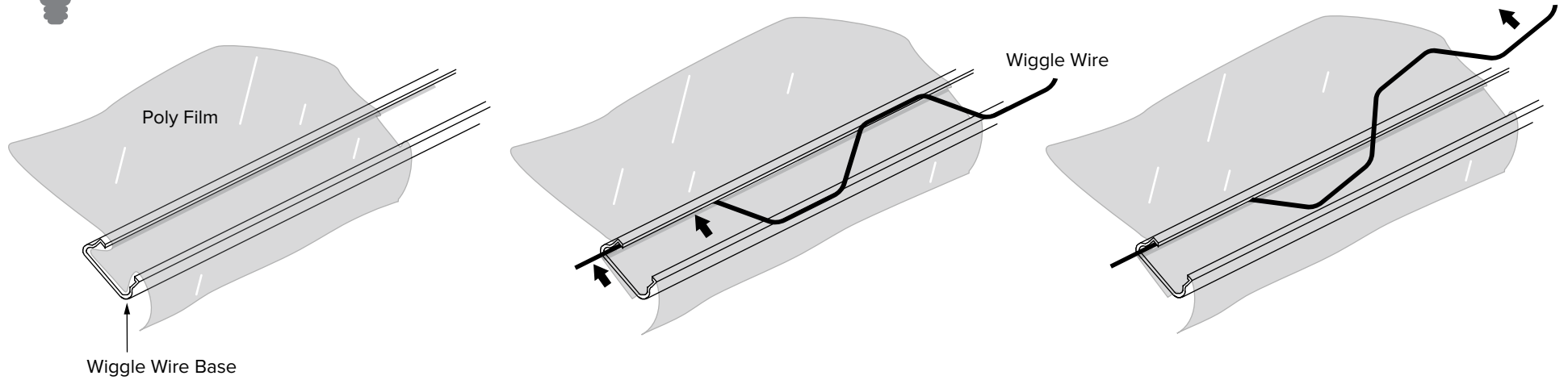

**1** Carefully begin to fold the Poly Film into the Wiggle Wire base while keeping a constant tension on the Poly Film to avoid wrinkles.

**2** Insert one end of the Wiggle Wire as shown above while maintaining tension on the Poly Film.

**3** Bend the Wiggle Wire up just enough to clear the edge of the Wiggle Wire Base.

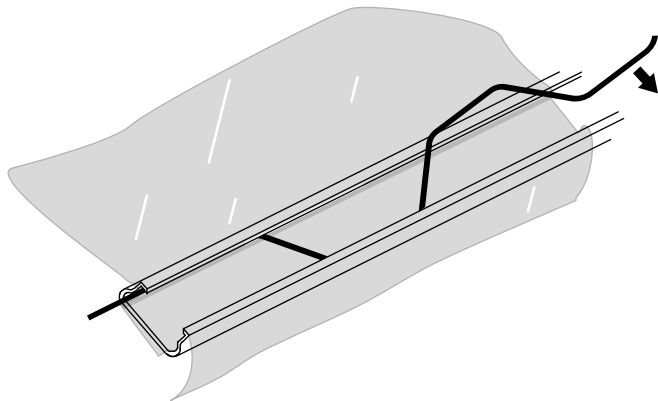

Continue feeding the Wiggle Wire into the Base always keeping the Poly Film under a constant tension to avoid wrinkles.

Overlap previous Wiggle Wire when adding a new Wiggle Wire.

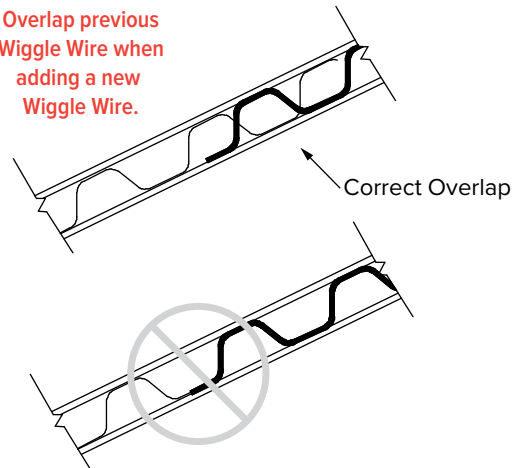

Wrong - No Overlap

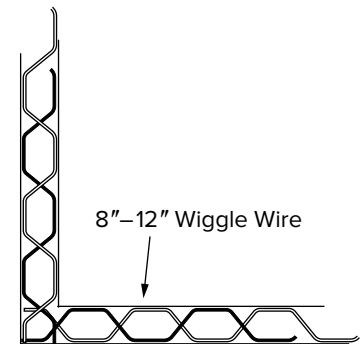

Reinforce all corners with additional 8"-12" sections of Wiggle Wire.

**5**

**NOTE:** Take care not to Rub/Pinch/Abraid the Poly with the Wiggle Wire during installation.

## Instructions on this page apply to 20' & 24' FieldPro Models

### General Notes:

- These instructions pertain to both Roof Poly installations and explain the best method for initial placement of the Poly.
- Pick a calm day when attempting to install the Roof Poly. On a windy day, it is almost impossible to handle the Poly.
- If the Poly is installed on a cool day, the material may expand as the temperature warms causing the Poly to droop. If this happens, it may be necessary to re-tension the Poly and adjust the Wiggle Wire as needed at a later date.

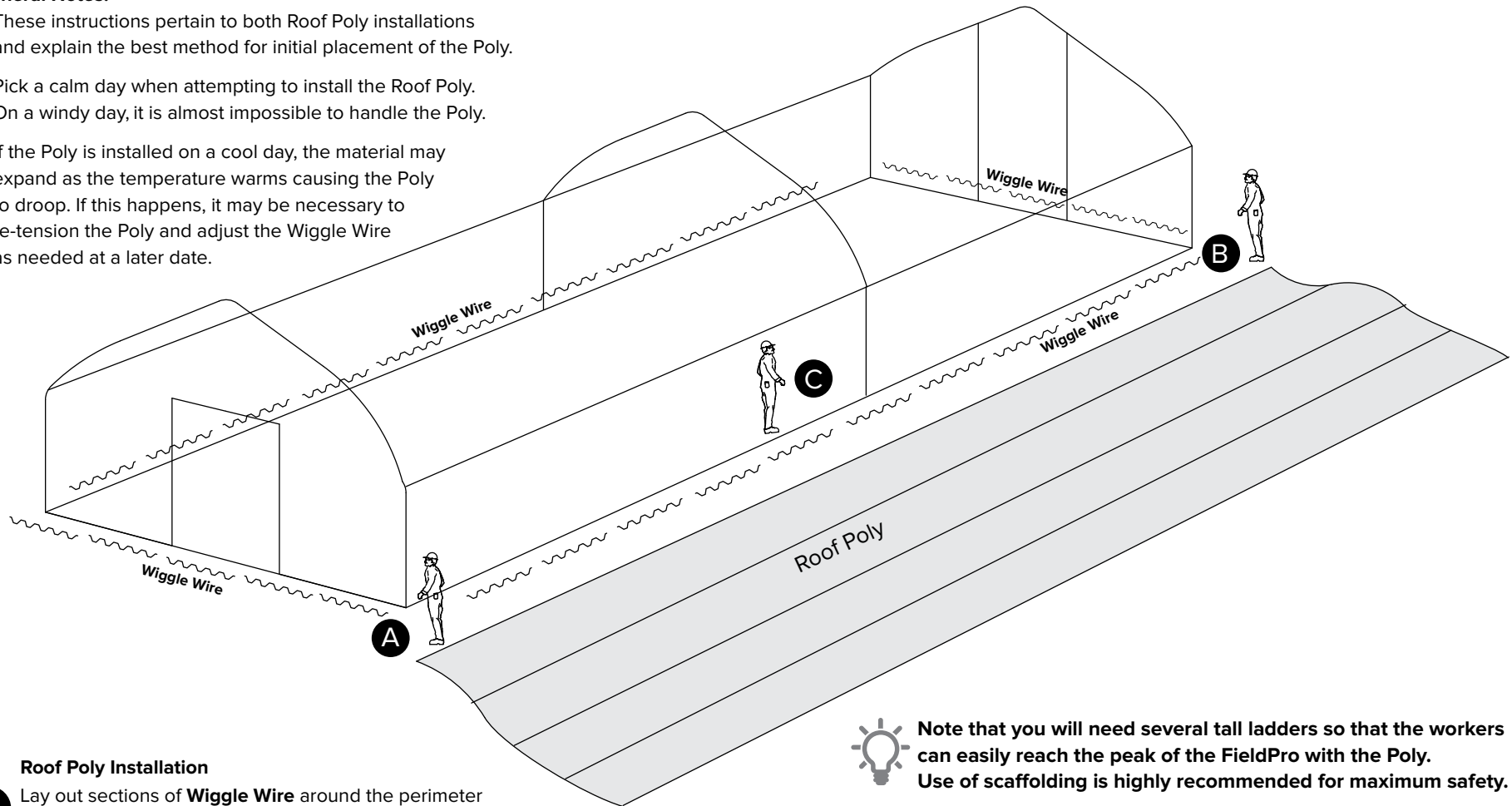

### Roof Poly Installation

- 1** Lay out sections of **Wiggle Wire** around the perimeter of the FieldPro so they are handy. Unroll the **Poly** on the ground along the length of the FieldPro. Be sure to have equal overhang at both ends.
- 2** Place one worker at Point **A** and one at Point **B**. It helps to have another worker inside the FieldPro on a ladder near Point **C** to help move the **Poly** up and over the FieldPro frame sections.

 Note that you will need several tall ladders so that the workers can easily reach the peak of the FieldPro with the Poly. Use of scaffolding is highly recommended for maximum safety.

# Installing Roof Poly on FieldPro with Roll-Up Side Curtain

*Instructions on this page apply to 20' & 24' FieldPro Models*

Note: These instructions are for a FieldPro that will feature the Roll-Up Poly Curtain. See page 33 for the Ground-to-Ground Roof Poly Installation.

**1** Once the Poly is in position, place a couple of temporary sections of **Wiggle Wire** between Point **4** and Point **6** to help prevent the Poly from shifting while the **Wiggle Wire** is installed on the first side.

**2** Begin installing **Wiggle Wire** at Point **2** (center of the FieldPro) and work down to Point **1**. Return to Point **2** and install **Wiggle Wire** to Point **3**. Be sure to let the **Poly** edge overhang 3 to 6 inches on all sides.

It helps to have two workers install the **Wiggle Wire** to prevent drooping and main proper tension down the entire length. One worker tensions the **Poly** while the second worker follows along inserting the **Wiggle Wire**. Using a helper in this manner while installing the **Wiggle Wire** will make the wrinkles disappear. See Detail 1.

**3** Now go to the other side of the FieldPro. Begin Installing **Wiggle Wire** at Point **5** working one side at a time same as the first side. Use a helper again to help tension the **Poly** as the **Wiggle Wire** is inserted.

Be sure the **Wiggle Wire** is seated properly into the **Wiggle Wire Base**. Adjust the **Poly** and **Wiggle Wire** as required.

**4** Starting at the top of the **End Frame** at Point **7**, begin installing **Wiggle Wire** down to Point **4**. Go back to top and install **Wiggle Wire** down to Point **1**. Next do the same on the other **End Frame** of the FieldPro.

**5** After all the **Wiggle Wire** has been installed on both sides and along the top of both **End Frames** of the FieldPro, the corners (see red dots in illustration) need to be reinforced with additional 12" pieces of **Wiggle Wire**. Also note Detail 2 showing proper way to install the **Wiggle Wire** at the corners.

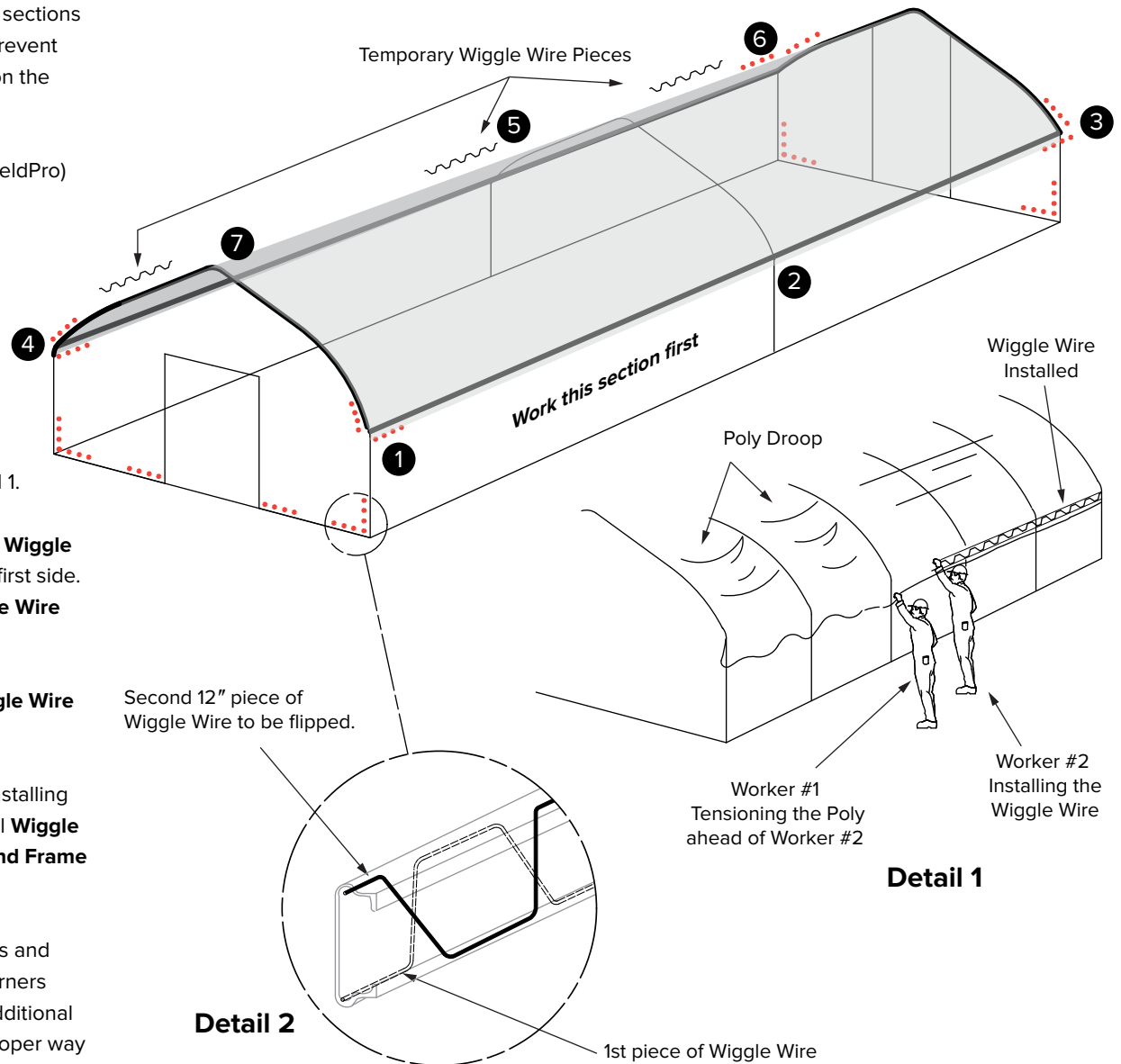

# Installing Ground-to-Ground Roof Poly

Instructions on this page apply to 20' & 24' FieldPro Models

**1** Once the Poly is in position, place a couple of temporary sections of **Wiggle Wire** between Point **4** and Point **6** to help prevent the Poly from shifting while the **Wiggle Wire** is installed on the first side.

**2** Begin installing **Wiggle Wire** at Point **2** (center of the FieldPro) and work down to Point **1**. Return to Point **2** and install **Wiggle Wire** to Point **3**. Be sure to let the **Poly** edge overhang 3 to 6 inches.

It helps to have two workers install the **Wiggle Wire** to prevent drooping and main proper tension down the entire length. One worker tensions the **Poly** while the second worker follows along inserting the **Wiggle Wire**. Using a helper in this manner while installing the **Wiggle Wire** will make the wrinkles disappear. See Detail 1.

**3** Now go to the other side of the FieldPro. Begin Installing **Wiggle Wire** at Point **5** working one side at a time same as the first side. Use a helper again to help tension the **Poly** as the **Wiggle Wire** is inserted.

Be sure the **Wiggle Wire** is seated properly into the **Wiggle Wire Base**. Adjust the **Poly** and **Wiggle Wire** as required.

**4** Starting at the top of the **End Frame** at Point **7**, begin installing **Wiggle Wire** down to Point **4**. Go back to top and install **Wiggle Wire** down to Point **1**. Next do the same on the other **End Frame** of the FieldPro.

**5** After all the **Wiggle Wire** has been installed on both sides and along the top of both **End Frames** of the FieldPro, the corners (see red dots in illustration) need to be reinforced with additional 12" pieces of **Wiggle Wire**. Also note Detail 2 showing proper way to install the **Wiggle Wire** at the corners.

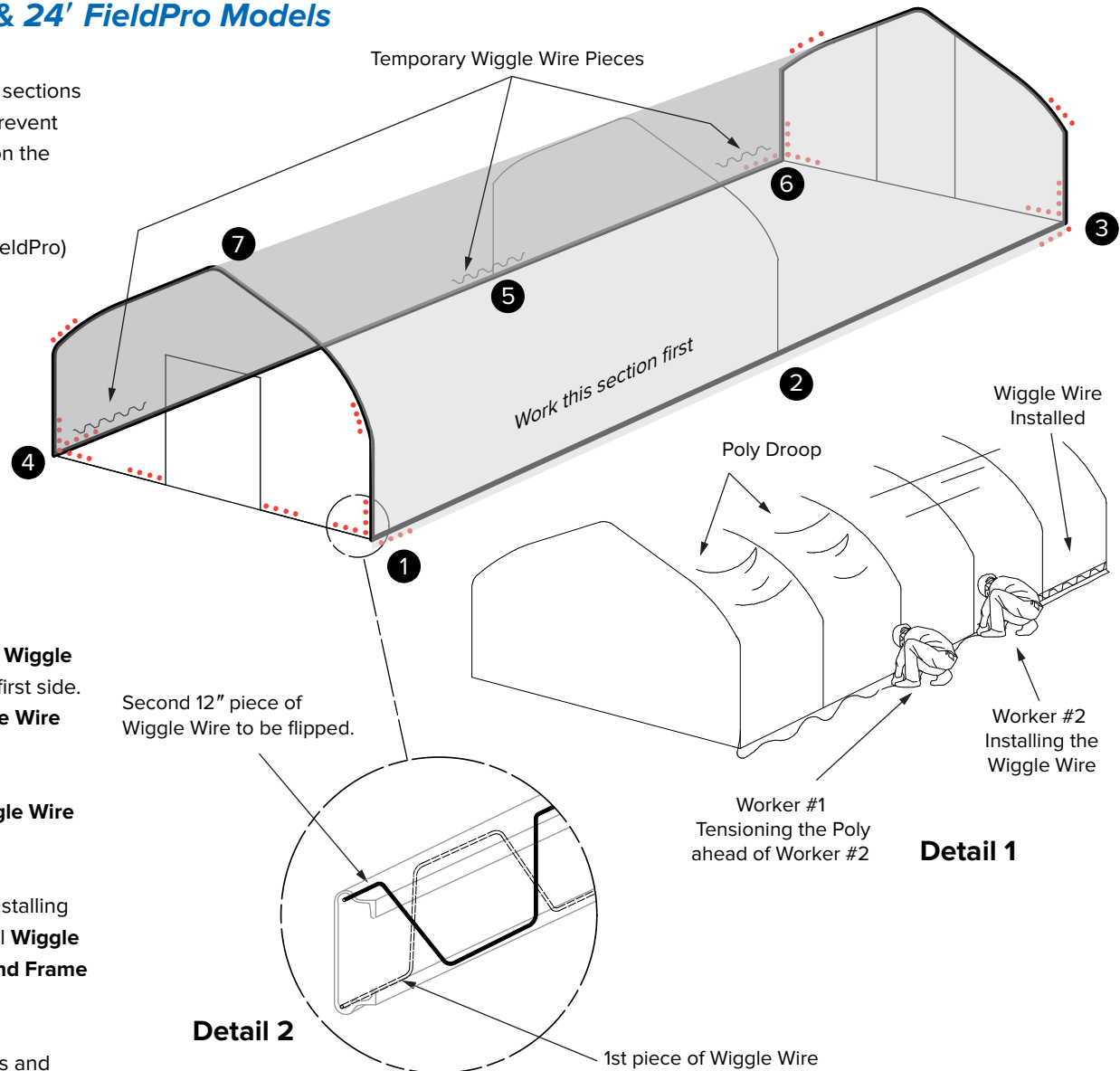

# Optional Door Kit Components and Hardware

Items shown on this page apply to 20' & 24' FieldPro Models



PT2521  
10" Bungee Ball



RC1316  
Roll-Up Door Cradle



FT2071  
Roll-Up Door 'J' Hook



RC1303  
U-Joint w/Bolts

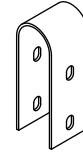

FT4053  
U-Bracket (1.66")

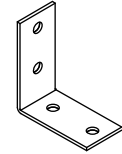

FT1990  
R.F. 'L' Bracket

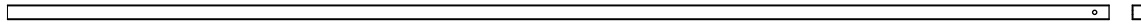

HT1004 - End Vert/Door Jamb (20' Gothic)

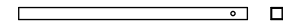

HT1080 Door Jamb Extension

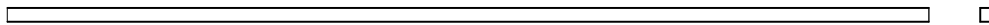

HT1010 - Door Header (8')



WIGGLWIRE - 43.000  
Wiggle Wire



WWBASE9  
8'-11" Wiggle Wire Base



GS2408  
1.315" Dia. Ground Stake (24")

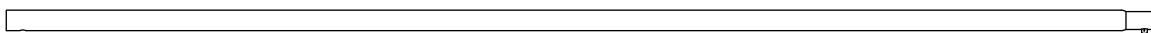

RC1007 - Roll-Up Tube Bottom 6'-2 1/4"



RC1026 - Roll-Up Tube Bottom Extension 5'



RC1010  
Roll-Up Tube Clip

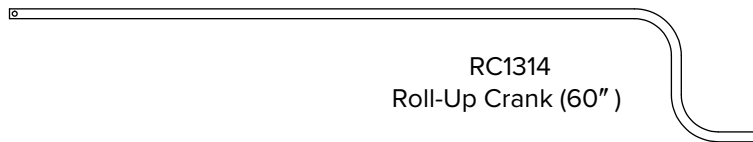

RC1314  
Roll-Up Crank (60")

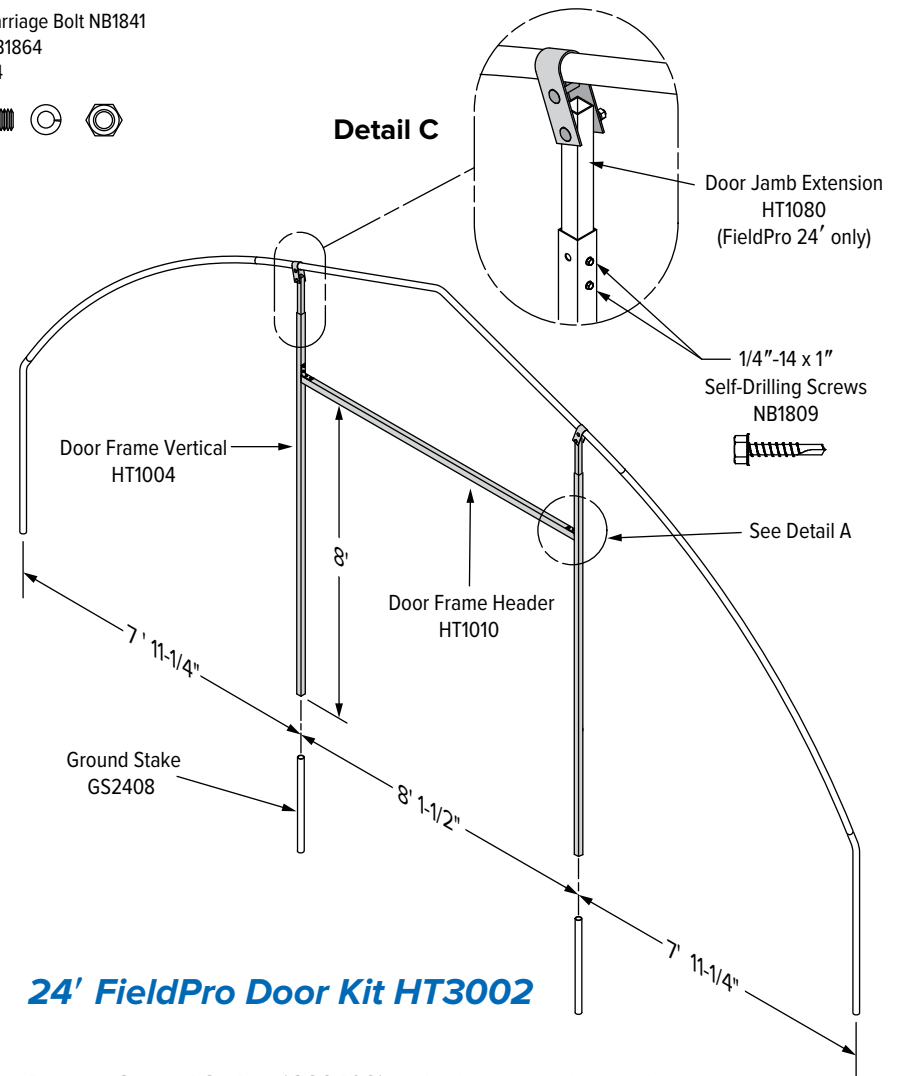
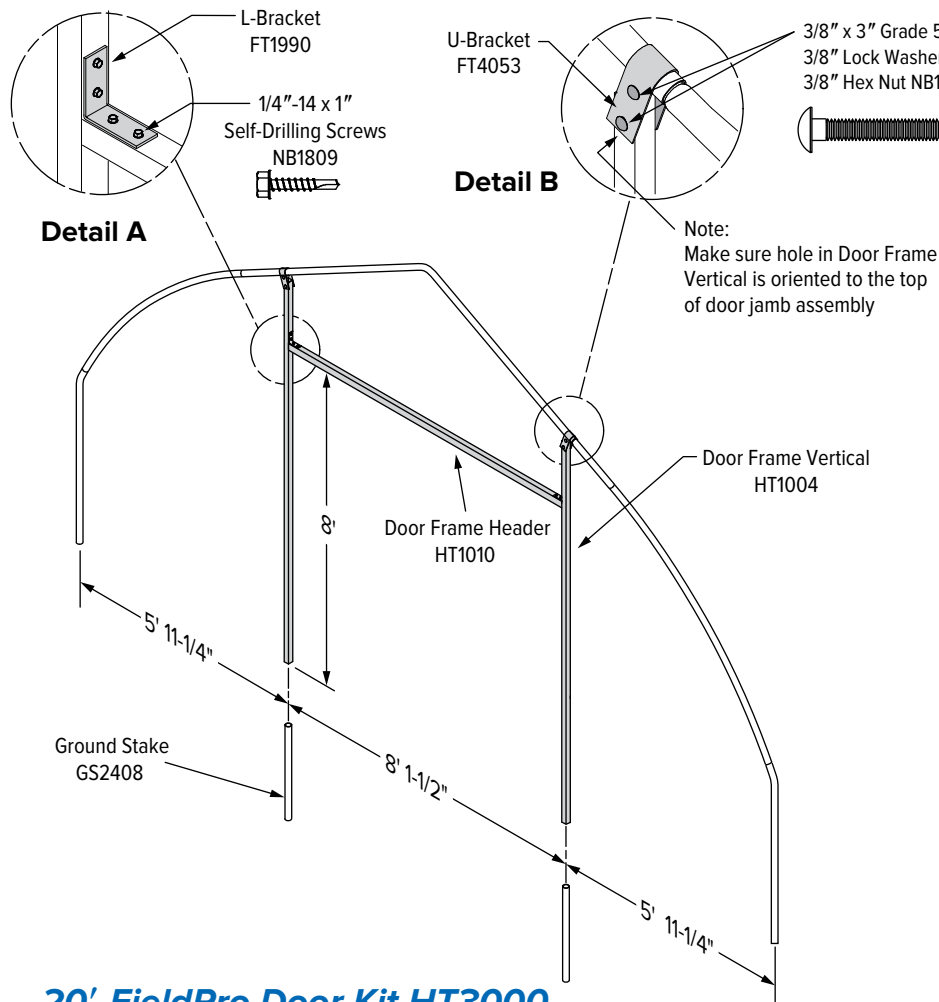

- 1 Drive in **Ground Stakes (GS2408)** at the locations shown above. Slide **Door Frame Verticals (HT1004)** over the **Ground Stakes**.
- 2 Attach the tops of the **Door Frame Verticals** to the **End Frame** using the **U-Brackets (FT4053)** and carriage bolts. See Detail B above. Make sure both **Door Frame Verticals** are plumb.
- 3 Attach the **Door Frame Header (HT1010)** using **L-Brackets (FT1990)** and self-drilling screws. See Detail A above.

- 1 Drive in **Ground Stakes (GS2408)** at the locations shown above. Slide **Door Frame Verticals (HT1004)** over the **Ground Stakes**.
- 2 Insert a **Door Jamb Extension (HT1080)** into the top of each **Door Frame Vertical**. Attach the **Door Frame Extensions** to the **End Frame** using the **U-Brackets (FT4053)** and carriage bolts. Secure the assembly using self-drilling screws. Make sure the jamb pieces are plumb. See Detail C above.
- 3 Attach the **Door Frame Header (HT1010)** using **L-Brackets (FT1990)** and self-drilling screws as shown in Detail A.

*Instructions on this page apply to 20' & 24' FieldPro Models*

**1** Measure the distance from the **Metal Door Jamb** to the **End Frame** for upper and lower wood\* side rails. Attach the wood rails using the **“L” Bracket (FT1990)** and appropriate screws. See Details A & B. Also see Detail #2 on page 25 to see how the side rails are attached at the corners.

**2** Attach **Roll-Up Door Cradles (RC1316)** at the bottom of each jamb as shown in Detail A.

**3** Cut five **Wiggle Wire Base** sections to length for use on the lower wood rails and around the Door Frame. Attach **Wiggle Wire Base** to wood rails using **Woodtite Screws (NB1807)** every 12".

Attach **Wiggle Wire Base** to metal jamb pieces and header using **1/4"-14 X 1" Self-drilling Screws (NB1809)** every 12".

**4** Install the Poly material to the end wall before you proceed to Part 3 on the next page. Refer to details on page 29 showing how the Poly is installed in wood framed doorway end application. Also see page 30 showing Wiggle Wire Installation.

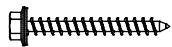

1 1/2" Woodtite Screw NB1807

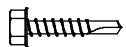

1/4" - 14x 1" Self-Drilling Screw NB1809

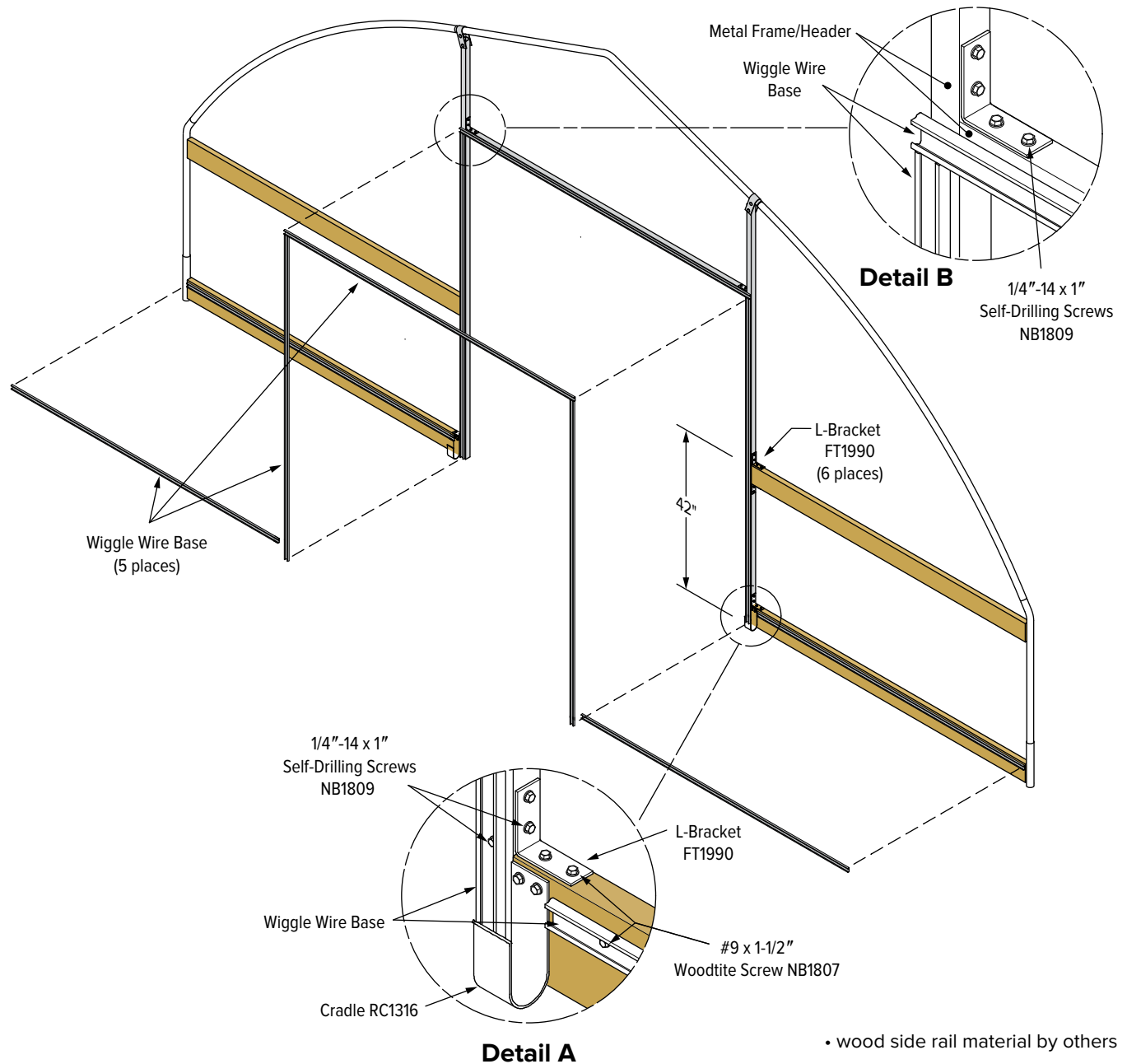

• wood side rail material by others

## Instructions on this page apply to 20' & 24' FieldPro Models

20' & 24' models both use **Door Kit (HT1013)**  
Refer to the door kit for contents.

- 1** Lay out the **Reinforced Poly Door** on a flat surface.
- 2** Insert the **Roll-Up Tube w/Snap Button (RC1007)** into the **Tube Bottom Extension (RC1026)**. Slide the assembled tubes into the sleeve at the bottom of the **Poly Door**. See Detail 1.

Secure the **Poly Door** to the **Door Tube** using **Roll-Up Tube Clips (RC1010)** approximately every 36". Set the **Poly Door** with **Tube** in the **Cradles**.

- 3** Lift the free end of the **Poly Door** to the top of the door frame and secure with **Wiggle Wire**. Be sure to center the door over the opening. Note: It is important that the **Roll-Up Door Tube** is still resting in the **Cradles** after the **Wiggle Wire** has been installed along the top.

- 4** Using the **Grommets** in the **Poly Door** as a guide, drill three 3/8" holes through the **Wiggle Wire Base** and **Wood Jamb** on each side of the Door. Insert a **3" Grade 5 Carriage Bolt (NB1841)** with the threaded end facing outside. Add **lock washer and hex nut** and tighten. Install a **Ball Knob** on threaded ends. Loop the **Bungee Cords** over the **Ball Knobs**. See Detail 2.

Install **U-Joint (RC1303)** onto the end of the **Roll-Up Tube** using a **5/16" x 1-3/4" hex bolt** and **lock nut** through the hole. Attach **Roll-Up Crank (RC1314)** to the end of the **U-Joint** using a **5/16" x 1-3/4" hex bolt** and **lock nut**. Install door **"J" Hook (FT2071)** to retain the **Roll-Up Crank** when door is rolled up. See Detail 3.

- 5** Check the operation of the **Poly Door** by unhooking the **Bungee Cords** and rolling up the **Poly Door** to the top grommet elevation. Insert a loose **Bungee Cord** into the center hole of the Door. Wrap the cord around the rolled up part of the door and insert the **Ball** through the loop of the cord. Do same at left and right grommets.

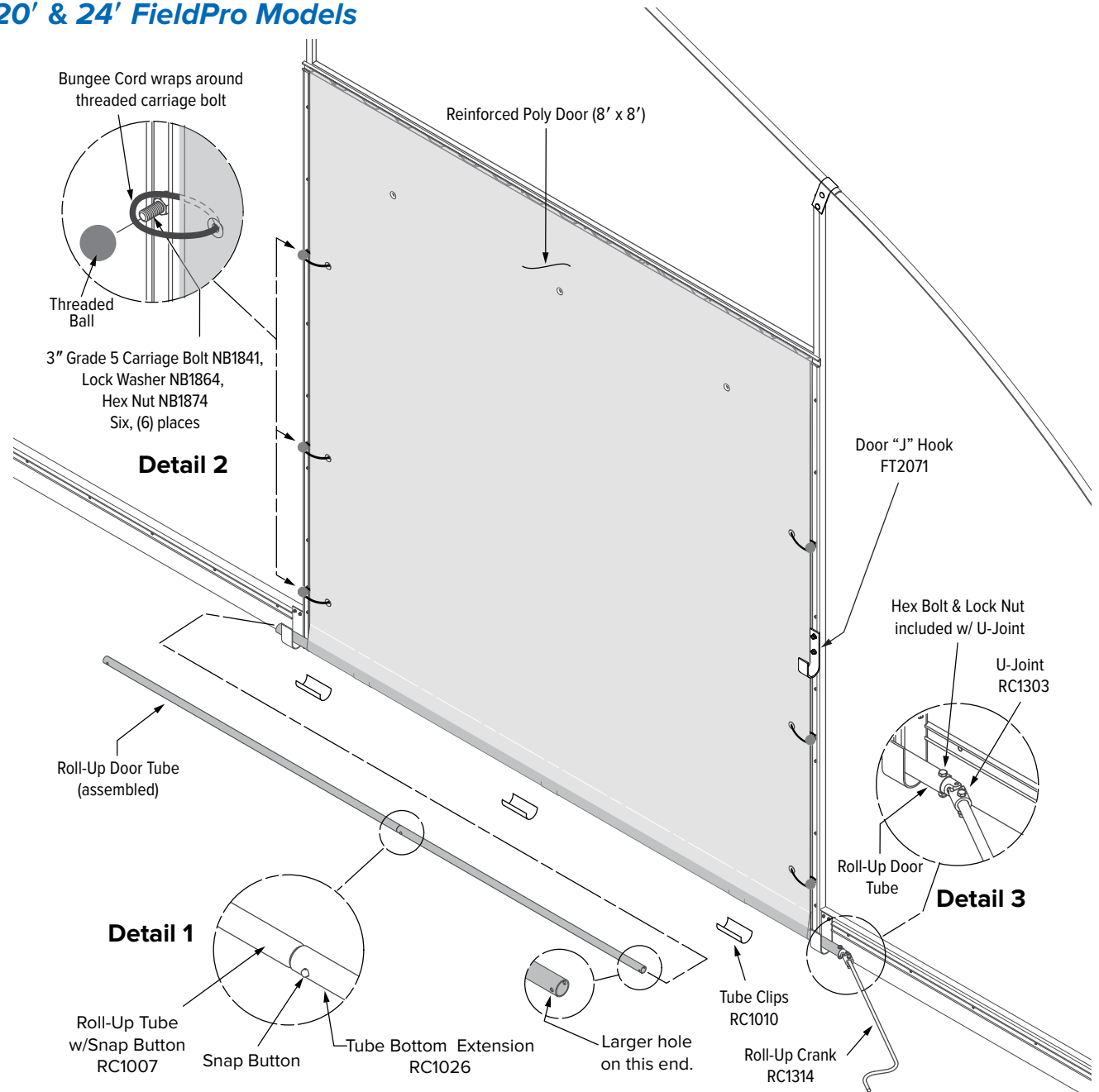

# Optional Roll-Up Side Curtain Components and Hardware



HT Gearbox Vertical (70")  
HT1002

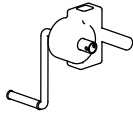

Roll-Up Unit  
NS104  
MV1000



Bracket  
with S Hook  
RC1311

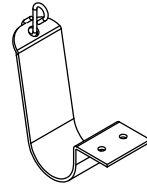

RC1330  
Cradle, Short,  
w/S-Hook



Tube Clip  
Roll-Up 1.315  
RC1010

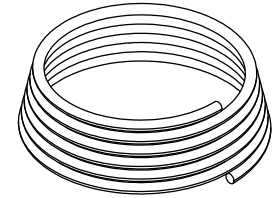

RS5049  
1/4" Nylon Rope 18600



WIGGLWIRE - 43.000  
Wiggle Wire

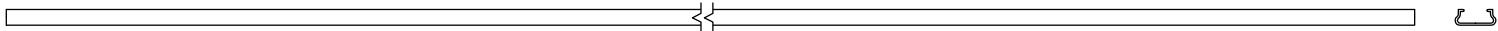

WWBASE9  
8' - 11" Wiggle Wire Base

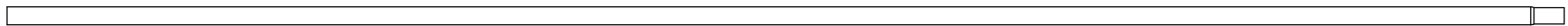

CF1014 - Tube w/Swage (116")

# Roll-Up Curtain Installation – Part 1

Instructions on this page apply to 20' & 24' FieldPro Models



**Important Note:**  
The **Roof Poly** and **End Frame Poly** (not shown) are installed before installing the **Roll-Up Side Curtain**. See page 32 for how to install the **Roof Poly** with the **Roll-Up Side Curtain** option.

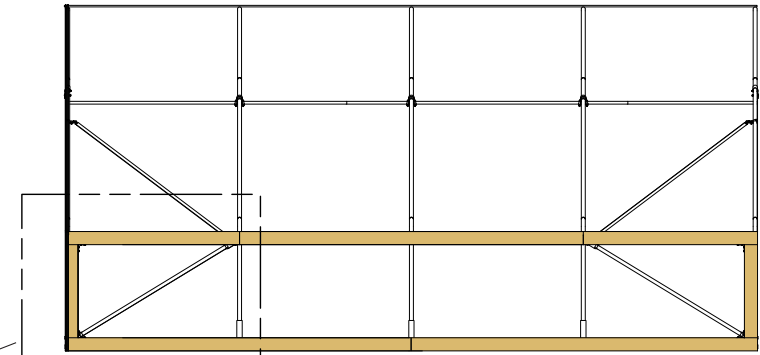

Side View of FieldPro

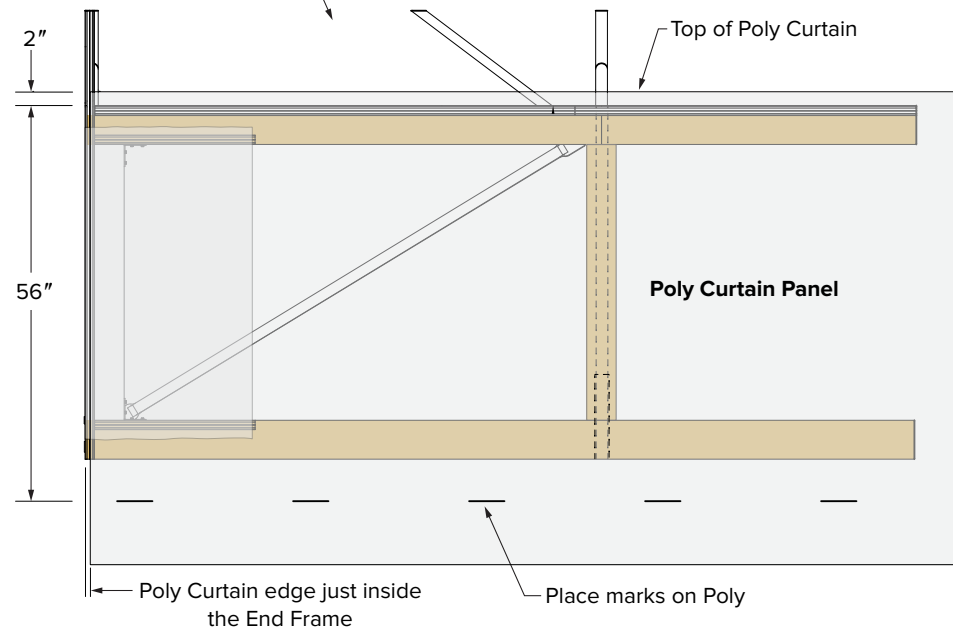
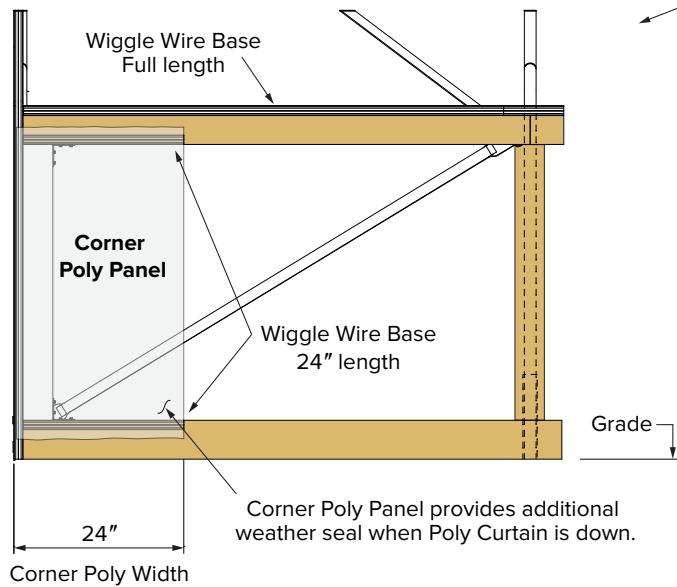

**1** Install **Wiggle Wire Base** flush with top of wood rail across full length of the FieldPro. Also install two, (2) 24" lengths of the **Wiggle Wire Base** to top and bottom wood rails (each end) as shown above.

Cut a 24" x 48" piece of Poly to use for the **Corner Poly Panel**. Use **Wiggle Wire** to secure this panel in place.

**2** The **Roll-Up Poly Curtain** ends should be kept just inside the **End Frames**. The top should extend 2" above the top of the upper rail. Begin folding the Poly into the **Wiggle Wire Base** and secure with the **Wiggle Wire**. Continue securing the **Poly Curtain** in place down the entire length of the FieldPro. Make sure that 2" of **Poly** always extends above the top rail—keeping the Poly as even as possible.

After the **Poly Curtain** top is secured, use a permanent marker to make placement marks down the entire length of the **Poly Curtain**. These placement marks should be drawn at a point 56" down from the top rail. These marks will help to align the **Poly Curtain** with the **Roll Up Tube**. Proceed to next page to continue the installation.

*Instructions on this page apply to 20' & 24' FieldPro Models*

**1** To install the **Vertical Tube (HT10020)** that supports the **Roll-Up Unit (MV1000)**, drill a 5" diameter hole that is 8" in depth. The end of the **Vertical Tube** that has a plate, goes into the hole. The top of the **Tube** should extend 12" above the upper wood rail. Backfill the hole and tamp around the tube to compact the soil.

Place the **Roll-Up Unit** onto the **Vertical Tube**. See illustration at right and Detail B.

**2** To prepare the first **Roll-Up Tube (CF1014)**, drill a 3/8" clearance hole in the non-swaged end of the section. Place the **Roll-Up Tube** over the shaft on the **Roll-Up Unit** and replace the screw and nut that will hold this section in place.

Continue to add additional **Roll-Up Tube** sections until you reach the other end of the FieldPro. Secure the tube sections together at each splice with 1/4"-14 x 1" Self-Drilling Screws (NB1809). See Detail A.

Trim the last **Roll-Up Tube** flush with the **End Frame**.

**3** Use the marks previously placed on the **Poly Curtain** to align **Roll Up Tube(s)**.

Begin fastening the Poly Curtain to the assembled **Roll-Up Tube** using a **Tube Clip** every 36". Keep the poly on the **Roll-Up Tube** straight by continuing to line up the poly and tube with the placement marks as you progress down the side of the FieldPro. See Detail C.

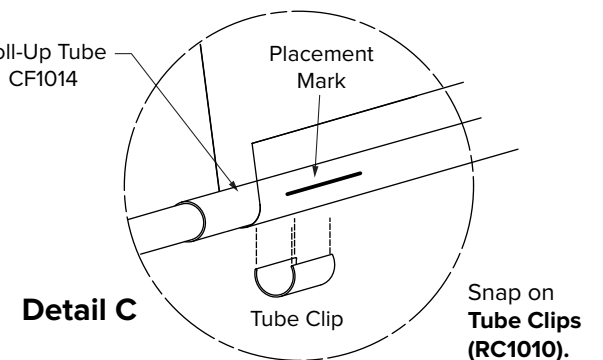
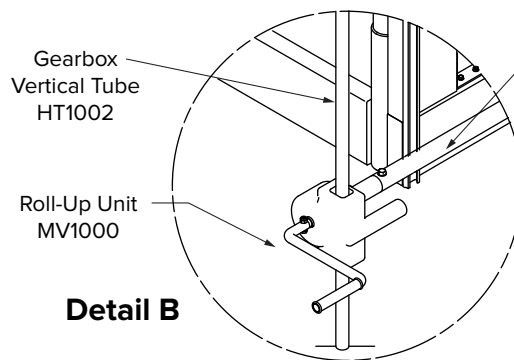
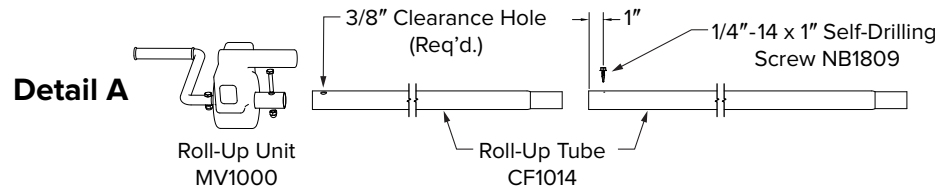
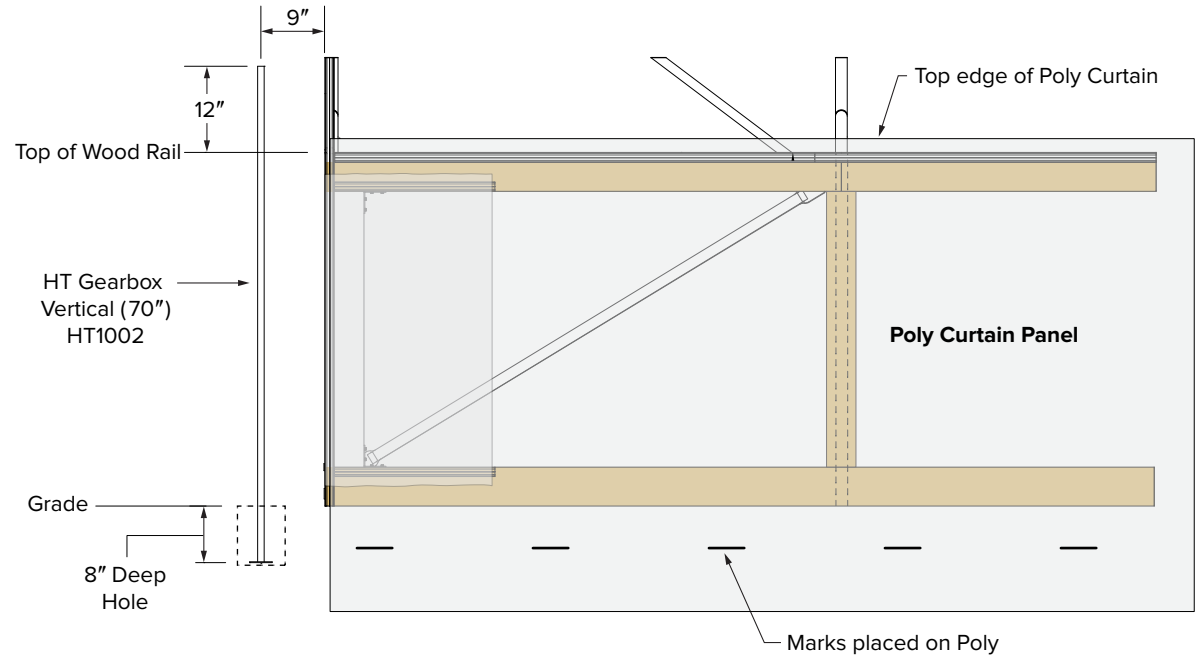

# Roll-Up Curtain Retainer Installation

## Instructions on this page apply to 20' & 24' FieldPro Models

- 1** Raise the **Poly Curtain** by turning the crank handle on the **Roll-Up Unit** counterclockwise until the curtain is about halfway up.
- 2** Measure over 24" from the end of the lower side rail. See illustration at right. Install a **Cradle w/ S-Hook (RC1330)** at this location using two, (2) **Woodtite Screws (NB1807)** as shown in Detail A.  
  
Install additional **Cradles** along the length of the side rail every 12'-0" on center.
- 3** The **Rope Brackets w/ S-Hook (RC1311)** will be installed over the **Wiggle Wire Base**. Center the **Brackets** and use **Woodtite Screws (NB1807)** to fasten the Brackets. See Detail B.
- 4** Thread the **1/4" nylon rope** through the cradles and **Rope Brackets** in a zig-zag pattern down the side of the FieldPro. Tighten **Rope** and secure to the **S-Hook** on the **Rope Brackets** at each end of the FieldPro.

