

CD8000 8 level circle display

ASSEMBLY INSTRUCTIONS



IMPORTANT

Please read these instructions carefully before you start to assemble this display. Save these instructions for future reference.

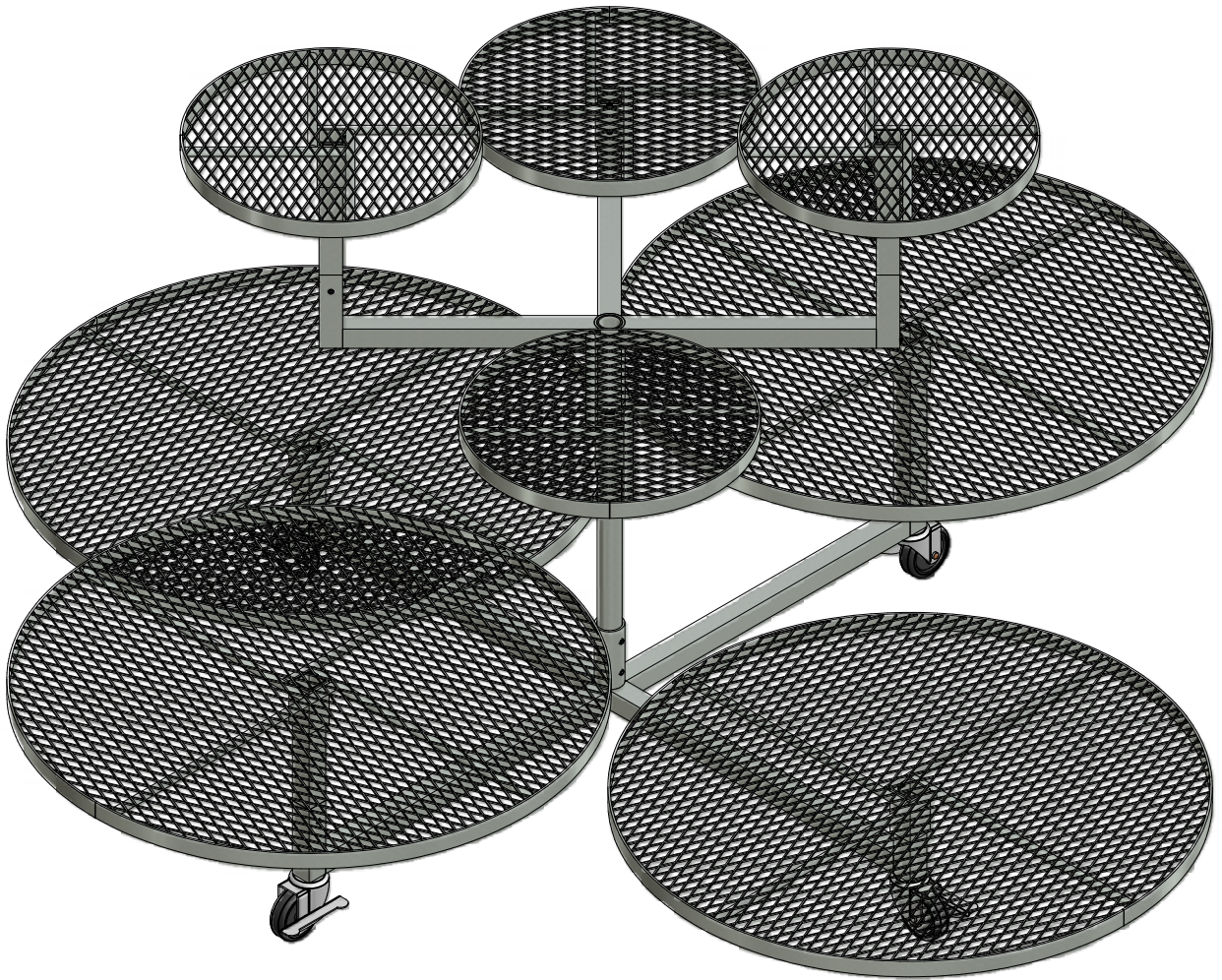

PARTS IDENTIFICATION

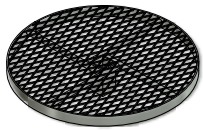

CD8005
16" SHELF
(4)



CD8004
32" SHELF
(4)



CD8003
POST



CD8006
SHELF EXTENSION 10"
(4)

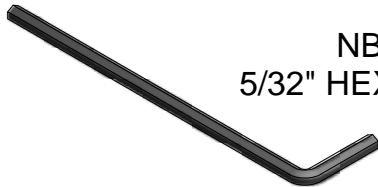

NB1979
5/32" HEX WRENCH

CD8002
SHELF SUPPORT

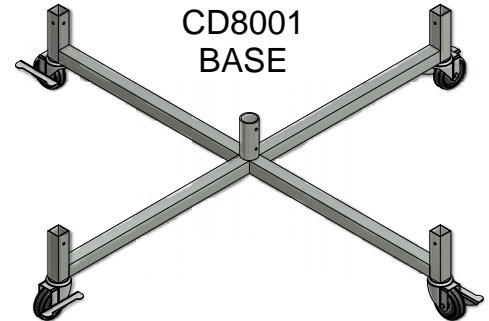
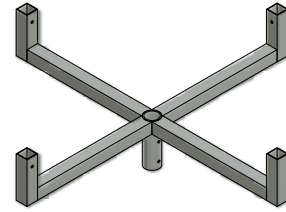

CD8001
BASE



NB1978
5/16" SET SCREW
(20)

OPTIONAL COMPONENTS



CD8008
SIGN POST 33"

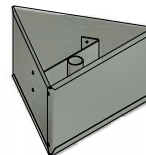

CD4007
SIGN HOLDER, 3 SIDE

TOOLS & EQUIPMENT REQUIRED

No additional tools are required.

UNIT ASSEMBLY

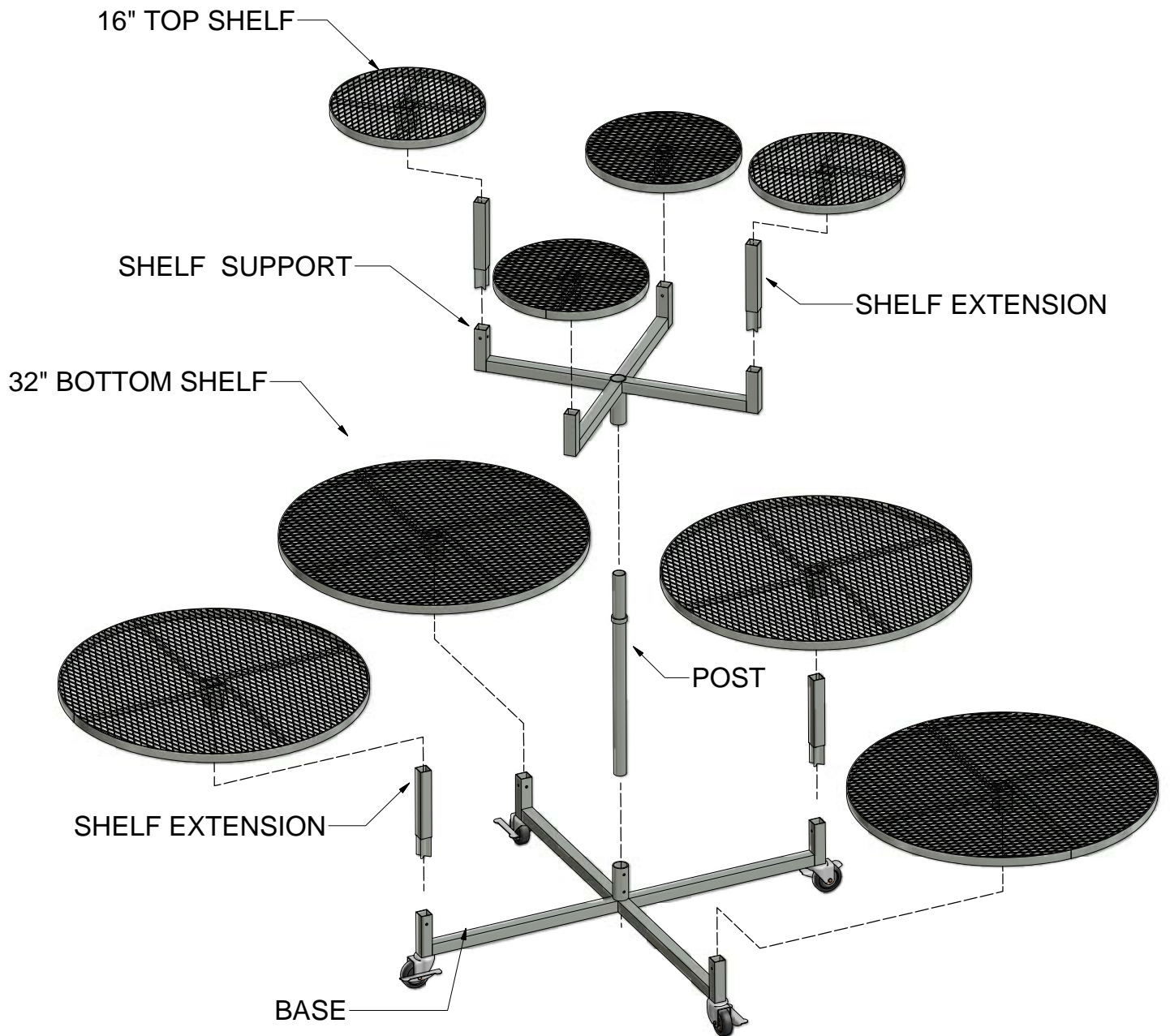

1. INSERT SHELF EXTENSION INTO BASE AND INSTALL OTHER SHELF EXTENSION ON OPPOSITE SIDE, INLINE WITH FIRST ONE.
2. INSERT END OF POST INTO BASE (NOTE COLLAR POSITION). SLIDE SHELF SUPPORT ONTO POST.
3. INSERT SHELF SUPPORT EXTENSION INTO SHELF SUPPORT AND INSTALL OTHER SHELF SUPPORT EXTENSION ON OPPOSITE SIDE, INLINE WITH FIRST ONE.
4. INSTALL SHELVES.

UNIT ASSEMBLY

3 SCREWS
(2 PL.)

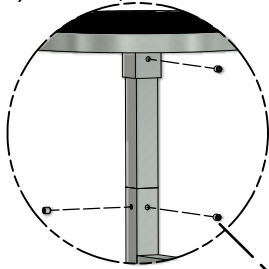

FIGURE A

1 SCREW
(2 PL.)

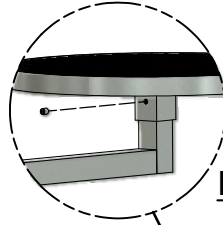

FIGURE B

2 SCREWS

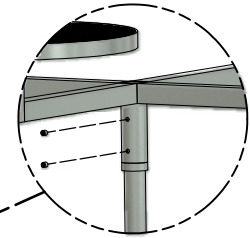

FIGURE E

2 SCREWS

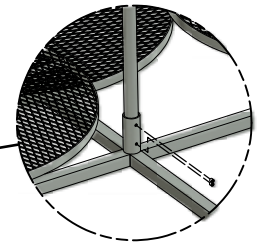

FIGURE F

3 SCREWS
(2 PL.)

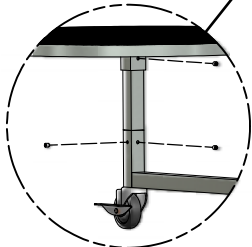

FIGURE C

1 SCREW
(2 PL.)

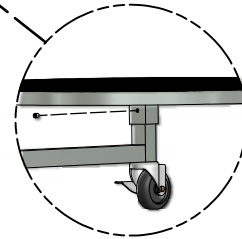
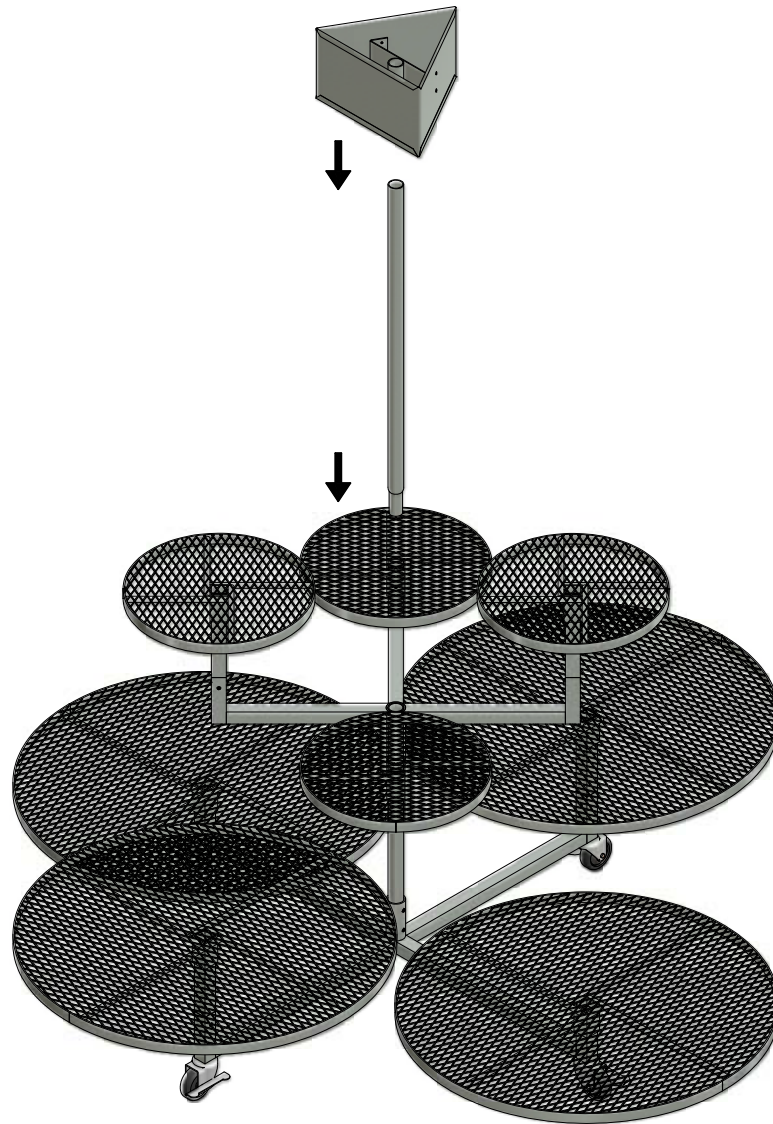

FIGURE D

5. USE FOUR SET SCREWS TO ATTACH BASE (FIG. F) AND SHELF SUPPORT (FIG. E) TO POST.

6. USE 16 SET SCREWS TO HOLD SHELVES (FIG. A, B, C, & D) FIRMLY IN PLACE.

OPTIONAL SIGN HOLDER ASSEMBLY



1. SLIDE SIGN POST INTO TOP OF DISPLAY. SLIDE SIGN HOLDER ONTO TOP OF SIGN POST.

CASTER USE INSTRUCTIONS

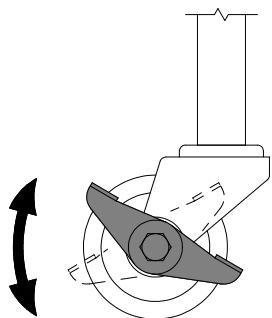

ONCE THE DISPLAY IS IN PLACE, ALL CASTERS MUST BE LOCKED INTO PLACE USING THE CASTER BRAKES TO PREVENT DISPLAY MOVEMENT. THE BRAKE IS ACTIVATED BY ROTATING THE LEVER FROM THE "OFF" POSITION TO THE "ON" POSITION AS SHOWN.

SAFETY GUIDELINES

Do not climb, sit on, or use this product as a ladder. Injuries may occur.

Do not place or install electrical items on this product. Wet conditions are typical and electrical shock may occur.

Do not place this product on a slope that exceeds 3 degrees.

Do not move this display after product is in place. Damage to display and injuries may occur.

Lock casters (when provided) once display is in place to prevent movement.

Remove all debris or obstacles from caster's path before moving.

CARE & MAINTENANCE

To remove loose soil and debris, simply spray the soiled areas with a garden hose.

Prior to storage, all surfaces of this product should be sprayed down with water and allowed to dry completely.

Limited Warranty

Poly-Tex, Inc. warrants its products to be free from defects in material and workmanship for a period of (1) year from date of invoice. This warranty is provided to the original purchaser of the product and is not transferable. Poly-Tex does not warrant parts not manufactured by Poly-Tex, but does assign any transferable manufacturer or supplier warranties. Should any defect be found, full repair or replacement will be rendered to the customer at no cost following inspection by a Poly-Tex representative and the return of the defective product to our Castle Rock, MN factory. Expenses for removal or reinstallation of defective products will not be covered by the warranty.

POLY-TEX SHALL NOT BE HELD RESPONSIBLE FOR ANY SPECIAL OR CONSEQUENTIAL DAMAGES, OR FOR ANY DELAY IN PERFORMANCE OF THIS WARRANTY BEYOND OUR CONTROL. THIS WARRANTY IS EXCLUSIVE AND IN LIEU OF ALL OTHER WARRANTIES WHETHER IMPLIED, WRITTEN OR ORAL INCLUDING THE WARRANTIES OF MERCHANTABILITY AND FITNESS FOR A PARTICULAR PURPOSE.

This warranty does not cover damage from customer abuse, misuse, improper installation, customer modifications, customer negligence in performing normal maintenance, damage resulting from acts of nature.

Contact information
Poly-Tex, Inc. PO Box 458
27725 Danville Ave Castle Rock, MN 55010
Toll free (800) 852-3443 Fax (651) 463-2479
www.poly-tex.com